

IMPROVEMENT PERMIT

03-5-5754

Be it ordained by the Harnett County Board of Health as follows: Section III, Item B. "No Person shall begin construction of any building at which a septic tank system is to be used for disposal of sewage without first obtaining a written permit from the Harnett County Health Department."

Name: (owner) Robert Adams Jr (Klamath Corp) [X] New Installation [X] Septic Tank
Property Location: SR# Ne 24 [] Repairs [X] Nitrification Line

Subdivision Heritage Village Lot # 6-12

Tax ID # _____ Quadrant # _____

Number of Bedrooms Proposed: 3 (28x66) Lot Size: 646 ac

Basement with Plumbing: [] Garage: []

Water Supply: [] Well [X] Public [] Community

Distance From Well: 50 ft.

Following is the minimum specifications for sewage disposal system on above captioned property. Subject to final approval.

Type of system: [X] Conventional [] Other _____

Size of tank: Septic Tank: 1000 gallons Pump Tank: _____ gallons

Subsurface Drainage Field No. of ditches 2 exact length of each ditch 100 ft. width of ditches 3 ft. depth of ditches 18.21 in.

French Drain Required: _____ Linear feet

Date: 11-5-02

This permit is subject to revocation if site plans or intended use change.

Signed: [Signature] Environmental Health Specialist

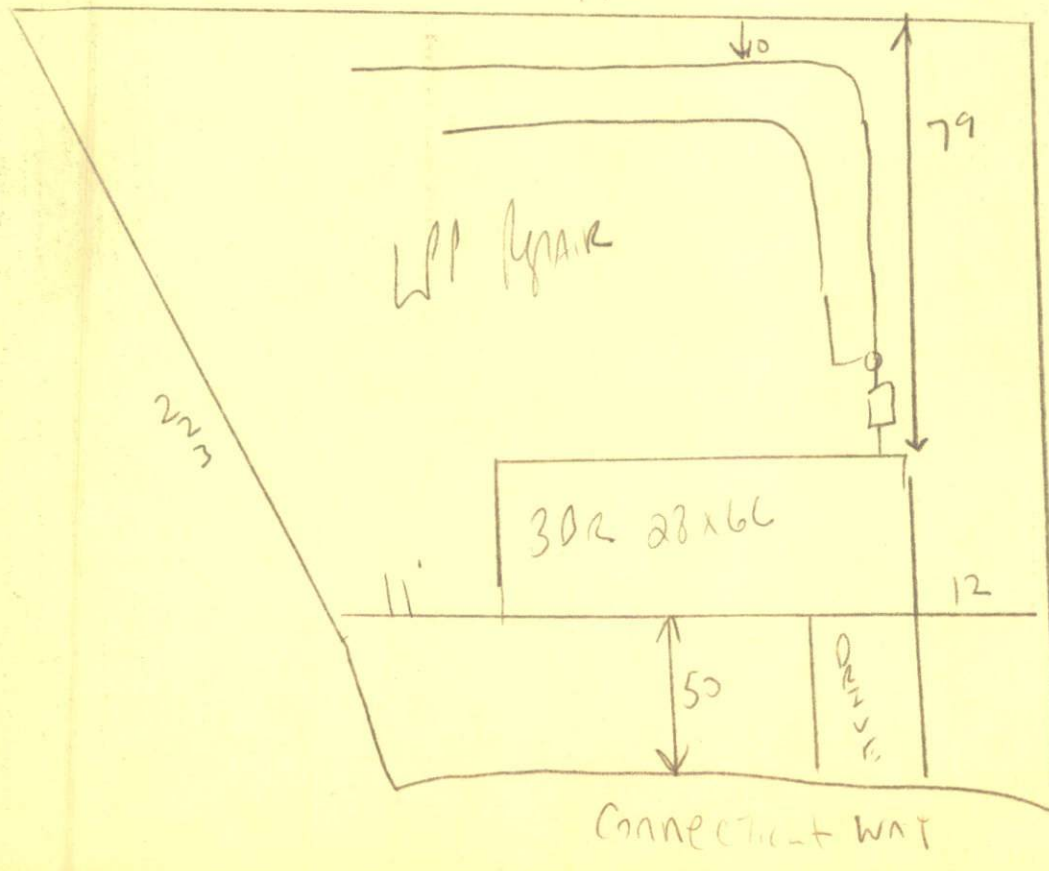

STUB out Plumbing Shallow Maintain all set back, Do Not Drive or Park on septic SYSTEM

HARNETT COUNTY HEALTH DEPARTMENT
AUTHORIZATION TO CONSTRUCT

Authorization is hereby given to construct a wastewater system to the specifications described by Harnett County Health Department, Improvement Permit # 19791. This authorization shall be valid for a period not to exceed five (5) years from the date of issuance. This authorization will be invalid if ownership, site plans, or intended use change.

Name Robert Adams Jr (K. Arnold Corp) Telephone # 910-436-6476

Address _____

Property Location SR# NC24 Road Name _____
Heritage Village G-12 3 (28x66) .46A1
Subdivision Lot # # Bedrooms Proposed Lot size

TYPE OF SYSTEM

New Installation Repair Septic Tank Nitrification Lines

Conventional Other _____

Basement With Plumbing Without Plumbing

Water Supply: Well Public - Minimum Well Setback: 50 Ft.
Septic Tank 1000 Pump Chamber _____

NITRIFICATION FIELD SPECIFICATIONS

Number of fields 1 # of lines per field 2 Length of lines 100 Ft.

Width of ditches 3 ft. Depth of ditches 18.24 inches

French Drain: Linear feet required _____ Depth of gravel _____

No wastewater system shall be covered or placed into use by any person until an inspection by the Harnett County Health Department has determined that the system has been installed according to the conditions of the Improvement Permit and that a valid Operations Permit has been issued.

Signature of Authorized Agent for Harnett County [Signature] Date 11-5-02