

IMPROVEMENT PERMIT

03-5-5503

Be it ordained by the Harnett County Board of Health as follows: Section III, Item B. "No Person shall begin construction of any building at which a septic tank system is to be used for disposal of sewage without first obtaining a written permit from the Harnett County Health Department."

Name: (owner) Lisa Blue / Barry Guyton
Property Location: SR# Besler Rd
Subdivision Lisa Blue Lot # 1

Tax ID # \_\_\_\_\_ Quadrant # \_\_\_\_\_
Number of Bedrooms Proposed: 4 (28x76) Lot Size: .70

Basement with Plumbing: [ ] Garage: [ ]
Water Supply: [x] Well [x] Public [ ] Community
Distance From Well: 50 ft.

Following is the minimum specifications for sewage disposal system on above captioned property. Subject to final approval.

Type of system: [x] Conventional [ ] Other
Size of tank: Septic Tank: 1000 gallons Pump Tank: \_\_\_\_\_ gallons
Subsurface Drainage Field No. of ditches 1 exact length 400 width of ditches 3 depth of ditches 18-24 MAX in.

French Drain Required: \_\_\_\_\_ Linear feet
Date: 9-12-02
Signed: J. W. ARS Environmental Health Specialist

This permit is subject to revocation if site plans or intended use change.

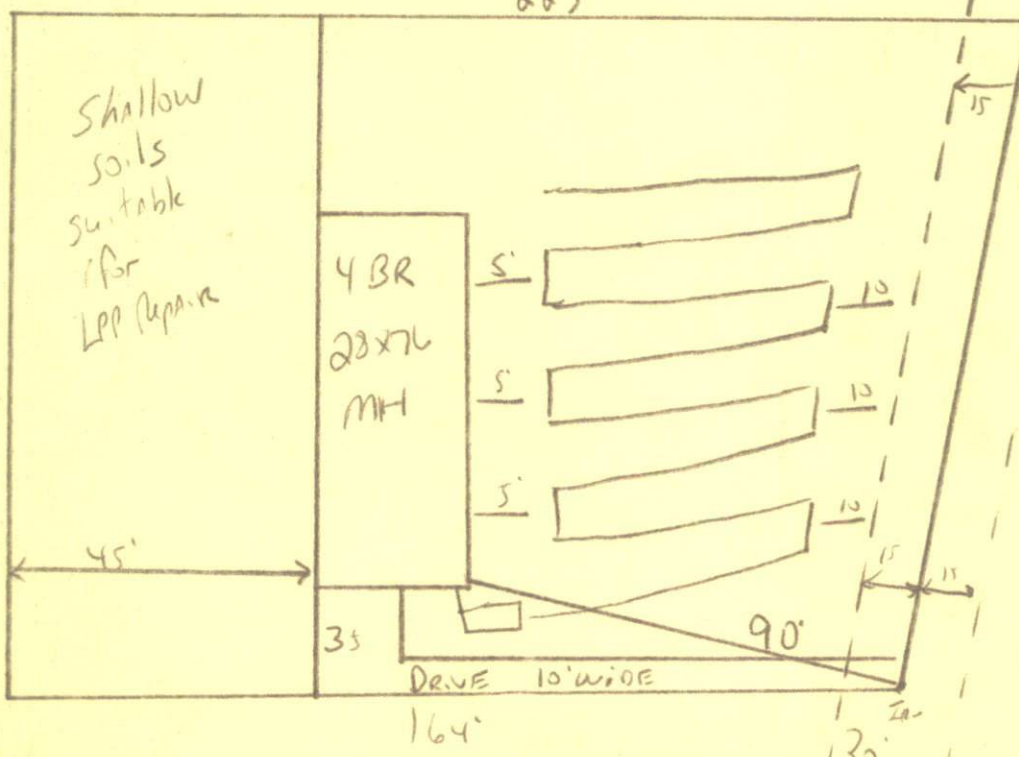

MUST meet onsite Before Installing
Drive must Be 10' WIDE MAX and Be Along Property Line
Do not Drive or park on septic SYSTEM
Maintain All Set Backs



HARNETT COUNTY HEALTH DEPARTMENT  
AUTORIZATION TO CONSTRUCT

Authorization is hereby given to construct a wastewater system to the specifications described by Harnett County Health Department, Improvement Permit # 19595. This authorization shall be valid for a period not to exceed five (5) years from the date of issuance. This authorization will be invalid if ownership, site plans, or intended use change.

Lisa Blue Barry Gayle 499-5877  
Name Telephone #

Address

Brewer Rd

Property Location SR# Road Name

Lisa Blue 1 4(28x76) .70  
Subdivision Lot # # Bedrooms Proposed Lot size

TYPE OF SYSTEM

New Installation  Repair  Septic Tank  Nitrification Lines

Conventional Other \_\_\_\_\_  Basement  With Plumbing  Without Plumbing

Water Supply:  Well  Public - Minimum Well Setback: 50 Ft.  
Septic Tank 1/000 Pump Chamber \_\_\_\_\_

NITRIFICATION FIELD SPECIFICATIONS

Number of fields 1 # of lines per field 1 Length of lines 400 Ft.

Width of ditches 3 ft. Depth of ditches 18-24 inches

French Drain: Linear feet required \_\_\_\_\_ Depth of gravel \_\_\_\_\_

No wastewater system shall be covered or placed into use by any person until an inspection by the Harnett County Health Department has determined that the system has been installed according to the conditions of the Improvement Permit and that a valid Operations Permit has been issued.

[Signature]  
Signature of Authorized Agent for Harnett County

9-12-02  
Date