

03/13/02

### SEPTIC SYSTEM LAYOUT DESIGN : FIELD SHEET

Project/Site: Ronald Johnson

Lot #: \_\_\_\_\_

# Bedrooms 2

Investigator \_\_\_\_\_

House Footprint single-wide Setbacks \_\_\_\_\_

Date 9/2/02

Slope: \_\_\_\_\_ Foundation Drain: YES NO

Line No.	Line color	Field Line Length	System Line Length	Field Elevation			Relative Elevation
				Setup #1	Setup #2	Setup #3	
1	W	48					
2	Y	65					
3	(A) R	51					
4	(C) R	71					
5	Y	112					
6	W	84					
7	R	60					
8	B	40					
9							
10							
11							
12							
13							
Pump Tank							
Supply Line							
EIP Benchmark							100.0

#### PROPOSED SYSTEM:

Initial System gravity

~~2 x 135~~ on contour @ 2'  
 0.3 gpd/sqft  
 L1 45' } 135' L4 70' } 13'  
 L2 45' } L5 65' }  
 L3 45'

#### Repair System

~~2 x 100~~  
 gravity innovative  
 2 x 100'  
 L5 35' } 100  
 L6 65' }  
 L7 60' } 100  
 L8 40' }

Scale:

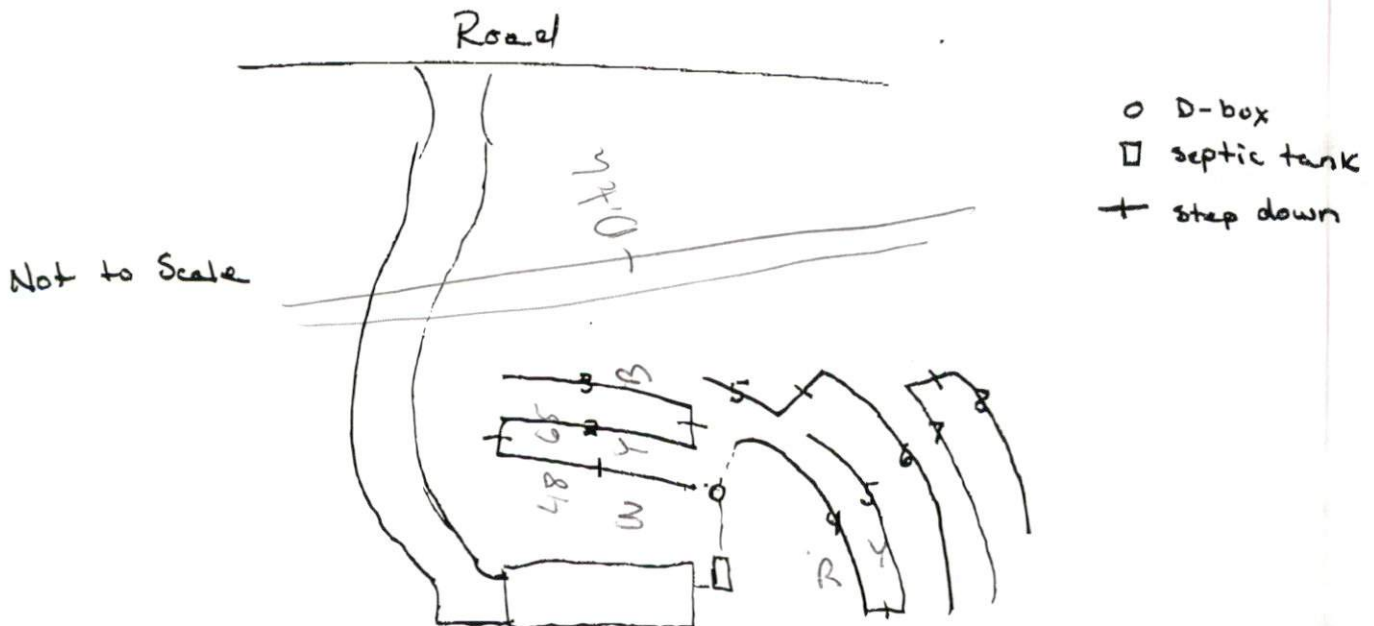

IF FLAGS  
 ARE DAMAGED  
 OR REMOVED  
 BEFORE SYSTEM  
 IS INSTALLED  
 YOU WILL BE  
 REQUIRED TO  
 GET  
 HAL OWNERS  
 TO RESTATE  
 SYSTEM

P/2

2x13x  
 12" Deep  
 Meet onsite

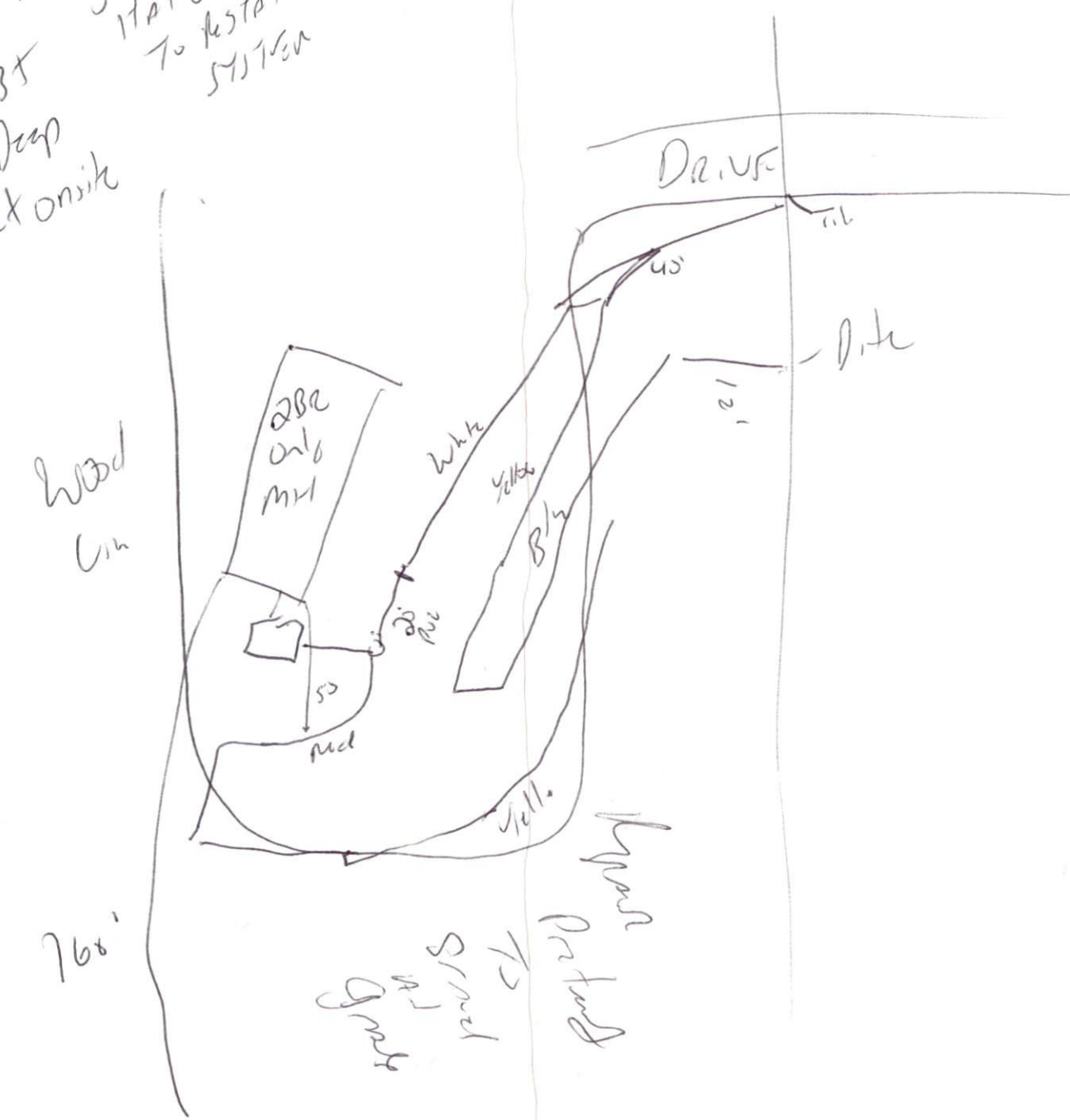

P/2

#1 0-12L  
12-20SL  
20-28SL  
28" CR2

#2 0-18L  
18-30SL  
26" CR2

#3 0-12L  
12-18SL  
16-18SL  
exp CR2  
16"

#4 0-6L  
6-14SL  
14-18  
SL  
exp CR2

#5 0-10L  
10-18SL  
typical  
at 14

EX. CON. MON.

716.93'

SIP

N 09° 04' 00" E

353.90'

N/F W. M.

S

54° 00' 09" W

JOHNSTON

828.96'

5.77 ACRES

5.00 ACRES

②

①

615.42'

S 80° 56' 00" E

I hereby certify that an actual survey has been shown hereon; broken lines plot to a ratio of precision of 1/10,000 +

G. S. 47-30 as amended, registration number 10,000, D., 1988

SITE PLAN APPROVAL

DISTRICT RA200 USE Swm

#BEDROOMS 2

Date 8-9-02

Zoning Administrator Theresa Jones

Required Property Line Setbacks

	Minimum	Actual
Front	<u>35</u>	<u>170</u>
Side	<u>10</u>	<u>175</u>
Corner	<u>20</u>	<u>170</u>
Rear	<u>25</u>	<u>170</u>
Nearest Building	<u>10</u>	<u>170</u>

R/W

EIP

42.44' PK 100.00'

SIP

30' PK

353.90'

S 09° 04' 00" W

N. C. S. R.

WELDON WOMACK

Public