

IMPROVEMENT PERMIT

02-5-2018

Be it ordained by the Harnett County Board of Health as follows: Section III, Item B. "No Person shall begin construction of any building at which a septic tank system is to be used for disposal of sewage without first obtaining a written permit from the Harnett County Health Department."

Name: (owner) Todd & Tina Hollar New Installation Septic Tank
Property Location: SR# 1128 Repairs Nitrification Line

Subdivision Little River Plantation Lot # 101

Tax ID # _____ Quadrant # _____

Number of Bedrooms Proposed: 3 (28x70) Lot Size: 10.94 AC

Basement with Plumbing: Garage:

Water Supply: Well Public Community

Distance From Well: 50 ft.

Following is the minimum specifications for sewage disposal system on above captioned property. Subject to final approval.

Type of system: Conventional Other _____

Size of tank: Septic Tank: 1000 gallons Pump Tank: _____ gallons

Subsurface Drainage Field No. of ditches 1 exact length of each ditch 270 ft. width of ditches 3 ft. depth of ditches 18 in.

French Drain Required: _____ Linear feet

Date: 7-11-02

This permit is subject to revocation if site plans or intended use change.

Signed: Joe WARR
Environmental Health Specialist

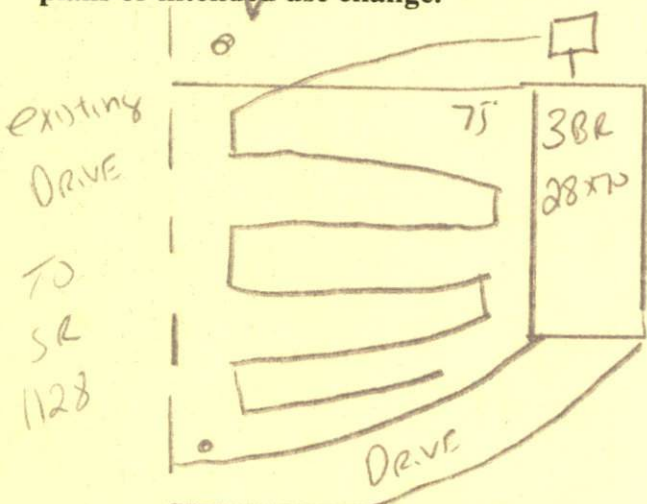

LPP Repair

Blue Flag

200
Must Meet onsite Before Installing - 1st Line To Be 18"-24" The Rest 18" - MAINTAIN ALL SET BACKS
Do not Drive or park on septic system

HARNETT COUNTY HEALTH DEPARTMENT
AUTHORIZATION TO CONSTRUCT

Authorization is hereby given to construct a wastewater system to the specifications described by Harnett County Health Department, Improvement Permit # 19486. This authorization shall be valid for a period not to exceed five (5) years from the date of issuance. *This authorization will be invalid if ownership, site plans, or intended use change.*

Todd & Tina Hollan 919-7746141
Name Telephone #

Address

1128
Property Location SR# Road Name

Little River Plantation 101 3(28x70) 1094 ac
Subdivision Lot # # Bedrooms Proposed Lot size

TYPE OF SYSTEM

New Installation Repair Septic Tank Nitrification Lines
 Conventional Other _____ Basement With Plumbing Without Plumbing

Water Supply: Well Public - Minimum Well Setback: 50 Ft.
Septic Tank 1000 Pump Chamber _____

NITRIFICATION FIELD SPECIFICATIONS

Number of fields 1 # of lines per field 1 Length of lines 240 Ft.

Width of ditches 3 ft. Depth of ditches 18 inches

French Drain: Linear feet required _____ Depth of gravel _____

No wastewater system shall be covered or placed into use by any person until an inspection by the Harnett County Health Department has determined that the system has been installed according to the conditions of the Improvement Permit and that a valid Operations Permit has been issued.

[Signature] 7-11-02
Signature of Authorized Agent for Harnett County Date