

IMPROVEMENT PERMIT

02-5-5003

Be it ordained by the Harnett County Board of Health as follows: Section III, Item B. "No Person shall begin construction of any building at which a septic tank system is to be used for disposal of sewage without first obtaining a written permit from the Harnett County Health Department."

Name: (owner) DANIELA GITANTIS

New Installation Septic Tank

Property Location: SR# NC24

Repairs Nitrification Line

Subdivision Hill Brook Bridlewood Hills Lot # 14

Tax ID # _____ Quadrant # _____

Number of Bedrooms Proposed: 3 (28x48) Lot Size: 4.04 AC

Basement with Plumbing: Garage:

Water Supply: Well Public Community

Distance From Well: 50 ft.

Following is the minimum specifications for sewage disposal system on above captioned property. Subject to final approval.

Type of system: Conventional Other _____

Size of tank: Septic Tank: 1000 gallons Pump Tank: _____ gallons

Subsurface Drainage Field No. of ditches 1 exact length of each ditch 300 ft. width of ditches 3 ft. depth of ditches 18 in. ^{MAX}

French Drain Required: _____ Linear feet

Date: 7-9-02

This permit is subject to revocation if site plans or intended use change.

Signed: [Signature]

Environmental Health Specialist

← TO NC24 ROAD

Existing Septic System #11577 Douglas G. Tantis 1-7-97

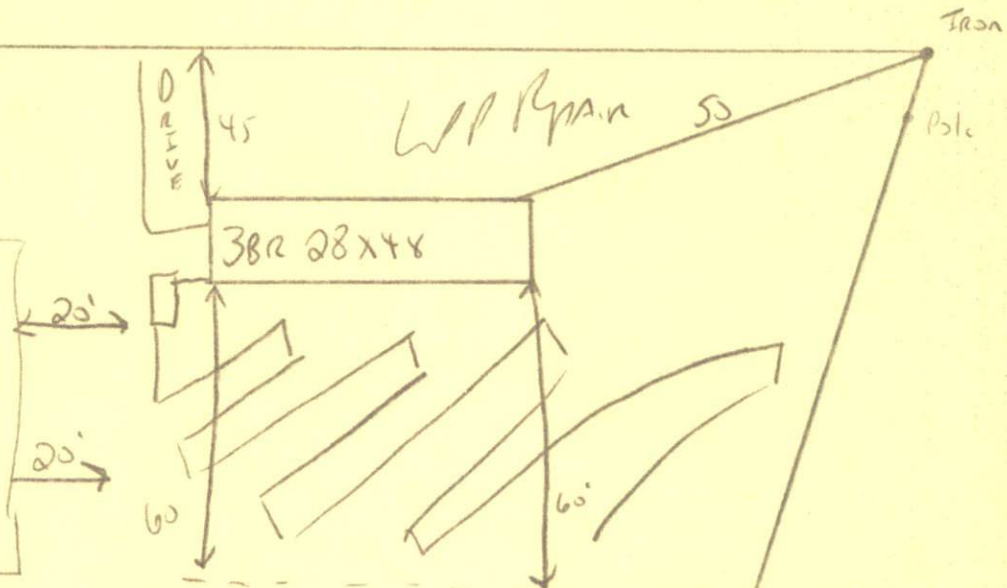

STUB out Plumbing
Shallow 18" Ditch Depth
Meet on site
DO NOT Drive or park on septic system

Maintain All Set Backs
Keep Septic system 20' Apart

HARNETT COUNTY HEALTH DEPARTMENT
AUTHORIZATION TO CONSTRUCT

Authorization is hereby given to construct a wastewater system to the specifications described by Harnett County Health Department, Improvement Permit # 19484. This authorization shall be valid for a period not to exceed five (5) years from the date of issuance. *This authorization will be invalid if ownership, site plans, or intended use change.*

Danica G. Taylor 499-1162
Name Telephone #

Address

NC 24

Property Location SR# Road Name

Bridlewood Hills

14

3(28x48)

4.07 AC

Subdivision Lot # # Bedrooms Proposed Lot size

TYPE OF SYSTEM

New Installation Repair Septic Tank Nitrification Lines

Conventional Other _____ Basement With Plumbing Without Plumbing

Water Supply: Well Public - Minimum Well Setback: _____ Ft.
Septic Tank 1000 Pump Chamber _____

NITRIFICATION FIELD SPECIFICATIONS

Number of fields 1 # of lines per field 1 Length of lines 300 Ft.

Width of ditches 3 ft. Depth of ditches 18 inches

French Drain: Linear feet required _____ Depth of gravel _____

No wastewater system shall be covered or placed into use by any person until an inspection by the Harnett County Health Department has determined that the system has been installed according to the conditions of the Improvement Permit and that a valid Operations Permit has been issued.

[Signature] 7-9-02
Signature of Authorized Agent for Harnett County Date