

IMPROVEMENT PERMIT

02-54876

Be it ordained by the Harnett County Board of Health as follows: Section III, Item B. "No Person shall begin construction of any building at which a septic tank system is to be used for disposal of sewage without first obtaining a written permit from the Harnett County Health Department."

Name: (owner) Dallas Duncan New Installation Septic Tank
 Property Location: SR# 1201 Repairs Nitrification Line

Subdivision VISTA Ridge Lot # B

Tax ID # _____ Quadrant # _____

Number of Bedrooms Proposed: 3 (28x56) Lot Size: 1.0 ac

Basement with Plumbing: Garage:

Water Supply: Well Public Community

Distance From Well: 55 ft.

Following is the minimum specifications for sewage disposal system on above captioned property. Subject to final approval.

Type of system: Conventional Other _____

Size of tank: Septic Tank: 1000 gallons Pump Tank: _____ gallons

Subsurface Drainage Field No. of ditches 3 exact length of each ditch 80 ft. width of ditches 3 ft. depth of ditches 18-24 in.

French Drain Required: _____ Linear feet

Date: 6-23-02

This permit is subject to revocation if site plans or intended use change.

Signed: J. Waters
 Environmental Health Specialist

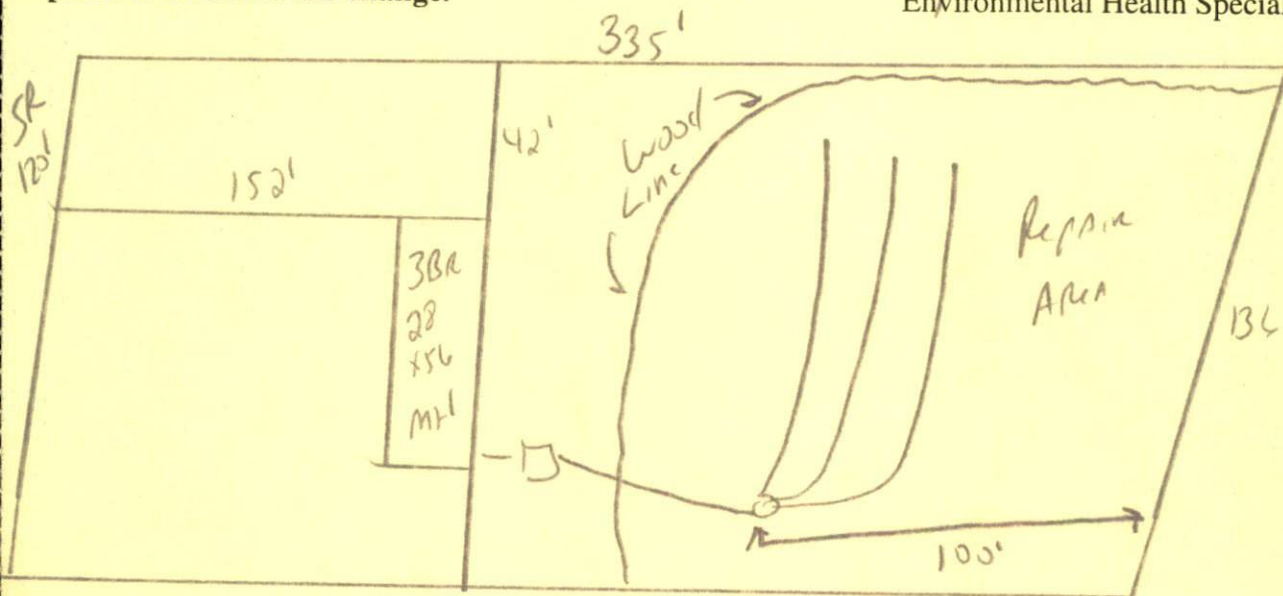

STUB out Plumbing shallow 18-24" ditch depths
 Lines start 100' from Rear property Line - MAINTAIN
 All set Backs Do not Drive or pack on septic system

HARNETT COUNTY HEALTH DEPARTMENT
AUTHORIZATION TO CONSTRUCT

Authorization is hereby given to construct a wastewater system to the specifications described by Harnett County Health Department, Improvement Permit # 19464. This authorization shall be valid for a period not to exceed five (5) years from the date of issuance. *This authorization will be invalid if ownership, site plans, or intended use change.*

Name Dallas Duncan Telephone # 785-341-4255

Address 1201

Property Location SR# USTA Ridge Road Name B
Subdivision 3(28x56) Lot # 1.0Ac
Bedrooms Proposed

TYPE OF SYSTEM

New Installation Repair Septic Tank Nitrification Lines
 Conventional Other _____ Basement With Plumbing Without Plumbing

Water Supply: Well Public - Minimum Well Setback: 50 Ft.
Septic Tank 1000 Pump Chamber _____

NITRIFICATION FIELD SPECIFICATIONS

Number of fields 10 # of lines per field 3 Length of lines 80 Ft.
Width of ditches 3 ft. Depth of ditches 1824 inches

French Drain: Linear feet required _____ Depth of gravel _____

No wastewater system shall be covered or placed into use by any person until an inspection by the Harnett County Health Department has determined that the system has been installed according to the conditions of the Improvement Permit and that a valid Operations Permit has been issued.

Signature of Authorized Agent for Harnett County [Signature] Date 6-20-02