

# IMPROVEMENT PERMIT

Be it ordained by the Harnett County Board of Health as follows: Section III, Item B. "No Person shall begin construction of any building at which a septic tank system is to be used for disposal of sewage without first obtaining a written permit from the Harnett County Health Department."

Name: (owner) Wendy DRIVER

New Installation     Septic Tank

Property Location: SR# 1447 Rawls Community

Repairs     Nitrification Line

Subdivision \_\_\_\_\_ Lot # \_\_\_\_\_

Tax ID # \_\_\_\_\_ Quadrant # \_\_\_\_\_

Number of Bedrooms Proposed: 4 Lot Size: 1 acre

Basement with Plumbing:  Garage:

Water Supply:  Well  Public  Community

Distance From Well: 50' ft.

Following is the minimum specifications for sewage disposal system on above captioned property. Subject to final approval.

Type of system:  Conventional     Other \_\_\_\_\_

Size of tank: Septic Tank: 1200 gallons    Pump Tank: \_\_\_\_\_ gallons

Subsurface Drainage Field    No. of ditches 2    exact length of each ditch 100 ft.    width of ditches 3 ft.    depth of ditches 18-24 in.

French Drain Required: - Linear feet

Date: 6-19-02

This permit is subject to revocation if site plans or intended use change.

Signed: James E. Marshall  
Environmental Health Specialist

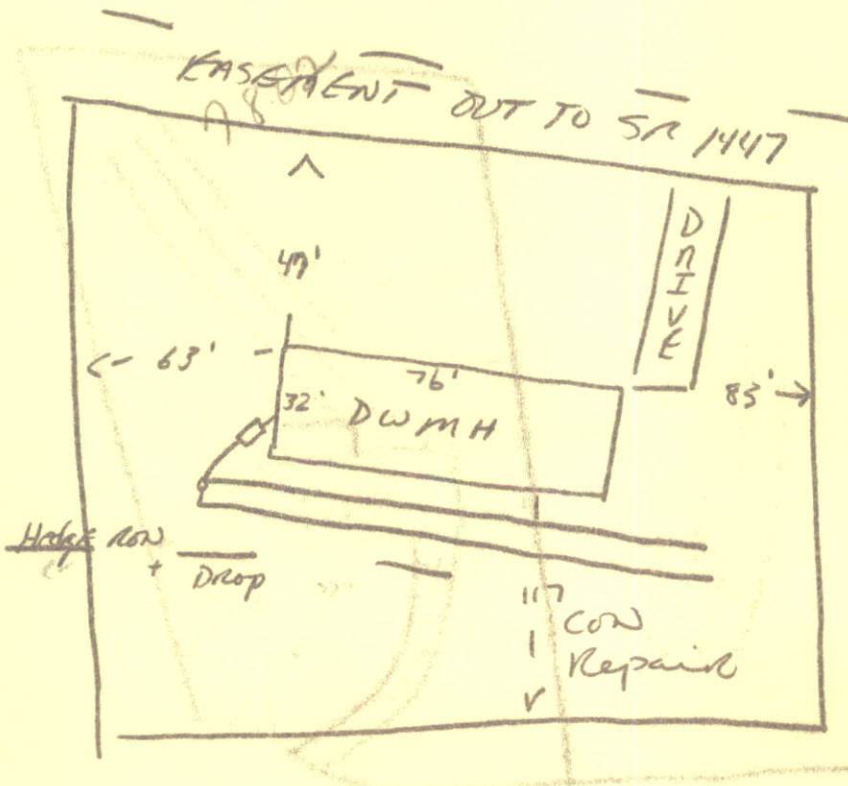

#02-5-4832

HAI T COUNTY HEALTH DEPARTMENT  
AUTHORIZATION TO CONSTRUCT

Authorization is hereby given to construct a wastewater system to the specifications described by Harnett County Health Department, Improvement Permit # 13916. This authorization shall be valid for a period not to exceed five (5) years from the date of issuance. This authorization will be invalid if ownership, site plans, or intended use change.

Wendy DRIVER Name Telephone # 919-552-5352

181 Rawls Club Rd F.V. N.C. 27526 Address

1447 Property Location SR# Rawls Community Road Name

Subdivision \_\_\_\_\_ Lot # 4 # Bedrooms Proposed \_\_\_\_\_ Lot size 1 acre

TYPE OF SYSTEM

New Installation  Repair  Septic Tank  Nitrification Lines

Conventional Other \_\_\_\_\_  Basement  With Plumbing  Without Plumbing

Water Supply:  Well  Public - Minimum Well Setback: \_\_\_\_\_ Ft.  
Septic Tank 1200 Pump Chamber \_\_\_\_\_

NITRIFICATION FIELD SPECIFICATIONS

Number of fields 2 # of lines per field 2 Length of lines 100 Ft.

Width of ditches 3 ft. Depth of ditches 18-24 inches

French Drain: Linear feet required \_\_\_\_\_ Depth of gravel \_\_\_\_\_

No wastewater system shall be covered or placed into use by any person until an inspection by the Harnett County Health Department has determined that the system has been installed according to the conditions of the Improvement Permit and that a valid Operations Permit has been issued.

James E. Manhart Signature of Authorized Agent for Harnett County Date 6-19-02