

IMPROVEMENT PERMIT

02-5-4706

Be it ordained by the Harnett County Board of Health as follows: Section III, Item B. "No Person shall begin construction of any building at which a septic tank system is to be used for disposal of sewage without first obtaining a written permit from the Harnett County Health Department."

Name: (owner) Joseph Tancet
Property Location: SR# NC 24
New Installation [checked]
Septic Tank [checked]
Repairs []
Nitrification Line []

Subdivision Wilber Browne Lot # 7

Tax ID # _____ Quadrant # _____

Number of Bedrooms Proposed: 3 (28x52) Lot Size: .46 AC

Basement with Plumbing: [] Garage: [checked]

Water Supply: [] Well [] Public [checked] Community []

Distance From Well: 50 ft.

Following is the minimum specifications for sewage disposal system on above captioned property. Subject to final approval.

Type of system: [checked] Conventional [] Other _____

Size of tank: Septic Tank: 1000 gallons Pump Tank: _____ gallons

Subsurface Drainage Field No. of 3 exact length 70 width of 3 depth of 18 1/4 in.
ditches of each ditch ft. ditches ft. ditches in.

French Drain Required: _____ Linear feet

Date: 05-24-02

This permit is subject to revocation if site plans or intended use change.

Signed: [Signature]
163 Environmental Health Specialist

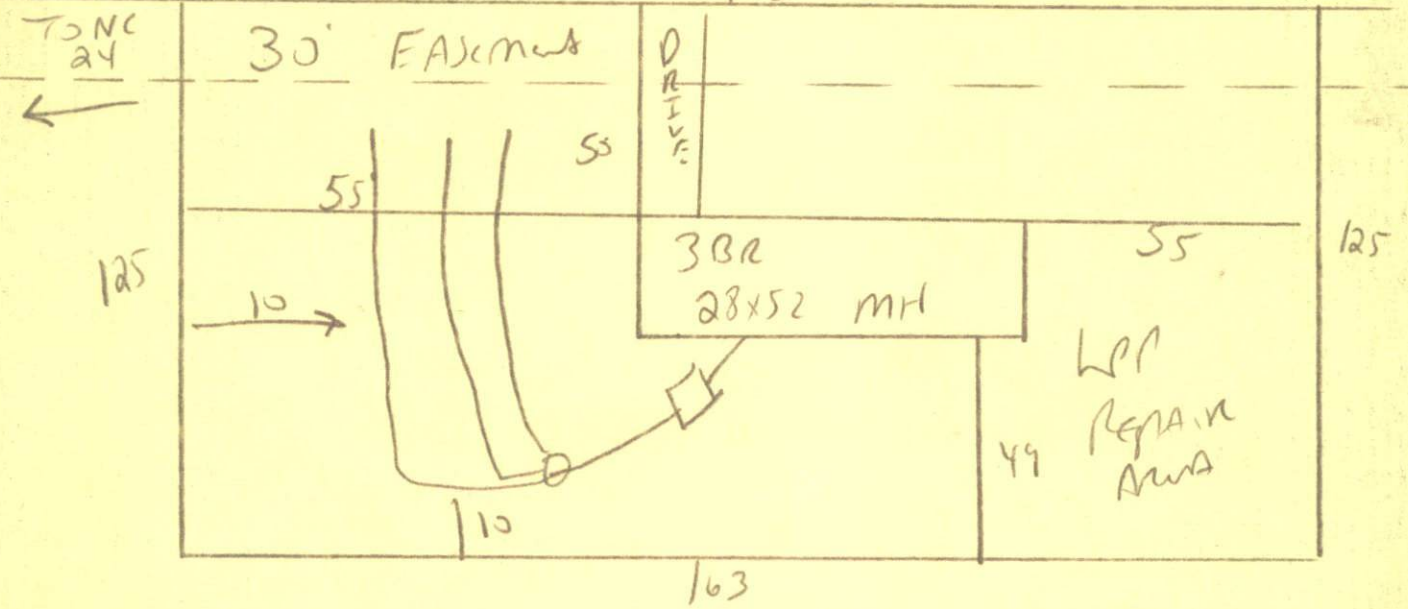

STAB Out Plumbing shallow
DO NOT DRIVE OR PARK ON SEPTIC SYSTEM
18 to 24" Pitch Depth
Maintain All Jet Backs

HARNETT COUNTY HEALTH DEPARTMENT
AUTHORIZATION TO CONSTRUCT

Authorization is hereby given to construct a wastewater system to the specifications described by Harnett County Health Department, Improvement Permit # 19100. This authorization shall be valid for a period not to exceed five (5) years from the date of issuance. *This authorization will be invalid if ownership, site plans, or intended use change.*

Joseph Tord 488-2475
Name Telephone #

Address

NC 24

Property Location SR# Road Name

Walker Brown 7 3(28x52) 46

Subdivision Lot # # Bedrooms Proposed Lot size

TYPE OF SYSTEM

New Installation Repair Septic Tank Nitrification Lines

Conventional Other _____

Basement With Plumbing Without Plumbing

Water Supply: Well Public - Minimum Well Setback: 50 Ft.

NITRIFICATION FIELD SPECIFICATIONS

Number of fields 1 # of lines per field 3 Length of lines 70 Ft.

Width of ditches 2 ft. Depth of ditches 18.24 inches

French Drain: Linear feet required _____ Depth of gravel _____

No wastewater system shall be covered or placed into use by any person until an inspection by the Harnett County Health Department has determined that the system has been installed according to the conditions of the Improvement Permit and that a valid Operations Permit has been issued.

[Signature] 5-24-02
Signature of Authorized Agent for Harnett County Date