

IMPROVEMENT PERMIT

02-5-4610

Be it ordained by the Harnett County Board of Health as follows: Section III, Item B. "No Person shall begin construction of any building at which a septic tank system is to be used for disposal of sewage without first obtaining a written permit from the Harnett County Health Department."

Name: (owner) Robert Durden

New Installation  Septic Tank

Property Location: SR# NC 27

Repairs

Nitrification Line

Subdivision Longleaf Acres

Lot # 40

Tax ID #

Quadrant #

Number of Bedrooms Proposed: 3 (41x60)

Lot Size: 1.04 AC

Basement with Plumbing:

Garage:  Please note the change in

Water Supply:  Well  Public

Community house location - Due to the size of the home, size of Garage, size of Park 9 location of suitable soils - This house must be moved

Distance From Well: 50 ft.

Following is the minimum specifications for sewage disposal system on above captioned property. Subject to final approval. AS SHOWN ON THIS PERMIT

Type of system:  Conventional

Other Pump to Conventional

Size of tank: Septic Tank: 1000 gallons

Pump Tank: 1000 gallons

Subsurface Drainage Field No. of ditches 4 exact length of each ditch 100 ft. width of ditches 3 ft. depth of ditches 18" max in.

French Drain Required: Linear feet

Date: 5-16-02

This permit is subject to revocation if site plans or intended use change.

Signed: J. W. W. S.

Environmental Health Specialist

Plot Plan must be changed to match this permit

Maintain All set Backs 18" max Ditch Depths Follow contours 110

Do not Drive on Park on septic system

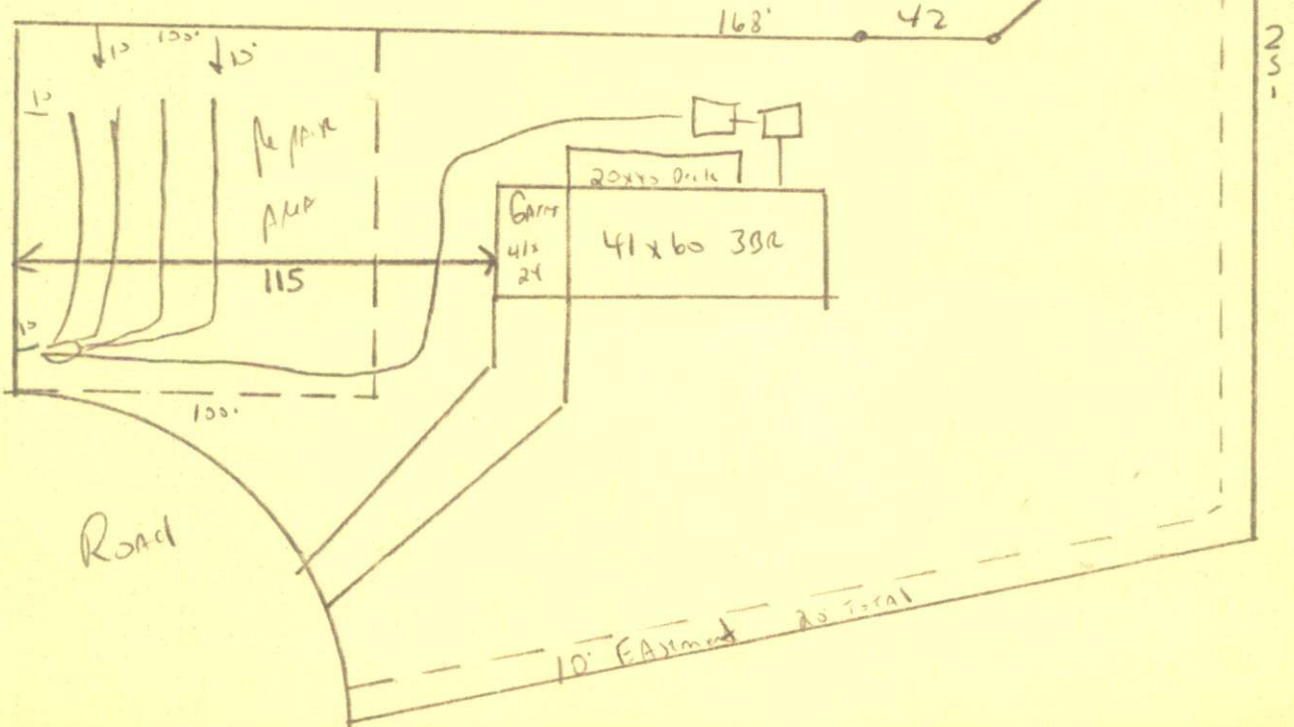

NETT COUNTY HEALTH DEPARTMENT  
AUTHORIZATION TO CONSTRUCT

Authorization is hereby given to construct a wastewater system to the specifications described by Harnett County Health Department, Improvement Permit # 19094. This authorization shall be valid for a period not to exceed five (5) years from the date of issuance. *This authorization will be invalid if ownership, site plans, or intended use change.*

Robert Durden 436-0872  
Name Telephone #

Address

NK 27

Property Location SR# Road Name

Longleaf Area

40

3(41x60)

1.04ac

Subdivision Lot # # Bedrooms Proposed Lot size

TYPE OF SYSTEM

New Installation  Repair  Septic Tank  Nitrification Lines

Conventional Other Pump to Conv.

Basement  With Plumbing  Without Plumbing

Water Supply:  Well  Public - Minimum Well Setback: 50 Ft.

NITRIFICATION FIELD SPECIFICATIONS

Number of fields 1 # of lines per field 4 Length of lines 100 Ft.

Width of ditches 3 ft. Depth of ditches 18 inches

French Drain: Linear feet required \_\_\_\_\_ Depth of gravel \_\_\_\_\_

No wastewater system shall be covered or placed into use by any person until an inspection by the Harnett County Health Department has determined that the system has been installed according to the conditions of the Improvement Permit and that a valid Operations Permit has been issued.

[Signature] 5-16-02  
Signature of Authorized Agent for Harnett County Date