

IMPROVEMENT PERMIT

02-5-4272

Be it ordained by the Harnett County Board of Health as follows: Section III, Item B. "No Person shall begin construction of any building at which a septic tank system is to be used for disposal of sewage without first obtaining a written permit from the Harnett County Health Department."

Name: (owner) Larry Holder New Installation Septic Tank
Property Location: SR# NC27/Tingra M Repairs Nitrification Line

Subdivision _____ Lot # _____

Tax ID # _____ Quadrant # _____

Number of Bedrooms Proposed: 3(28x58) Lot Size: 3.35 ac

Basement with Plumbing: Garage: *NOTE homeowner can Remove Pump by moving house BACK TO 100' from Front Property line*
Water Supply: Well Public Community
Distance From Well: 55 ft.

Following is the minimum specifications for sewage disposal system on above captioned property. Subject to final approval.

Type of system: Conventional Other Pump to Conventional

Size of tank: Septic Tank: 1000 gallons Pump Tank: 1000 gallons

Subsurface Drainage Field No. of ditches 3 exact length 100 ft. width of 3 ft. depth of 18" in.

French Drain Required: _____ Linear feet

Date: 3-27-02

This permit is subject to revocation if site plans or intended use change.

Signed: Joe W. AR
Environmental Health Specialist NC 27

Please note if house is move back 100 from this property line - A pump will not be required

1-11-2002 R

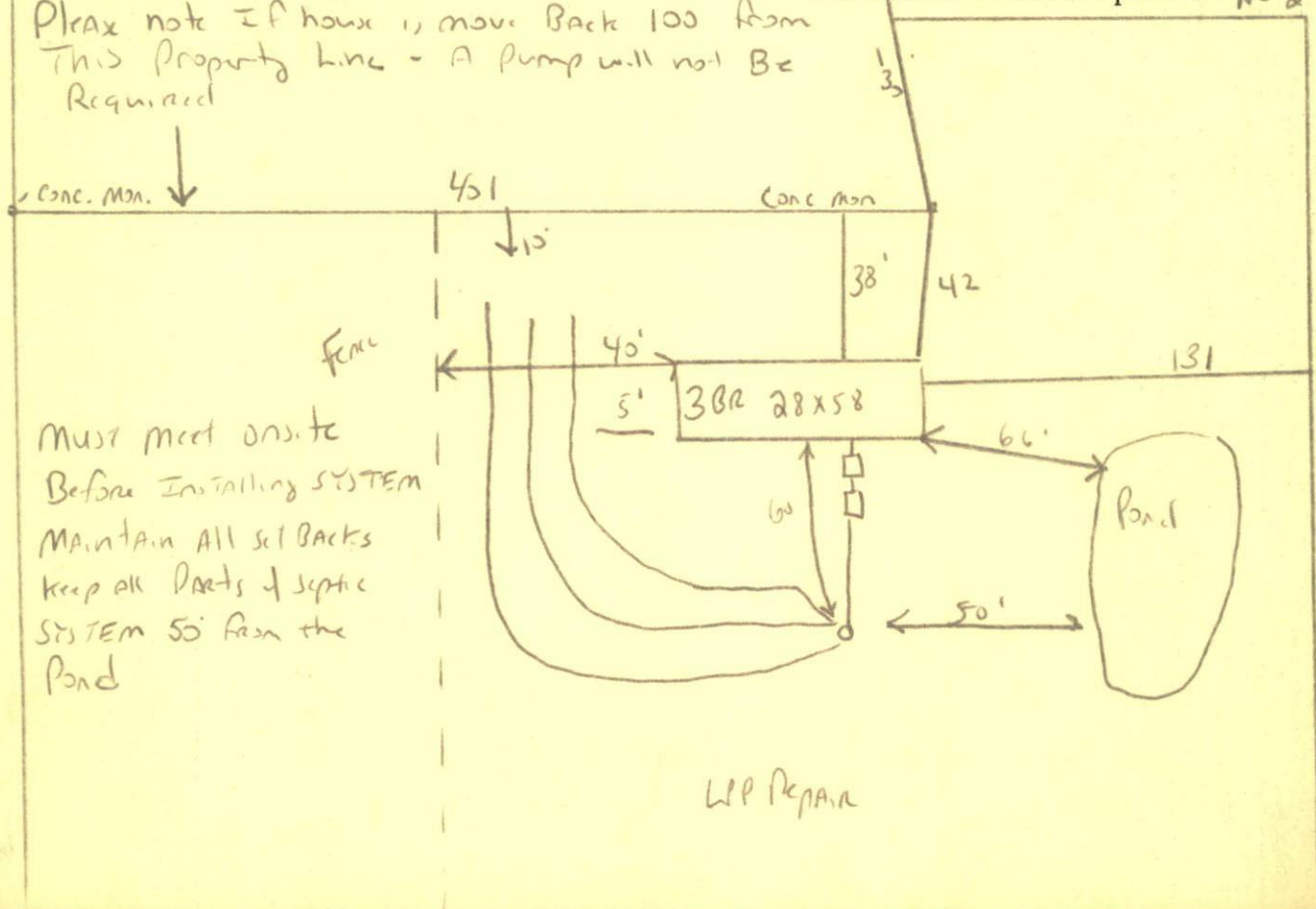

MUST meet onsite Before installing SYSTEM
MAINTAIN All set BACKS
keep all PARTS of septic SYSTEM 55' from the Pond

LPP Repair

