

01-5-2825

HARNETT COUNTY HEALTH DEPARTMENT

No 19809

IMPROVEMENT PERMIT

Be it ordained by the Harnett County Board of Health as follows: Section III, Item B. "No Person shall begin construction of any building at which a septic tank system is to be used for disposal of sewage without first obtaining a written permit from the Harnett County Health Department."

Name: (owner) SARAH GREGORY
Property Location: SR# NC27 (TACIA DR)
New Installation, Repairs, Septic Tank, Nitrification Line

Subdivision COOPERS PLACE Lot # 4

Tax ID # Quadrant #

Number of Bedrooms Proposed: 3 Lot Size: 2.64

Basement with Plumbing: Garage:

Water Supply: Well, Public, Community

Distance From Well: 100 ft.

Following is the minimum specifications for sewage disposal system on above captioned property. Subject to final approval.

Type of system: Conventional, Other PUMP TO EZZLA (POLYSTYRENE AGG. TRENCH)

Size of tank: Septic Tank: 1000 gallons Pump Tank: 1000 gallons

Subsurface Drainage Field: No. of ditches 2, exact length of each ditch 150 ft., width of ditches 3 ft., depth of ditches 18 in.

French Drain Required: Linear feet

Date: 1/9/03
Signed: [Signature] Environmental Health Specialist

This permit is subject to revocation if site plans or intended use change.

* MAINTAIN ALL SETBACKS
* MEET ON SITE PRIOR TO INSTALLATION

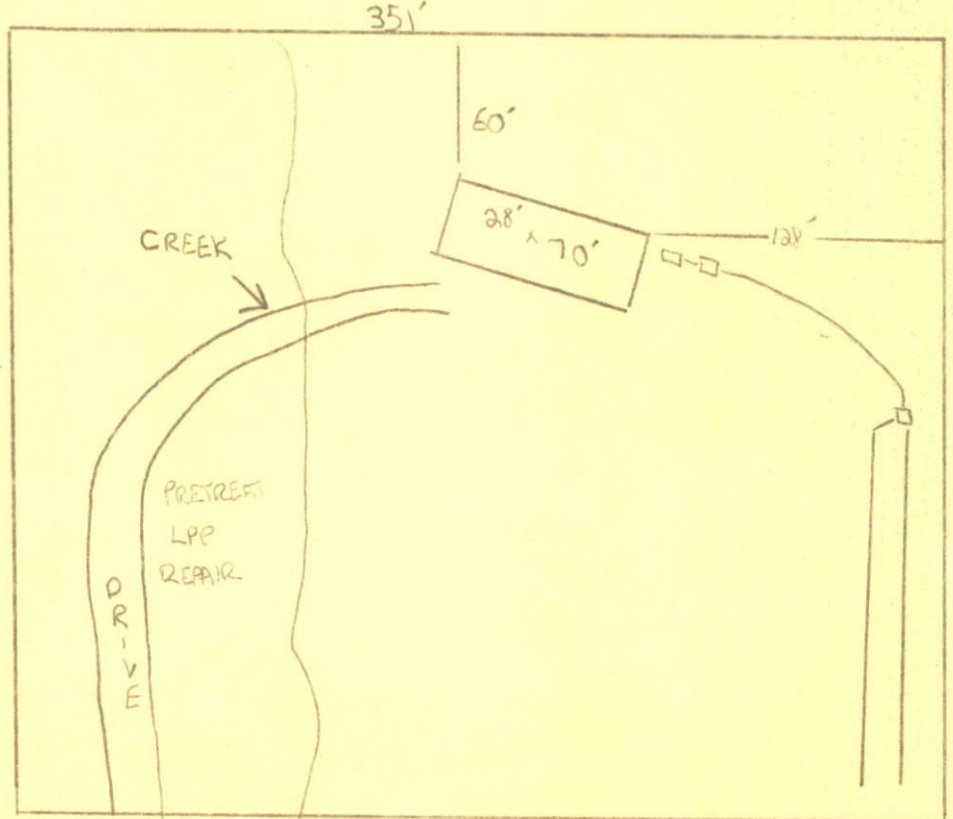

DRAWING NTS

TO NC27 ->

HARNETT COUNTY HEALTH DEPARTMENT
AUTHORIZATION TO CONSTRUCT

Authorization is hereby given to construct a wastewater system to the specifications described by Harnett County Health Department, Improvement Permit # 19809. This authorization shall be valid for a period not to exceed five (5) years from the date of issuance. This authorization will be invalid if ownership, site plans, or intended use change.

SARAH GREGORY 892-8989
Name Telephone#

14 SHANE LANE DUNN NC 28334
Address

NC27 _____
Property Location SR# Road Name

COOKERS PLACE 4 3 2.64 AC
Subdivision Lot # # Bedrooms Proposed Lot Size

TYPE OF SYSTEM

New Installation Repair Septic Tank Nitrification Lines

Conventional Other Pump To POLYSTYRENE AGGREGATE TRENCH

Basement With Plumbing Without Plumbing

Water Supply: Well Public Water Supply Minimum Well Setback: 100 Ft.

Septic Tank 1000 gal Pump Chamber 1000 gal

NITRIFICATION FIELD SPECIFICATIONS

Number of fields 1 # of lines per field 2 Length of lines 150 Ft.

Width of ditches 3 ft. Depth of ditches 18 inches

French Drain: Linear feet required _____ Depth of gravel _____

No wastewater system shall be covered or placed into use by any person until an inspection by the Harnett County Health Department has determined that the system has been installed according to the conditions of the Improvement Permit and that a valid Operations Permit has been issued.

[Signature] PS 1/9/03
Signature of Authorized Agent for Harnett County of Harnett Date