

01-5-2179

HARNETT COUNTY HEALTH DEPARTMENT

No 18552

# IMPROVEMENT PERMIT

Be it ordained by the Harnett County Board of Health as follows: Section III, Item B. "No Person shall begin construction of any building at which a septic tank system is to be used for disposal of sewage without first obtaining a written permit from the Harnett County Health Department."

Name: (owner) EO THOMAS

New Installation  Septic Tank

Property Location: SR# 1103 LINE ROAD

Repairs  Nitrification Line

Subdivision THOMAS RANCH ESTATES Lot # 9C

Tax ID # \_\_\_\_\_ Quadrant # \_\_\_\_\_

Number of Bedrooms Proposed: 3 Lot Size: 2.12 AC

Basement with Plumbing:  Garage:

Water Supply:  Well  Public  Community

Distance From Well: 100 ft.

Following is the minimum specifications for sewage disposal system on above captioned property. Subject to final approval.

Type of system:  Conventional  Other POLYSTYRENE AGGREGATE TRENCH

Size of tank: Septic Tank: 1000 gallons Pump Tank: \_\_\_\_\_ gallons

Subsurface No. of exact length width of depth of  
Drainage Field ditches 5 of each ditch 40 ft. ditches 3 ft. ditches 18 in. <sup>15.5" ON UPPER SIDE</sup> <sub>ON LOWER SIDE</sub>

French Drain Required: \_\_\_\_\_ Linear feet

Date: 6/19/01

This permit is subject to revocation if site plans or intended use change.

Signed: [Signature]  
Environmental Health Specialist

- \* MAINTAIN ALL SETBACKS
- \* RUN LINES ON CONTOUR
- \* 6" COVER MUST BE (PLACED) MAINTAINED OVER ALL TRENCHES

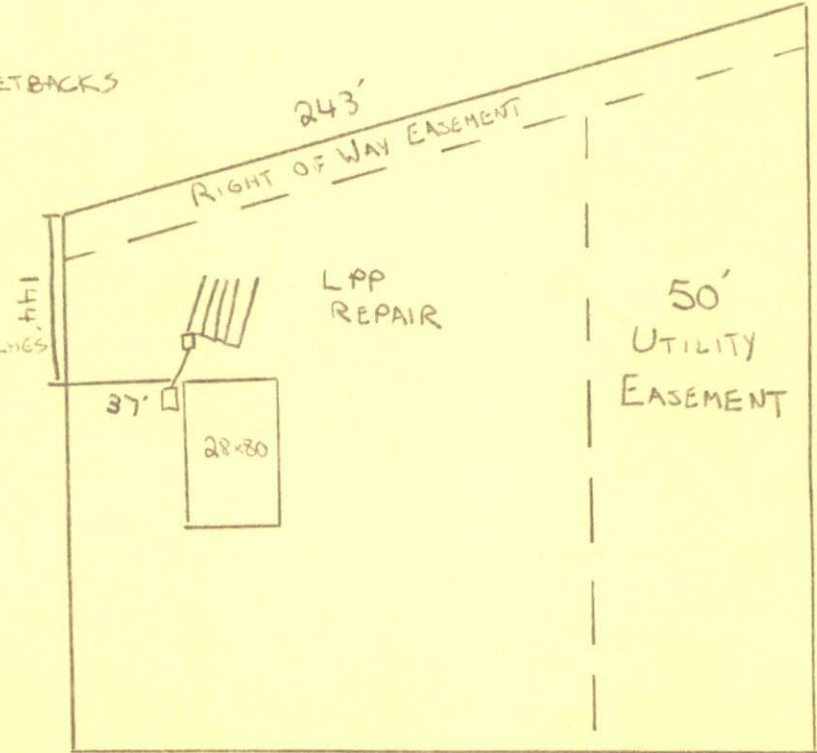

HARNETT COUNTY HEALTH DEPARTMENT  
AUTHORIZATION TO CONSTRUCT

Authorization is hereby given to construct a wastewater system to the specifications described by Harnett County Health Department Improvement Permit # 18552. This authorization shall be valid for a period not to exceed five (5) years from the date of issuance. This authorization will be invalid if ownership, site plans, or intended use change.

Owner or Authorized Agent ED THOMAS

Name: \_\_\_\_\_ Telephone # 910-245-4279

Address: 136 ED THOMAS RD CAMERON NC 28326

Property Location: SR# 1103 Road Name LINE ROAD

New Installation  Repair \_\_\_\_\_ Septic Tank  Nitrification Lines

Subdivision THOMAS RANCH ESTATES Lot # 9C

Number of Bedrooms Proposed: 3 Lot size: 2.78 AC

Basement \_\_\_\_\_ With Plumbing \_\_\_\_\_ Without Plumbing \_\_\_\_\_

Water Supply: Well  Public \_\_\_\_\_ Minimum Well Setback: 100 ft.

Type of System: Conventional \_\_\_\_\_ Other

Tank Volume: Septic Tank 1000 gallons Pump Chamber \_\_\_\_\_ gallons

Nitrification Field Specifications

Number of fields 1 Number of Lines per Field 5 Length of lines 40

Width of ditches 3 ft. Depth of ditches 18 inches

French Drain: Linear feet required \_\_\_\_\_ Depth of gravel \_\_\_\_\_

No wastewater system shall be covered or placed into use by any person until an inspection by the Harnett County Health Department has determined that the system has been installed according to the conditions of the improvement permit and that a valid operations permit has been issued.

Authorized Agent for Harnett County Health Department

Name: [Signature] Date: 6/14/01