

IMPROVEMENT PERMIT

01-50001212

Be it ordained by the Harnett County Board of Health as follows: Section III, Item B. "No Person shall begin construction of any building at which a septic tank system is to be used for disposal of sewage without first obtaining a written permit from the Harnett County Health Department."

Name: (owner) Pine Grove Dev.

New Installation Septic Tank

Property Location: SR# 1141

Repairs Nitrification Line

Subdivision Heather Brook Lot # 66

Tax ID # _____ Quadrant # _____

Number of Bedrooms Proposed: 3 (27x76) Lot Size: .73

Basement with Plumbing: Garage:

Water Supply: Well Public Community

Distance From Well: 50 ft.

Following is the minimum specifications for sewage disposal system on above captioned property. Subject to final approval.

Type of system: Conventional Other Pump To Conventional

Size of tank: Septic Tank: 1000 gallons Pump Tank: 1000 gallons

Subsurface Drainage Field No. of 3 exact length 70 width of 3 depth of 18-24 ditches of each ditch ft. ft. ditches in.

French Drain Required: _____ Linear feet

Date: 02-12-01

This permit is subject to revocation if site plans or intended use change.

Signed: Joe Westers
Environmental Health Specialist

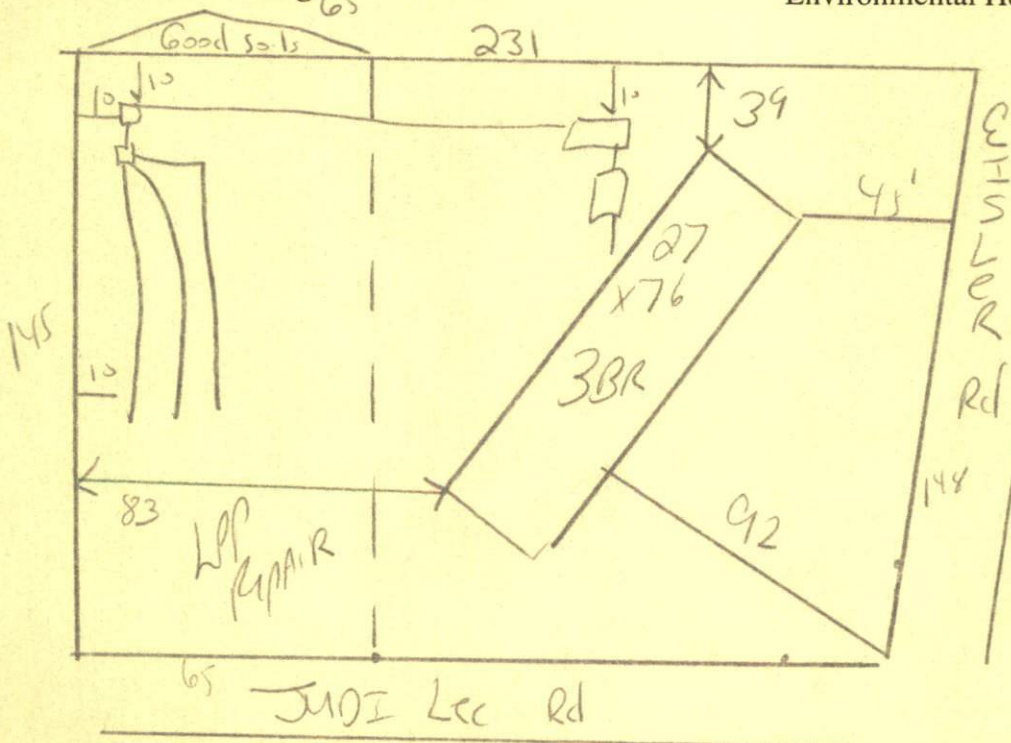

Meet onsite Before installing MAY be able to get out of a pump STUB Plumbing shallow

Do not DRIVE OR PARK ON septic system

HARNETT COUNTY HEALTH DEPARTMENT
AUTL...RIZATION TO CONS...UCT

Authorization is hereby given to construct a wastewater system to the specifications described by Harnett County Health Department Improvement Permit # 17614. This authorization shall be valid for a period not to exceed five (5) years from the date of issuance. This authorization will be invalid if ownership, site plans, or intended use change.

Owner or Authorized Agent Pine Grove Dev. Corp

Name: _____ Telephone # 498-2204

Address: _____

Property Location: SR # 1114 Road Name _____

New Installation Repair _____ Septic Tank Nitrification Lines

Subdivision Heather Brook Lot # 66

Number of Bedrooms Proposed: 3(27x76) Lot size: 0.73

Basement _____ With Plumbing _____ Without Plumbing _____

Water Supply: Well _____ Public Minimum Well Setback: _____ ft.

Type of System: Conventional _____ Other

Tank Volume: Septic Tank 1000 gallons Pump Chamber 1000 gallons

Nitrification Field Specifications

Number of fields 1 Number of Lines per Field 3 Length of lines 70

Width of ditches 3 ft. Depth of ditches 18.24 inches

French Drain: Linear feet required _____ Depth of gravel _____

No wastewater system shall be covered or placed into use by any person until an inspection by the Harnett County Health Department has determined that the system has been installed according to the conditions of the improvement permit and that a valid operations permit has been issued.

Authorized Agent for Harnett County Health Department

Name: [Signature] Date: 2-12-01

(Revised 2/96)CNSTRCT.WPD