

IMPROVEMENT PERMIT

011041

Be it ordained by the Harnett County Board of Health as follows: Section III, Item B. "No Person shall begin construction of any building at which a septic tank system is to be used for disposal of sewage without first obtaining a written permit from the Harnett County Health Department."

Name: (owner) Pine Grove Dev.
Property Location: SR# 1141
New Installation, Septic Tank, Repairs, Nitrification Line

Subdivision Heather Brooke Lot # 29

Tax ID # Quadrant #

Number of Bedrooms Proposed: 3 (27x56) Lot Size: .55Ac

Basement with Plumbing: Garage: Water Supply: Well Public Community Distance From Well: 53 ft. Note change in Drive location

Following is the minimum specifications for sewage disposal system on above captioned property. Subject to final approval.

Type of system: Conventional Other

Size of tank: Septic Tank: 1000 gallons Pump Tank: gallons

Subsurface Drainage Field No. of ditches: 2 exact length of each ditch: 120 ft. width of ditches: 3 ft. depth of ditches: 18-24 in.

French Drain Required: Linear feet

Date: 12-11-00

This permit is subject to revocation if site plans or intended use change. Signed: Environmental Health Specialist

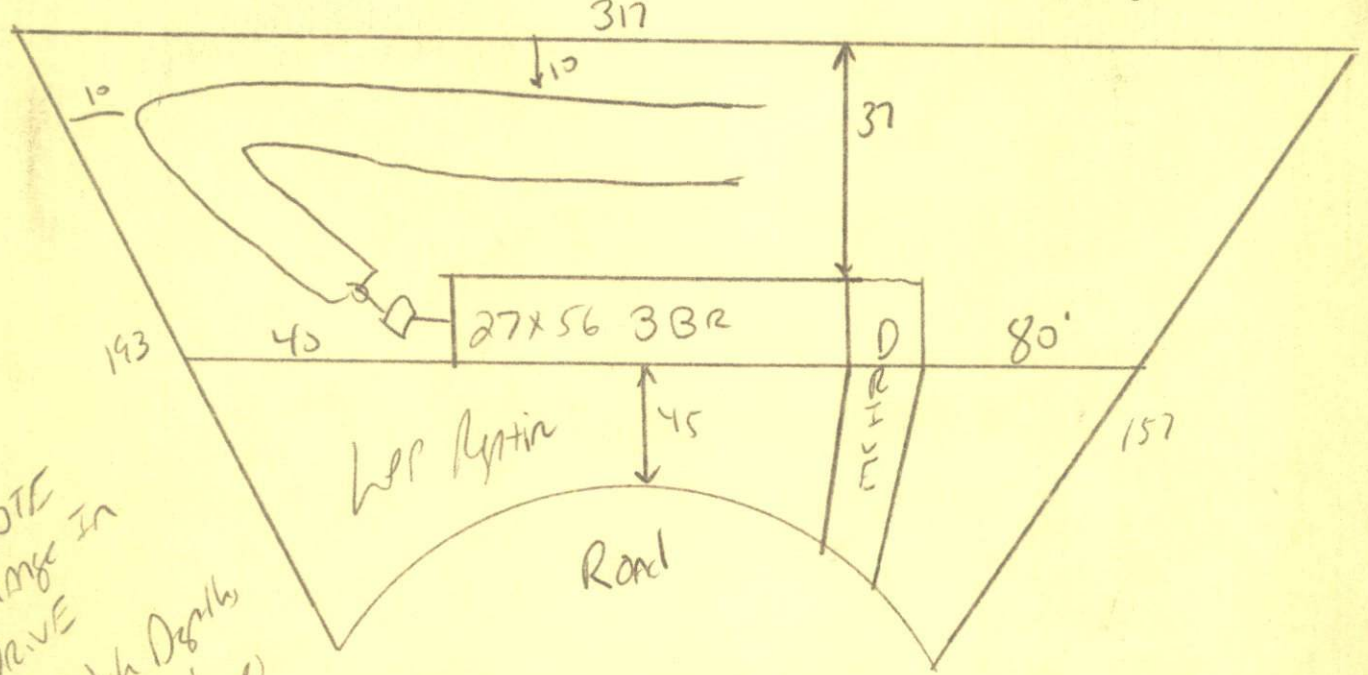

NOTE Change in Drive 18" Ditch Depth Follow Subarea Maintain All set Backs

HARNETT COUNTY HEALTH DEPARTMENT  
AUTHORIZATION TO CONSTRUCT

Authorization is hereby given to construct a wastewater system to the specifications described by Harnett County Health Department Improvement Permit # 16798. This authorization shall be valid for a period not to exceed five (5) years from the date of issuance. This authorization will be invalid if ownership, site plans, or intended use change.

Owner or Authorized Agent Pine Grove Dev.

Name: \_\_\_\_\_ Telephone # 498-2204

Address: \_\_\_\_\_

Property Location: SR# 141 Road Name \_\_\_\_\_

New Installation  Repair \_\_\_\_\_ Septic Tank  Nitrification Lines

Subdivision Heather Brooke Lot # 29

Number of Bedrooms Proposed: 3 (27x56) Lot size: 0.55 AC

Basement \_\_\_\_\_ With Plumbing \_\_\_\_\_ Without Plumbing \_\_\_\_\_

Water Supply: Well \_\_\_\_\_ Public  Minimum Well Setback: \_\_\_\_\_ ft.

Type of System: Conventional  Other \_\_\_\_\_

Tank Volume: Septic Tank 1000 gallons Pump Chamber \_\_\_\_\_ gallons

**Nitrification Field Specifications**

Number of fields 1 Number of Lines per Field 2 Length of lines 120

Width of ditches 3 ft. Depth of ditches 18 inches

French Drain: Linear feet required \_\_\_\_\_ Depth of gravel \_\_\_\_\_

No wastewater system shall be covered or placed into use by any person until an inspection by the Harnett County Health Department has determined that the system has been installed according to the conditions of the improvement permit and that a valid operations permit has been issued.

Authorized Agent for Harnett County Health Department

Name: [Signature] Date: 12-11-00