

00-50000061

IMPROVEMENT PERMIT

Be it ordained by the Harnett County Board of Health as follows: Section III, Item B. "No Person shall begin construction of any building at which a septic tank system is to be used for disposal of sewage without first obtaining a written permit from the Harnett County Health Department."

Name: (owner) Casey Lee Garter New Installation Septic Tank
Property Location: SR# 1128 Danoch Rd Repairs Nitrification Line

Subdivision _____ Lot # Tract 1

Tax ID # 01-0526-0046-01 Quadrant # 0526-47-6511

Number of Bedrooms Proposed: Three Lot Size: 31 acres 95-00

Basement with Plumbing: Garage:
Water Supply: Well Public Community 10-12-00

Distance From Well: 50' ft.

Following is the minimum specifications for sewage disposal system on above captioned property. Subject to final approval.

Type of system: Conventional Other _____

Size of tank: Septic Tank: 1000 gallons Pump Tank: _____ gallons

Subsurface Drainage Field No. of 3 exact length 100 width of 3 depth of 18
ditches of each ditch ft. ft. ft. in.

French Drain Required: _____ Linear feet

Date: 05 September 2000
Signed: Vernon R. Dodge
Environmental Health Specialist

This permit is subject to revocation if site plans or intended use change.

*Existing home to be removed
*Contractor must meet on-site prior to installation.

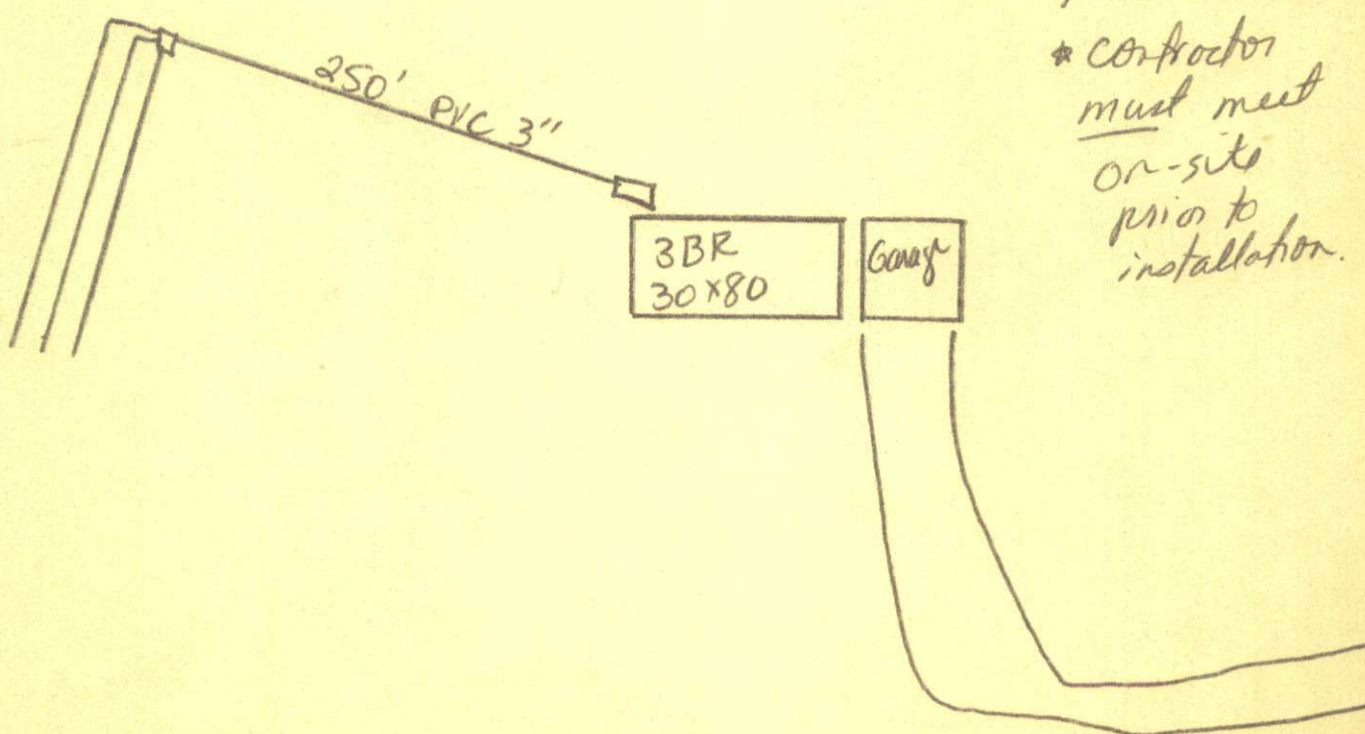

HARNETT COUNTY HEALTH DEPARTMENT
AUTHORIZATION TO CONSTRUCT

Authorization is hereby given to construct a wastewater system to the specifications described by Harnett County Health Department Improvement Permit # 18106. This authorization shall be valid for a period not to exceed five (5) years from the date of issuance. This authorization will be invalid if ownership, site plans, or intended use change.

Owner or Authorized Agent _____

Name: Gary Lee Gunter Telephone # 893-6224

Address: 1953 Danoch Rd Lillington, NC

Property Location: SR # 1128 Road Name Danoch

New Installation Repair Septic Tank Nitrification Lines

Subdivision _____ Lot # Tract 1

Number of Bedrooms Proposed: Three Lot size: _____

Basement _____ With Plumbing _____ Without Plumbing _____

Water Supply: Well _____ Public Minimum Well Setback: 50 ft.

Type of System: Conventional Other _____

Tank Volume: Septic Tank 1000 gallons Pump Chamber _____ gallons

Nitrification Field Specifications

Number of fields 1 Number of Lines per Field 3 Length of lines 100 feet

Width of ditches 3 ft. Depth of ditches 18 inches

French Drain: Linear feet required _____ Depth of gravel _____

No wastewater system shall be covered or placed into use by any person until an inspection by the Harnett County Health Department has determined that the system has been installed according to the conditions of the improvement permit and that a valid operations permit has been issued.

Authorized Agent for Harnett County Health Department
Name: Vernat R. [Signature] Date: 05 Sept 2000