

Initial Application Date: 1-21-16

Application # 1656037912

CU# _____

COUNTY OF HARNETT RESIDENTIAL LAND USE APPLICATION
Central Permitting 108 E. Front Street, Lillington, NC 27546 Phone: (910) 893-7525 ext:2 Fax: (910) 893-2793 www.harnett.org/permits

****A RECORDED SURVEY MAP, RECORDED DEED (OR OFFER TO PURCHASE) & SITE PLAN ARE REQUIRED WHEN SUBMITTING A LAND USE APPLICATION****

LANDOWNER: Wayne + Tara Blackman Mailing Address: 227 Leonard
City: Dunn State: NC Zip: 28334 Contact No: _____ Email: _____

APPLICANT: H. Allen Williams Mailing Address: 101 N Spring Branch Rd
City: Dunn State: NC Zip: 28334 Contact No: 919-524-2159 Email: _____

*Please fill out applicant information if different than landowner

CONTACT NAME APPLYING IN OFFICE: H. Allen Williams Phone # 919-524-2159

PROPERTY LOCATION: Subdivision: 227 Lane rd. Dunn N.C. 28334 Lot #: _____ Lot Size: 3.90

State Road # _____ State Road Name: Lane rd. Map Book & Page: 1

Parcel: 021527 0132 PIN: 1527-69-5350.000

Zoning: RA-30 Flood Zone: - Watershed: - Deed Book & Page: 1093, 934 Power Company*: _____

*New structures with Progress Energy as service provider need to supply premise number _____ from Progress Energy.

PROPOSED USE:

SFD: (Size _____ x _____) # Bedrooms: _____ # Baths: _____ Basement(w/wo bath): _____ Garage: _____ Deck: _____ Crawl Space: _____ Slab: _____ Slab: _____
(Is the bonus room finished? () yes () no w/ a closet? () yes () no (if yes add in with # bedrooms)

Mod: (Size _____ x _____) # Bedrooms _____ # Baths _____ Basement (w/wo bath) _____ Garage: _____ Site Built Deck: _____ On Frame _____ Off Frame _____
(Is the second floor finished? () yes () no Any other site built additions? () yes () no

Manufactured Home: _____ SW _____ DW _____ TW (Size _____ x _____) # Bedrooms: _____ Garage: _____ (site built? _____) Deck: _____ (site built? _____)

Duplex: (Size _____ x _____) No. Buildings: _____ No. Bedrooms Per Unit: _____

Home Occupation: # Rooms: _____ Use: _____ Hours of Operation: _____ #Employees: _____

Addition/Accessory/Other: (Size 16 x 44) Use: detached garage + carport Closets in addition? () yes () no

Water Supply: _____ County _____ Existing Well _____ New Well (# of dwellings using well _____) *Must have operable water before final

Sewage Supply: _____ New Septic Tank (Complete Checklist) Existing Septic Tank (Complete Checklist) _____ County Sewer

Does owner of this tract of land, own land that contains a manufactured home within five hundred feet (500') of tract listed above? () yes (X) no

Does the property contain any easements whether underground or overhead () yes (X) no

Structures (existing or proposed): Single family dwellings: Manufactured Homes: _____ Other (specify): _____

Required Residential Property Line Setbacks:

	Minimum	Actual
Front	<u>35</u>	<u>35+</u>
Rear	<u>25</u>	<u>25+</u>
Closest Side	<u>10</u>	<u>24</u>
Sidestreet/corner lot	_____	_____
Nearest Building on same lot	_____	_____

Comments: _____

SPECIFIC DIRECTIONS TO THE PROPERTY FROM LILLINGTON:

421 to Dunn TL on N. Clinton Ave continue on Jonesboro rd to Lane rd. TL go approximately 1 1/2 miles 227 Lane rd on R across from Tanning Ridge sub.

If permits are granted I agree to conform to all ordinances and laws of the State of North Carolina regulating such work and the specifications of plans submitted. I hereby state that foregoing statements are accurate and correct to the best of my knowledge. Permit subject to revocation if false information is provided.

H. Allen Williams
Signature of Owner or Owner's Agent

1-21-16
Date

It is the owner/applicants responsibility to provide the county with any applicable information about the subject property, including but not limited to: boundary information, house location, underground or overhead easements, etc. The county or its employees are not responsible for any incorrect or missing information that is contained within these applications.

This application expires 6 months from the initial date if permits have not been issued

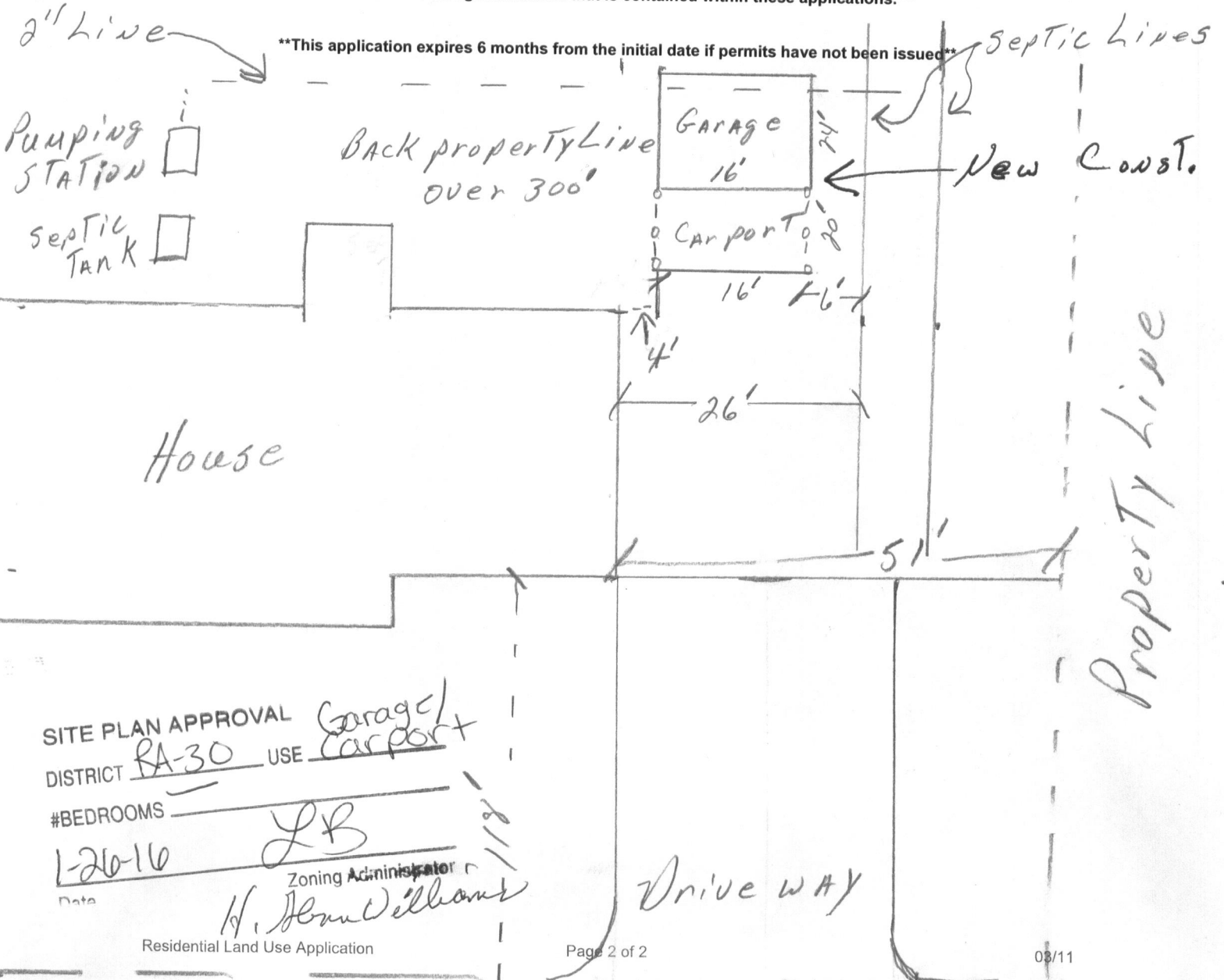

SITE PLAN APPROVAL

DISTRICT RA-30 USE Garage/Carport

#BEDROOMS LB

1-20-16
Date
Zoning Administrator
H. Allen Williams

227 Lane Rd.

HARNETT COUNTY, NORTH CAROLINA

GIS/LAND RECORDS



- AddressPoints
- Road Centerlines
- MajorRoads
- Rivers
- Parcels
- FEMA_Flood_Panel_200
- County_Boundary
- CityLimits
- FEMA_Flood_Hazard_20
 - AE
 - AEFW
 - SHADED X
- Watershed
 - WS-III
 - WS-III HQW
 - WS-III NSW
 - WS-IV
- Harnett_2013.sid
 - Red: Band_1
 - Green: Band_2
 - Blue: Band_3

Harnett County GIS
305 W Cornelius Harnett Blvd, Suite 100
Lillington NC 27546
Phone: 910-893-7523 www.harnett.org

Any use of this map shall be at the sole risk of the user of this map. Although, all effort has been taken to insure accuracy in the data presented, Harnett County makes no warranty, expressed or implied, as to the accuracy of this information represented herein. Any user of this product shall hold harmless Harnett County, its elected officials, employees and agents from and against any claim, damage, loss, action, cause of action, or liability arising from the use of this GIS product.



NAME: Wayne + Sara Blackman

APPLICATION #: 37912

This application to be filled out when applying for a septic system inspection.

County Health Department Application for Improvement Permit and/or Authorization to Construct

IF THE INFORMATION IN THIS APPLICATION IS FALSIFIED, CHANGED, OR THE SITE IS ALTERED, THEN THE IMPROVEMENT PERMIT OR AUTHORIZATION TO CONSTRUCT SHALL BECOME INVALID. The permit is valid for either 60 months or without expiration depending upon documentation submitted. (Complete site plan = 60 months; Complete plat = without expiration)

910-893-7525 option 1

CONFIRMATION # _____

Environmental Health New Septic System Code 800

- **All property irons must be made visible.** Place "pink property flags" on each corner iron of lot. All property lines must be clearly flagged approximately every 50 feet between corners.
- Place "orange house corner flags" at each corner of the proposed structure. Also flag driveways, garages, decks, out buildings, swimming pools, etc. Place flags per site plan developed at/for Central Permitting.
- Place orange Environmental Health card in location that is easily viewed from road to assist in locating property.
- If property is thickly wooded, Environmental Health requires that you clean out the **undergrowth** to allow the soil evaluation to be performed. Inspectors should be able to walk freely around site. **Do not grade property.**
- **All lots to be addressed within 10 business days after confirmation. \$25.00 return trip fee may be incurred for failure to uncover outlet lid, mark house corners and property lines, etc. once lot confirmed ready.**
- After preparing proposed site call the voice permitting system at 910-893-7525 option 1 to schedule and use code **800** (after selecting notification permit if multiple permits exist) for Environmental Health inspection. Please note confirmation number given at end of recording for proof of request.
- Use Click2Gov or IVR to verify results. Once approved, proceed to Central Permitting for permits.

Environmental Health Existing Tank Inspections Code 800

- Follow above instructions for placing flags and card on property.
- Prepare for inspection by removing soil over **outlet end** of tank as diagram indicates, and lift lid straight up (*if possible*) and then **put lid back in place.** (Unless inspection is for a septic tank in a mobile home park)
- **DO NOT LEAVE LIDS OFF OF SEPTIC TANK**
- After uncovering **outlet end** call the voice permitting system at 910-893-7525 option 1 & select notification permit if multiple permits, then use code **800** for Environmental Health inspection. Please note confirmation number given at end of recording for proof of request.
- Use Click2Gov or IVR to hear results. Once approved, proceed to Central Permitting for remaining permits.

SEPTIC

If applying for authorization to construct please indicate desired system type(s): can be ranked in order of preference, must choose one.

- Accepted Innovative Conventional Any
 Alternative Other _____

The applicant shall notify the local health department upon submittal of this application if any of the following apply to the property in question. If the answer is "yes", applicant **MUST ATTACH SUPPORTING DOCUMENTATION**:

- YES NO Does the site contain any Jurisdictional Wetlands?
 YES NO Do you plan to have an irrigation system now or in the future?
 YES NO Does or will the building contain any drains? Please explain. _____
 YES NO Are there any existing wells, springs, waterlines or Wastewater Systems on this property?
 YES NO Is any wastewater going to be generated on the site other than domestic sewage?
 YES NO Is the site subject to approval by any other Public Agency?
 YES NO Are there any Easements or Right of Ways on this property?
 YES NO Does the site contain any existing water, cable, phone or underground electric lines?

If yes please call No Cuts at 800-632-4949 to locate the lines. This is a free service.

I Have Read This Application And Certify That The Information Provided Herein Is True, Complete And Correct. Authorized County And State Officials Are Granted Right Of Entry To Conduct Necessary Inspections To Determine Compliance With Applicable Laws And Rules.

I Understand That I Am Solely Responsible For The Proper Identification And Labeling Of All Property Lines And Corners And Making The Site Accessible So That A Complete Site Evaluation Can Be Performed.

H. Glenn Williams
PROPERTY OWNERS OR OWNERS LEGAL REPRESENTATIVE SIGNATURE (REQUIRED)

1-21-16
DATE

09/09/11

Application #

37912

Harnett County Central Permitting

PO Box 65 Lillington NC 27546

910 893 7525 Fax 910 893 2793 www.harnett.org/permits

Each section below to be filled out by whomever performing work. Must be owner or licensed contractor. Address company name & phone must match.

Application for Residential Building and Trades Permit

Owner's Name _____ Date _____

Site Address _____ Phone _____

Directions to job site from Lillington _____

Subdivision _____ Lot _____

Description of Proposed Work _____ # of Bedrooms _____

Heated SF _____ Unheated SF _____ Finished Bonus Room? _____ Crawl Space _____ Slab _____

General Contractor Information

H. Alan Wilham
Building Contractor's Company Name

919-524-2139
Telephone

101 N Spring Branch Rd.
Address
24975

Email Address

License # _____

Electrical Contractor Information

Description of Work _____ Service Size _____ Amps T-Pole _____ Yes _____ No

J. Leo Electric
Electrical Contractor's Company Name

Telephone

Address

Email Address

License # _____

Mechanical/HVAC Contractor Information

Description of Work _____

Mechanical Contractor's Company Name

Telephone

Address

Email Address

License # _____

Plumbing Contractor Information

Description of Work _____ # Baths _____

Plumbing Contractor's Company Name

Telephone

Address

Email Address

License # _____

Insulation Contractor Information

Insulation Contractor's Company Name & Address

Telephone

***NOTE General Contractor must fill out and sign the second page of this application**

I hereby certify that I have the authority to make necessary application that the application is correct and that the construction will conform to the regulations in the Building Electrical Plumbing and Mechanical codes and the Harnett County Zoning Ordinance I state the information on the above contractors is correct as known to me and that **by signing below I have obtained all subcontractors permission to obtain these permits** and if **any** changes occur including listed contractors site plan number of bedrooms building and trade plans Environmental Health permit changes or proposed use changes I certify it is my responsibility to notify the Harnett County Central Permitting Department of any and all changes

EXPIRED PERMIT FEES - 6 Months to 2 years permit re-issue fee is \$150 00 After 2 years re-issue fee is as per current fee schedule

H. Steve Williams
Signature of Owner/Contractor/Officer(s) of Corporation

3-8-16
Date

Affidavit for Worker's Compensation N C G S 87-14

The undersigned applicant being the

General Contractor Owner Officer/Agent of the Contractor or Owner

Do hereby confirm under penalties of perjury that the person(s) firm(s) or corporation(s) performing the work set forth in the permit

Has three (3) or more employees and has obtained workers compensation insurance to cover them

Has one (1) or more subcontractors(s) and has obtained workers compensation insurance to cover them

Has one (1) or more subcontractors(s) who has their own policy of workers compensation insurance covering themselves

Has no more than two (2) employees and no subcontractors

While working on the project for which this permit is sought it is understood that the Central Permitting Department issuing the permit may require certificates of coverage of worker s compensation insurance prior to issuance of the permit and at any time during the permitted work from any person firm or corporation carrying out the work

Company or Name Williams Building + Home Repair

Sign w/Title H. Steve Williams Date 3-8-16

HARNETT COUNTY CENTRAL PERMITTING
P.O. BOX 65
LILLINGTON, NC 27546
For Inspections Call: (910) 893-7525 Fax: (910) 893-2793
Bldg Insp scheduled before 2pm available next business day.

Application Number 16-50037912 Page 3
Property Address 227 LANE RD Date 3/08/16
PARCEL NUMBER 02-1527- - -0132- - -
Application description . . . CP GARAGE/CARPORT RESIDENTIAL DETACHED
Subdivision Name
Property Zoning RES/AGRI DIST - RA-30

Required Inspections

Seq	Phone Insp#	Insp Code	Description	Initials	Date
Permit type RESIDENTIAL BUILDING PERMIT					
999	103	B103	R*BLDG FOUND & TEMP SVC POLE	_____	___/___/___
999	111	B111	R*BLDG SLAB INSP/TEMP SVC POLE	_____	___/___/___
999	105	B105	R*OPEN FLOOR	_____	___/___/___
999	309	P309	R*PLUMB UNDER SLAB	_____	___/___/___
999	101	B101	R*BLDG FOOTING / TEMP SVC POLE	_____	___/___/___
999	429	R429	FOUR TRADE FINAL	_____	___/___/___
999	425	R425	FOUR TRADE ROUGH IN	_____	___/___/___
999	131	R131	ONE TRADE FINAL	_____	___/___/___
999	125	R125	ONE TRADE ROUGH IN	_____	___/___/___
999	329	R329	THREE TRADE FINAL	_____	___/___/___
999	325	R325	THREE TRADE ROUGH IN	_____	___/___/___
999	229	R229	TWO TRADE FINAL	_____	___/___/___
999	225	R225	TWO TRADE ROUGH IN	_____	___/___/___
Permit type RESIDENTIAL ELECTRICAL PERMIT					
999	211	E211	R*ELEC ABOVE CEILING	_____	___/___/___
999	217	E217	R*ELEC RECONNECT	_____	___/___/___
999	205	E205	R*ELEC UNDER SLAB	_____	___/___/___
999	215	E215	R*ELEC. UND. POOL	_____	___/___/___
999	213	E213	R*ELECTRICAL UNDERGROUND	_____	___/___/___
999	131	R131	ONE TRADE FINAL	_____	___/___/___
999	125	R125	ONE TRADE ROUGH IN	_____	___/___/___
Permit type LAND USE PERMIT					
999	818	Z818	PZ*ZONING INSPECTION	_____	___/___/___
999	820	Z820	PZ*ZONING/FINAL INSPECTION	_____	___/___/___

HARNETT COUNTY CENTRAL PERMITTING

P.O. BOX 65

LILLINGTON, NC 27546

For Inspections Call: (910) 893-7525 Fax: (910) 893-2793

Bldg Insp scheduled before 2pm available next business day.

Application Number	16-50037912	Date	3/08/16
Property Address	227 LANE RD		
PARCEL NUMBER	02-1527- - -0132- - -		
Application type description	CP GARAGE/CARPORT RESIDENTIAL DETACHED		
Subdivision Name			
Property Zoning	RES/AGRI DIST - RA-30		

Owner

BLACKMAN JOHNNIE WAYNE & SARAH
 RT 3 BOX 383
 DUNN NC 28334

Contractor

WILLIAMS HARRY GLENN
 101 N SPRING BRANCH RD
 DUNN NC 28334
 (910) 567-6094

Applicant

WILLIAMS GLENN
 101 N. SPRING BRANCH RD
 DUNN NC 28334
 (919) 524-2159

--- Structure Information 000 000 16X44 DETACHED GARAGE & CARPORT

Flood Zone	FLOOD ZONE X		
Other struct info	PROPOSED USE		GARAGE/CARPORT
	SEPTIC - EXISTING?		EXIST
	WATER SUPPLY		COUNTY

Permit	RESIDENTIAL BUILDING PERMIT		
Additional desc			
Phone Access Code	1129022		
Issue Date	3/08/16	Valuation	26048
Expiration Date	3/08/17		

Permit	RESIDENTIAL ELECTRICAL PERMIT		
Additional desc			
Phone Access Code	1129410		
Issue Date	3/08/16	Valuation	0
Expiration Date	3/08/17		

Permit	LAND USE PERMIT		
Additional desc			
Phone Access Code	1129402		
Issue Date	3/08/16	Valuation	0
Expiration Date	9/04/16		

Special Notes and Comments

T/S: 01/26/2016 11:23 AM LBENNETT --
 421 TO DUNN TAKE LEFT ON NORTH CLINTON

HARNETT COUNTY CENTRAL PERMITTING
P.O. BOX 65
LILLINGTON, NC 27546
For Inspections Call: (910) 893-7525 Fax: (910) 893-2793
Bldg Insp scheduled before 2pm available next business day.

Application Number 16-50037912 Page 2
Date 3/08/16

Special Notes and Comments
AVENUE - CONTINUE ON JONESBORO RD TO
LOVE RD TAKE LEFT GO APPROX 1 1/2 MILES
227 LANE RD ON RIGHT ACROSS FROM
TANNING RIDGE SUB.
