



December 17, 2008

[www.harnett.org](http://www.harnett.org)

Eric Demoranville  
235 Papoose Trail  
Lillington, NC 27546

Harnett County Government Complex  
307 Cornelius Harnett Boulevard  
Lillington, NC 27546

ph: 910-893-7547  
fax: 910-893-9371

**Re: Harnett County Land Use Application HTE #08-5-21354**

Dear Mr. Demoranville,

The Harnett County Department of Public Health, Environmental Health Division on December 16, 2008, evaluated the above referenced property at the site designated on the plat/site plan that accompanied your existing tank application. According to your application requesting a garage, the evaluation was done in accordance with the laws and rules governing wastewater systems in North Carolina General Statute 18A.1950 including related statutes and Title 15A, Subchapter 18A, of the North Carolina Administrative Code, Rule.1950 and related rules.

Based on the criteria set out in Title 15A, Subchapter 18A, of the North Carolina Administrative Code, Rules .1950, the evaluation indicated that the site is **UNSUITABLE** for the addition requested. Therefore, your request for an existing tank is **DENIED**. The site is denied based on the following:

**15A NCAC 18A.1950 a(16) Any swimming pool must be 15' from any part of septic system.**

**15A NCAC 18.1945 (b) Each lot shall have original septic system plus repair area.**

**15A NCAC 18A.1950 (10) – Any building to be 5' from drain line.**

***The garage is staked out on top of the drain field. (See the attached map showing approximate drain field and repair area location.)***

If you should have any questions or concerns I can be contacted Monday through Friday from 8am – 9am at 910-893-7547.

Sincerely,

Joe West, R. S.  
Environmental Health Specialist  
Harnett County Department of Public Health

JW/sgs

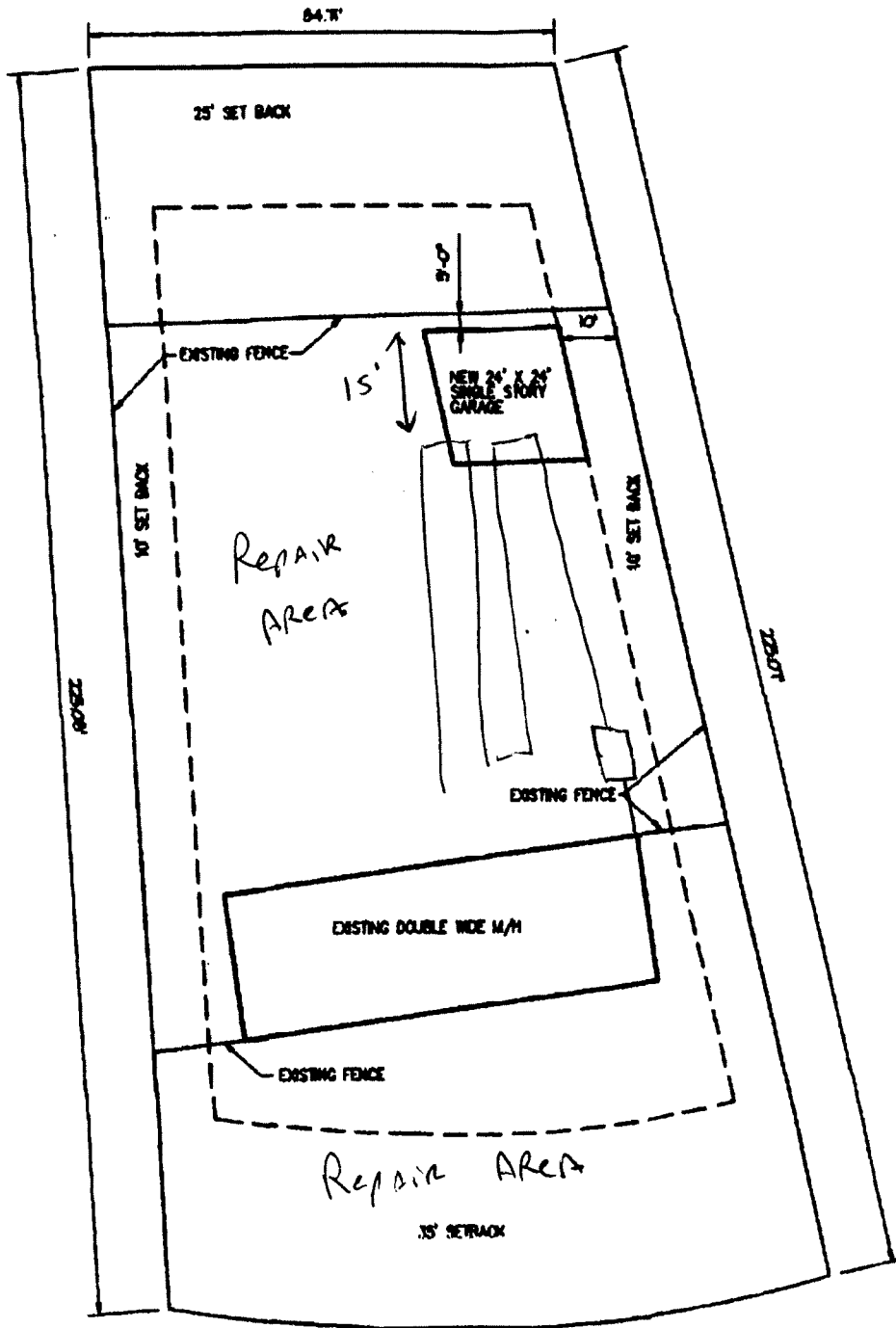

UPDATED PLOT PLAN  
 235 PAPOOSE TRAIL  
 LOT 35  
 CHEROKEE RIDGE  
 HARNETT COUNTY, NC

DECEMBER 7, 2008  
 SCALE: 1/32" = 1'-0"