

HTE# 08-5-1977

Harnett County Department of Public Health

24737

Improvement Permit

A building permit cannot be issued with only an Improvement Permit

ISSUED TO: Mt. Pisgah Presbyterian Ch PROPERTY LOCATION: Mt. Pisgah Church Rd
 NEW REPAIR EXPANSION SUBDIVISION _____ LOT # _____
 Type of Structure: FELLOWSHIP HALL (96'x52') Site Improvements required prior to Construction Authorization Issuance:
 Proposed Wastewater System Type: CONVENTIONAL C.A. TO BE ISSUED AFTER PROJECTED DAILY
 Projected Daily Flow: 1500 GPD FLOW HAS BEEN FINALIZED. 1500 GPD
 Number of bedrooms: _____ Number of Occupants: 300 max IS THE PROJECTED MAXIMUM DAILY FLOW
 Basement Yes No
 Pump Required: Yes No May be required based on final location and elevations of facilities
 Type of Water Supply: Community Public Well Distance from well 100 feet Permit valid for: Five years
 Permit conditions: _____ No expiration

Authorized State Agent: [Signature] Date: 5/16/08 SEE ATTACHED SITE SKETCH

The issuance of this permit by the Health Department in no way guarantees the issuance of other permits. The permit holder is responsible for checking with appropriate governing bodies in meeting their requirements. This site is subject to revocation if the site plan, plat, or the intended use changes. The Improvement Permit shall not be affected by a change in ownership of the site. This permit is subject to compliance with the provisions of the Laws and Rules for Sewage Treatment and Disposal and to conditions of this permit.

Construction Authorization

(Required for Building Permit)

The construction and installation requirements of Rules .1950, .1952, .1954, .1955, .1956, .1957, .1958, and .1959 are incorporated by references into this permit and shall be met. Systems shall be installed in accordance with the attached system layout.

ISSUED TO: Mt. Pisgah Presbyterian Ch. PROPERTY LOCATION: Mt. Pisgah Church Rd
 Facility Type: FELLOWSHIP HALL New Expansion Repair
 Basement? Yes No Basement Fixtures? Yes No
 Type of Wastewater System** CONVENTIONAL (Initial) Wastewater Flow: 400 GPD
 (See note below, if applicable CONVENTIONAL (Repair))

Installation Requirements/Conditions

Septic Tank Size <u>1000</u> gallons	Number of trenches <u>3</u>	Trench Spacing: <u>9</u> Feet on Center
Pump Tank Size _____ gallons	Exact length of each trench <u>133</u> feet	Soil Cover: <u>6-18</u> inches
	Trenches shall be installed on contour at a	(Maximum soil cover shall not exceed
	Maximum Trench Depth of: <u>18-30</u> inches	36" above the trench bottom)
	(Trench bottoms shall be level to +/- 1/4" in all directions)	
Pump Requirements: _____ ft. TDH vs. _____ GPM		Aggregate Depth: <u>6</u> inches below pipe
		<u>2</u> inches above pipe
Conditions: <u>DAILY FLOW BASED ON WATER DATA SUPPLIED BY APPLICANT</u>		<u>12</u> inches total

**If applicable: I understand the system type specified is different from the type specified on the application. I accept the specifications of this permit.

Owner/Legal Representative Signature: _____ Date: _____

This Construction Authorization is subject to revocation if the site plan, plat, or the intended use changes. The Construction Authorization shall not be transferred when there is a change in ownership of the site. This Construction Authorization is subject to compliance with the provisions of the Laws and Rules for Sewage Treatment and Disposal and to the conditions of this permit. SEE ATTACHED SITE SKETCH

Authorized State Agent: [Signature] Date: 7/18/08
Construction Authorization Expiration Date: 7/18/13

HTE# 08-5-19777

Permit # 24737

Harnett County Department of Public Health Site Sketch

ISSUED TO: Mt. Pisgah Presbyterian Church SUBDIVISION Mt. Pisgah Church Rd LOT # _____

Authorized State Agent: [Signature] RS (OLIVER TOLKSDORF) Date: 7/18/08

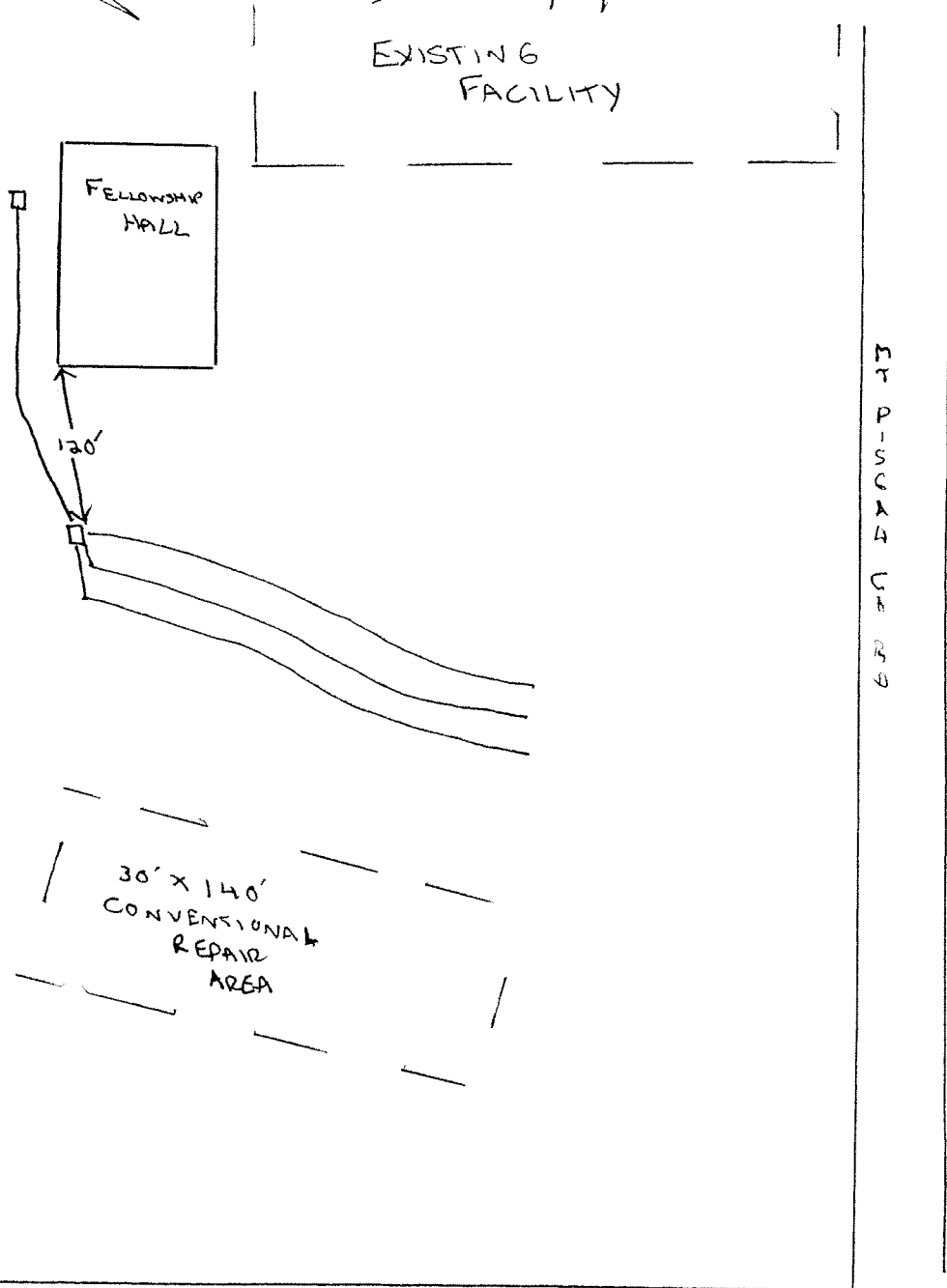

McArthur Rd