

Initial Application Date: 3/20/18

Application # 1850043596

CU# _____

COUNTY OF HARNETT RESIDENTIAL LAND USE APPLICATION

Central Permitting 108 E. Front Street, Lillington, NC 27546 Phone: (910) 893-7525 ext:2 Fax: (910) 893-2793 www.harnett.org/permits

"A RECORDED SURVEY MAP, RECORDED DEED (OR OFFER TO PURCHASE) & SITE PLAN ARE REQUIRED WHEN SUBMITTING A LAND USE APPLICATION"

LANDOWNER: Kelly A. Yaeger & Paul Mailing Address: 51 MAGNOLIA FARM DR. FUQUAY-VARINA, NC
City: UQUAY-VARINA State: NC Zip: 27526 Contact No: (850)826-1396 Email: johnkozii@gmail.com

APPLICANT: Chris Yarbrough (NC Solar Now, Inc.) Mailing Address: 3401-101 Atlantic Ave
City: Raleigh State: NC Zip: 27604 Contact No: 919-833-9096 Email: permitting@ncsolarnow.com
*Please fill out applicant information if different than landowner

CONTACT NAME APPLYING IN OFFICE: Chris Yarbrough Phone # 919-833-9096

PROPERTY LOCATION: Subdivision: _____ Lot #: - Lot Size: 23.27
State Road # 1415 State Road Name: Rawls Church Rd Map Book & Page: 2005, 189
Parcel: 0800654 0247 01 PIN: 0654-18-2056-020
Zoning: R40 Flood Zone: X Watershed: WSIV Deed Book & Page: 2004, 558 Power Company*: Duke Energy
*New structures with Progress Energy as service provider need to supply premise number _____ from Progress Energy.

PROPOSED USE:

- SFD: (Size _____ x _____) # Bedrooms: _____ # Baths: _____ Basement(w/wo bath): _____ Garage: _____ Deck: _____ Crawl Space: _____ Slab: _____ Slab: _____
(Is the bonus room finished? () yes () no w/ a closet? () yes () no (if yes add in with # bedrooms)
- Mod: (Size _____ x _____) # Bedrooms _____ # Baths _____ Basement (w/wo bath) _____ Garage: _____ Site Built Deck: _____ On Frame _____ Off Frame _____
(Is the second floor finished? () yes () no Any other site built additions? () yes () no
- Manufactured Home: _____ SW _____ DW _____ TW (Size _____ x _____) # Bedrooms: _____ Garage: _____ (site built? _____) Deck: _____ (site built? _____)
- Duplex: (Size _____ x _____) No. Buildings: _____ No. Bedrooms Per Unit: _____
- Home Occupation: # Rooms: _____ Use: _____ Hours of Operation: _____ #Employees: _____
- Addition/Accessory/Other: (Size _____ x _____) Use: Ground-mounted Solar PV Array (approx. 668 sq. ft.) Closets in addition? () yes () no

Water Supply: County _____ Existing Well _____ New Well (# of dwellings using well _____) *Must have operable water before final
Sewage Supply: _____ New Septic Tank (Complete Checklist) Existing Septic Tank (Complete Checklist) _____ County Sewer
Does owner of this tract of land, own land that contains a manufactured home within five hundred feet (500') of tract listed above? () yes () no
Does the property contain any easements whether underground or overhead () yes () no
Structures (existing or proposed): Single family dwellings: 1 Manufactured Homes: _____ Other (specify): _____

Required Residential Property Line Setbacks:

	Minimum	Actual
Front	_____	<u>500</u>
Rear	_____	<u>650</u>
Closest Side	_____	<u>200</u>
Sidestreet/corner lot	_____	_____
Nearest Building on same lot	_____	<u>170</u>

Comments: _____

SPECIFIC DIRECTIONS TO THE PROPERTY FROM LILLINGTON: _____

Attached Separately

If permits are granted I agree to conform to all ordinances and laws of the State of North Carolina regulating such work and the specifications of plans submitted. I hereby state that foregoing statements are accurate and correct to the best of my knowledge. Permit subject to revocation if false information is provided.



Signature of Owner or Owner's Agent

3/18/18

Date

*****It is the owner/applicants responsibility to provide the county with any applicable information about the subject property, including but not limited to: boundary information, house location, underground or overhead easements, etc. The county or its employees are not responsible for any incorrect or missing information that is contained within these applications.*****

****This application expires 6 months from the initial date if permits have not been issued****

Application # _____

Harnett County Central Permitting

PO Box 65 Lillington, NC 27546 - Ph: 910-893-7525 - Fx: 910-893-2793 - www.harnett.org/permits
Certification of Work Performed By Owner/Contractor
(Individual Trade Application)

Owner (s) of Structure: Kelly A. Yaeger : Edwin Phone: (850)826-1396

Owner (s) Mailing Address: 51 MAGNOLIA FARM DR. FUQUAY-VARINA, NC 27526

Land Owner Name (s): Kelly A. Yaeger Phone: 803-719-1685

Construction or Site Address: 51 MAGNOLIA FARM DR. FUQUAY-VARINA, NC 27526

PIN # 0054-18-2056.000 Parcel # 080654 024701

PA-40

Job Cost: \$1000 Description of Work to be done Installation of a roof-mounted solar pv array

Mechanical: New Unit With Ductwork New Unit Without Ductwork Gas Piping Other

Electrical*: 200 Amp <200 Amp Service Change Service Reconnect Other
* For Progress Energy customers we need the premise number

Plumbing: Water/Sewer Tap Number of Baths Water Heater

Specific Directions to Job from Lillington:
Attached seperately

Subdivision: _____ Lot #: _____

I Karl Stupka will provide the Electrical labor on this structure.
(Contractors Name) (Trade)

I am the building owner or my NC state license number is 31533-L, which entitles me to perform such work on the above structure legally. All work shall comply with the State Building Code and all other applicable State and local laws, ordinances and regulations.

NC SOLAR NOW
Contractor's Company Name
3401-101 Atlantic Ave Raleigh NC 27604
Address
31533-L
License #

919-833-9096
Telephone
Karl@ncsolarnow.com
Email Address

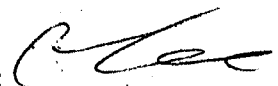
Structure Owner / Contractor Signature:  Date: 3/19/18

By signing this application you affirm that you have obtained permission from the above listed license holder to purchase permits on their behalf. If doing the work as owner you understand that you cannot rent, lease or sell the listed property for 12 months after completion of the listed work.

***Company name, address, & phone must match information on license**

NAME: Chris Yarbrough

APPLICATION #: 43596

This application to be filled out when applying for a septic system inspection.

County Health Department Application for Improvement Permit and/or Authorization to Construct

IF THE INFORMATION IN THIS APPLICATION IS FALSIFIED, CHANGED, OR THE SITE IS ALTERED, THEN THE IMPROVEMENT PERMIT OR AUTHORIZATION TO CONSTRUCT SHALL BECOME INVALID. The permit is valid for either 60 months or without expiration depending upon documentation submitted. (Complete site plan = 60 months; Complete plat = without expiration)

910-893-7525 option 1

CONFIRMATION # 026815-11
3120118

- Environmental Health New Septic System** Code 800
 - **All property irons must be made visible.** Place "pink property flags" on each corner iron of lot. All property lines must be clearly flagged approximately every 50 feet between corners.
 - Place "orange house corner flags" at each corner of the proposed structure. Also flag driveways, garages, decks, out buildings, swimming pools, etc. Place flags per site plan developed at/for Central Permitting.
 - Place orange Environmental Health card in location that is easily viewed from road to assist in locating property.
 - If property is thickly wooded, Environmental Health requires that you clean out the undergrowth to allow the soil evaluation to be performed. Inspectors should be able to walk freely around site. **Do not grade property.**
 - **All lots to be addressed within 10 business days after confirmation. \$25.00 return trip fee may be incurred for failure to uncover outlet lid, mark house corners and property lines, etc. once lot confirmed ready.**
 - After preparing proposed site call the voice permitting system at 910-893-7525 option 1 to schedule and use code 800 (after selecting notification permit if multiple permits exist) for Environmental Health inspection. Please note confirmation number given at end of recording for proof of request.
 - Use Click2Gov or IVR to verify results. Once approved, proceed to Central Permitting for permits.
- Environmental Health Existing Tank Inspections** Code 800
 - Follow above instructions for placing flags and card on property.
 - Prepare for inspection by removing soil over outlet end of tank as diagram indicates, and lift lid straight up (*if possible*) and then **put lid back in place.** (Unless inspection is for a septic tank in a mobile home park)
 - **DO NOT LEAVE LIDS OFF OF SEPTIC TANK**
 - After uncovering outlet end call the voice permitting system at 910-893-7525 option 1 & select notification permit if multiple permits, then use code 800 for Environmental Health inspection. Please note confirmation number given at end of recording for proof of request.
 - Use Click2Gov or IVR to hear results. Once approved, proceed to Central Permitting for remaining permits.

SEPTIC

If applying for authorization to construct please indicate desired system type(s): can be ranked in order of preference, must choose one.

- Accepted Innovative Conventional Any
 Alternative Other PO for Solar Panels

The applicant shall notify the local health department upon submittal of this application if any of the following apply to the property in question. If the answer is "yes", applicant **MUST ATTACH SUPPORTING DOCUMENTATION**:

- YES NO Does the site contain any Jurisdictional Wetlands?
 YES NO Do you plan to have an irrigation system now or in the future?
 YES NO Does or will the building contain any drains? Please explain. _____
 YES NO Are there any existing wells, springs, waterlines or Wastewater Systems on this property?
 YES NO Is any wastewater going to be generated on the site other than domestic sewage?
 YES NO Is the site subject to approval by any other Public Agency?
 YES NO Are there any Easements or Right of Ways on this property?
 YES NO Does the site contain any existing water, cable, phone or underground electric lines?

If yes please call No Cuts at 800-632-4949 to locate the lines. This is a free service.

I Have Read This Application And Certify That The Information Provided Herein Is True, Complete And Correct. Authorized County And State Officials Are Granted Right Of Entry To Conduct Necessary Inspections To Determine Compliance With Applicable Laws And Rules.

I Understand That I Am Solely Responsible For The Proper Identification And Labeling Of All Property Lines And Corners And Making The Site Accessible So That A Complete Site Evaluation Can Be Performed.

[Signature]
PROPERTY OWNERS OR OWNERS LEGAL REPRESENTATIVE SIGNATURE (REQUIRED)

3-19-18
DATE

ENGINEER:

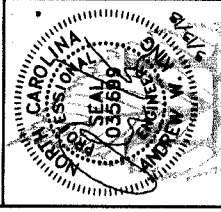

MODEL ENERGY
 702 E. FRANKLIN ST.
 RALEIGH, NC 27604
 919-274-9905
 MODELENERGY1.COM

JOB TITLE: P-1194

NEW SOLAR PV SYSTEM
 11.04 KW DC INPUT
 10.0 KW AC EXPORT
 Kelly A. Yeager
 51 MAGNOLIA FARM DR.
 FUQUAY-VARINA, NC 27526

CLIENT:

ISSUED FOR:	DATE:
PERMIT	1/3/17

SITE INFORMATION

PV2.1

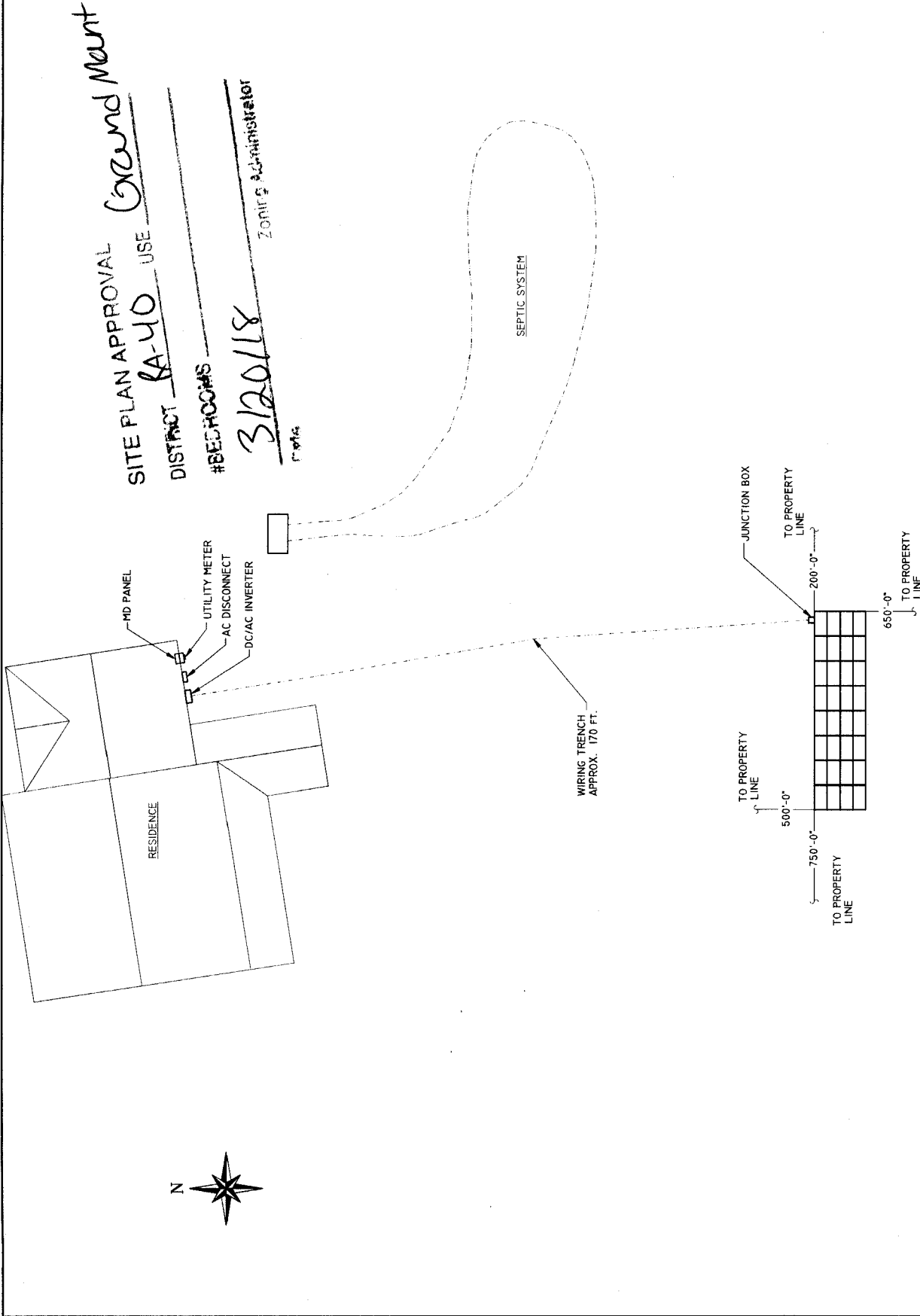

SITE PLAN APPROVAL Grand Mount
 DISTRICT RA-40 USE Grand Mount
 #BEDROOMS 3
 Zoning Administrator 3/20/18



VICINITY MAP

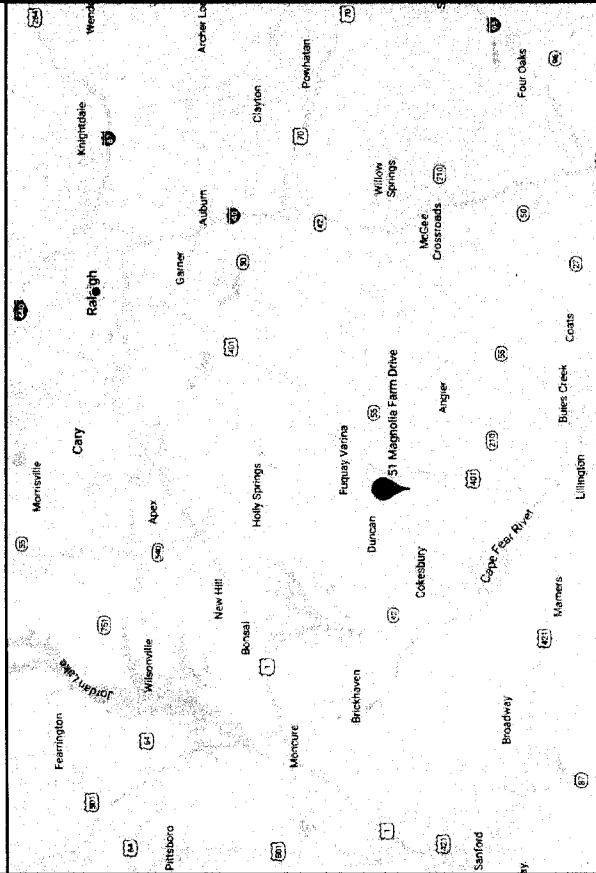

PROPERTY MAP

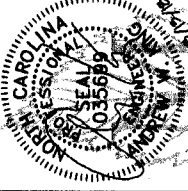

ENGINEER: 

MODEL ENERGY
 702 E. FRANKLIN ST.
 RALEIGH, NC 27604
 919-274-9905
 MODELENERGY1.COM

R1194

NEW SOLAR PV SYSTEM
 11.04 KW DC INPUT
 10.0 KW AC EXPORT

CLIENT:
 Kelly A. Yaeger
 51 MAGNOLIA FARM DR.
 FUQUAY-PARINA, NC 27526

SOLAR NOW

ISSUED FOR: PERMIT
 DATE: 1/3/17

PROJECT INFORMATION
PV1.1

ABBREVIATIONS	CODE REFERENCES
<p>A AMPERE AC ALTERNATING CURRENT DC DIRECT CURRENT EGC EQUIPMENT GROUNDING CONDUCTOR EMT ELECTRICAL METAL TUBING GALV GALVANIZED GEC GROUNDING ELECTRODE CONDUCTOR GND GROUND I CURRENT I_{MP} CURRENT AT MAXIMUM POWER I_{SC} SHORT-CIRCUIT CURRENT KVA KILOWATT AMPERE KW KILOWATT MAX MAXIMUM MIN MINIMUM MCB MAIN CIRCUIT BREAKER MLO MAIN LUG ONLY NOM NOMINAL NTS NOT TO SCALE P_{NOM} NOMINAL POWER PV PHOTOVOLTAIC SN SOLAR NOON ST STANDARD TEST CONDITIONS TYP TYPICAL V VOLT V_{MP} VOLTAGE AT MAXIMUM POWER V_{OC} OPEN-CIRCUIT VOLTAGE W WATT</p>	<p>2014 NATIONAL ELECTRIC CODE 2012 NORTH CAROLINA RESIDENTIAL CODE 2012 NORTH CAROLINA FIRE CODE</p>

ABBREVIATIONS	CODE REFERENCES
<p>A AMPERE AC ALTERNATING CURRENT DC DIRECT CURRENT EGC EQUIPMENT GROUNDING CONDUCTOR EMT ELECTRICAL METAL TUBING GALV GALVANIZED GEC GROUNDING ELECTRODE CONDUCTOR GND GROUND I CURRENT I_{MP} CURRENT AT MAXIMUM POWER I_{SC} SHORT-CIRCUIT CURRENT KVA KILOWATT AMPERE KW KILOWATT MAX MAXIMUM MIN MINIMUM MCB MAIN CIRCUIT BREAKER MLO MAIN LUG ONLY NOM NOMINAL NTS NOT TO SCALE P_{NOM} NOMINAL POWER PV PHOTOVOLTAIC SN SOLAR NOON ST STANDARD TEST CONDITIONS TYP TYPICAL V VOLT V_{MP} VOLTAGE AT MAXIMUM POWER V_{OC} OPEN-CIRCUIT VOLTAGE W WATT</p>	<p>2014 NATIONAL ELECTRIC CODE 2012 NORTH CAROLINA RESIDENTIAL CODE 2012 NORTH CAROLINA FIRE CODE</p>

CONSTRUCTION NOTES	ABBREVIATIONS	CODE REFERENCES
<ol style="list-style-type: none"> ALL WORK AND EQUIPMENT SHALL BE INSTALLED IN ACCORDANCE WITH THE LATEST NATIONAL, STATE, AND LOCAL CODES AND ORDINANCES FOLLOW MANUFACTURER'S INSTALLATION INSTRUCTIONS, BEST PRACTICES, AND SPECIFICATIONS WIRES SHALL BE RATED AND LABELED "SUNLIGHT RESISTANT" WHERE EXPOSED TO AMBIENT CONDITIONS THE PHOTOVOLTAIC SYSTEM SHALL NOT EXCEED 600 VOLTS OR 800 AMPS EACH ELECTRICAL APPLIANCE SHALL BE PROVIDED WITH A NAMEPLATE GIVING THE IDENTIFYING NAME AND THE RATING IN VOLTS AND AMPERES, OR VOLTS AND WATTS. IF THE APPLIANCE IS TO BE USED ON A SPECIFIC FREQUENCY OR FREQUENCIES, IT SHALL BE SO MARKED. WHERE MOTOR OVERLOAD PROTECTION EXTERNAL TO THE APPLIANCE IS REQUIRED, THE APPLIANCE SHALL BE SO MARKED WHERE APPLICABLE, GROUNDING ELECTRODE CONDUCTOR TO BE CONTINUOUS. GROUNDING CRIMPS TO BE IRREVERSIBLE GROUNDING DC PHOTOVOLTAIC ARRAYS SHALL BE PROVIDED WITH DC GROUND-FAULT PROTECTION THAT MEETS THE REQUIREMENTS OF NEC SECTION 690.5. UNGROUNDED DC PHOTOVOLTAIC ARRAYS SHALL COMPLY WITH NEC SECTION 690.35 IN ONE- AND TWO-FAMILY DWELLINGS, LIVE PARTS IN PHOTOVOLTAIC SOURCE CIRCUITS AND PHOTOVOLTAIC OUTPUT CIRCUITS OVER 150 VOLTS TO GROUND, SHALL ONLY BE ACCESSIBLE TO QUALIFIED PERSONS WHILE ENERGIZED. PHOTOVOLTAIC SYSTEMS SHALL BE PERMANENTLY MARKED AT VARIOUS EQUIPMENT LOCATIONS TO IDENTIFY THAT A PHOTOVOLTAIC SYSTEM IS INSTALLED AND THAT VARIOUS DANGERS ARE PRESENT. EACH PHOTOVOLTAIC SYSTEM DISCONNECTING MEANS SHALL BE PERMANENTLY MARKED TO IDENTIFY IT AS A PHOTOVOLTAIC SYSTEM DISCONNECT WHERE ALL TERMINALS OF A DISCONNECTING MEANS MAY BE ENERGIZED IN THE OPEN POSITION, A WARNING SIGN SHALL BE MOUNTED ON OR ADJACENT TO THE DISCONNECT A PERMANENT LABEL FOR THE DIRECT-CURRENT PHOTOVOLTAIC POWER SOURCE SHALL BE PROVIDED BY THE INSTALLER AT THE DC DISCONNECT MEANS A PERMANENT PLAQUE OR DIRECTORY, DENOTING ALL ELECTRICAL POWER SOURCES, PERMITTING SHALL BE INSTALLED AT EACH SERVICE EQUIPMENT LOCATION AND A HARNETT COUNTY PERMITTING A PERMANENT PLAQUE OR DIRECTORY SHALL BE PROVIDED DENOTING DISCONNECT MEANS AND THE PHOTOVOLTAIC SYSTEM DISCONNECT APPLICATION LOCATION AT EACH DISCONNECT MEANS AND THE PHOTOVOLTAIC SYSTEM DISCONNECT MEANS ALL MODULE GROUND CONNECTIONS SHALL BE MADE IN ACCORDANCE WITH NEC SECTION 690.4(C) <p>JOB NAME <u>NC Solar Now</u> DATE PLANS RECEIVED <u>3/20/18</u> SITE PLANS APPROVED <u>[Signature]</u> APPROVED BY <u>[Signature]</u> <u>3/21/18</u></p>	<p>A AMPERE AC ALTERNATING CURRENT DC DIRECT CURRENT EGC EQUIPMENT GROUNDING CONDUCTOR EMT ELECTRICAL METAL TUBING GALV GALVANIZED GEC GROUNDING ELECTRODE CONDUCTOR GND GROUND I CURRENT I_{MP} CURRENT AT MAXIMUM POWER I_{SC} SHORT-CIRCUIT CURRENT KVA KILOWATT AMPERE KW KILOWATT MAX MAXIMUM MIN MINIMUM MCB MAIN CIRCUIT BREAKER MLO MAIN LUG ONLY NOM NOMINAL NTS NOT TO SCALE P_{NOM} NOMINAL POWER PV PHOTOVOLTAIC SN SOLAR NOON ST STANDARD TEST CONDITIONS TYP TYPICAL V VOLT V_{MP} VOLTAGE AT MAXIMUM POWER V_{OC} OPEN-CIRCUIT VOLTAGE W WATT</p>	<p>2014 NATIONAL ELECTRIC CODE 2012 NORTH CAROLINA RESIDENTIAL CODE 2012 NORTH CAROLINA FIRE CODE</p>

© 2017 MODEL ENERGY, PLLC EXPRESSLY RESERVES ITS COMMON LAW COPYRIGHT AND OTHER PROPERTY RIGHTS IN THESE PLANS. THESE PLANS ARE NOT TO BE REPRODUCED, CHANGED OR COPIED IN ANY FORM OR MANNER WHATSOEVER, NOR ARE THEY TO BE ASSIGNED TO ANY THIRD PARTY WITHOUT FIRST OBTAINING THE EXPRESSED WRITTEN PERMISSION AND CONSENT OF MODEL ENERGY, PLLC.

ROOF FASTENERS	
MAKE	RED HEAD
TYPE	WEDGE ANCHOR
MATERIAL	304 SS
SIZE	3/8" X 3.5"
WEIGHT	0.1 LBS.
MAXIMUM PULL-OUT FORCE	2,800 LBS.
SAFETY FACTOR	3
DESIGN PULL-OUT FORCE	933 LBS.

ARRAY SUMMARY	
# MODULES	32
# ROOF MOUNTS	48
# FASTENERS	48
RAIL LENGTH	N/A
ARRAY AREA	668 SQFT.
ARRAY WEIGHT	1566 LBS.
AZIMUTH @ SN	180°
TILT ANGLE	30°

NOTES:
 • EMBED ANCHOR BETWEEN 2.5 AND 3.0 INCHES INTO THE CONCRETE

PV MODULES	
MAKE	CAN. SOLAR
MODEL	CS60-345M
WIDTH	59 IN.
LENGTH	77 IN.
THICKNESS	1.6 IN.
WEIGHT	49 LBS.

GROUND MOUNTS	
MAKE	UNIRACK
MODEL	L-FOOT
MATERIAL	ALUMINUM
WEIGHT	0.25 LBS.
FASTENERS	1 PER MOUNT

MOUNTING RAILS	
MAKE	UNIRACK
MODEL	SM STANDARD
MATERIAL	ALUMINUM
WEIGHT	1.25 LBS./SQFT.
SPACING	36 IN.

GROUND MOUNT	
TYPE	POURED PAD
MATERIAL	CONCRETE
LENGTH	52'-0"
WIDTH	14'-0"
DEPTH	4"
STRENGTH	2,000 PSI
DENSITY	150 LBS./CU.FT.
WEIGHT	36,500 LBS.

LOADING SUMMARY	
DEAD LOAD	
MOUNTING PAD	50.1 LBS./SQFT.
PV ARRAY	2.6 LBS./SQFT.
TOTAL	54.6 LBS./SQFT.
WIND LOAD:	
UP/LIFT	-33.8 LBS./SQFT.
DOWNWARD	21.2 LBS./SQFT.
FASTENER LOAD:	
UP/LIFT	-34.5 LBS.
DOWNWARD	216 LBS.

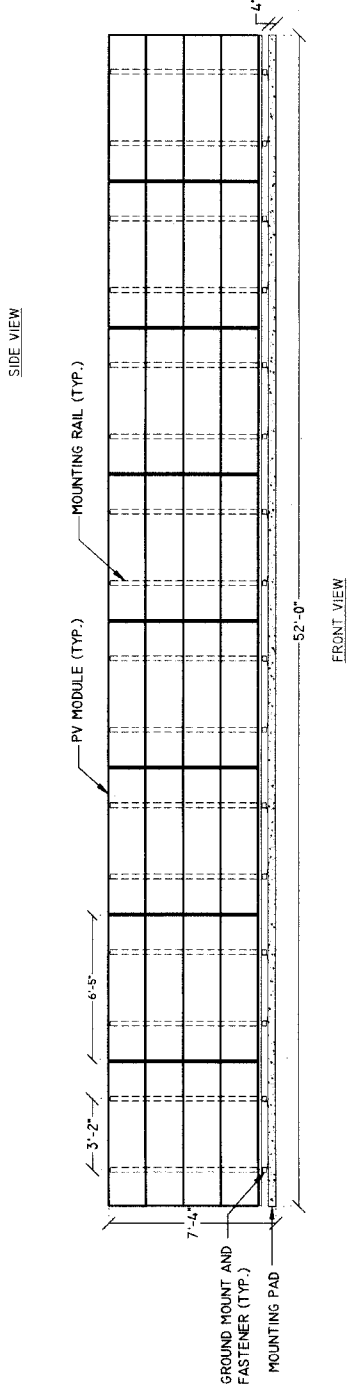
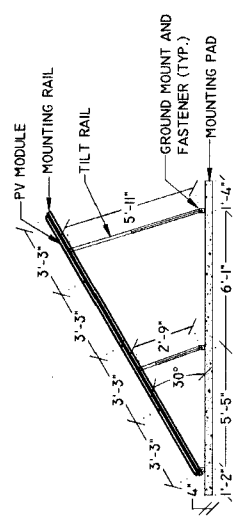

SCALE: 1/4" = 1'-0"

ENGINEER:

MODEL ENERGY
 702 E. FRANKLIN ST.
 RALEIGH, NC 27604
 919-274-9905
 MODELENERGY1.COM
 P:1194

JOB TITLE:
 NEW SOLAR PV SYSTEM
 11.04 KW DC INPUT
 10.0 KW AC EXPORT
 Kelly A. Yaeger
 51 MAGNOLIA FARM DR.
 FUQUAY-VARINA, NC 27526

CLIENT:

 ISSUED FOR: PERMIT
 DATE: 1/3/17
 ELECTRICAL INFORMATION
PV3.1

© 2017 MODEL ENERGY, PLLC EXPRESSLY RESERVES ITS COMMON LAW COPYRIGHT AND OTHER PROPERTY RIGHTS IN THESE PLANS. THESE PLANS ARE NOT TO BE REPRODUCED, CHANGED OR COPIED IN ANY FORM OR MANNER WHATSOEVER, NOR ARE THEY TO BE ASSIGNED TO ANY THIRD PARTY WITHOUT FIRST OBTAINING THE EXPRESSED WRITTEN PERMISSION AND CONSENT OF MODEL ENERGY, PLLC.



INVERTERS

SolarEdge Single Phase Inverters

For North America

SE3000A-US / SE3800A-US / SE5000A-US / SE6000A-US /
SE7600A-US / SE10000A-US / SE11400A-US

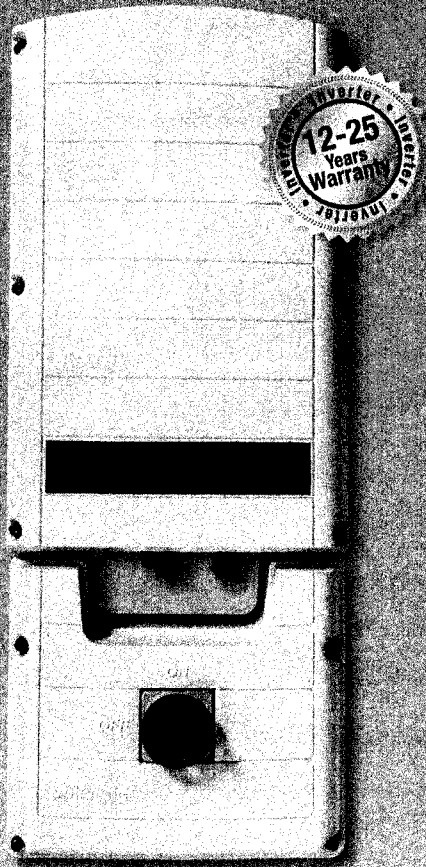

The best choice for SolarEdge enabled systems

- Integrated arc fault protection for NEC 2011 690.11 compliance
- Rapid shutdown for NEC 2014 690.12
- Superior efficiency (98%)
- Small, lightweight and easy to install on provided bracket
- Built-in module-level monitoring
- Internet connection through Ethernet or Wireless
- Outdoor and indoor installation
- Fixed voltage inverter, DC/AC conversion only
- Pre-assembled Safety Switch for faster installation
- Optional – revenue grade data, ANSI C12.1



Single Phase Inverters for North America

SE3000A-US / SE3800A-US / SE5000A-US / SE6000A-US /
SE7600A-US / SE10000A-US / SE11400A-US

	SE3000A-US	SE3800A-US	SE5000A-US	SE6000A-US	SE7600A-US	SE10000A-US	SE11400A-US		
OUTPUT									
Nominal AC Power Output	3000	3800	5000	6000	7600	9980 @ 208V 10000 @ 240V	11400	VA	
Max. AC Power Output	3300	4150	5400 @ 208V 5450 @ 240V	6000	8350	10800 @ 208V 10950 @ 240V	12000	VA	
AC Output Voltage Min.-Nom.-Max. ⁽¹⁾ 183 - 208 - 229 Vac	-	-	✓	-	-	✓	-		
AC Output Voltage Min.-Nom.-Max. ⁽¹⁾ 211 - 240 - 264 Vac	✓	✓	✓	✓	✓	✓	✓		
AC Frequency Min.-Nom.-Max. ⁽¹⁾	59.3 - 60 - 60.5							Hz	
Max. Continuous Output Current	12.5	16	24 @ 208V 21 @ 240V	25	32	48 @ 208V 42 @ 240V	47.5	A	
GFDI Threshold	1							A	
Utility Monitoring, Islanding Protection, Country Configurable Thresholds	Yes							Yes	
INPUT									
Maximum DC Power (STC)	4050	5100	6750	8100	10250	13500	15350	W	
Transformer-less, Ungrounded	Yes								
Max. Input Voltage	500							Vdc	
Nom. DC Input Voltage	325 @ 208V / 350 @ 240V							Vdc	
Max. Input Current ⁽²⁾	9.5	13	16.5 @ 208V 15.5 @ 240V	18	23	33 @ 208V 30.5 @ 240V	34.5	Adc	
Max. Input Short Circuit Current	45							Adc	
Reverse-Polarity Protection	Yes								
Ground-Fault Isolation Detection	600k Ω Sensitivity								
Maximum Inverter Efficiency	97.7	98.2	98.3	98.3	98	98	98	%	
CEC Weighted Efficiency	97.5	98	97 @ 208V 98 @ 240V	97.5	97.5	97 @ 208V 97.5 @ 240V	97.5	%	
Nighttime Power Consumption	< 2.5			< 4				W	
ADDITIONAL FEATURES									
Supported Communication Interfaces	RS485, RS232, Ethernet, ZigBee (optional)								
Revenue Grade Data, ANSI C12.1	Optional ⁽³⁾								
Rapid Shutdown – NEC 2014 690.12	Yes								
STANDARD COMPLIANCE									
Safety	UL1741, UL1699B, UL1998, CSA 22.2								
Grid Connection Standards	IEEE1547								
Emissions	FCC part15 class B								
INSTALLATION SPECIFICATIONS									
AC output conduit size / AWG range	3/4" minimum / 16-6 AWG				3/4" minimum / 8-3 AWG				
DC input conduit size / # of strings / AWG range	3/4" minimum / 1-2 strings / 16-6 AWG				3/4" minimum / 1-3 strings / 14-6 AWG				
Dimensions with Safety Switch (HxWxD)	30.5 x 12.5 x 7.2 / 775 x 315 x 184				30.5 x 12.5 x 10.5 / 775 x 315 x 260				in / mm
Weight with Safety Switch	51.2 / 23.2		54.7 / 24.7		88.4 / 40.1		lb / kg		
Cooling	Natural Convection				Natural convection and internal fan (user replaceable)		Fans (user replaceable)		
Noise	< 25				< 50				dBA
Min.-Max. Operating Temperature Range	-13 to +140 / -25 to +60 (-40 to +60 version available ⁽⁴⁾)							°F / °C	
Protection Rating	NEMA 3R								

⁽¹⁾ For other regional settings please contact SolarEdge support.
⁽²⁾ A higher current source may be used; the inverter will limit its input current to the values stated.
⁽³⁾ Revenue grade inverter P/N: SExxxxA-US000NNR2 (for 7600W inverter:SE7600A-US002NNR2).
⁽⁴⁾ -40 version P/N: SExxxxA-US000NNU4 (for 7600W inverter:SE7600A-US002NNU4).



RoHS

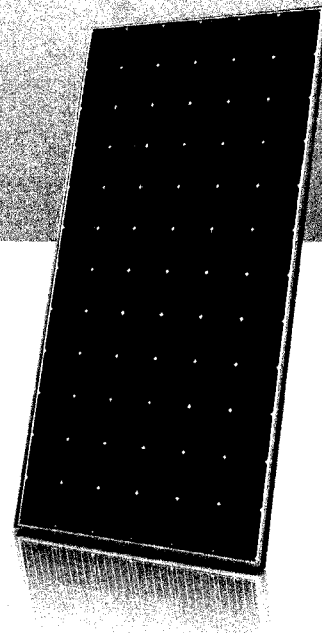

MAXPOWER CS6U-330 | 335 | 340 | 345M

Canadian Solar's modules use the latest innovative cell technology, increasing module power output and system reliability, ensured by 15 years of experience in module manufacturing, well-engineered module design, stringent BOM quality testing, an automated manufacturing process and 100% EL testing.

KEY FEATURES

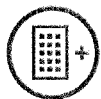

Excellent module efficiency of up to 17.74 %



Cell efficiency of up to 20.0 %



Outstanding low irradiance performance: 96.5 %



High PTC rating of up to 91.7 %



IP67 junction box for long-term weather endurance



Heavy snow load up to 5400 Pa, wind load up to 2400 Pa



linear power output warranty



product warranty on materials and workmanship

MANAGEMENT SYSTEM CERTIFICATES*

ISO 9001:2008 / Quality management system
ISO 14001:2004 / Standards for environmental management system
OHSAS 18001:2007 / International standards for occupational health & safety

PRODUCT CERTIFICATES*

IEC 61215 / IEC 61730: VDE / CE / CQC / MCS
UL 1703 / IEC 61215 performance: CEC listed (US)
UL 1703: CSA / IEC 61701 ED2: VDE / IEC 62716: VDE / Take-e-way
UNI 9177 Reaction to Fire: Class 1



* As there are different certification requirements in different markets, please contact your local Canadian Solar sales representative for the specific certificates applicable to the products in the region in which the products are to be used.

CANADIAN SOLAR INC. is committed to providing high quality solar products, solar system solutions and services to customers around the world. As a leading PV project developer and manufacturer of solar modules with over 15 GW deployed around the world since 2001, Canadian Solar Inc. (NASDAQ: CSIQ) is one of the most bankable solar companies worldwide.

CANADIAN SOLAR INC.

2430 Camino Ramon, Suite 240 San Ramon, CA, USA 94583-4385 | www.canadiansolar.com/na | sales.us@canadiansolar.com

ENGINEERING DRAWING (mm)

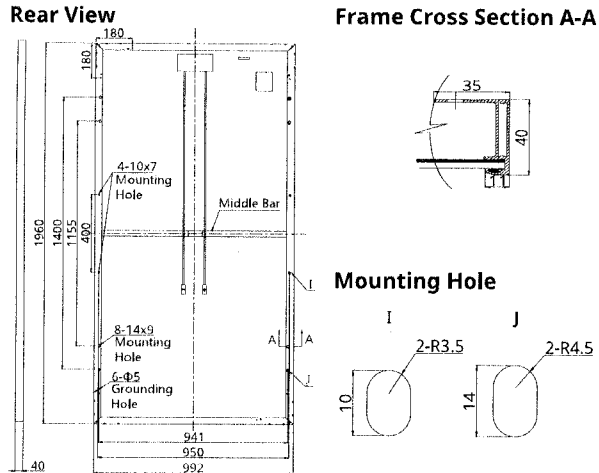

ELECTRICAL DATA / STC*

CS6U	330M	335M	340M	345M
Nominal Max. Power (Pmax)	330 W	335 W	340 W	345 W
Opt. Operating Voltage (Vmp)	37.5 V	37.8 V	37.9 V	38.1 V
Opt. Operating Current (Imp)	8.80 A	8.87 A	8.97 A	9.06 A
Open Circuit Voltage (Voc)	45.9 V	46.1 V	46.2 V	46.4 V
Short Circuit Current (Isc)	9.31 A	9.41 A	9.48 A	9.56 A
Module Efficiency	16.97%	17.23%	17.49%	17.74%
Operating Temperature	-40°C ~ +85°C			
Max. System Voltage	1000 V (IEC) or 1000 V (UL)			
Module Fire Performance	TYPE 1 (UL 1703) or CLASS C (IEC 61730)			
Max. Series Fuse Rating	15 A			
Application Classification	Class A			
Power Tolerance	0 ~ + 5 W			

* Under Standard Test Conditions (STC) of irradiance of 1000 W/m², spectrum AM 1.5 and cell temperature of 25°C.

ELECTRICAL DATA / NOCT*

CS6U	330M	335M	340M	345M
Nominal Max. Power (Pmax)	238 W	242 W	245 W	249 W
Opt. Operating Voltage (Vmp)	34.2 V	34.5 V	34.6 V	34.7 V
Opt. Operating Current (Imp)	6.96 A	7.01 A	7.10 A	7.17 A
Open Circuit Voltage (Voc)	42.1 V	42.3 V	42.4 V	42.6 V
Short Circuit Current (Isc)	7.54 A	7.62 A	7.67 A	7.74 A

* Under Nominal Operating Cell Temperature (NOCT), irradiance of 800 W/m², spectrum AM 1.5, ambient temperature 20°C, wind speed 1 m/s.

PERFORMANCE AT LOW IRRADIANCE

Outstanding performance at low irradiance, average relative efficiency of 96.5 % from an irradiance of 1000 W/m² to 200 W/m² (AM 1.5, 25°C).

The specification and key features described in this datasheet may deviate slightly and are not guaranteed. Due to on-going innovation, research and product enhancement, Canadian Solar Inc. reserves the right to make any adjustment to the information described herein at any time without notice. Please always obtain the most recent version of the datasheet which shall be duly incorporated into the binding contract made by the parties governing all transactions related to the purchase and sale of the products described herein.

Caution: For professional use only. The installation and handling of PV modules requires professional skills and should only be performed by qualified professionals. Please read the safety and installation instructions before using the modules.

CS6U-335M / I-V CURVES

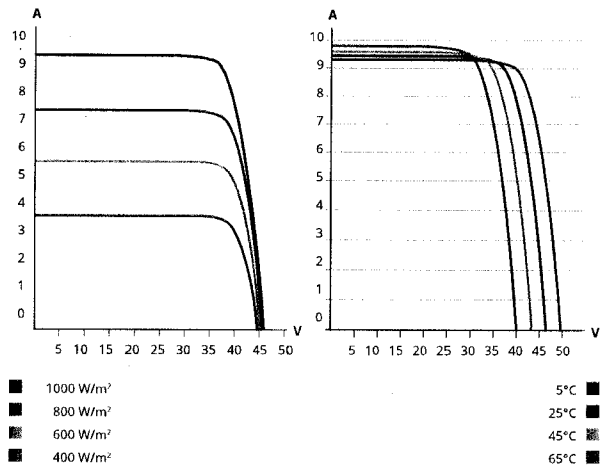

MECHANICAL DATA

Specification	Data
Cell Type	Mono-crystalline, 6 inch
Cell Arrangement	72 (6×12)
Dimensions	1960×992×40 mm (77.2×39.1×1.57 in)
Weight	22.4 kg (49.4 lbs)
Front Cover	3.2 mm tempered glass
Frame Material	Anodized aluminium alloy
J-Box	IP67, 3 diodes
Cable	4 mm ² (IEC) or 4 mm ² & 12 AWG 1000V (UL), 1160 mm (45.7 in)
Connector	T4 (IEC/UL)
Per Pallet	26 pieces, 635 kg (1400 lbs)
Per container (40' HQ)	624 pieces

TEMPERATURE CHARACTERISTICS

Specification	Data
Temperature Coefficient (Pmax)	-0.41 % / °C
Temperature Coefficient (Voc)	-0.31 % / °C
Temperature Coefficient (Isc)	0.053 % / °C
Nominal Operating Cell Temperature	45±2 °C

PARTNER SECTION



HARNETT COUNTY CENTRAL PERMITTING

P.O. BOX 65

LILLINGTON, NC 27546

For Inspections Call: (910) 893-7525 Fax: (910) 893-2793

Application Number	18-50043596	Page	2
Property Address	51 MAGNOLIA FARM DR	Date	4/10/18
PARCEL NUMBER	08-0654- - -0247- -01-		
Application description	CP ADD & ALTER RESIDENTIAL		
Subdivision Name			
Property Zoning	RES/AGRI DIST - RA-40		

Required Inspections

Seq	Phone Insp#	Insp Code	Description	Initials	Date
Permit type RESIDENTIAL ELECTRICAL PERMIT					
999	211	E211	R*ELEC ABOVE CEILING	_____	__/__/__
999	217	E217	R*ELEC RECONNECT	_____	__/__/__
999	205	E205	R*ELEC UNDER SLAB	_____	__/__/__
999	215	E215	R*ELEC. UND. POOL	_____	__/__/__
999	213	E213	R*ELECTRICAL UNDERGROUND	_____	__/__/__
999	131	R131	ONE TRADE FINAL	_____	__/__/__
999	125	R125	ONE TRADE ROUGH IN	_____	__/__/__
Permit type LAND USE PERMIT					
999	818	Z818	PZ*ZONING INSPECTION	_____	__/__/__
999	820	Z820	PZ*ZONING/FINAL INSPECTION	_____	__/__/__

HARNETT COUNTY CENTRAL PERMITTING
P.O. BOX 65
LILLINGTON, NC 27546
For Inspections Call: (910) 893-7525 Fax: (910) 893-2793

Application Number 18-50043596 Date 4/10/18
Property Address 51 MAGNOLIA FARM DR
PARCEL NUMBER 08-0654- - -0247- -01-
Application type description CP ADD & ALTER RESIDENTIAL
Subdivision Name
Property Zoning RES/AGRI DIST - RA-40

Owner

YEAGER EDWIN P & KELLY
6075 RAWLS CHURCH RD
FUQUAY-VARINA NC 27526

Contractor

NC SOLAR NOW
3401-101 ATLANTIC AVE
RALEIGH NC 27604
(919) 833-9096

Applicant

NC SOLAR NOW
3401-101 ATLANTIC AVE
RALEIGH NC 27604
(919) 833-9096

--- Structure Information 000 000 GROUND MOUNT SOLOR PV ARRAY (668 SQFT)
Flood Zone FLOOD ZONE X
Other struct info # BATHS 6
BEDROOMS 9.00
PROPOSED USE ELECTRICAL
SEPTIC - EXISTING? EXIST
WATER SUPPLY COUNTY

Permit RESIDENTIAL ELECTRICAL PERMIT
Additional desc
Phone Access Code . 1237569
Issue Date 4/10/18 Valuation 0
Expiration Date . . 4/10/19

Permit LAND USE PERMIT
Additional desc
Phone Access Code . 1237577
Issue Date 4/10/18 Valuation 0
Expiration Date . . 10/07/18

Special Notes and Comments
T/S: 03/20/2018 10:23 AM LLUCAS ----
OFF RAWLS CHURCH RD

HARNETT COUNTY CASH RECEIPTS
*** CUSTOMER RECEIPT ***
Oper: LLUCAS Type: CP Drawer: 1
Date: 3/20/18 53 Receipt no: 295515

Year	Number	Amount
2018	50043596	
51 MAGNOLIA FARM DR		
FUGUAY-VARINA, NC 27526		
B1	BP - PERMIT FEES	\$100.00

NC SOLAR NOW

Tender detail	
CP CREDIT CARD	\$100.00
Total tendered	\$100.00
Total payment	\$100.00

Trans date: 3/20/18 Time: 14:55:39

** THANK YOU FOR YOUR PAYMENT **

HARNETT COUNTY CASH RECEIPTS
*** CUSTOMER RECEIPT ***
Oper: LLUCAS Type: CP Drawer: 1
Date: 4/10/18 53 Receipt no: 316487

Year	Number	Amount
2018	50043596	
51 MAGNOLIA FARM DR		
FUGUAY-VARINA, NC 27526		
B1	BP - PERMIT FEES	\$105.00

ELECTRICAL

NC SOLAR NOW

Tender detail	
CP CREDIT CARD	\$105.00
Total tendered	\$105.00
Total payment	\$105.00

Trans date: 4/10/18 Time: 9:04:42

** THANK YOU FOR YOUR PAYMENT **