











HARNETT COUNTY CENTRAL PERMITTING

P.O. BOX 65
LILLINGTON, NC 27546
For Inspections Call: (910) 893-7525 Fax: (910) 893-2793
Bldg Insp scheduled before 2pm available next business day.

Application Number . . . . . 17-50041716 Date 7/25/17
Property Address . . . . . 82 OAK VALLEY FARM RD
PARCEL NUMBER . . . . . 07-1509- - -0070- - -
Application type description CP ADD & ALTER RESIDENTIAL
Subdivision Name . . . . .
Property Zoning . . . . . RES/AGRI DIST - RA-40

Owner Contractor
TART WILLIAM & C OWNER
RT 1 BOX 211
COATS NC 27521

Applicant
SPEIGHT JEFF
217 HIGHLAND DRIVE
ANGIER NC 27501
(919) 669-8832

Structure Information 000 000 20X20 SCREENED IN PORCH
Flood Zone . . . . . FLOOD ZONE X
Other struct info . . . . . # BEDROOMS 3.00
SEPTIC - EXISTING? EXISTING
WATER SUPPLY COUNTY/WELL

Permit . . . . . RESIDENTIAL BUILDING PERMIT
Additional desc . . . . .
Phone Access Code . . . . . 1201714
Issue Date . . . . . 7/25/17 Valuation . . . . . 0
Expiration Date . . . . . 7/25/18

Permit . . . . . RESIDENTIAL ELECTRICAL PERMIT
Additional desc . . . . .
Phone Access Code . . . . . 1201722
Issue Date . . . . . 7/25/17 Valuation . . . . . 0
Expiration Date . . . . . 7/25/18

Permit . . . . . LAND USE PERMIT
Additional desc . . . . .
Phone Access Code . . . . . 1201730
Issue Date . . . . . 7/25/17 Valuation . . . . . 0
Expiration Date . . . . . 1/21/18

Special Notes and Comments
T/S: 06/27/2017 11:33 AM BPETRICH --
82 OAK VALLEY FARM RD COATS 27521





**PARTS INDEX**

\*PARTS ALSO AVAILABLE FOR 4-5/8" AND 6" ROOF THICKNESS

PICTURE	DESCRIPTION	DRAWING #	PICTURE	DESCRIPTION	DRAWING #
	SD HEADER SUPPORT	1-2079A		6" RIDGE BEAM	1-0218
	HD HEADER SUPPORT	1-2089A		8" RIDGE BEAM	1-0229
	HEADER ARM	1-0214A		WALL POST SUPPORT BRACKET	1-2053
	HEADER BEARING PLATE 6" LONG GALV. STEEL	8-2111		SASH WIDTH	1-2064
	H SUPPORT	1-2080A		SASH HEIGHT	1-2062
	H REINFORCING GALV. STEEL	8-2003		SASH INTERLOCK	1-2061
	HD CORNER POST	1-2078A		SCREEN HEIGHT	1-2016
	CORNER POST COVER	1-2081A		SCREEN WIDTH	1-2017
	HD 2-1/2" ANGLE BRACKET	1-2083		SD HEADER REINFORCEMENT 1-1/2" x 2" x 11 GA. GALV. RECTANGULAR STEEL TUBE	8-0089
	2-1/2" ANGLE BRACKET	8-2108A		HD HEADER REINFORCEMENT 1-1/2" x 4" x 11 GA. GALV. RECTANGULAR STEEL TUBE	8-0090
	GANGING POST	1-2082		1.32" ALUM. SQUARE TUBE	1-2022
	WALL POST	1-2049		1.5" ALUM. SQUARE TUBE	1-0201
	WALL POST CAP	1-2051		2" GLAZING BAR	1-0501
	MASTERFRAME HEAD	1-2008B		AV UTILITY POST	1-2092
	MASTERFRAME SILL	1-2007B		2-1/2" X 2-1/2" X 3/16" STEEL TUBE	8-0091
	MASTERFRAME JAMB	1-2009B		WALL POST REINFORCEMENT, GALV. STEEL	8-2004
	1-LITE MALE	1-2086		SASH STILE REINFORCEMENT, GALVANIZED STEEL	8-0026
	1-LITE FEMALE	1-2087A		3" GRP MALE FRAME *	1-0114
	WALL EXPANDER	1-0203		3" GRP FEMALE FRAME *	1-0115
	FLOOR EXPANDER	1-2056		1/2" x 5/8" ANGLE	1-0121
	1-3/4" FLOOR EXPANDER	1-2057C		HANGER TAB	1-0209
	PANEL CAP	1-2035		RIDGE POST TIE DOWN STRAP, 6"	8-0115
	AACA WING HORIZONTAL	1-2073		ALUM. RIDGE POST BRACKET	8-2002
	AACA WING VERTICAL	1-2074		1-BEAM STEEL STIFFENER (FOR 3" 1-BEAM ONLY)	8-0051
	FASCIA, 3" *	1-0258A		3" ROOF CORNER TIE DOWN KIT *	P/N 07187
	PANEL HANGER, 3" *	1-0210		4-5/8" ROOF CORNER TIE DOWN KIT *	P/N 07188
	FOAM KNEEWALL TRIM	1-2044		6" ROOF CORNER TIE DOWN KIT *	P/N 07189
	1-BEAM, 3" *	1-0217B			
	1/8" GLAZING STOP	2-2006			
	5/8" GLAZING STOP (10)	2-2005			

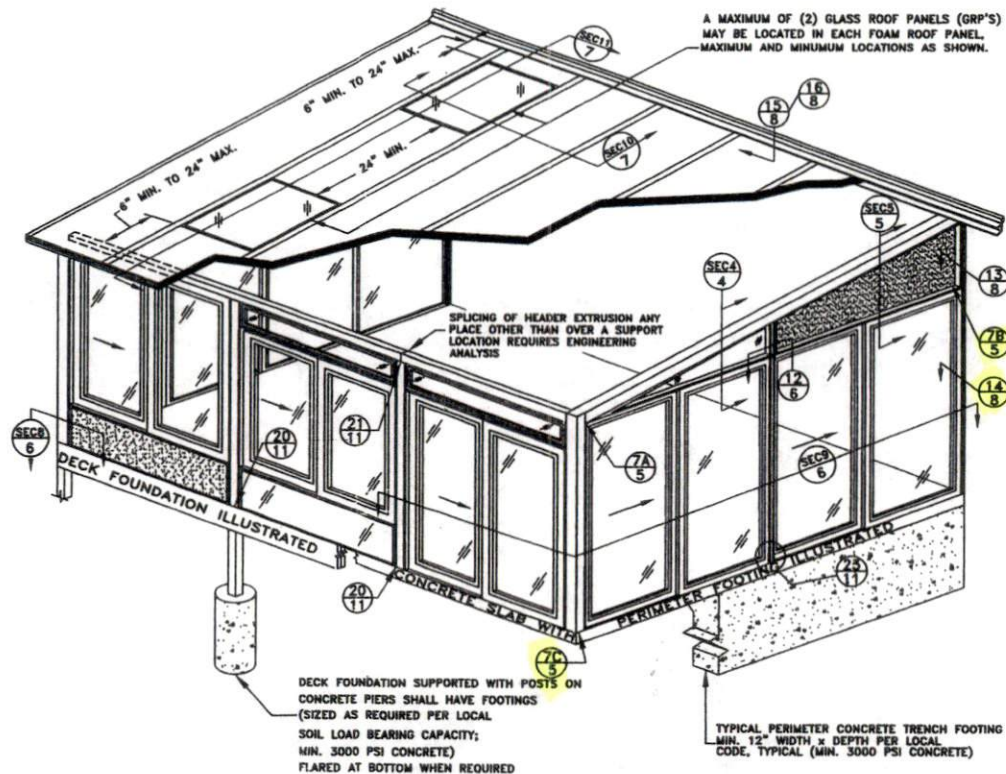

# AAS SUNROOM ENCLOSURE

(SINGLE SLOPE ROOF SHOWN - SEE SHEET 2 OF 11 FOR GABLE ROOF)

DRAWN BY: VNG  
DATE: 09-17-03  
SCALE: NTS  
VERSION: E.1(10/25/10)



AN EMPLOYEE OWNED COMPANY

720 E. HIGHLAND ROAD  
MACEDONIA, OHIO 44056

THIS DRAWING IS THE PROPERTY OF PATIO ENCLOSURES, INC. ALL RIGHTS RESERVED. DUPLICATION OF THIS DRAWING IN ANY FORM IS NOT PERMITTED WITHOUT THE EXPRESSED WRITTEN CONSENT OF PATIO ENCLOSURES, INC.

THE STANDARD PLANS, ELEVATIONS, SECTIONS & DETAILS CONTAINED HEREIN ARE IN ACCORDANCE WITH INSTALLATION PROCEDURES ESTABLISHED BY PATIO ENCLOSURES, INC. AND ARE FOR GENERAL REFERENCE. SEE INDIVIDUAL JOB SUBMITTAL FOR SPECIFIC PROJECTIONS, UNIT NOTINGS & WALL HEIGHTS.

**STANDARD  
RESIDENTIAL  
AAS DETAILS**





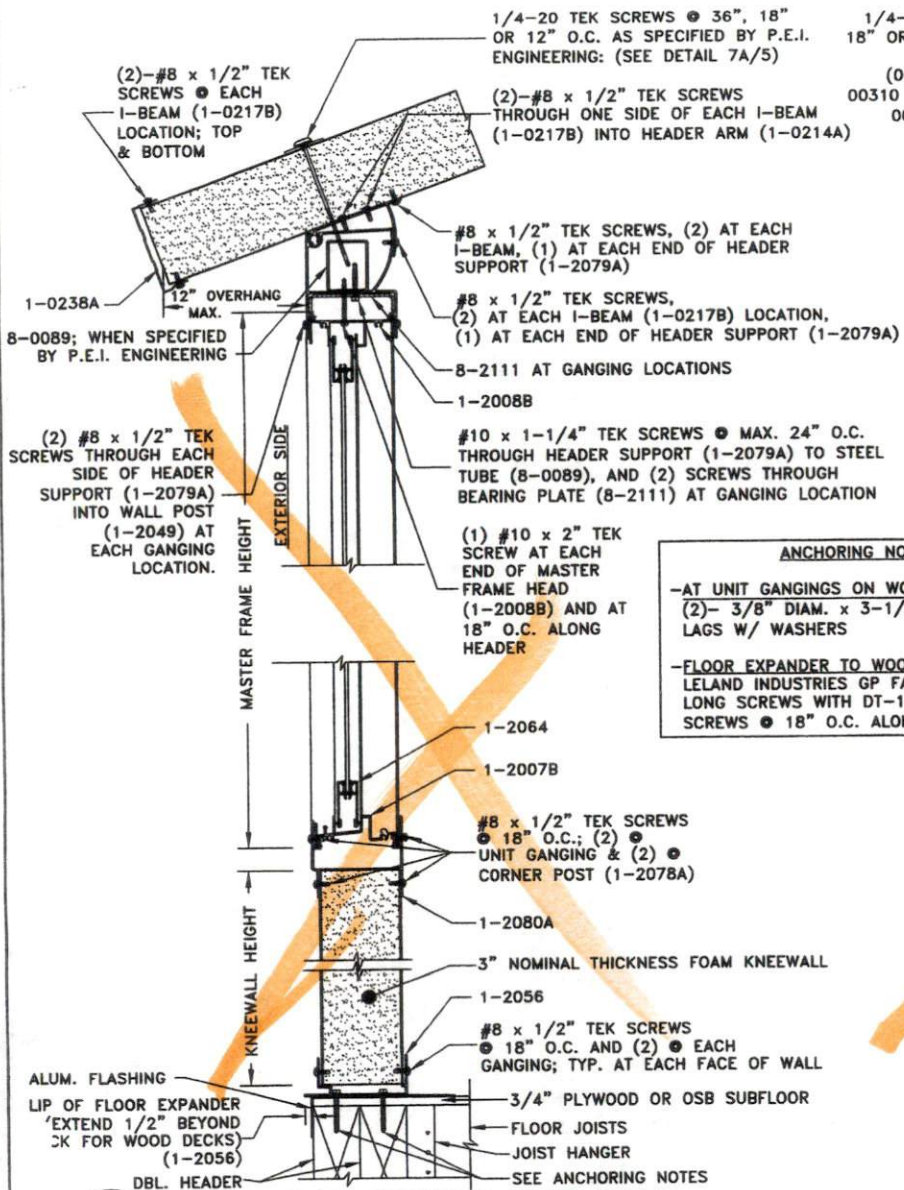

SEC1  
3  
HEADER OVER WINDOW OVER FOAM KNEEWALL ON WOOD DECK

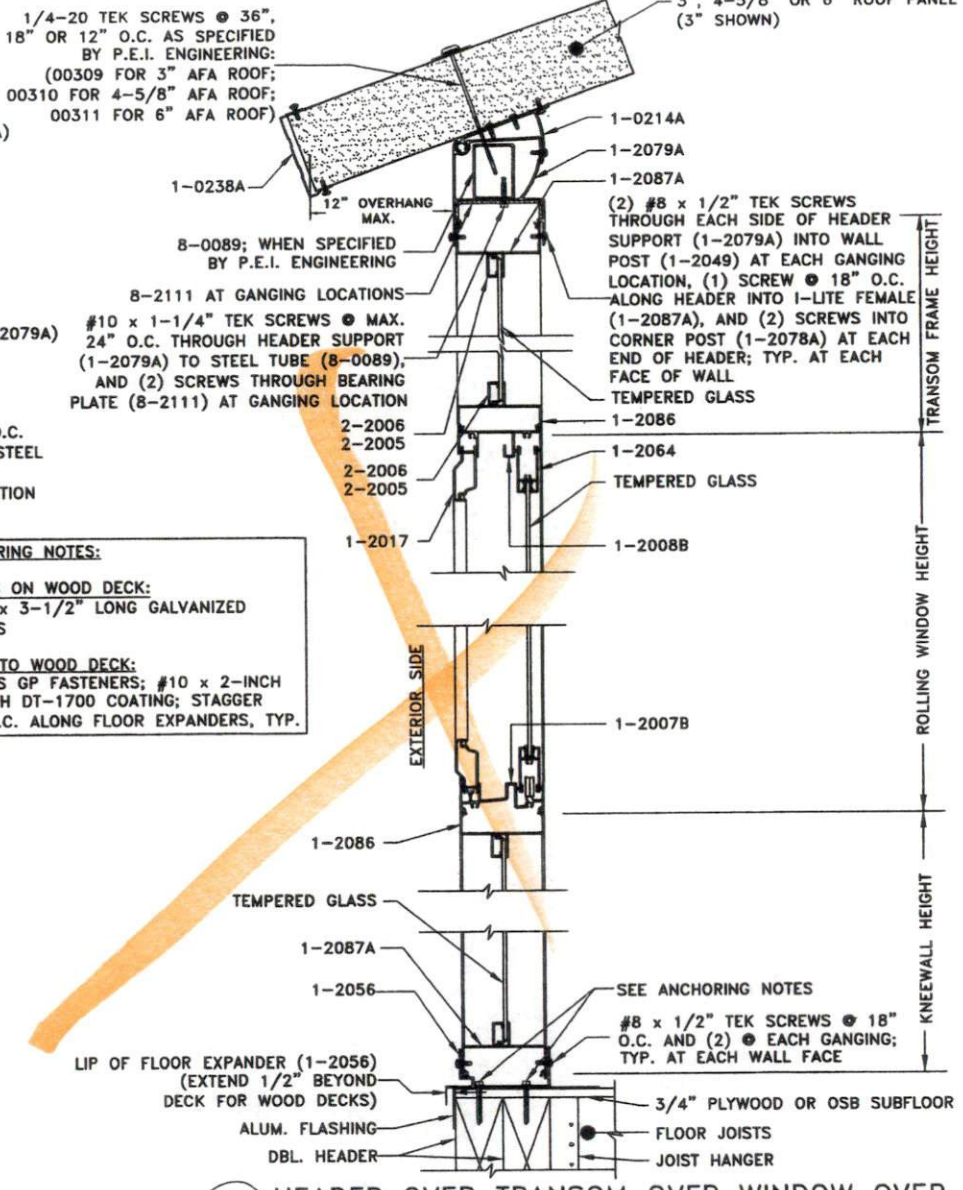

SEC2  
3  
HEADER OVER TRANSOM OVER WINDOW OVER GLASS KNEEWALL ON WOOD DECK

**ANCHORING NOTES:**

-AT UNIT GANGINGS ON WOOD DECK:  
(2)- 3/8" DIAM. x 3-1/2" LONG GALVANIZED LAGS W/ WASHERS

-FLOOR EXPANDER TO WOOD DECK:  
LELAND INDUSTRIES GP FASTENERS; #10 x 2-INCH LONG SCREWS WITH DT-1700 COATING; STAGGER SCREWS @ 18" O.C. ALONG FLOOR EXPANDERS, TYP.



DRAWN BY: VNG  
DATE: 09-17-03  
SCALE: NTS  
VERSION: E:1(10/25/10)

**patio ENCLOSURES, INC.**  
AN EMPLOYEE OWNED COMPANY  
720 E. HIGHLAND ROAD  
MACEDONIA, OHIO 44056

THIS DRAWING IS THE PROPERTY OF PATIO ENCLOSURES, INC. ALL RIGHTS ARE RESERVED. NO PART OF THIS DRAWING IS TO BE REPRODUCED OR TRANSMITTED IN ANY FORM OR BY ANY MEANS, WITHOUT THE EXPRESSED WRITTEN CONSENT OF PATIO ENCLOSURES, INC.

THE STANDARD PLANS, ELEVATIONS, SECTIONS & DETAILS CONTAINED HEREIN ARE IN ACCORDANCE WITH THE BUILDING CODES AND REGULATIONS IN EFFECT AT THE TIME OF THE ORIGINAL DESIGN. FOR GENERAL INFORMATION, SEE BRIDGEMAN FOR SPECIFIC PROJECTIONS, UNIT WIDTHS & WALL HEIGHTS.

**STANDARD RESIDENTIAL AAS DETAILS**



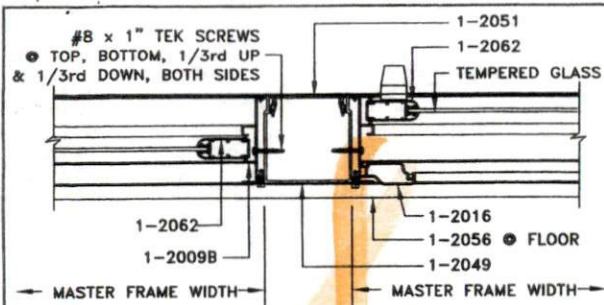

SEE WALL POST ANCHORAGE DETAIL #20 ON SHEET 11

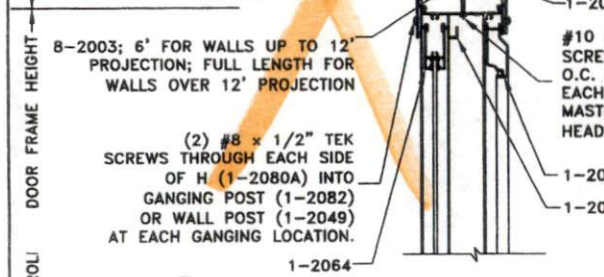
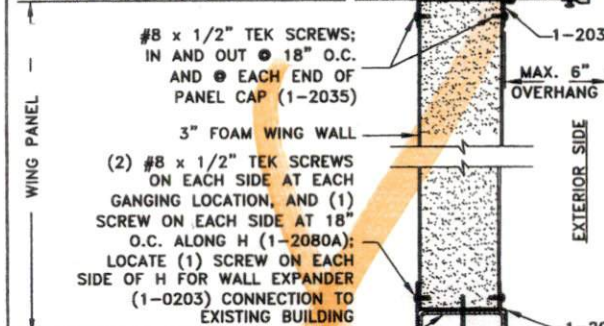
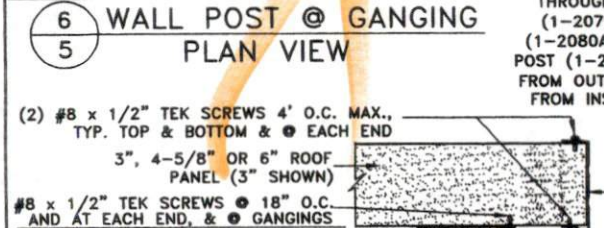

SEC5 FOAM WING OVER  
5 SLIDING GLASS DOOR

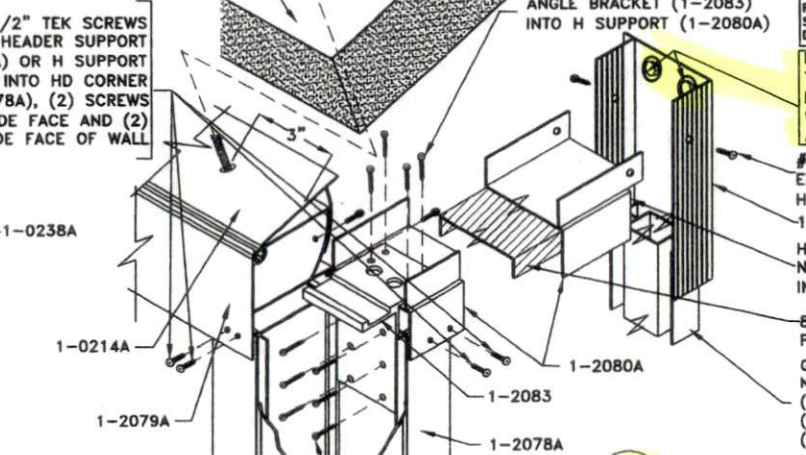
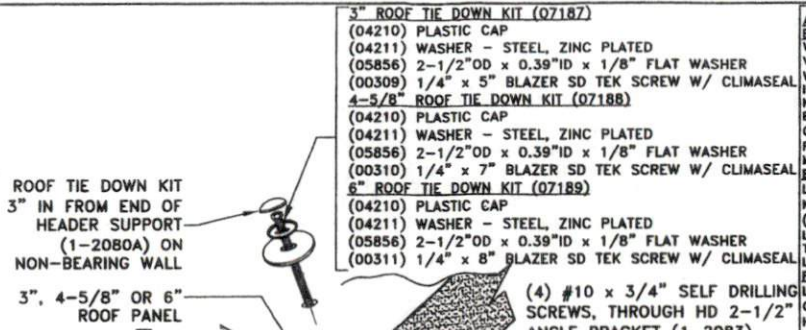

7A;B  
5 H SUPPORT CONNECTION AT CORNER POST & WALL EXPANDER

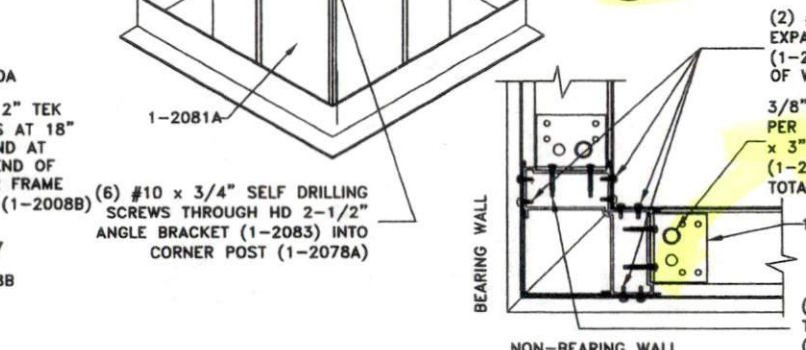

DETAIL AT B-C CORNER 7C  
5 WOOD & CONCRETE FOUNDATION ANCHORAGE @ CORNER POST & FLOOR EXPANDERS

ATTACHING SUNROOM WALL EXPANDER TO EXISTING STRUCTURE:  
WOOD FRAMED STRUCTURES & WOOD FRAMING WITH BRICK VENEER USE 1/4-INCH DIAMETER GALVANIZED LAGS & WASHERS PROVIDING A MINIMUM 1-1/2-INCH EMBEDMENT INTO WOOD FRAMING OR WOOD BLOCKING INSTALLED AND NAILED TO WOOD FRAMING AT ALL LOCATIONS NOTED BELOW. FOR BLOCK MASONRY, BLOCK WITH BRICK FACING, OR CONCRETE, USE 1/4-INCH DIAMETER TAPCON LE FASTENERS PROVIDING 1-3/4-INCH EMBEDMENT INTO MASONRY OR CONCRETE AT ALL LOCATIONS NOTED BELOW.

BEARING WALLS:  
LOCATE (2) FASTENERS NEAR FLOOR LEVEL, (2) AT KNEEWALL OR RAILING HEIGHT, (2) AT TRANSOM, & (2) NEAR HEADER HEIGHT. INSTALL SINGLE FASTENERS LOCATED AT 16" O.C. VERTICALLY AND STAGGERED ALONG THE EXPANDER HEIGHT BETWEEN DOUBLE FASTENER LOCATIONS TYPICAL.

FOR NONBEARING WALLS:  
LOCATE (2) FASTENERS NEAR FLOOR, (2) AT KNEEWALL OR RAILING HEIGHT, (2) AT TRANSOM HEIGHT, (2) AT H, & (2) NEAR TOP END OF EXPANDER. INSTALL SINGLE FASTENERS LOCATED AT 16" O.C. VERTICALLY AND STAGGERED ALONG THE EXPANDER HEIGHT BETWEEN DOUBLE FASTENER LOCATIONS TYPICAL.

PROVIDE (2) LAGS WITH WASHERS THROUGH WALL EXPANDER (1-0203) AT LOCATIONS NOTED ABOVE, AND (1) LAG WITH WASHER AT 16" O.C. STAGGERED AS NOTED

#8 x 1/2" TEK SCREWS THROUGH WALL EXPANDER (1-0203) INTO H SUPPORT (1-2080A); EACH SIDE 1-0203

H SUPPORT (1-2080A) FACTORY NOTCHED AS SHOWN TO FIT INSIDE WALL EXPANDER (1-0203)

B-2003; WHEN SPECIFIED BY P.E.I. ENGINEERING

GANGING POST (1-2082) NESTED IN WALL EXPANDER (1-0203) SUPPORTS H SUPPORT (1-2080A) OR HEADER SUPPORT (1-2079A)

(2) #8 x 1/2" TEK SCREWS THROUGH FLOOR EXPANDER (1-2056) INTO HD CORNER POST (1-2078A) FROM OUTSIDE AND INSIDE FACE OF WALL. TYP. AT SIDE OF POST

3/8" DIAM. x 3 1/2" LONG GALVANIZED LAG PER BRACKET FOR WOOD DECK & 3/8" DIAM. x 3" LONG WEDGE-BOLT PER BRACKET (1-2083) FOR CONCRETE FOUNDATION. TOTAL (2) ANCHORS REQUIRED

(4) #10 x 3/4" SELF DRILLING SCREWS THROUGH EACH HD 2-1/2" ANGLE BRACKET (1-2083) INTO CORNER POST (1-2078A)



DRAWN BY: YNG  
DATE: 09-17-03  
SCALE: NTS  
VERSION: E. (10/25/10)



THIS DRAWING IS THE PROPERTY OF PATIO ENCLOSURES, INC. ALL RIGHTS RESERVED. DUPLICATION OF THIS DRAWING IN ANY FORM IS NOT PERMITTED WITHOUT THE EXPRESSED WRITTEN CONSENT OF PATIO ENCLOSURES, INC.

THE STANDARD PLANS, ELEVATIONS, SECTIONS & DETAILS CONTAINED HEREIN ARE IN ACCORDANCE WITH INSTALLATION PROCEDURES ESTABLISHED BY PATIO ENCLOSURES, INC. AND ARE FOR GENERAL REFERENCE. SEE CONTRACTUAL AND SUPPLEMENTAL FOR SPECIFIC PROVISIONS, UNIT WEIGHTS & WALL HEIGHTS.

STANDARD  
RESIDENTIAL  
AAS DETAILS



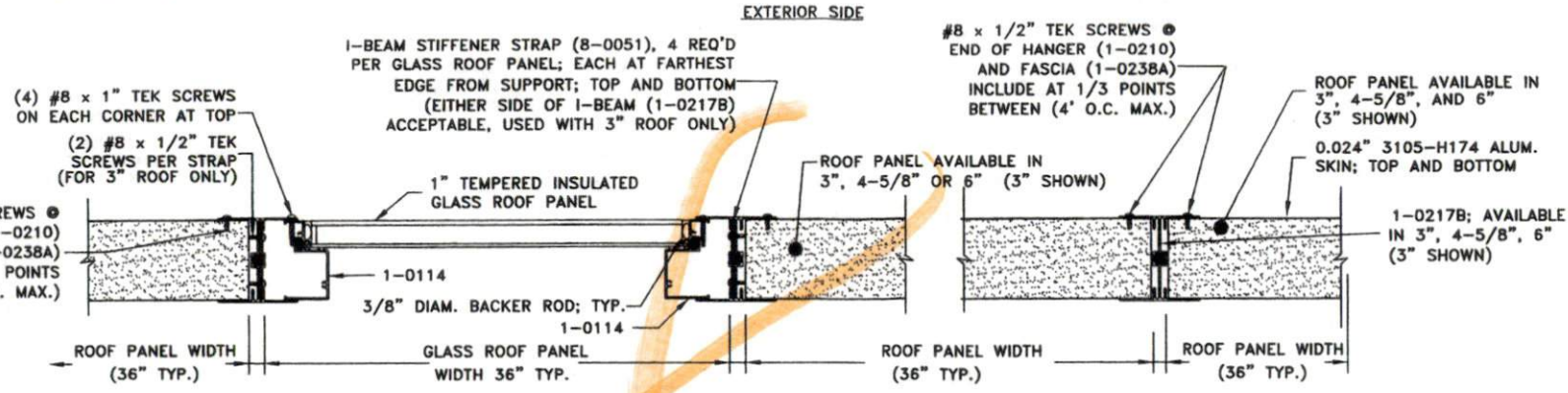

**SEC10 3-INCH FOAM PANEL ROOF CROSS SECTION**

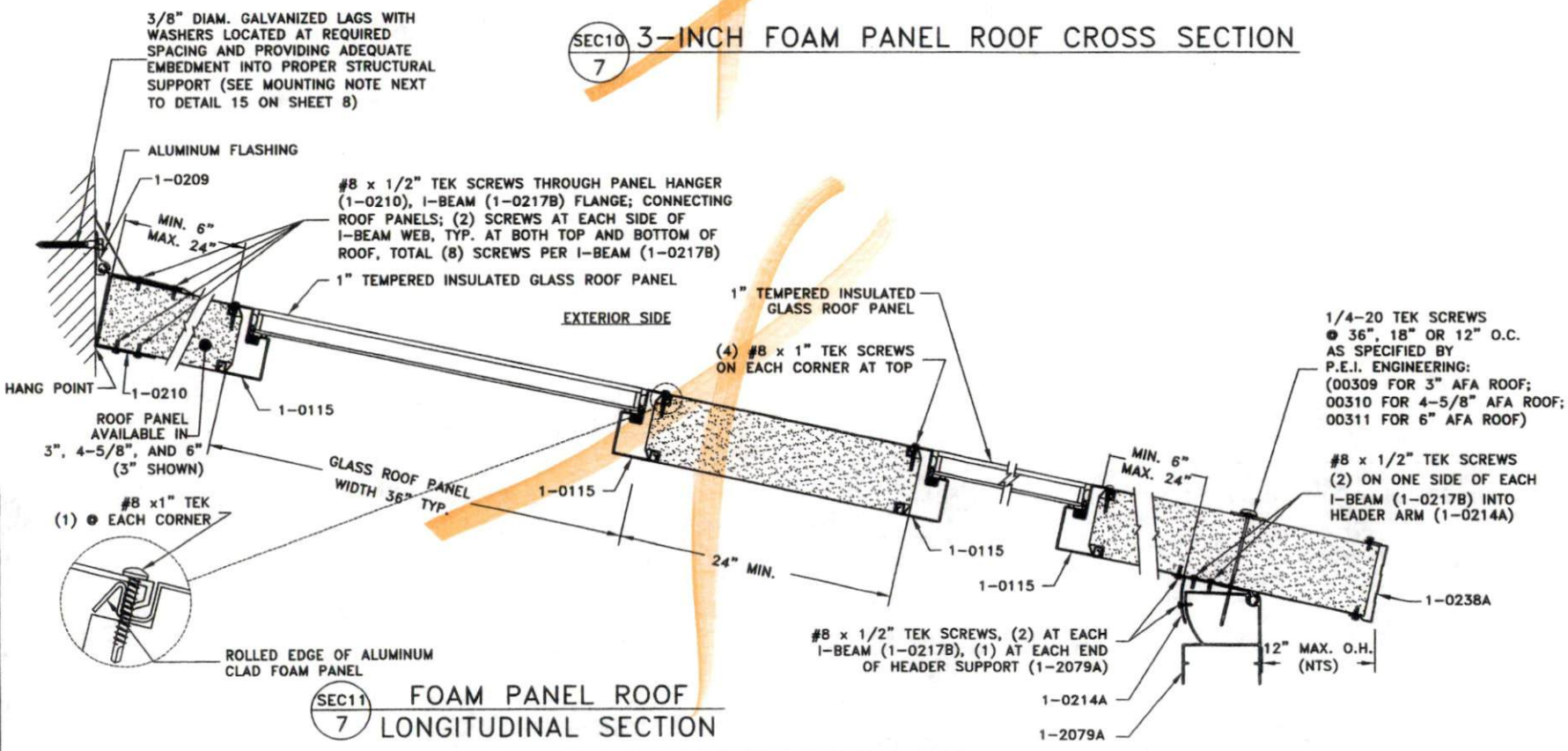

SUNROOM DETAILS

202 9 0 0 0 202

PROJECT: 3105-H174 ALUM. SKIN; TOP AND BOTTOM

DATE: 08-17-03

SCALE: NTS

VERSION: E.1(10/25/10)

DRAWN BY: YNG

DATE: 08-17-03

SCALE: NTS

VERSION: E.1(10/25/10)

**patio ENCLOSURES, INC.**

AN EMPLOYEE OWNED COMPANY

720 E. HIGHLAND ROAD  
MACEDONIA, OHIO 44056

THIS DRAWING IS THE PROPERTY OF PATIO ENCLOSURES, INC. ALL RIGHTS RESERVED. NO PART OF THIS DRAWING IN ANY FORM IS TO BE REPRODUCED OR TRANSMITTED IN ANY MANNER WITHOUT THE EXPRESSED WRITTEN CONSENT OF PATIO ENCLOSURES, INC.

THE ESTIMATED PLANS, ELEVATIONS, SECTIONS & DETAILS CONTAINED HEREIN ARE PREPARED IN ACCORDANCE WITH INSTALLATION PROCEDURES ESTABLISHED BY PATIO ENCLOSURES, INC. AND ARE FOR GENERAL REFERENCE. SEE INDIVIDUAL JOB SUBMITTAL FOR SPECIFIC PROJECTIONS, UNIT NOTIONS & WALL HEIGHTS.

**STANDARD  
RESIDENTIAL  
AAS DETAILS**

SHEET 7 OF 11

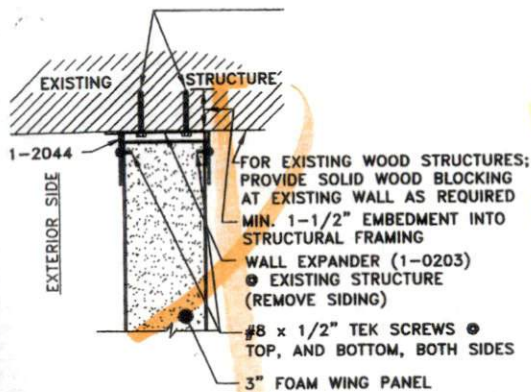

**ATTACHING SUNROOM WALL EXPANDER TO EXISTING STRUCTURE:**  
 WOOD FRAMED STRUCTURES & WOOD FRAMING WITH BRICK VENEER USE 1/4-INCH DIAMETER GALVANIZED LAGS & WASHERS PROVIDING A MINIMUM 1-1/2-INCH EMBEDMENT INTO WOOD FRAMING OR WOOD BLOCKING INSTALLED AND NAILED TO WOOD FRAMING AT ALL LOCATIONS NOTED BELOW. FOR BLOCK MASONRY, BLOCK WITH BRICK FACING, OR CONCRETE, USE 1/4-INCH DIAMETER TAPCON LE FASTENERS PROVIDING 1-3/4-INCH EMBEDMENT INTO MASONRY OR CONCRETE AT ALL LOCATIONS NOTED BELOW.  
**BEARING WALLS:**  
 LOCATE (2) FASTENERS NEAR FLOOR LEVEL, (2) AT KNEEWALL OR RAILING HEIGHT, (2) AT TRANSOM, & (2) NEAR HEADER HEIGHT. INSTALL SINGLE FASTENERS LOCATED AT 16" O.C. VERTICALLY AND STAGGERED ALONG THE EXPANDER HEIGHT BETWEEN DOUBLE FASTENER LOCATIONS TYPICAL.  
**FOR NONBEARING WALLS:**  
 LOCATE (2) FASTENERS NEAR FLOOR, (2) AT KNEEWALL OR RAILING HEIGHT, (2) AT TRANSOM HEIGHT, (2) AT H, & (2) NEAR TOP END OF EXPANDER. INSTALL SINGLE FASTENERS LOCATED AT 16" O.C. VERTICALLY AND STAGGERED ALONG THE EXPANDER HEIGHT BETWEEN DOUBLE FASTENER LOCATIONS TYPICAL.

**MOUNTING TO EXISTING STRUCTURES:** REMOVE EXISTING SIDING AND ANY COMPRESSIBLE SHEATHING AT CONNECTION POINTS OF ENCLOSURE TO HOUSE. LAGS MUST BE SECURELY ANCHORED TO STRUCTURAL FRAMING OR INSTALL BLOCKING SECURELY FASTENED TO STRUCTURAL FRAMING TO PROVIDE MINIMUM 1-1/2" EMBEDMENT FOR MOUNTING FASTENERS.

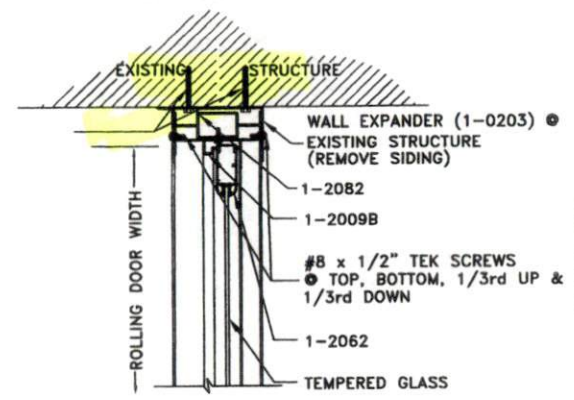

13 PLAN VIEW OF FOAM WING PANEL AT EXISTING STRUCTURE

14 PLAN VIEW OF ROLLING DOOR AT EXISTING STRUCTURE

**MOUNTING NOTE:** THE QUANTITY AND SIZE OF FASTENERS REQUIRED VARIES BY APPLICATION. A LEDGER WITH MORE LAGS ADEQUATELY FASTENED TO THE EXISTING STRUCTURE, OR A SUPPORT BEAM MOUNTED ON SUPPORT POSTS AT THE FACE OF THE EXISTING STRUCTURE MAY BE REQUIRED UNDER HEAVY LOADS. CONSULT P.E.I. ENGINEERING OR A LOCAL DESIGN PROFESSIONAL FOR JOB SPECIFIC REQUIREMENTS.

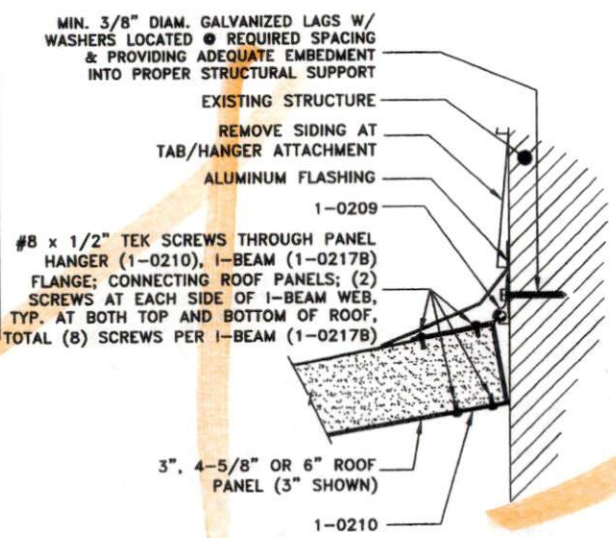

15 TAB AND HANGER ASSEMBLY (WALL MOUNT)

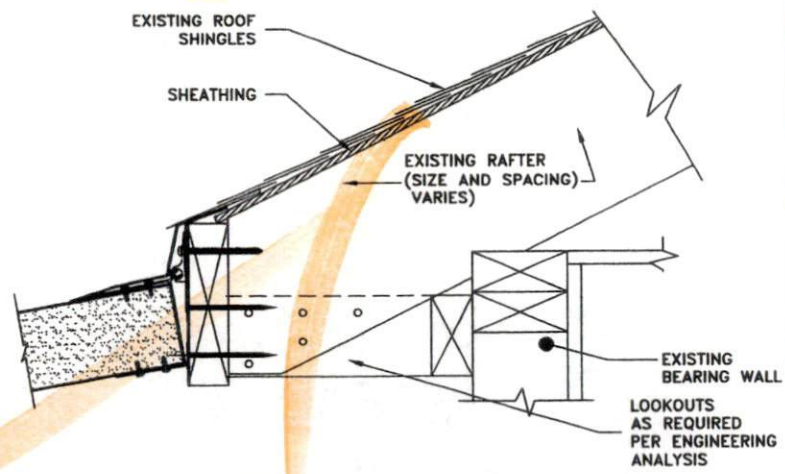

**NOTE:** THIS MOUNTING METHOD MAY REQUIRE LOOKOUTS ADDED OR ADDITIONAL REINFORCEMENT AND/OR FASTENERS AT EACH RAFTER LOCATION. EXISTING STRUCTURE MUST BE EVALUATED FOR STRUCTURAL SUITABILITY BY LICENSED ENGINEER.

16 TAB AND HANGER ASSEMBLY (FASCIA MOUNT)

**SUNROOM DETAILS**

DATE: 09-17-03  
 SCALE: NTS  
 VERSION: E-1(10/25/10)

**patio ENCLOSURES, INC.**  
 AN EMPLOYEE OWNED COMPANY  
 720 E. HIGHLAND ROAD  
 MACEDONIA, OHIO 44056

THE DRAWING IS THE PROPERTY OF PATIO ENCLOSURES, INC. ALL RIGHTS RESERVED. THIS DRAWING IN ANY FORM IS NOT PERMITTED WITHOUT THE EXPRESSED WRITTEN CONSENT OF PATIO ENCLOSURES, INC.

THE STANDARD PLANS, ELEVATIONS, SECTIONS & DETAILS COMPLY WITH THE REQUIREMENTS OF THE INSTALLATION PROCEDURES ESTABLISHED BY PATIO ENCLOSURES, INC. AND ARE FOR GENERAL REFERENCE. SEE INDIVIDUAL JOB SUBMITTAL FOR SPECIFIC PROJECTIONS, UNIT WEIGHTS & WALL HEIGHTS.

**STANDARD RESIDENTIAL AAS DETAILS**

SHEET 8 OF 11

SEE GENERAL NOTES ON SHEET 1 FOR REQUIREMENTS FOR PRESSURE TREATED LUMBER AND FASTENERS.

(2)-#10 x 2" TEK SCREWS THROUGH INTERIOR FACE OF FLOOR EXPANDER (1-2056) INTO RIDGE POST

3/8" DIAM. x 3-1/2" LONG GALVANIZED LAG WITH WASHER EACH SIDE OF RIDGE POST ON WOOD FOUNDATIONS  
NOTE: LOCATE LAGS/BOLTS IN HOLE CLOSEST TO INTERIOR OF ROOM; TYPICAL

PLYWOOD OR OSB DECK SURFACE  
1-2056

TRUGRIP ANCHORS @ 18" O.C. TYP. STAGGERED

ALUM. FLASHING

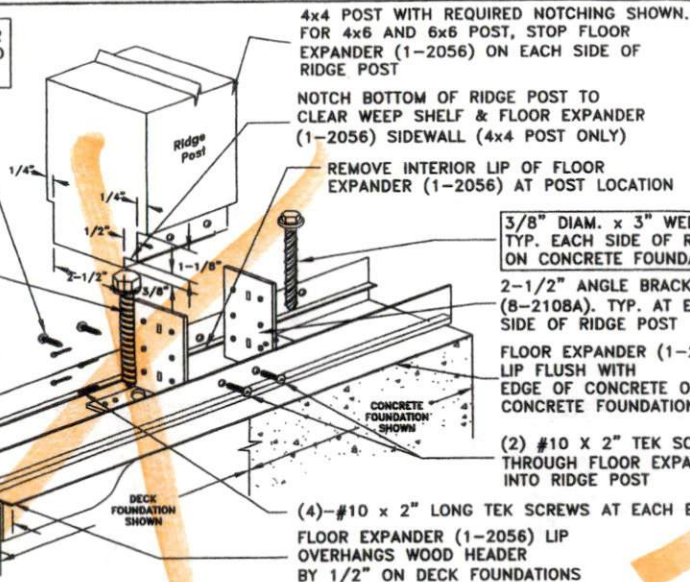

4x4 POST WITH REQUIRED NOTCHING SHOWN. FOR 4x6 AND 6x6 POST, STOP FLOOR EXPANDER (1-2056) ON EACH SIDE OF RIDGE POST

NOTCH BOTTOM OF RIDGE POST TO CLEAR WEEP SHELF & FLOOR EXPANDER (1-2056) SIDEWALL (4x4 POST ONLY)

REMOVE INTERIOR LIP OF FLOOR EXPANDER (1-2056) AT POST LOCATION

3/8" DIAM. x 3" WEDGE-BOLT; TYP. EACH SIDE OF RIDGE POST ON CONCRETE FOUNDATION

2-1/2" ANGLE BRACKET (8-2108A). TYP. AT EACH SIDE OF RIDGE POST

FLOOR EXPANDER (1-2056) LIP FLUSH WITH EDGE OF CONCRETE ON CONCRETE FOUNDATION

(2) #10 x 2" TEK SCREWS THROUGH FLOOR EXPANDER (1-2056) INTO RIDGE POST

(4)-#10 x 2" LONG TEK SCREWS AT EACH BRACKET; TYP.  
FLOOR EXPANDER (1-2056) LIP OVERHANGS WOOD HEADER BY 1/2" ON DECK FOUNDATIONS

ANCHORING NOTE:

FOR WOOD USE: MIN. (2) 3/8" DIAM. x 3-1/2" LONG GALVANIZED LAGS (MIN. 1-1/2" EMBEDMENT INTO STRUCTURAL FRAMING)

FOR CONCRETE USE:  
(2) 3/8" DIAM. x 3" WEDGE-BOLT

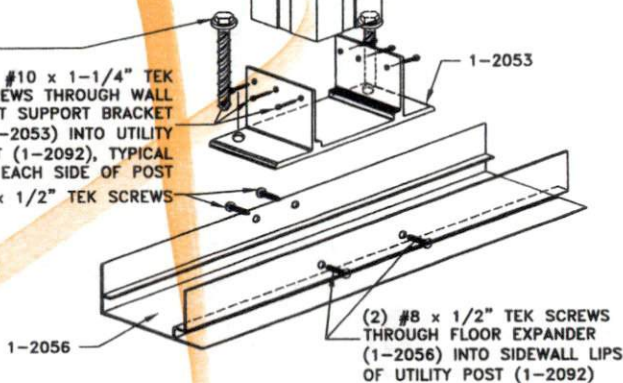

8-0091  
1-2092 W/ 2-1/2" x 2-1/2" x 3/16" STEEL TUBE (8-0091) (LENGTH OF STEEL TUBE INSERT TO BE EXACTLY SAME AS AV UTILITY POST)

(3) #10 x 1-1/4" TEK SCREWS THROUGH WALL POST SUPPORT BRACKET (1-2053) INTO UTILITY POST (1-2092), TYPICAL AT EACH SIDE OF POST

(2) #8 x 1/2" TEK SCREWS

(2) #8 x 1/2" TEK SCREWS THROUGH FLOOR EXPANDER (1-2056) INTO SIDEWALL LIPS OF UTILITY POST (1-2092)

17A WOOD RIDGE POST ANCHORAGE

9

AT FLOOR EXPANDER

(BOTH WOOD DECK & CONCRETE FOUNDATION SHOWN)

(WOOD POST SHALL BE PRESSURE TREATED FOR CONCRETE FOUNDATION)

17B AV UTILITY RIDGE POST ANCHORAGE

9

AT FLOOR EXPANDER

(CONCRETE FOUNDATION SHOWN)

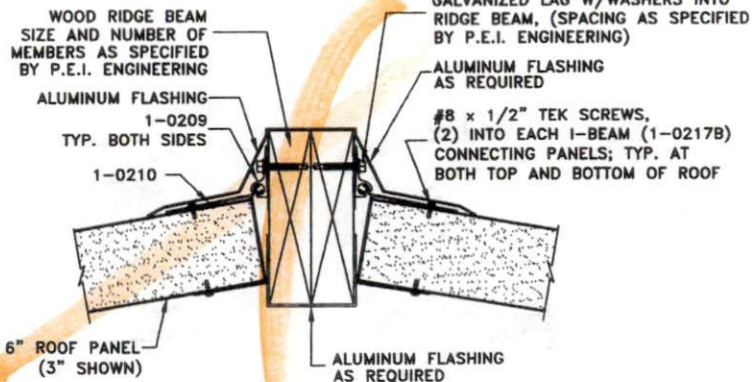

WOOD RIDGE BEAM SIZE AND NUMBER OF MEMBERS AS SPECIFIED BY P.E.I. ENGINEERING

ALUMINUM FLASHING 1-0209 TYP. BOTH SIDES

1-0210

3", 4-5/8" OR 6" ROOF PANEL (3" SHOWN)

ALUMINUM FLASHING AS REQUIRED

MIN. 3/8" DIAM. x 2-1/2" LONG GALVANIZED LAG W/WASHERS INTO RIDGE BEAM, (SPACING AS SPECIFIED BY P.E.I. ENGINEERING)

ALUMINUM FLASHING AS REQUIRED

#8 x 1/2" TEK SCREWS, (2) INTO EACH I-BEAM (1-0217B) CONNECTING PANELS; TYP. AT BOTH TOP AND BOTTOM OF ROOF

18B WOOD RIDGE BEAM AND

9

TAB AND PANEL HANGER

SUNROOM DETAILS



DRAWN BY: VNG  
DATE: 08-17-03  
SCALE: NTS  
VERSION: E.1(10/25/10)



770 E. HIGHLAND ROAD  
MACEDONIA, OHIO 44056

THIS DRAWING IS THE PROPERTY OF PATIS ENCLOSURES, INC. ALL RIGHTS RESERVED. REPLICATION OF THIS DRAWING IN ANY FORM IS NOT PERMITTED WITHOUT THE EXPRESSED WRITTEN CONSENT OF PATIS ENCLOSURES, INC.  
THE STANDARD PLANS, ELEVATIONS, SECTIONS & DETAILS CONTAINED HEREIN ARE IN ACCORDANCE WITH INSTALLATION PROCEDURES ESTABLISHED BY PATIS ENCLOSURES, INC. AND ARE FOR GENERAL REFERENCE. SEE INDIVIDUAL JOB SUBMITTAL FOR SPECIFIC PROJECTIONS, UNIT WORKS & WALL HEIGHTS.

STANDARD  
RESIDENTIAL  
AAS DETAILS

USE MIN. 3/8" DIAM. x 2-1/2"  
GALVANIZED LAGS W/WASHERS  
INTO RIDGE BEAM; (SPACING AS  
SPECIFIED BY P.E.I. ENGINEERING)

HANGER TAB (1-0209)  
TYP. BOTH SIDES

MIN. (5) #10 x 2" TEK  
SCREWS INTO RIDGE  
POST EACH SIDE

8-0115

NOTE: HIGH WIND CONDITIONS MAY  
REQUIRE ALTERNATE CONNECTIONS.  
REQUEST P.E.I. ENGINEERING.

STRAP IS CONTINUOUS  
(BEND OVER CORNERS  
OF RIDGE BEAM)

PANEL HANGER (1-0210)  
TYP. BOTH SIDES

WOOD RIDGE BEAM (SIZE AND  
NUMBER OF MEMBERS PER P.E.I.  
ENGINEERING REQUIREMENTS)

MIN. (5) #10 x 2" TEK SCREWS  
INTO EACH SIDE OF BEAM

PPT 4x4, 4x6,  
6x6 RIDGE POST, TYP.

12" MIN. LAP LENGTH ON POST;  
TYPICAL AT EACH SIDE OF POST

SEE GENERAL NOTES ON SHEET 1 FOR  
REQUIREMENTS FOR PRESSURE TREATED  
LUMBER AND FASTENERS.

**WOOD RIDGE BEAM  
ON WOOD POST**

19A  
10

**RIDGE BEAM TO WOOD RIDGE POST CONNECTION**

NOTE:  
WHEN USING EPA APPROVED PRESERVATIVE TREATED LUMBER AT  
GANGINGS, FIRST ISOLATE WOOD POST FROM ALUMINUM BY WRAPPING  
WITH EITHER OF THE FOLLOWING: 15LB ROOF FELT, OR 10 MIL PLASTIC  
SHEETING PRIOR TO INSTALLATION OF ALUMINUM CLIPS OR TRIM COIL.  
ALL FASTENERS IN DIRECT CONTACT WITH PRESERVATIVE TREATED  
WOOD SHALL BE HOT-DIPPED GALVANIZED PER ASTM A153, OR  
OTHER APPROVED PROTECTIVE COATING. TRIM COIL TO BE ATTACHED  
TO ISOLATED WOOD POST USING STAINLESS STEEL TRIM NAILS.

HANGER TAB (1-0209)  
TYP. BOTH SIDES

8-0115

MIN. (5) #8 x 1/2" TEK SCREWS  
THROUGH GABLE POST TIE DOWN  
STRAP (8-0115) INTO AV  
UTILITY POST (1-2092);  
EACH SIDE

(2) #10 x 2" TEK SCREWS  
THROUGH FOAM KNEEWALL TRIM  
(1-2044) INTO RIDGE BEAM;  
EACH SIDE

#8 x 1" TEK SCREWS;  
(2) @ TOP & BOTTOM, (1)  
STAGGERED @ 12" O.C.;  
TYP. AT EACH SIDE OF AV  
UTILITY POST (1-2092)

NOTE: HIGH WIND CONDITIONS MAY  
REQUIRE ALTERNATE CONNECTIONS;  
REQUEST P.E.I. ENGINEERING

USE 3/8" DIAM. x 2-1/2" LG.  
GALVANIZED LAGS W/WASHERS  
INTO RIDGE BEAM STAGGERED  
AT OPPOSITE SIDES (SPACING  
AS SPECIFIED BY P.E.I.  
ENGINEERING)

PANEL HANGER (1-0210)  
TYP. BOTH SIDES

WOOD RIDGE BEAM (SIZE AND  
NUMBER OF MEMBERS AS  
SPECIFIED P.E.I. ENGINEERING)

USE (5)- #10 x 2" TEK  
SCREWS THROUGH GABLE  
POST TIE DOWN STRAP  
(8-0115) INTO EACH SIDE

WALL EXPANDER (1-0203)  
W/ LIP PEELED. FORMS CAP  
FOR AV UTILITY POST (1-2092)

AV UTILITY POST (1-2092)  
W/ 2.5" SQR x 3/16" STEEL  
TUBE (8-0091)

(LENGTH OF STEEL TUBE  
INSERT TO BE SAME AS  
AV UTILITY POST)

1-2044  
TYP. AT EACH SIDE

**WOOD RIDGE BEAM  
ON UTILITY POST**

19B  
10

**RIDGE BEAM TO ALUM. RIDGE POST CONNECTION**



DRAWN BY: VNG  
DATE: 08-17-03  
SCALE: NTS  
VERSION: E.1(10/25/10)



720 E. HIGHLAND ROAD  
MACEDONIA, OHIO 44056

THIS DRAWING IS THE PROPERTY OF PATIO ENCLOSURES, INC. ALL RIGHTS RESERVED. NO PART OF THIS DRAWING IS TO BE REPRODUCED OR TRANSMITTED IN ANY FORM OR BY ANY MEANS, WITHOUT THE EXPRESSED WRITTEN CONSENT OF PATIO ENCLOSURES, INC.  
THE STANDARD PLANS, ELEVATIONS, SECTIONS & DETAILS CONTAINED HEREIN ARE IN ACCORDANCE WITH THE BUILDING CODES AND REGULATIONS OF THE CITY OF MACEDONIA, OHIO. SEE GENERAL NOTES FOR SPECIFIC PROJECTIONS, UNIT MOTORS & WALL HEIGHTS.

**STANDARD  
RESIDENTIAL  
AAS DETAILS**



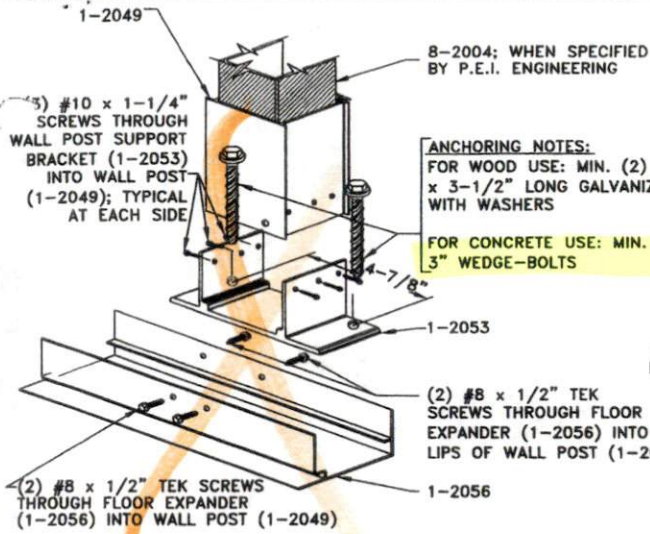

20 WALL POST CONNECTION, AT BEARING WALL

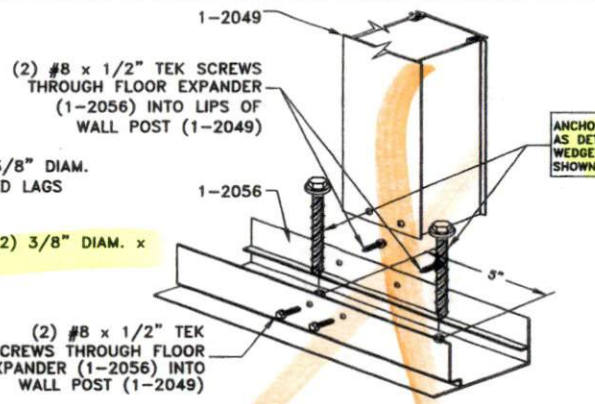

22 WALL POST CONNECTION AT NON-BEARING WALL

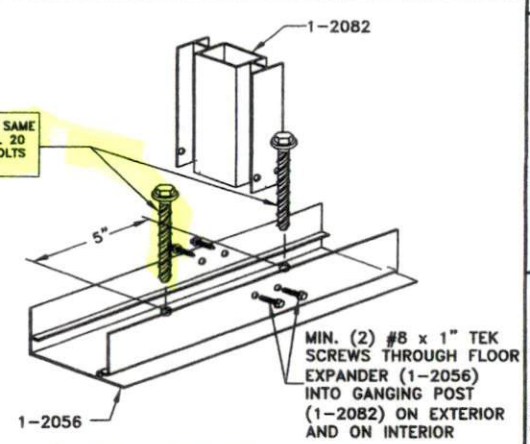

23 GANGING POST CONNECTION AT NON-BEARING WALL

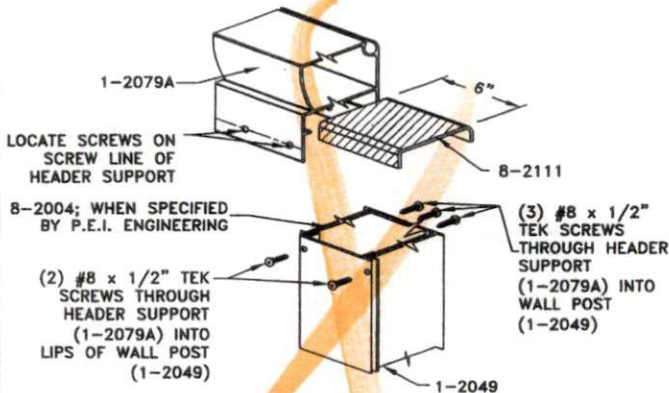

21 HEADER SUPPORT TO WALL POST CONNECTION AT BEARING WALL

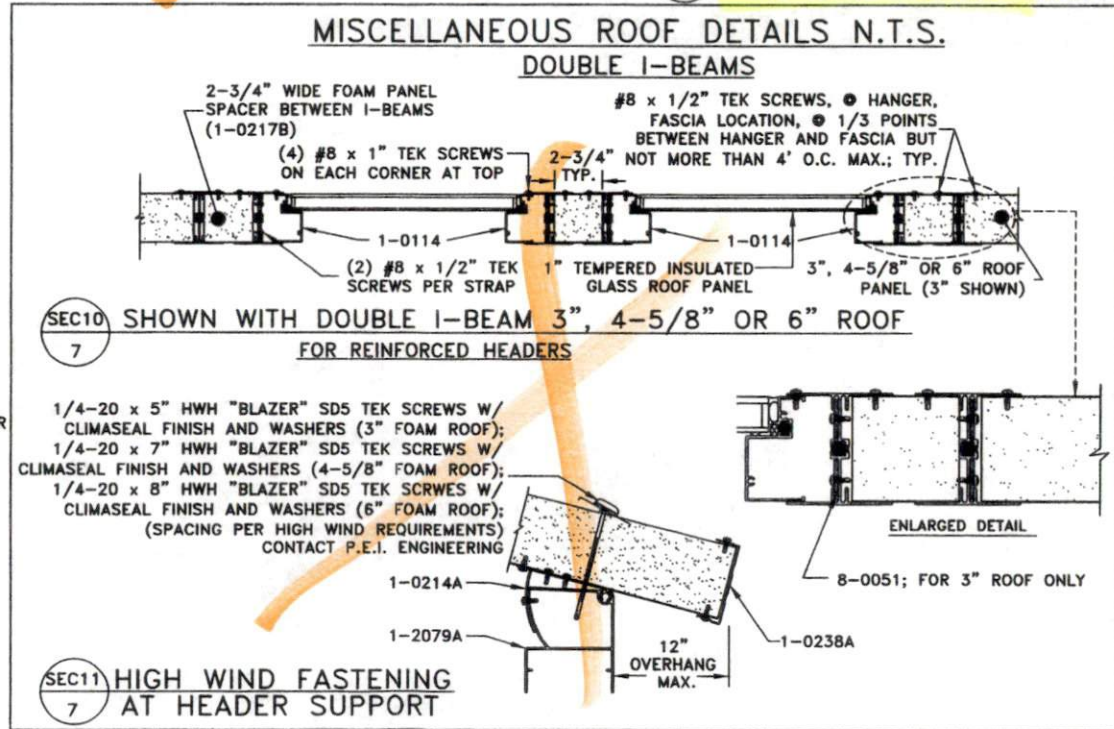

SUNROOM DETAILS

2012

PROFESSIONAL

2012

2012

DRAWN BY: VNG

DATE: 09-17-03

SCALE: NTS

VERSION: E:1(10/25/10)

patio ENCLOSURES, INC.®

AN EMPLOYEE OWNED COMPANY

720 E. HIGHLAND ROAD  
MACEDONIA, OHIO 44056

THIS DRAWING IS THE PROPERTY OF PATIO ENCLOSURES, INC. ALL RIGHTS RESERVED. DUPLICATION OF THIS DRAWING IN ANY FORM IS NOT PERMITTED WITHOUT THE EXPRESSED WRITTEN CONSENT OF PATIO ENCLOSURES, INC.

THE STANDARD PLANS, ELEVATIONS, SECTIONS & DETAILS CONTAINED HEREIN ARE IN ACCORDANCE WITH INSTALLATION PROCEDURES ESTABLISHED BY PATIO ENCLOSURES, INC. AND ARE FOR GENERAL REFERENCE. SEE INDIVIDUAL JOB SUBMITTAL FOR SPECIFIC PROVISIONS, UNIT WORKS & WALL HEIGHTS.

STANDARD RESIDENTIAL AAS DETAILS