

Initial Application Date: 6/12/17

Application # 17-50041597

Central Permitting 108 E. Front Street, Lillington, NC 27546 Phone: (910) 893-7525 ext:2 Fax: (910) 893-2793 www.harnett.org/permits

COUNTY OF HARNETT RESIDENTIAL LAND USE APPLICATION

\*\*A RECORDED SURVEY MAP, RECORDED DEED (OR OFFER TO PURCHASE) & SITE PLAN ARE REQUIRED WHEN SUBMITTING A LAND USE APPLICATION\*\*

LANDOWNER: John M. Woodason Mailing Address: 635 Tylerstone Dr.  
City: Fuquay Varina State: NC Zip: 27526 Contact No: 919-813-9405 Email: woodason59@yahoo.com

APPLICANT: John M. Woodason Mailing Address: 635 Tylerstone Dr.  
City: Fuquay Varina State: NC Zip: 27526 Contact No: 919-813-9405 Email: woodason59@yahoo.com  
\*Please fill out applicant information if different than landowner

CONTACT NAME APPLYING IN OFFICE: \_\_\_\_\_ Phone # \_\_\_\_\_

PROPERTY LOCATION: Subdivision: Victoria Hills Lot #: 127 Lot Size: .83

State Road # 2230 State Road Name: Tylerstone Dr. Map Book & Page: 2005, 655

Parcel: 08065302 0105 07 PIN: 0663-14-5890.000

Zoning: RA-30 Flood Zone: X Watershed: GIS Deed Book & Page: 3342, 1 Power Company\*: Duke

\*New structures with Progress Energy as service provider need to supply premise number \_\_\_\_\_ from Progress Energy.

PROPOSED USE:

- SFD: (Size \_\_\_\_\_ x \_\_\_\_\_) # Bedrooms: \_\_\_\_\_ # Baths: \_\_\_\_\_ Basement(w/wo bath): \_\_\_\_\_ Garage: \_\_\_\_\_ Deck: \_\_\_\_\_ Crawl Space: \_\_\_\_\_ Slab: \_\_\_\_\_ Slab: \_\_\_\_\_  
(Is the bonus room finished? ( ) yes ( ) no w/ a closet? ( ) yes ( ) no (if yes add in with # bedrooms))
- Mod: (Size \_\_\_\_\_ x \_\_\_\_\_) # Bedrooms \_\_\_\_\_ # Baths \_\_\_\_\_ Basement (w/wo bath) \_\_\_\_\_ Garage: \_\_\_\_\_ Site Built Deck: \_\_\_\_\_ On Frame \_\_\_\_\_ Off Frame \_\_\_\_\_  
(Is the second floor finished? ( ) yes ( ) no Any other site built additions? ( ) yes ( ) no
- Manufactured Home: \_\_\_\_\_ SW \_\_\_\_\_ DW \_\_\_\_\_ TW (Size \_\_\_\_\_ x \_\_\_\_\_) # Bedrooms: \_\_\_\_\_ Garage: \_\_\_\_\_ (site built? \_\_\_\_\_) Deck: \_\_\_\_\_ (site built? \_\_\_\_\_)
- Duplex: (Size \_\_\_\_\_ x \_\_\_\_\_) No. Buildings: \_\_\_\_\_ No. Bedrooms Per Unit: \_\_\_\_\_
- Home Occupation: # Rooms: \_\_\_\_\_ Use: \_\_\_\_\_ Hours of Operation: \_\_\_\_\_ #Employees: \_\_\_\_\_
- Addition/Accessory/Other: (Size \_\_\_\_\_ x \_\_\_\_\_) Use: Deck & Pool (21' round) Closets in addition? ( ) yes (X) no

Water Supply:  County \_\_\_\_\_ Existing Well \_\_\_\_\_ New Well (# of dwellings using well \_\_\_\_\_) \*Must have operable water before final

Sewage Supply: \_\_\_\_\_ New Septic Tank (Complete Checklist)  Existing Septic Tank (Complete Checklist) \_\_\_\_\_ County Sewer

Does owner of this tract of land, own land that contains a manufactured home within five hundred feet (500') of tract listed above? ( ) yes (X) no

Does the property contain any easements whether underground or overhead ( ) yes (X) no

Structures (existing or proposed): Single family dwellings:  existing Manufactured Homes: \_\_\_\_\_ Other (specify): proposed deck and pool

Required Residential Property Line Setbacks:

Front	Minimum	<u>35</u>	Actual	<u>100+</u>
Rear		<u>25</u>		<u>25+</u>
Closest Side		<u>10</u>		<u>19'</u>
Sidestreet/corner lot				
Nearest Building on same lot		<u>10</u>		

Comments: 12x17 and 9x15 deck wit 21' round above ground pool.

6.12.17  
N

SPECIFIC DIRECTIONS TO THE PROPERTY FROM LILLINGTON:

Head north on S. Main St. toward E. Harnett St. Turn left onto McKinney Pkwy. Turn left onto US-401 N. Turn right onto Lafayette Rd. Turn right onto Victoria Hills Dr. S. Turn right onto Tylerstone Dr.

If permits are granted I agree to conform to all ordinances and laws of the State of North Carolina regulating such work and the specifications of plans submitted. I hereby state that foregoing statements are accurate and correct to the best of my knowledge. Permit subject to revocation if false information is provided.

John M. Woodson  
Signature of Owner or Owner's Agent

6/14/17  
Date

\*\*\*It is the owner/applicants responsibility to provide the county with any applicable information about the subject property, including but not limited to: boundary information, house location, underground or overhead easements, etc. The county or its employees are not responsible for any incorrect or missing information that is contained within these applications.\*\*\*

\*\*\*This application expires 6 months from the initial date if permits have not been issued\*\*

100.01'

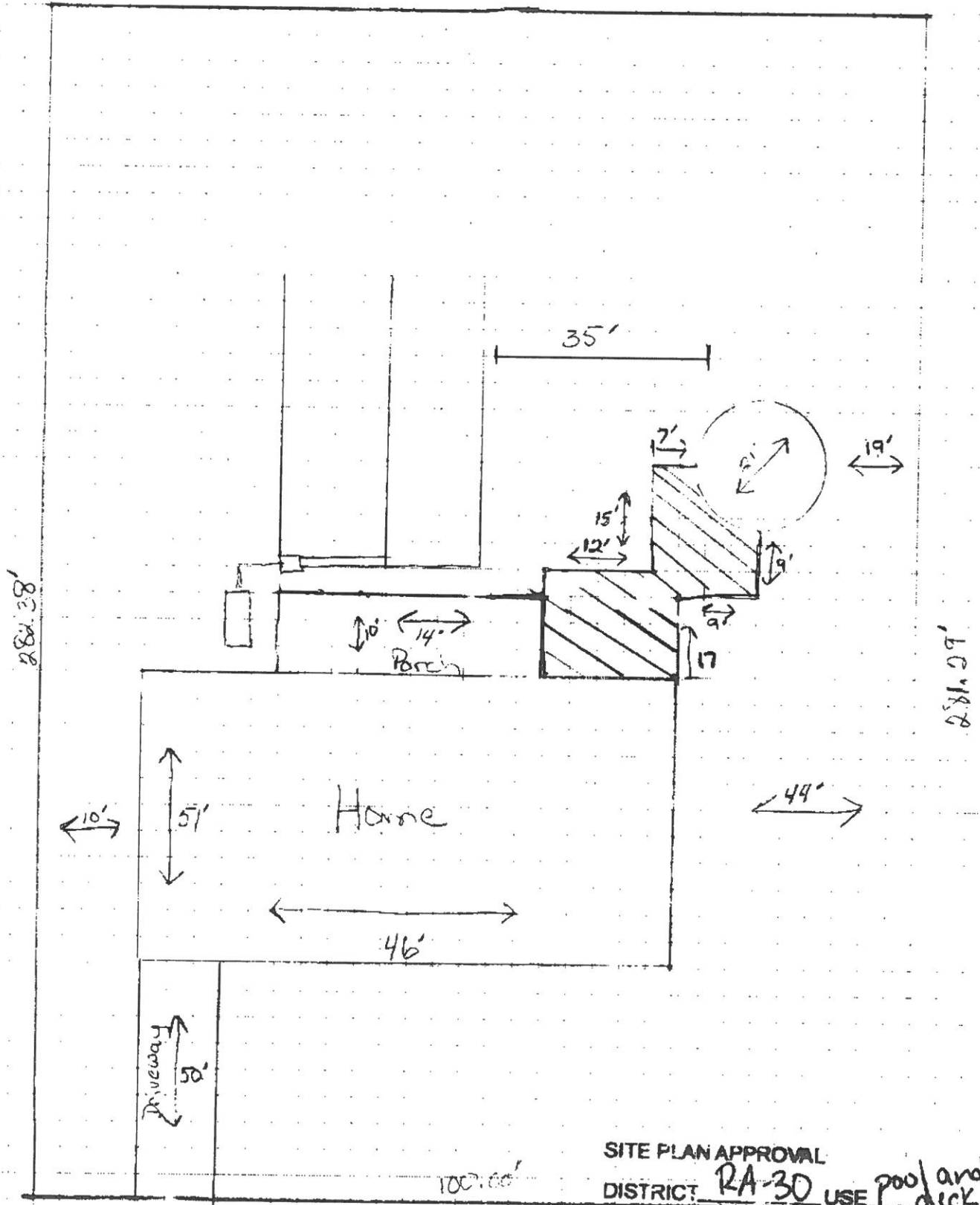

100.00'

SITE PLAN APPROVAL  
 DISTRICT RA-30 USE pool and deck  
 #BEDROOMS 3  
BP 6/12/17  
 ADMINISTRATOR





NAME: John Woodason

APPLICATION #: 17-50041597

**\*This application to be filled out when applying for a septic system inspection.\***

**County Health Department Application for Improvement Permit and/or Authorization to Construct**

IF THE INFORMATION IN THIS APPLICATION IS FALSIFIED, CHANGED, OR THE SITE IS ALTERED, THEN THE IMPROVEMENT PERMIT OR AUTHORIZATION TO CONSTRUCT SHALL BECOME INVALID. The permit is valid for either 60 months or without expiration depending upon documentation submitted. (Complete site plan = 60 months; Complete plat = without expiration) 910-893-7525 option 1

CONFIRMATION # 170 6/12/17 022461

**Environmental Health New Septic System Code 800**

- **All property irons must be made visible.** Place "pink property flags" on each corner iron of lot. All property lines must be clearly flagged approximately every 50 feet between corners.
- Place "orange house corner flags" at each corner of the proposed structure. Also flag driveways, garages, decks, out buildings, swimming pools, etc. Place flags per site plan developed at/for Central Permitting.
- Place orange Environmental Health card in location that is easily viewed from road to assist in locating property.
- If property is thickly wooded, Environmental Health requires that you clean out the undergrowth to allow the soil evaluation to be performed. Inspectors should be able to walk freely around site. **Do not grade property.**
- **All lots to be addressed within 10 business days after confirmation. \$25.00 return trip fee may be incurred for failure to uncover outlet lid, mark house corners and property lines, etc. once lot confirmed ready.**
- After preparing proposed site call the voice permitting system at 910-893-7525 option 1 to schedule and use code **800** (after selecting notification permit if multiple permits exist) for Environmental Health inspection. Please note confirmation number given at end of recording for proof of request.
- Use Click2Gov or IVR to verify results. Once approved, proceed to Central Permitting for permits.

**Environmental Health Existing Tank Inspections Code 800**

- Follow above instructions for placing flags and card on property.
- Prepare for inspection by removing soil over **outlet end** of tank as diagram indicates, and lift lid straight up (if possible) and then **put lid back in place.** (Unless inspection is for a septic tank in a mobile home park)
- **DO NOT LEAVE LIDS OFF OF SEPTIC TANK**
- After uncovering **outlet end** call the voice permitting system at 910-893-7525 option 1 & select notification permit if multiple permits, then use code **800** for Environmental Health inspection. Please note confirmation number given at end of recording for proof of request.
- Use Click2Gov or IVR to hear results. Once approved, proceed to Central Permitting for remaining permits.

**SEPTIC**

If applying for authorization to construct please indicate desired system type(s): can be ranked in order of preference, must choose one.

- Accepted       Innovative       Conventional       Any  
 Alternative       Other

The applicant shall notify the local health department upon submittal of this application if any of the following apply to the property in question. If the answer is "yes", applicant **MUST ATTACH SUPPORTING DOCUMENTATION**:

- YES     NO    Does the site contain any Jurisdictional Wetlands?  
 YES     NO    Do you plan to have an irrigation system now or in the future?  
 YES     NO    Does or will the building contain any drains? Please explain.  
 YES     NO    Are there any existing wells, springs, waterlines or Wastewater Systems on this property?  
 YES     NO    Is any wastewater going to be generated on the site other than domestic sewage?  
 YES     NO    Is the site subject to approval by any other Public Agency?  
 YES     NO    Are there any Basements or Right of Ways on this property?  
 YES     NO    Does the site contain any existing water, cable, phone or underground electric lines?  
 If yes please call No Cuts at 800-632-4949 to locate the lines. This is a free service.

I Have Read This Application And Certify That The Information Provided Herein Is True, Complete And Correct. Authorized County And State Officials Are Granted Right Of Entry To Conduct Necessary Inspections To Determine Compliance With Applicable Laws And Rules. I Understand That I Am Solely Responsible For The Proper Identification And Labeling Of All Property Lines And Corners And Making The Site Accessible So That A Complete Site Evaluation Can Be Performed.

John M Woodason  
PROPERTY OWNERS OR OWNERS LEGAL REPRESENTATIVE SIGNATURE (REQUIRED)

6/11/17  
DATE