

HTE# 16-5-40218

Harnett County Department of Public Health

29261

Improvement Permit

A building permit cannot be issued with only an Improvement Permit

ISSUED TO: James Hartman PROPERTY LOCATION: 245 Briar Creek Ln.
 SUBDIVISION: Fleming Rd. (SR 2004) LOT # _____
 NEW REPAIR EXPANSION
 Type of Structure: Apartment 1BR (2nd story Barn)
 Proposed Wastewater System Type: 25% Reduction System
 Projected Daily Flow: 240 GPD
 Number of bedrooms: 2 Number of Occupants: 4 max
 Basement Yes No
 Pump Required: Yes No May be required based on final location and elevations of facilities
 Type of Water Supply: Community Public Well Distance from well _____ feet
 Permit conditions: _____ Permit valid for: Five years
 No expiration

Authorized State Agent: [Signature] Date: 12-12-16 SEE ATTACHED SITE SKETCH
 The issuance of this permit by the Health Department in no way guarantees the issuance of other permits. The permit holder is responsible for checking with appropriate governing bodies in meeting their requirements. This site is subject to revocation if the site plan, plat, or the intended use changes. The Improvement Permit shall not be affected by a change in ownership of the site. This permit is subject to compliance with the provisions of the Laws and Rules for Sewage Treatment and Disposal and to conditions of this permit.

Construction Authorization

(Required for Building Permit)

The construction and installation requirements of Rules .1950, .1952, .1954, .1955, .1956, .1957, .1958, and .1959 are incorporated by references into this permit and shall be met. Systems shall be installed in accordance with the attached system layout.

ISSUED TO: James Hartman PROPERTY LOCATION: 245 Briar Creek Ln
 SUBDIVISION: Fleming Rd. (SR 2004) LOT # _____
 Facility Type: Apartment 1BR (2nd story Barn) New Expansion Repair
 Basement? Yes No Basement Fixtures? Yes No
 Type of Wastewater System** 25% Reduction System (Initial) Wastewater Flow: 240 GPD
 (See note below, if applicable)
25% Reduction System (Repair)

Installation Requirements/Conditions

Septic Tank Size <u>900 (MIN)</u> gallons	Number of trenches <u>3</u>	Exact length of each trench <u>60</u> feet	Trench Spacing: <u>9</u> Feet on Center
Pump Tank Size _____ gallons	Trenches shall be installed on contour at a	Maximum Trench Depth of: <u>18</u> inches	Soil Cover: <u>6</u> inches
	(Trench bottoms shall be level to +/-1/4"	in all directions)	(Maximum soil cover shall not exceed 36" above the trench bottom)
Pump Requirements: _____ ft. TDH vs. _____ GPM			Aggregate Depth: <u>6</u> inches below pipe
Conditions: <u>2 Bedroom Maximum Per STATE CDR</u>			<u>2</u> inches above pipe
			<u>12</u> inches total

**WATER LINES (INCLUDING IRRIGATION) MUST BE 10FT. FROM ANY PART OF SEPTIC SYSTEM OR REPAIR AREA.
NO UTILITIES ALLOWED IN INITIAL OR REPAIR DRAIN FIELD AREA.**

**If applicable: I understand the system type specified is different from the type specified on the application. I accept the specifications of this permit.

Owner/Legal Representative Signature: _____ Date: _____

This Construction Authorization is subject to revocation if the site plan, plat, or the intended use changes. The Construction Authorization shall not be transferred when there is a change in ownership of the site. This Construction Authorization is subject to compliance with the provisions of the Laws and Rules for Sewage Treatment and Disposal and to the conditions of this permit. SEE ATTACHED SITE SKETCH

Authorized State Agent: [Signature] Date: 12/05/2016
 Construction Authorization Expiration Date: 12/05/2021

HTE# 16-5-40218

Permit # 29261

Harnett County Department of Public Health Site Sketch

PROPERTY LOCATOR: 245 Briar Creek Ln.

ISSUED TO: James Hartman

SUBDIVISION Fleming Rd. (SR 2004) LOT #

Authorized State Agent:

Date: 12/12/2016

John W. Wood, REHS-I

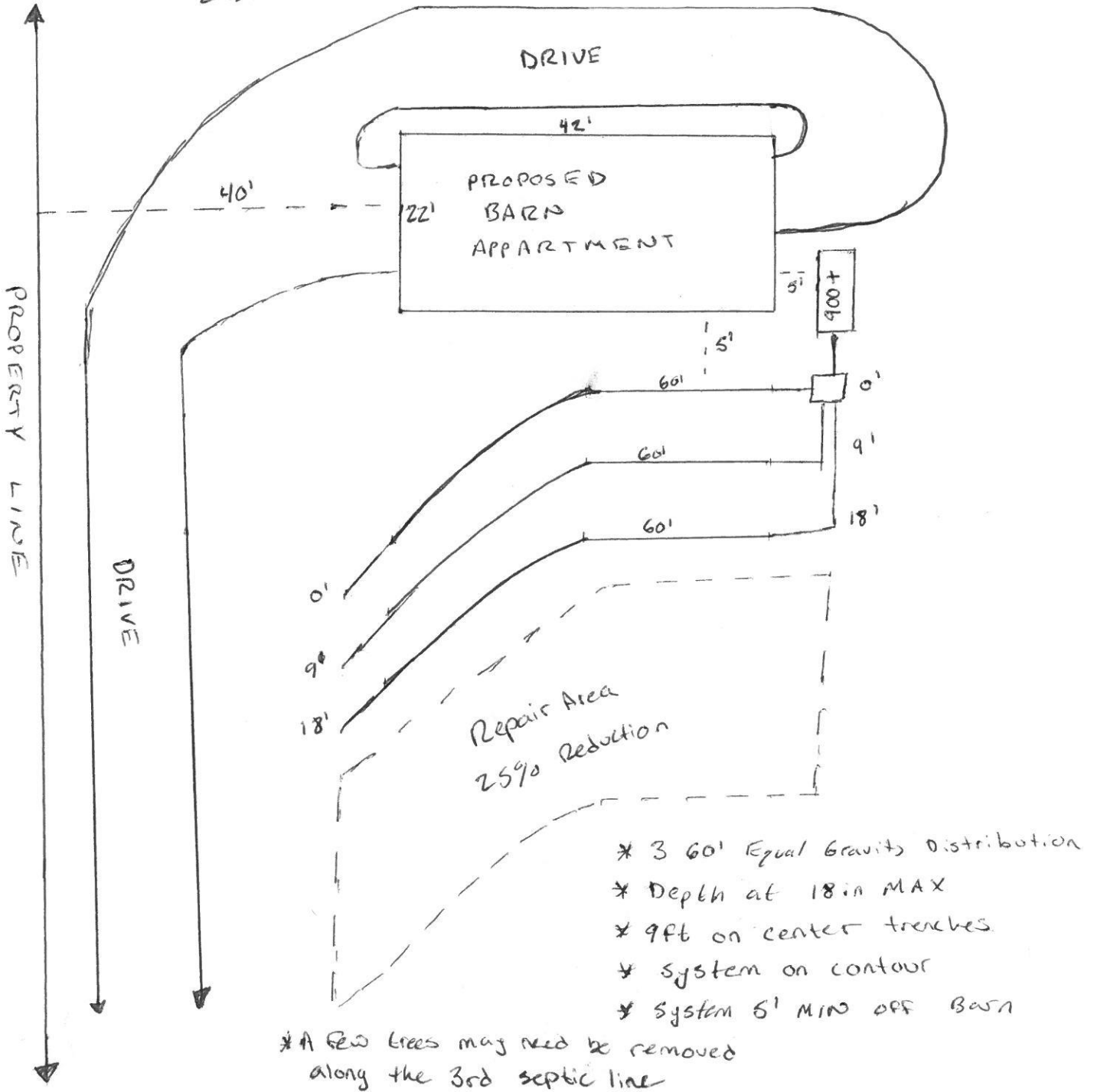

- * 3 60' Equal Gravits Distribution
- * Depth at 18" MAX
- * 9ft on center trenches
- * System on contour
- * System 5' MIN OFF BARN

* A few trees may need to be removed along the 3rd septic line