

Initial Application Date: 1.13.16

Application # 10-50037844

Central Permitting 108 E. Front Street, Lillington, NC 27546 Phone: (910) 893-7525 ext:2 Fax: (910) 893-2793 www.harnett.org/permits
COUNTY OF HARNETT RESIDENTIAL LAND USE APPLICATION CU# _____

****A RECORDED SURVEY MAP, RECORDED DEED (OR OFFER TO PURCHASE) & SITE PLAN ARE REQUIRED WHEN SUBMITTING A LAND USE APPLICATION****

LANDOWNER: Kevin Snow Mailing Address: 66 Kentucky Derby Lane
City: Lillington State: NC Zip: 27546 Contact No: _____ Email: _____

APPLICANT: Porch Conversion Mailing Address: 6821 Market St MH74@Icloud
City: Wilmington State: NC Zip: 28405 Contact No: (910) 777 Email: ICOM
*Please fill out applicant information if different than landowner

CONTACT NAME APPLYING IN OFFICE: Mike Trowbridge -3363 Phone # (910) 261-8787

PROPERTY LOCATION: Subdivision: Watters Ridge Pk A Lot #: 3 Lot Size: 1.46 AC

State Road # _____ State Road Name: _____ Map Book & Page 2010, 848

Parcel: 03.0507.0200.02 PIN: 0507.14.2701

Zoning: RA20R Flood Zone: X Watershed: NA Deed Book & Page: 2950, 74 Power Company*: _____

*New structures with Progress Energy as service provider need to supply premise number _____ from Progress Energy.

PROPOSED USE:

- SFD: (Size _____ x _____) # Bedrooms: _____ # Baths: _____ Basement(w/wo bath): _____ Garage: _____ Deck: _____ Crawl Space: _____ Slab: _____ Monolithic Slab: _____
(Is the bonus room finished? () yes () no w/ a closet? () yes () no (if yes add in with # bedrooms))
- Mod: (Size _____ x _____) # Bedrooms _____ # Baths _____ Basement (w/wo bath) _____ Garage: _____ Site Built Deck: _____ On Frame _____ Off Frame _____
(Is the second floor finished? () yes () no Any other site built additions? () yes () no
- Manufactured Home: _____ SW _____ DW _____ TW (Size _____ x _____) # Bedrooms: _____ Garage: _____ (site built? _____) Deck: _____ (site built? _____)
- Duplex: (Size _____ x _____) No. Buildings: _____ No. Bedrooms Per Unit: _____
- Home Occupation: # Rooms: _____ Use: _____ Hours of Operation: _____ #Employees: _____

Addition/Accessory/Other: (Size 12 x 12) Use: Screened Room Closets in addition? () yes () no

Water Supply: County _____ Existing Well _____ New Well (# of dwellings using well _____) *Must have operable water before final

Sewage Supply: _____ New Septic Tank (Complete Checklist) Existing Septic Tank (Complete Checklist) _____ County Sewer

Does owner of this tract of land, own land that contains a manufactured home within five hundred feet (500') of tract listed above? () yes () no

Does the property contain any easements whether underground or overhead () yes () no

Structures (existing or proposed): Single family dwellings: 1 Manufactured Homes: _____ Other (specify): _____

Required Residential Property Line Setbacks:

	Minimum	Actual
Front	<u>35</u>	<u>35+</u>
Rear	<u>25</u>	<u>57'</u>
Closest Side	<u>10</u>	<u>26</u>
Sidestreet/corner lot	<u>20</u>	<u>—</u>
Nearest Building on same lot	<u>10</u>	<u>—</u>

Comments: existing

SPECIFIC DIRECTIONS TO THE PROPERTY FROM LILLINGTON: _____

TRETTOR'S RIDGE
LOT 3

If permits are granted I agree to conform to all ordinances and laws of the State of North Carolina regulating such work and the specifications of plans submitted. I hereby state that foregoing statements are accurate and correct to the best of my knowledge. Permit subject to revocation if false information is provided.

* _____
Signature of Owner or Owner's Agent

1-13-16

Date

It is the owner/applicants responsibility to provide the county with any applicable information about the subject property, including but not limited to: boundary information, house location, underground or overhead easements, etc. The county or its employees are not responsible for any incorrect or missing information that is contained within these applications.

****This application expires 6 months from the initial date if permits have not been issued****

**HARNETT COUNTY, NORTH CAROLINA
GIS/LAND RECORDS**

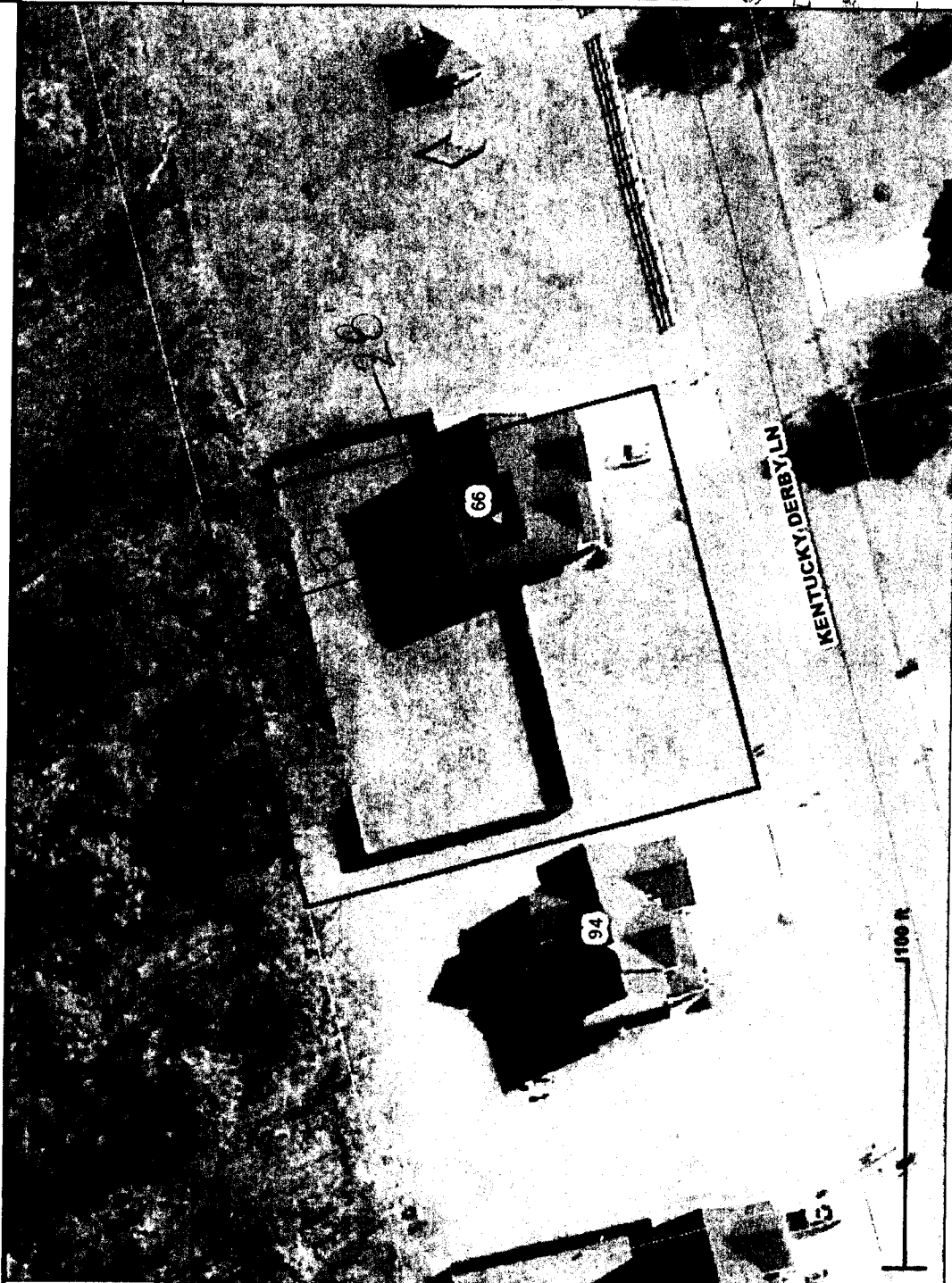

Harnett County GIS
305 W Cornelius Harnett Blvd, Suite 100
Lillington, NC 27546
Phone: 910-893-7523 www.harnett.org

Any use of this map shall be at the sole risk of the user of this map. Although, all effort has been taken to insure accuracy in the data presented, Harnett County makes no warranty, expressed or implied, as to the accuracy of this information represented herein. Any user of this product shall hold harmless Harnett County, its elected officials, employees and agents from and against any claim, damage, loss, action, cause of action, or liability arising from the use of this GIS product.



- Address Points
- Road Centerlines
- Major Roads
- Rivers
- Parcels
- County_Boundary
- CityLimits
- Harnett_2013 sid
- Red: Band_1
- Green: Band_2
- Blue: Band_3

SITE PLAN APPROVAL
DISTRICT_2A20P USE
BEDROOMS N/A
1-13-16
ZONING ADMIN: ST. RATOR

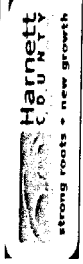

NAME: MIKE Trowbridge

APPLICATION #: 37844

This application to be filled out when applying for a septic system inspection.

County Health Department Application for Improvement Permit and/or Authorization to Construct

IF THE INFORMATION IN THIS APPLICATION IS FALSIFIED, CHANGED, OR THE SITE IS ALTERED, THEN THE IMPROVEMENT PERMIT OR AUTHORIZATION TO CONSTRUCT SHALL BECOME INVALID. The permit is valid for either 60 months or without expiration depending upon documentation submitted. (Complete site plan = 60 months; Complete plat = without expiration)

910-893-7525 option 1

CONFIRMATION # _____

Environmental Health New Septic System Code 800

- **All property irons must be made visible.** Place "pink property flags" on each corner iron of lot. All property lines must be clearly flagged approximately every 50 feet between corners.
- Place "orange house corner flags" at each corner of the proposed structure. Also flag driveways, garages, decks, out buildings, swimming pools, etc. Place flags per site plan developed at/for Central Permitting.
- Place orange Environmental Health card in location that is easily viewed from road to assist in locating property.
- If property is thickly wooded, Environmental Health requires that you clean out the **undergrowth** to allow the soil evaluation to be performed. Inspectors should be able to walk freely around site. **Do not grade property.**
- **All lots to be addressed within 10 business days after confirmation. \$25.00 return trip fee may be incurred for failure to uncover outlet lid, mark house corners and property lines, etc. once lot confirmed ready.**
- After preparing proposed site call the voice permitting system at 910-893-7525 option 1 to schedule and use code **800** (after selecting notification permit if multiple permits exist) for Environmental Health inspection. Please note confirmation number given at end of recording for proof of request.

Environmental Health Existing Tank Inspections Code 800

- Follow above instructions for placing flags and card on property.
- Prepare for inspection by removing soil over **outlet end** of tank as diagram indicates, and lift lid straight up (if possible) and then **put lid back in place.** (Unless inspection is for a septic tank in a mobile home park)
- **DO NOT LEAVE LIDS OFF OF SEPTIC TANK**
- After uncovering **outlet end** call the voice permitting system at 910-893-7525 option 1 & select notification permit if multiple permits, then use code **800** for Environmental Health inspection. Please note confirmation number given at end of recording for proof of request.
- Use Click2Gov or IVR to hear results. Once approved, proceed to Central Permitting for remaining permits.

SEPTIC

If applying for authorization to construct please indicate desired system type(s): can be ranked in order of preference, must choose one.

- Accepted Innovative Conventional Any
- Alternative Other _____

The applicant shall notify the local health department upon submittal of this application if any of the following apply to the property in question. If the answer is "yes", applicant **MUST ATTACH SUPPORTING DOCUMENTATION**:

- YES NO Does the site contain any Jurisdictional Wetlands?
- YES NO Do you plan to have an irrigation system now or in the future?
- YES NO Does or will the building contain any drains? Please explain. _____
- YES NO Are there any existing wells, springs, waterlines or Wastewater Systems on this property?
- YES NO Is any wastewater going to be generated on the site other than domestic sewage?
- YES NO Is the site subject to approval by any other Public Agency?
- YES NO Are there any Easements or Right of Ways on this property?
- YES NO Does the site contain any existing water, cable, phone or underground electric lines?

If yes please call No Cuts at 800-632-4949 to locate the lines. This is a free service.

I Have Read This Application And Certify That The Information Provided Herein Is True, Complete And Correct. Authorized County And State Officials Are Granted Right Of Entry To Conduct Necessary Inspections To Determine Compliance With Applicable Laws And Rules.

I Understand That I Am Solely Responsible For The Proper Identification And Labeling Of All Property Lines And Corners And Making The Site Accessible So That A Complete Site Evaluation Can Be Performed.

Mike Trowbridge
PROPERTY OWNERS OR OWNERS LEGAL REPRESENTATIVE SIGNATURE (REQUIRED)

1-13-16
DATE

09/09/11

Application #

16500-37-844

Harnett County Central Permitting
PO Box 65 Lillington NC 27546
910 893 7525 Fax 910 893 2793 www.harnett.org/permits

Each section below to be filled out by whomever performing work. Must be owner or licensed contractor. Address company name & phone must match.

Application for Residential Building and Trades Permit

Owner's Name KELVIN SNOW Date _____
Site Address 66 KENTUCKY DERBY LANE LILLINGTON, NC 27546 Phone 9103911802
Directions to job site from Lillington 401 south then right onto 27 west then left onto Docs rd then right onto Kentucky Derby lane

Subdivision TROTTERS RIDGE PH 1A Lot 3
Description of Proposed Work Build engineered screenroom on deck # of Bedrooms n/a
Heated SF _____ Unheated SF 144 Finished Bonus Room? _____ Crawl Space x Slab _____

General Contractor Information

PORCH CONVERSION 910-777-3363
Building Contractor's Company Name 6821 MARKET STREET WILMINGTON, NC 28405 Telephone _____
Address n/a > 30 K Email Address porchconversion@gmail.com
License # _____

Electrical Contractor Information

* Description of Work misc outlet & FAN Service Size _____ Amps T-Pole _____ Yes _____ No _____
HG Hicks Electric 919-235-8130
Electrical Contractor's Company Name _____ Telephone _____
Address 217 West Martin Street Raleigh, NC 27601 Email Address _____
License # _____

Mechanical/HVAC Contractor Information

Description of Work _____
Mechanical Contractor's Company Name _____ Telephone _____
Address _____ Email Address _____
License # _____

Plumbing Contractor Information

Description of Work _____ # Baths _____
Plumbing Contractor's Company Name _____ Telephone _____
Address _____ Email Address _____
License # _____

Insulation Contractor Information

Insulation Contractor's Company Name & Address _____ Telephone _____

*NOTE General Contractor must fill out and sign the second page of this application

I hereby certify that I have the authority to make necessary application that the application is correct and that the construction will conform to the regulations in the Building Electrical Plumbing and Mechanical codes and the Harnett County Zoning Ordinance I state the information on the above contractors is correct as known to me and that **by signing below I have obtained all subcontractors permission to obtain these permits** and if **any** changes occur including listed contractors site plan number of bedrooms building and trade plans Environmental Health permit changes or proposed use changes I certify it is my responsibility to notify the Harnett County Central Permitting Department of any and all changes

EXPIRED PERMIT FEES - 6 Months to 2 years permit re-issue fee is \$150 00 After 2 years re-issue fee is as per current fee schedule

Debra Sparks
Signature of Owner/Contractor/Officer(s) of Corporation

Feb 18, 2016
Date

Affidavit for Worker's Compensation N C G S 87-14

The undersigned applicant being the

General Contractor Owner Officer/Agent of the Contractor or Owner

Do hereby confirm under penalties of perjury that the person(s) firm(s) or corporation(s) performing the work set forth in the permit

Has three (3) or more employees and has obtained workers compensation insurance to cover them

Has one (1) or more subcontractors(s) and has obtained workers compensation insurance to cover them

Has one (1) or more subcontractors(s) who has their own policy of workers compensation insurance covering themselves

Has no more than two (2) employees and no subcontractors

While working on the project for which this permit is sought it is understood that the Central Permitting Department issuing the permit may require certificates of coverage of worker s compensation insurance prior to issuance of the permit and at any time during the permitted work from any person firm or corporation carrying out the work

Company or Name

Sign w/Title

Debra Sparks

Date

2/18/16

HARNETT COUNTY CENTRAL PERMITTING

P.O. BOX 65

LILLINGTON, NC 27546

For Inspections Call: (910) 893-7525 Fax: (910) 893-2793

Bldg Insp scheduled before 2pm available next business day.

Application Number	16-50037844	Page	2
Property Address	66 KENTUCKY DERBY LN	Date	2/18/16
PARCEL NUMBER	03-0507- - -0200- -02-		
Application description	CP ADD & ALTER RESIDENTIAL		
Subdivision Name	TROTTERS RIDGE PH1A 9LOTS		
Property Zoning	RES/AGRI DIST - RA-20R		

Required Inspections

Seq	Phone Insp#	Insp Code	Description	Initials	Date
Permit type RESIDENTIAL BUILDING PERMIT					
999	103	B103	R*BLDG FOUND & TEMP SVC POLE	_____	___/___/___
999	105	B105	R*OPEN FLOOR	_____	___/___/___
999	101	B101	R*BLDG FOOTING / TEMP SVC POLE	_____	___/___/___
999	131	R131	ONE TRADE FINAL	_____	___/___/___
999	125	R125	ONE TRADE ROUGH IN	_____	___/___/___
999	229	R229	TWO TRADE FINAL	_____	___/___/___
999	225	R225	TWO TRADE ROUGH IN	_____	___/___/___
Permit type RESIDENTIAL ELECTRICAL PERMIT					
999	211	E211	R*ELEC ABOVE CEILING	_____	___/___/___
999	217	E217	R*ELEC RECONNECT	_____	___/___/___
999	205	E205	R*ELEC UNDER SLAB	_____	___/___/___
999	215	E215	R*ELEC. UND. POOL	_____	___/___/___
999	213	E213	R*ELECTRICAL UNDERGROUND	_____	___/___/___
999	131	R131	ONE TRADE FINAL	_____	___/___/___
999	125	R125	ONE TRADE ROUGH IN	_____	___/___/___
Permit type LAND USE PERMIT					
999	818	Z818	PZ*ZONING INSPECTION	_____	___/___/___
999	820	Z820	PZ*ZONING/FINAL INSPECTION	_____	___/___/___

HARNETT COUNTY CENTRAL PERMITTING

P.O. BOX 65

LILLINGTON, NC 27546

For Inspections Call: (910) 893-7525 Fax: (910) 893-2793

Bldg Insp scheduled before 2pm available next business day.

Application Number	16-50037844	Date	2/18/16
Property Address	66 KENTUCKY DERBY LN		
PARCEL NUMBER	03-0507- - -0200- -02-		
Application type description	CP ADD & ALTER RESIDENTIAL		
Subdivision Name	TROTTERS RIDGE PH1A 9LOTS		
Property Zoning	RES/AGRI DIST - RA-20R		

Owner

SNOW KELVIN
66 KENTUCKY DERBY LANE
LILLINGTON NC 27546

Contractor

OWNER

Applicant

PORCH CONVERSIONS #3
6821 MARKET ST
WILMINGTON NC 28405
(910) 777-3363

--- Structure Information 000 000 12X12 SCREENED ROOM (THREE SEASON RM)
Flood Zone FLOOD ZONE X
Other struct info SEPTIC - EXISTING? EXISTING COUNTY
WATER SUPPLY

Permit RESIDENTIAL BUILDING PERMIT

Additional desc
Phone Access Code 1124213
Issue Date 2/18/16 Valuation 0
Expiration Date 2/17/17

Permit RESIDENTIAL ELECTRICAL PERMIT

Additional desc
Phone Access Code 1126879
Issue Date 2/18/16 Valuation 0
Expiration Date 2/17/17

Permit LAND USE PERMIT

Additional desc
Phone Access Code 1126887
Issue Date 2/18/16 Valuation 0
Expiration Date 8/16/16

Special Notes and Comments

T/S: 01/14/2016 08:34 AM DJOHNSON --
TROTTERS RIDGE PHS 1A LOT 3
66 KENTUCKY DERBY LN
