

HTE# 14-5-32801

# Harnett County Department of Public Health

24711

PERMIT # 29286

## Operation Permit

New Installation  Septic Tank  Nitrification Line  Repair  Expansion

PROPERTY LOCATION: 321 Arbor Crest Ln. (S2 NC 27 E)

Name: (owner) Edward But Wallace SUBDIVISION Arbor Crest LOT # 11

System Installer: Ricky Holland Registration #

Basement with plumbing:  Garage  Number of Bedrooms 3

Type of Water Supply:  Community  Public  Well Distance from well \_\_\_\_\_ feet

System Type: 25% Reduction Sys. III Types V and VI Systems expire in 5 years.

(In accordance with Table V a)

Owner must contact Health Department 6 months prior to expiration for permit renewal.

This system has been installed in compliance with applicable North Carolina General Statutes, Rules for Sewage Treatment and Disposal, and all conditions of the Improvement Permit and Construction Authorization.

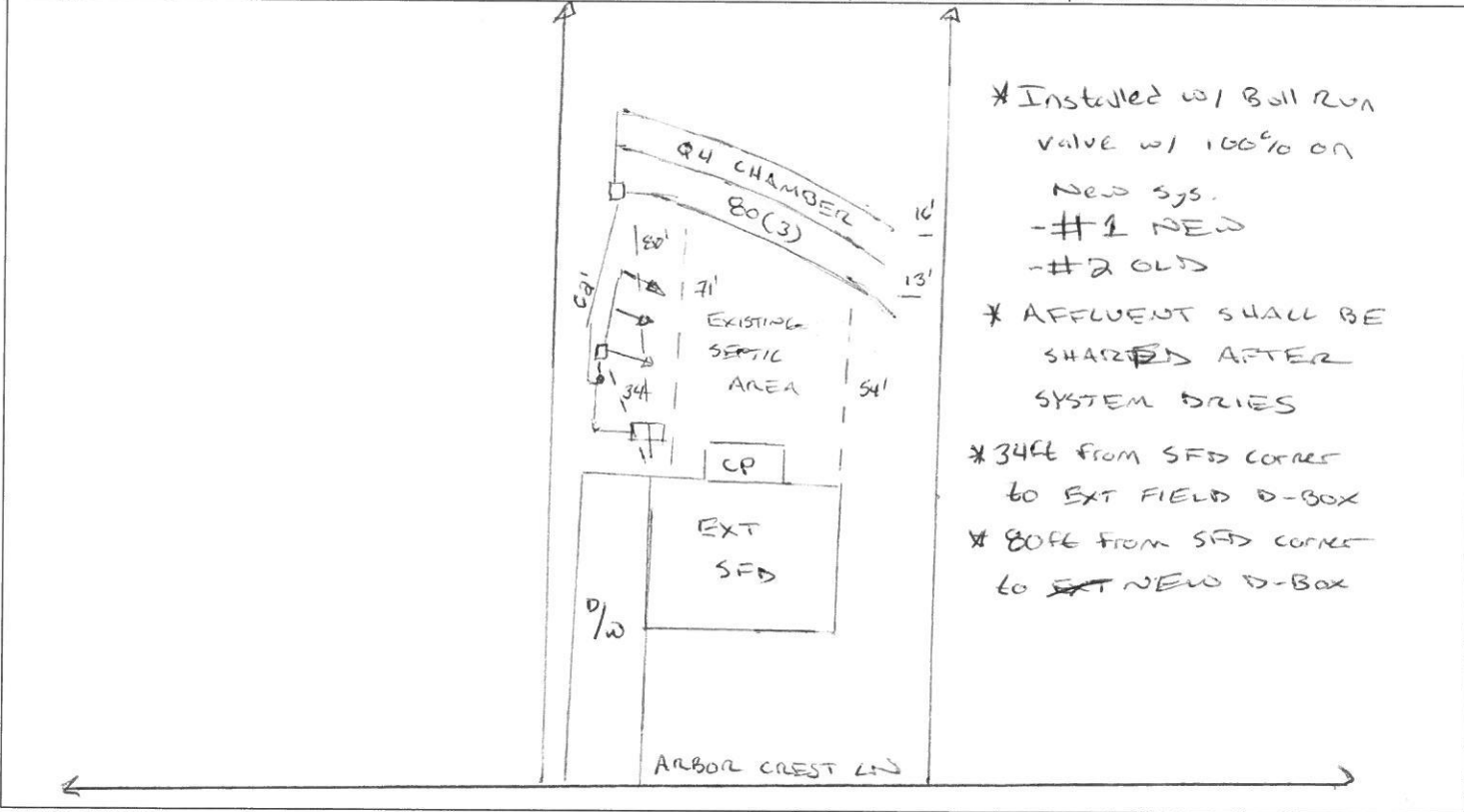

### PERMIT CONDITIONS:

- I. Performance: System shall perform in accordance with Rule .1961.
- II. Monitoring: As required by Rule .1961.
- III. Maintenance: As required by Rule .1961. Other: \_\_\_\_\_  
Subsurface system operator required? Yes  No   
If yes, see attached sheet for additional operation conditions, maintenance and reporting.
- IV. Operation: \_\_\_\_\_
- V. Other: \_\_\_\_\_

D-Box  Pump  Alarm  H2O Line  PWR Line

Following are the specifications for the sewage disposal system on the above captioned property.

Type of system:  Conventional  Other Q4 Chamber-III Septic Tank: EXT gallons Pump Tank: \_\_\_\_\_ gallons  
 Subsurface No. of exact length width of depth of  
 Drainage Field ditches 3 of each ditch 80 feet ditches 3 feet ditches 18 inches  
 French Drain Required: \_\_\_\_\_ Linear feet

Authorized State Agent [Signature]

Date 10/19/2017

REPAIR

EDWARDS BERT  
WALLACE

381 Arbor Crest Dr

Lot 11

Arbor Crests

10/15/01

