

HTE# 13-5-31762

Harnett County Department of Public Health

PERMIT # 27500

Operation Permit

22888

New Installation Septic Tank Nitrification Line Repair Expansion

PROPERTY LOCATION: 1850 TINGEN RD

Name: (owner) ART + SHARLEY RYKSE SUBDIVISION SUNSET RIDGE LOT # 15

System Installer: LARRY SHARPE Registration # _____

Basement with plumbing: Garage Number of Bedrooms 3

Type of Water Supply: Community Public Well Distance from well 100 feet

System Type: III Types V and VI Systems expire in 5 years.

(In accordance with Table V a)

Owner must contact Health Department 6 months prior to expiration for permit renewal.

This system has been installed in compliance with applicable North Carolina General Statutes, Rules for Sewage Treatment and Disposal, and all conditions of the Improvement Permit and Construction Authorization.

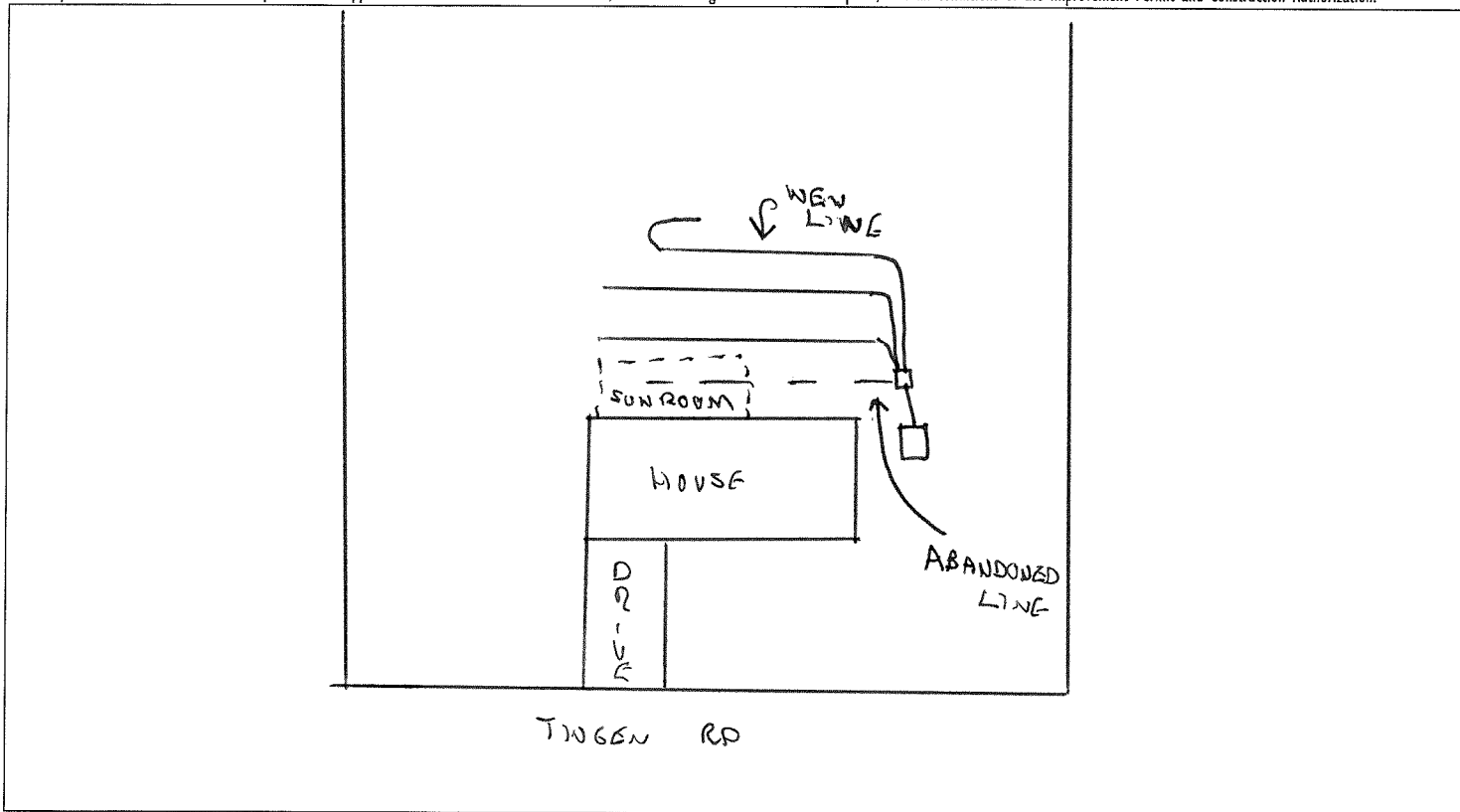

PERMIT CONDITIONS:

- I. Performance: System shall perform in accordance with Rule .1961.
- II. Monitoring: As required by Rule .1961.
- III. Maintenance: As required by Rule .1961. Other: _____
Subsurface system operator required? Yes No
If yes, see attached sheet for additional operation conditions, maintenance and reporting.
- IV. Operation: _____
- V. Other: _____

D-Box Pump Alarm H2O Line PWR Line

Following are the specifications for the sewage disposal system on the above captioned property.

Type of system: Conventional Other TIRE CHIPS Septic Tank: _____ gallons Pump Tank: _____ gallons

Subsurface Drainage Field: No. of ditches 1 exact length of each ditch 70 feet width of ditches 3 feet depth of ditches 36 inches

French Drain Required: _____ Linear feet

Authorized State Agent [Signature] REMS Date 8/14/13