

HTE# 13-5-31762

Harnett County Department of Public Health

Improvement Permit

27500

(Champion Windows)

A building permit cannot be issued with only an Improvement Permit

ISSUED TO: Art & Shirley Rijkse PROPERTY LOCATION: 1850 Tingen Rd
 SUBDIVISION Sunset Ridge LOT # 15
 NEW REPAIR EXPANSION
 Site Improvements required prior to Construction Authorization Issuance:
 Type of Structure: Existing SFD
 Proposed Wastewater System Type: conventional
 Projected Daily Flow: 360 GPD
 Number of bedrooms: 3 Number of Occupants: 4 max
 Basement Yes No
 Pump Required: Yes No May be required based on final location and elevations of facilities
 Type of Water Supply: Community Public Well Distance from well _____ feet Permit valid for: Five years
 Permit conditions: _____ No expiration

Authorized State Agent: Bryan McSwain RCHS Date: 8/9/2013 SEE ATTACHED SITE SKETCH
 The issuance of this permit by the Health Department in no way guarantees the issuance of other permits. The permit holder is responsible for checking with appropriate governing bodies in meeting their requirements. This site is subject to revocation if the site plan, plat, or the intended use changes. The Improvement Permit shall not be affected by a change in ownership of the site. This permit is subject to compliance with the provisions of the Laws and Rules for Sewage Treatment and Disposal and to conditions of this permit.

Construction Authorization

(Required for Building Permit)

The construction and installation requirements of Rules .1950, .1952, .1954, .1955, .1956, .1957, .1958, and .1959 are incorporated by references into this permit and shall be met. Systems shall be installed in accordance with the attached system layout.

ISSUED TO: Art & Shirley Rijkse PROPERTY LOCATION: 1850 Tingen Rd.
 SUBDIVISION Sunset Ridge LOT # 15
 Facility Type: SFD New Expansion Repair
 Basement? Yes No Basement Fixtures? Yes No
 Type of Wastewater System** Conventional (Initial) Wastewater Flow: 360 GPD
 (See note below, if applicable Pump to conventional (Repair))

Installation Requirements/Conditions	Number of trenches <u>1</u>	
Septic Tank Size <u>Existing</u> gallons	Exact length of each trench <u>70</u> feet	Trench Spacing: <u>9</u> Feet on Center
Pump Tank Size _____ gallons	Trenches shall be installed on contour at a	Soil Cover: <u>24</u> inches
	Maximum Trench Depth of: <u>36</u> inches	(Maximum soil cover shall not exceed
	(Trench bottoms shall be level to +/-1/4"	36" above the trench bottom)
	in all directions)	

Pump Requirements: _____ ft. TDH vs. _____ GPM _____ inches below pipe
 Aggregate Depth: _____ inches above pipe
 Conditions: The 1st drain line must be capped in the D-Box. _____ inches total
Outlet lid on septic tank should be uncovered at time of inspection to check sanitary tee

WATER LINES (INCLUDING IRRIGATION) MUST BE 10FT. FROM ANY PART OF SEPTIC SYSTEM OR REPAIR AREA.
NO UTILITIES ALLOWED IN INITIAL OR REPAIR DRAIN FIELD AREA.

**If applicable: I understand the system type specified is different from the type specified on the application. I accept the specifications of this permit.

Owner/Legal Representative Signature: _____ Date: _____

This Construction Authorization is subject to revocation if the site plan, plat, or the intended use changes. The Construction Authorization shall not be transferred when there is a change in ownership of the site. This Construction Authorization is subject to compliance with the provisions of the Laws and Rules for Sewage Treatment and Disposal and to the conditions of this permit. SEE ATTACHED SITE SKETCH

Authorized State Agent: Bryan McSwain RCHS Date: 8/9/2013
 Construction Authorization Expiration Date: 8/9/2015

HTE# 13-5-31762

Permit # 27500

Harnett County Department of Public Health Site Sketch

(Champion Windows)

ISSUED TO: Art + Shirley Rijkse PROPERTY LOCATON: 1850 Tingen Rd
SUBDIVISION Just Sunset Ridge LOT # 15

Authorized State Agent: [Signature] Date: 8/9/2013

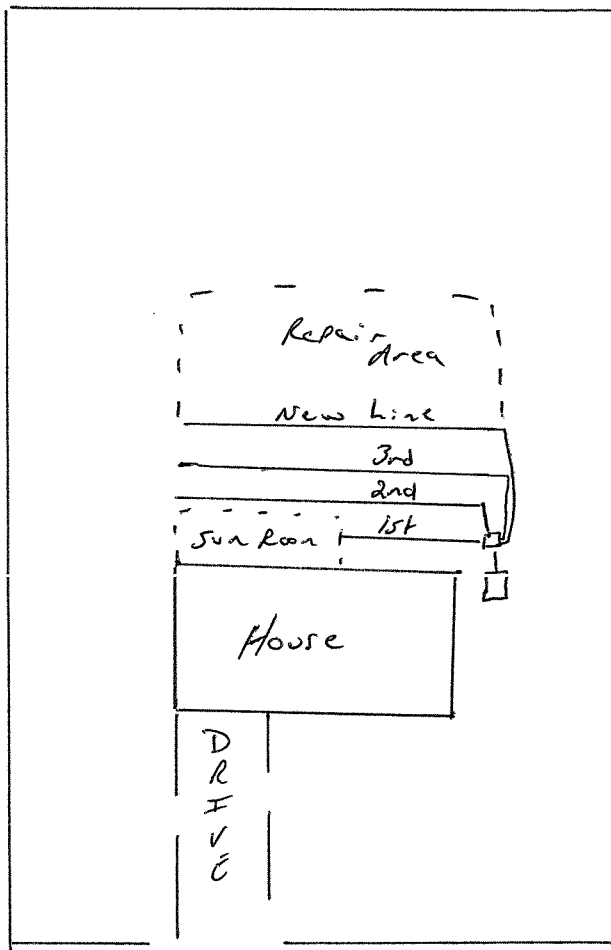

Tingen Rd.