

Initial Application Date: 5-14-12

Application # 125028928

CU# _____

COUNTY OF HARNETT RESIDENTIAL LAND USE APPLICATION

Central Permitting 108 E. Front Street, Lillington, NC 27546 Phone: (910) 893-7525 ext:2 Fax: (910) 893-2793 www.harnett.org/permits

"A RECORDED SURVEY MAP, RECORDED DEED (OR OFFER TO PURCHASE) & SITE PLAN ARE REQUIRED WHEN SUBMITTING A LAND USE APPLICATION"

LANDOWNER: Fannie Walker Mailing Address: 55 Ereset Lane

City: Linden State: NC Zip: 28356 Contact No: _____ Email: _____

APPLICANT*: Fannie Walker Mailing Address: 55 Ereset Ln

City: Linden State: NC Zip: 28356 Contact No: _____ Email: _____

*Please fill out applicant information if different than landowner

CONTACT NAME APPLYING IN OFFICE: Fannie Walker Phone # _____

PROPERTY LOCATION: Subdivision: _____ Lot #: 8 Lot Size: 1.6

State Road # 2039 State Road Name: Walker Map Book & Page: 615, 1

Parcel: 12 0544 0060 PIN: 0545-96-2881.000

Zoning: RAZOM Flood Zone: X Watershed: N/A Deed Book & Page: 524, 68 Power Company*: _____

*New structures with Progress Energy as service provider need to supply premise number _____ from Progress Energy.

PROPOSED USE:

Original dwelling 1940

SFD: (Size _____ x _____) # Bedrooms: _____ # Baths: _____ Basement (w/wo bath): _____ Garage: _____ Deck: _____ Crawl Space: _____ Slab: _____ Slab: _____
(Is the bonus room finished? () yes () no w/ a closet? () yes () no (if yes add in with # bedrooms)

Mod: (Size _____ x _____) # Bedrooms _____ # Baths _____ Basement (w/wo bath) _____ Garage: _____ Site Built Deck: _____ On Frame _____ Off Frame _____
(Is the second floor finished? () yes () no Any other site built additions? () yes () no

Manufactured Home: _____ SW _____ DW _____ TW (Size _____ x _____) # Bedrooms: _____ Garage: _____ (site built? _____) Deck: _____ (site built? _____)

Duplex: (Size _____ x _____) No. Buildings: _____ No. Bedrooms Per Unit: _____

Home Occupation: # Rooms: _____ Use: _____ Hours of Operation: _____ #Employees: _____

Addition/Accessory/Other: (Size 24 x 48) Use: _____ Closets in addition? () yes () no

Water Supply: County Existing Well _____ New Well (# of dwellings using well _____) *Must have operable water before final

Sewage Supply: _____ New Septic Tank (Complete Checklist) Existing Septic Tank (Complete Checklist) _____ County Sewer

Does owner of this tract of land, own land that contains a manufactured home within five hundred feet (500') of tract listed above? () yes () no

Does the property contain any easements whether underground or overhead () yes () no

Structures (existing or proposed): Single family dwellings: Manufactured Homes: _____ Other (specify): _____

Required Residential Property Line Setbacks:

Comments: _____

Front Minimum 35 Actual _____

Rear 25 _____

Closest Side 10 _____

Sidestreet/corner lot _____

Nearest Building _____

on same lot _____

7/26/12
S

SPECIFIC DIRECTIONS TO THE PROPERTY FROM LILLINGTON: 401 So to Bunnlevel Turn Right
on Mc Lean Chapel Road Turn Left on Wise Road Turn Right on
Leahy Rd. About one mile on Right 55 Ernest Ln.

If permits are granted I agree to conform to all ordinances and laws of the State of North Carolina regulating such work and the specifications of plans submitted. I hereby state that foregoing statements are accurate and correct to the best of my knowledge. Permit subject to revocation if false information is provided.

Jonis Walker
Signature of Owner or Owner's Agent

5-14-2022
Date

It is the owner/applicants responsibility to provide the county with any applicable information about the subject property, including but not limited to: boundary information, house location, underground or overhead easements, etc. The county or its employees are not responsible for any incorrect or missing information that is contained within these applications.

This application expires 6 months from the initial date if permits have not been issued

Walker
Book 133
Page 133
Map # 201-47

Charles McNeil
Deed Book 1587, Page 226
Map # 2001-671

Viarence M. Ferguson
Deed Book 1399, Page 434
Map # 2006-111

173.14' W
N72°36'03"E 32.96'
N 72° 40' 38" E 140.21'
2" Found Angle Iron Stake
6" AG
CC

1/4" FRB
2" BG
1" BG

N 13° 42' 38" W

S 12° 18' 56" E 424.59'

(8)
1.64 Acre

ert L. Walker
Book 883, Page 51

(9)

"Walker Div
Map Book 8, P. 6

(7)

James
Deed Book 3
Zoning Administrator

** Amendment*
SITE PLAN APPROVAL
24x24 Room Addit. No Closets
USE 24x24 Carport
DISTRICT R-20M
#BEDROOMS 0
5-14-12
W.M.H.
Date

1 = 50

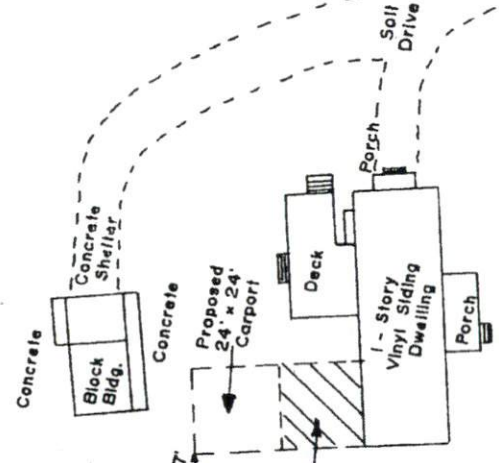

NOTE: 1" FIP
N 03° 24' 45" W
1.05' from True
Line

NOTE: 1" FIP
N 03° 24' 45" W
1.62' from True
Line

Annie U. Walker
Book 843, Page 839

Sheila McLaughlin
DB 1437,
Pg. 430

N71°44'46"E
21.93'
N71° 44' 46" E 1119.08' to
N 71° 42' 36" E
2" FIP
8" BG
CC

1 = 50

S 71° 44' 46" W 91.80'
CP 30.94'
CP 40.26'

277.64'

235.12'

230.11'
257
657

James J. Mitt