

HTE# 08-5-20145

# Harnett County Department of Public Health

24811

## Improvement Permit

A building permit cannot be issued with only an Improvement Permit

ISSUED TO: Ronald + Kimberly Hicks PROPERTY LOCATION: SR 1412 Christian Leght  
 NEW  REPAIR  EXPANSION  SUBDIVISION: MEL'S MEADOW LOT # 43  
 Type of Structure: EX SFD Site Improvements required prior to Construction Authorization Issuance:  
 Proposed Wastewater System Type: 25% REDUCTION  
 Projected Daily Flow: 480 GPD 360 Existing - 384 New  
 Number of bedrooms: 4 total Number of Occupants: 8 max  
 Basement  Yes  No  
 Pump Required:  Yes  No  May be required based on final location and elevations of facilities  
 Type of Water Supply:  Community  Public  Well Distance from well \_\_\_\_\_ feet Permit valid for:  Five years  
 Permit conditions: Contractor to meet on site prior to install  No expiration

\*PAY ATTENTION TO THIS.

Authorized State Agent: James E. Manhart Date: 6-10-08 SEE ATTACHED SITE SKETCH  
 The issuance of this permit by the Health Department in no way guarantees the issuance of other permits. The permit holder is responsible for checking with appropriate governing bodies in meeting their requirements. This site is subject to revocation if the site plan, plat, or the intended use changes. The Improvement Permit shall not be affected by a change in ownership of the site. This permit is subject to compliance with the provisions of the Laws and Rules for Sewage Treatment and Disposal and to conditions of this permit.

## Construction Authorization

(Required for Building Permit)

The construction and installation requirements of Rules .1950, .1952, .1954, .1955, .1956, .1957, .1958, and .1959 are incorporated by references into this permit and shall be met. Systems shall be installed in accordance with the attached system layout.

ISSUED TO: Ronald + Kimberly Hicks PROPERTY LOCATION: SR 1412 Christian Leght  
 SUBDIVISION: MEL'S MEADOW LOT # 43  
 Facility Type: EX SFD  New  Expansion  Repair  
 Basement?  Yes  No Basement Fixtures?  Yes  No  
 Type of Wastewater System\*\* 25% REDUCTION System MAINTENANCE (Initial) Wastewater Flow: 480 GPD  
 (See note below, if applicable )  
25% REDUCTION System (Repair)  
 Installation Requirements/Conditions  
 Septic Tank Size 1000 RT - 1000 NEW gallons Number of trenches 3  
 Pump Tank Size 1000 gallons Exact length of each trench 150 feet Trench Spacing: 9 Feet on Center  
 Trenches shall be installed on contour at a Soil Cover: 6 inches  
 Maximum Trench Depth of: 22" max inches (Maximum soil cover shall not exceed  
 (Trench bottoms shall be level to +1-1/4" 36" above the trench bottom)  
 in all directions)  
 Pump Requirements: \_\_\_\_\_ ft. TDH vs. \_\_\_\_\_ GPM \_\_\_\_\_ 6 inches below pipe  
 Aggregate Depth: \_\_\_\_\_ 2 inches above pipe  
 Conditions: Contractor to meet on site prior to install \_\_\_\_\_ 12 inches total

MAINTENANCE pump to 2" supply 3-1/2" SCL450 VALVES

\*\*If applicable: I understand the system type specified is different from the type specified on the application. I accept the specifications of this permit.

Owner/Legal Representative Signature: \_\_\_\_\_ Date: \_\_\_\_\_

This Construction Authorization is subject to revocation if the site plan, plat, or the intended use changes. The Construction Authorization shall not be transferred when there is a change in ownership of the site. This Construction Authorization is subject to compliance with the provisions of the Laws and Rules for Sewage Treatment and Disposal and to the conditions of this permit.

SEE ATTACHED SITE SKETCH

Authorized State Agent: James E. Manhart Date: 6-10-08  
 Construction Authorization Expiration Date: 6-10-13

HTE# 08-5-20145

Permit # 24811

# Harnett County Department of Public Health Site Sketch

ISSUED TO: Ronald + Kimberly HICKS PROPERTY LOCATOR: S1412 Christian LIGHT  
SUBDIVISION MEIS MEADOW LOT # 43

Authorized State Agent: James C. Manhart <sup>EA 123</sup> Date: 6-10-08

\* Contractor to RESET  
ON SITE PRIOR TO  
INSTALL. OPTIONS  
TO BE DISCUSSED.

\* 1<sup>ST</sup> option - Set NEW  
TANK NEXT  
TO Addition  
And ice connect  
to existing  
DRAIN LINE.  
AS SHOWN  
ON DIAGRAM

\* 2<sup>ND</sup> option - Pump to  
MANITEX.

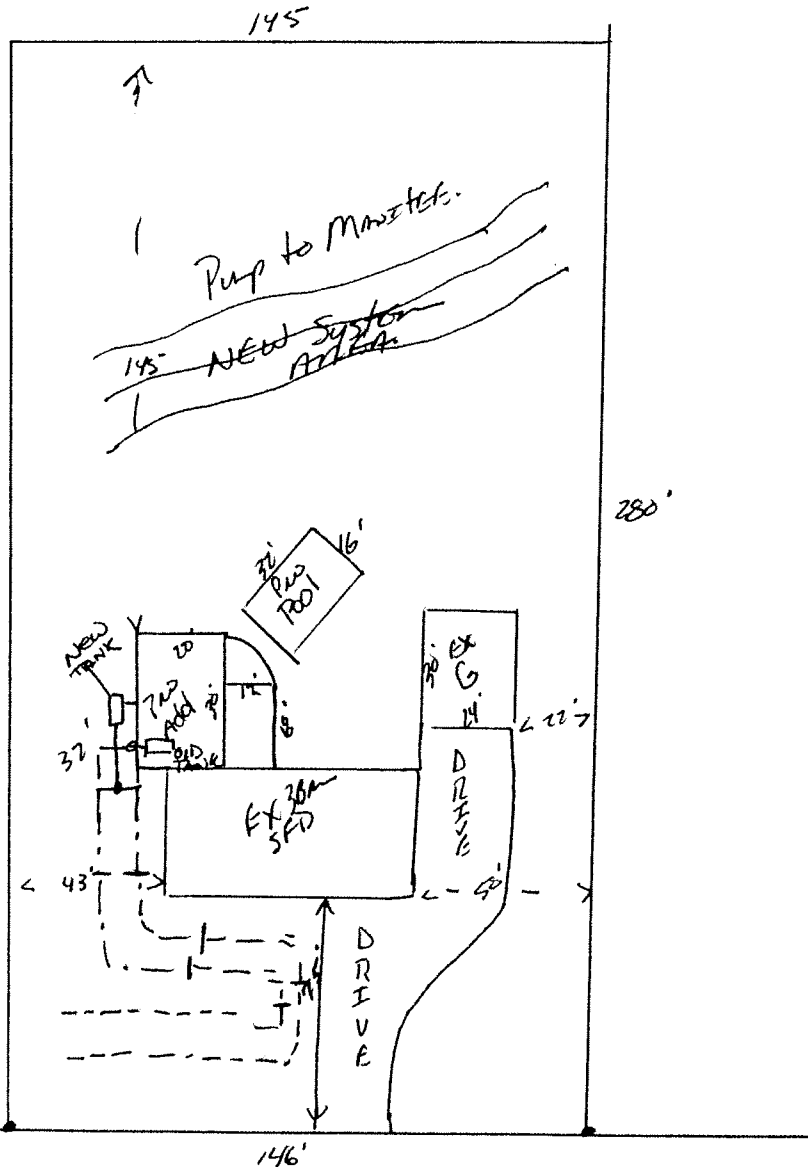

MEIS MEADOW