

Improvement Permit

A building permit cannot be issued with only an Improvement Permit

ISSUED TO: Ed Ray (T. Ivan & Debra Thomas) PROPERTY LOCATION: Peyton Lane SUBDIVISION _____ LOT # _____

NEW REPAIR EXPANSION Site Improvements required prior to Construction Authorization Issuance: 58.57 ac

Type of Structure: existing 3BR Meet onsite for final layout

Proposed Wastewater System Type: Pump to 25% Reduction system with Backhoe - may not need pump

Projected Daily Flow: 360 GPD

Number of bedrooms: 3 Number of Occupants: 6 max

Basement Yes No

Pump Required: Yes No May be required based on final location and elevations of facilities

Type of Water Supply: Community Public Well Distance from well 750 feet Permit valid for: Five years

Permit conditions: Meet onsite for final layout - Have Backhoe onsite to dig pits in Area too Rocky for soil Eval. may not need pump if suitable Area is found - Do not Drive or park on septic system No expiration

Authorized State Agent: Ju Lora Date: 09-07-07 SEE ATTACHED SITE SKETCH

The issuance of this permit by the Health Department in no way guarantees the issuance of other permits. The permit holder is responsible for checking with appropriate governing bodies in meeting their requirements. This site is subject to revocation if the site plan, plat, or the intended use changes. The Improvement Permit shall not be affected by a change in ownership of the site. This permit is subject to compliance with the provisions of the Laws and Rules for Sewage Treatment and Disposal and to conditions of this permit.

Construction Authorization

(Required for Building Permit)

The construction and installation requirements of Rules .1950, .1952, .1954, .1955, .1956, .1957, .1958, and .1959 are incorporated by references into this permit and shall be met. Systems shall be installed in accordance with the attached system layout.

ISSUED TO: Ed Ray (T. Ivan & Debra Thomas) PROPERTY LOCATION: Peyton Lane SUBDIVISION _____ LOT # _____

Facility Type: existing 3BR New Expansion Repair 58.57 ac

Basement? Yes No Basement Fixtures? Yes No

Type of Wastewater System** Pump to 25% Red. (Initial) system Wastewater Flow: 360 GPD

(See note below, if applicable) 360 LF (Repair)

Installation Requirements/Conditions

Septic Tank Size 1000 gallons Exact length of each trench 3x75 feet Trench Spacing: 9 Feet on Center

Pump Tank Size 1000 gallons Trenches shall be installed on contour at a Soil Cover: 6 inches

→ If existing tank cannot be used

Maximum Trench Depth of: 18 inches (Maximum soil cover shall not exceed 36" above the trench bottom)

(Trench bottoms shall be level to +/-1/4" in all directions)

Pump Requirements: _____ ft. TDH vs. _____ GPM _____ inches below pipe

Aggregate Depth: _____ inches above pipe

Conditions: _____ inches total

**If applicable: I understand the system type specified is different from the type specified on the application. I accept the specifications of this permit.

Owner/Legal Representative Signature: _____ Date: _____

This Construction Authorization is subject to revocation if the site plan, plat, or the intended use changes. The Construction Authorization shall not be transferred when there is a change in ownership of the site. This Construction Authorization is subject to compliance with the provisions of the Laws and Rules for Sewage Treatment and Disposal and to the conditions of this permit.

Authorized State Agent: Ju Lora Date: 09-07-07 SEE ATTACHED SITE SKETCH

Construction Authorization Expiration Date: 09-07-2012

HTE# 07-50018251 R

Permit # 24300 Option 1

Harnett County Department of Public Health Site Sketch

ISSUED TO: Ed Ray (T. Man & Debra Thomas) PROPERTY LOCATOR: Peyton Lane
 SUBDIVISION _____ LOT # _____
 Authorized State Agent: J. L. Hill Date: 09-07-07
 58.58 m

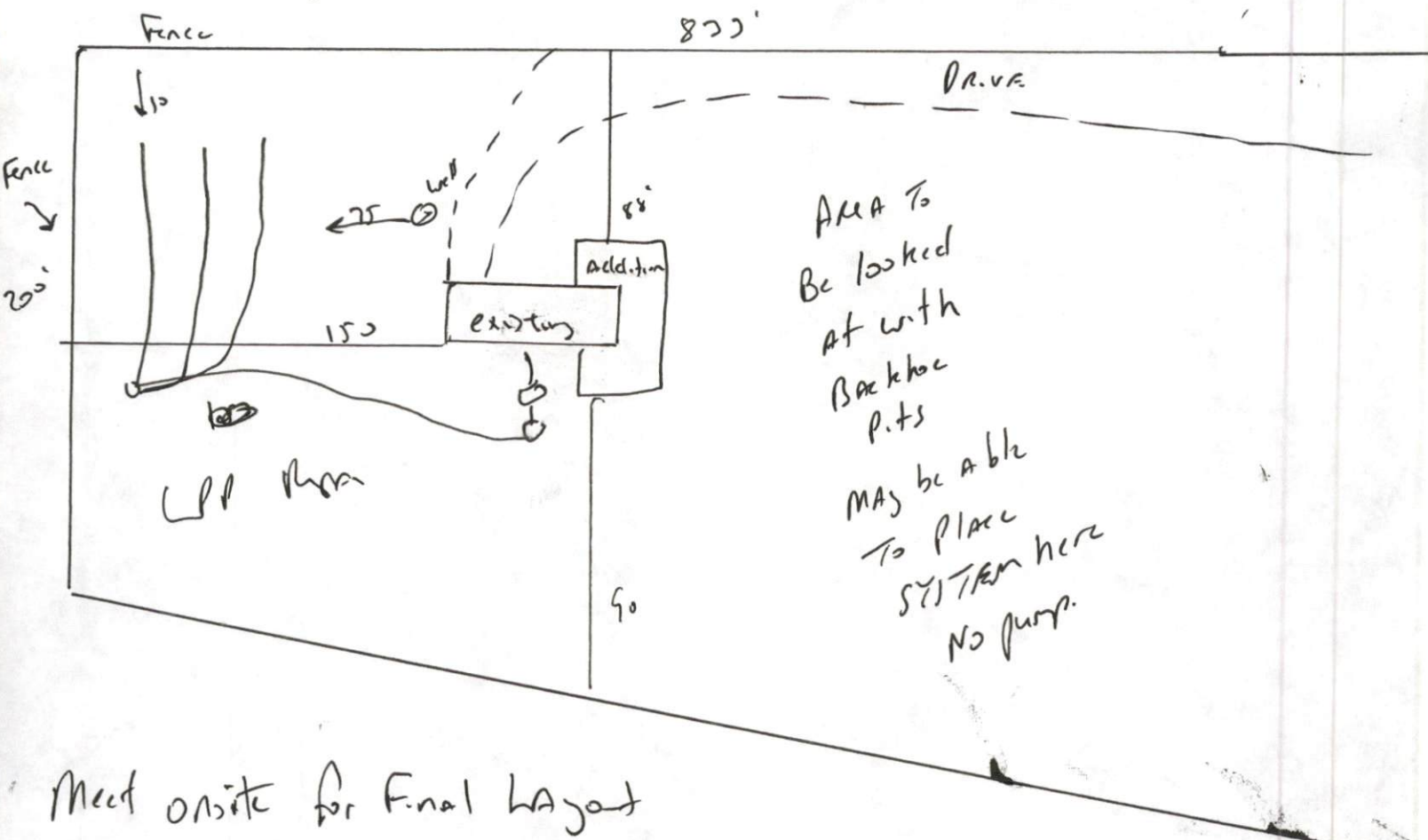

Meet onsite for Final layout

Maintain All setbacks

Install 3x75 of 25% reduction system where shown - will require Pump

I need to have Backhoe Pits Below house to evaluate soils (Too Rocky)

If suitable Area is found Then I can change permit

Do not Drive or park on syptic system

HTE# 07-500-18251 R

Permit # 24300 Option 2

Harnett County Department of Public Health Site Sketch

ISSUED TO: Ed Ray PROPERTY LOCATOR: Dayton Lane SUBDIVISION _____ LOT # 5853m

Authorized State Agent: Ju Larr Date: 10-01-07

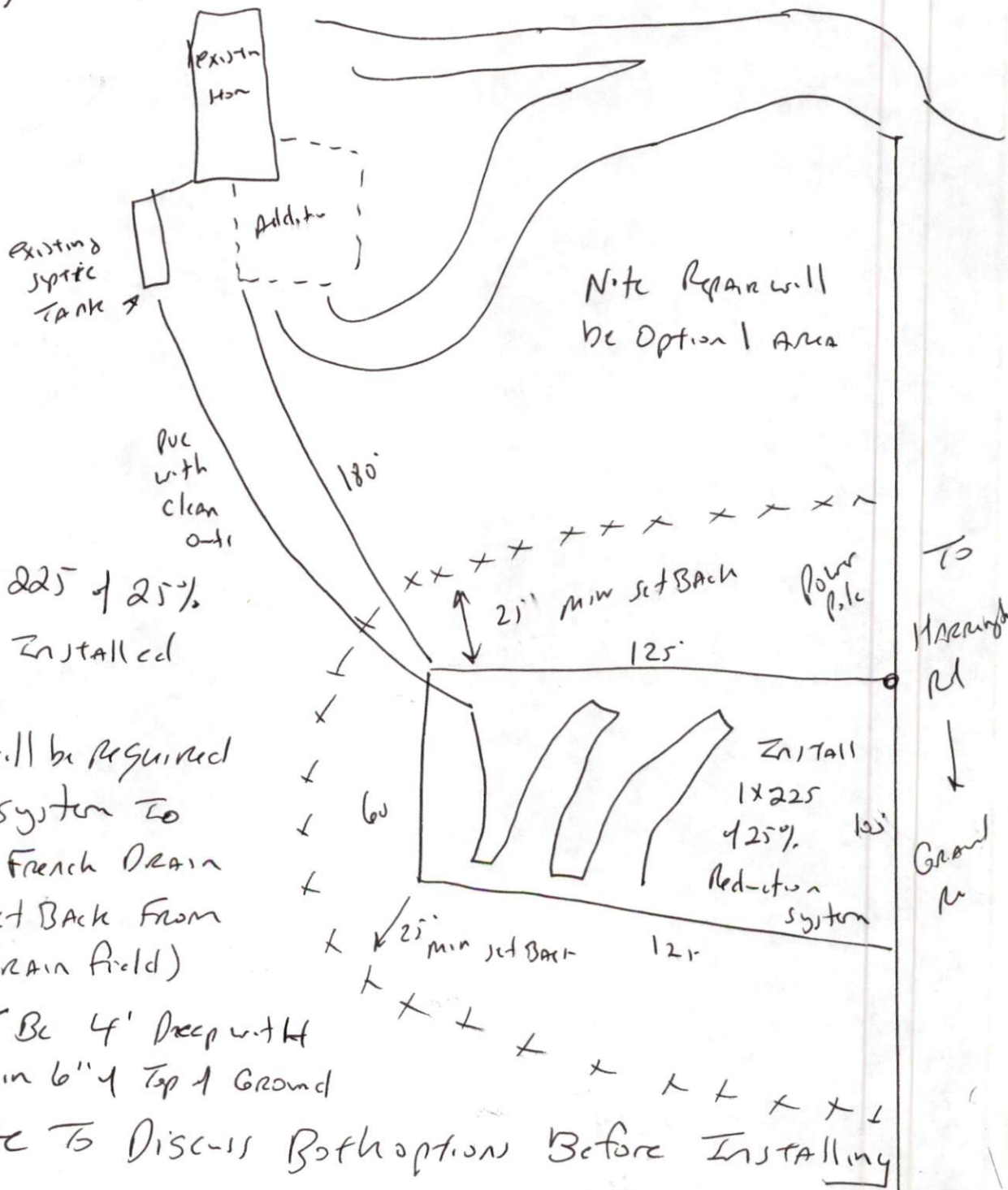

Option 2

Will require 1x 225 of 25% Reduction system installed at 18 to 24" deep. French drain will be required around septic system to divert water French drain to have 25' set back from septic lines. (Drain field) French drain to be 4' deep with gravel to within 6" of top of ground

Meet onsite to discuss both options before installing