

HTE# 18-5-43529R

Harnett County Department of Public Health

30089

Improvement Permit

A building permit cannot be issued with only an Improvement Permit

ISSUED TO: Tim McNeill
PROPERTY LOCATION: 81 Hollies Pines Rd. (SA 1270)
SUBDIVISION: LOT # 2B
NEW [X] REPAIR [] EXPANSION []
Type of Structure: 40'x24' Metal Bldg w/ Bathroom
Proposed Wastewater System Type: 25% Reduction Sys./Conventional
Projected Daily Flow: 100 GPD
Number of bedrooms: NA Number of Occupants: NA max
Basement [] Yes [X] No
Pump Required: [] Yes [] No [X] May be required based on final location and elevations of facilities
Type of Water Supply: [] Community [X] Public [] Well Distance from well NA feet
Permit valid for: [X] Five years [] No expiration
Permit conditions: 1 Employee w/ Single Bathroom at 100 GPD

Authorized State Agent: [Signature] Date: 08/23/2018
SEE ATTACHED SITE SKETCH
The issuance of this permit by the Health Department in no way guarantees the issuance of other permits. The permit holder is responsible for checking with appropriate governing bodies in meeting their requirements. This site is subject to revocation if the site plan, plat, or the intended use changes. The Improvement Permit shall not be affected by a change in ownership of the site. This permit is subject to compliance with the provisions of the Laws and Rules for Sewage Treatment and Disposal and to conditions of this permit.

Construction Authorization

(Required for Building Permit)

The construction and installation requirements of Rules .1950, .1952, .1954, .1955, .1956, .1957, .1958, and .1959 are incorporated by references into this permit and shall be met. Systems shall be installed in accordance with the attached system layout.

ISSUED TO: Tim McNeill
PROPERTY LOCATION: 81 Hollies Pines Rd. (SA 1270)
SUBDIVISION: LOT # 2B
Facility Type: 40'x24' Metal Bldg. [X] New [] Expansion [] Repair
Basement? [] Yes [X] No Basement Fixtures? [] Yes [] No
Type of Wastewater System** At-Grade 25% Red. Sys./Convo (Initial) Wastewater Flow: 100 GPD
(See note below, if applicable []) At-Grade 25% Red (Repair) *Conventional or 25% reduction*
Installation Requirements/Conditions
Septic Tank Size 1000 gallons Exact length of each trench 60 feet Trench Spacing: 9 Feet on Center
Pump Tank Size _____ gallons Trenches shall be installed on contour at a Soil Cover: 6 inches (Import)
Maximum Trench Depth of: 14 inches (Maximum soil cover shall not exceed 36" above the trench bottom)
in all directions)
Pump Requirements: _____ ft. TDH vs. _____ GPM
Aggregate Depth: NA inches below pipe
NA inches above pipe
NA inches total
Conditions: 6IN Imported Approved Cover Required

WATER LINES (INCLUDING IRRIGATION) MUST BE 10FT. FROM ANY PART OF SEPTIC SYSTEM OR REPAIR AREA.
NO UTILITIES ALLOWED IN INITIAL OR REPAIR DRAIN FIELD AREA.

**If applicable: I understand the system type specified is different from the type specified on the application. I accept the specifications of this permit.

Owner/Legal Representative Signature: _____ Date: _____

This Construction Authorization is subject to revocation if the site plan, plat, or the intended use changes. The Construction Authorization shall not be transferred when there is a change in ownership of the site. This Construction Authorization is subject to compliance with the provisions of the Laws and Rules for Sewage Treatment and Disposal and to the conditions of this permit. SEE ATTACHED SITE SKETCH

Authorized State Agent: [Signature] Date: 08/23/2018
ANDREW WARR Construction Authorization Expiration Date: 08/23/2023

HTE# 18-5-43529R

Permit # 30089

Harnett County Department of Public Health Site Sketch

ISSUED TO: Tim McNeill PROPERTY LOCATOR: 81 Hollies Pines Rd. (SR 1270)
SUBDIVISION _____ LOT # 2B

Authorized State Agent: ~~Andrew Curran~~ Date: ~~07/17/2018~~ (AIL)
ANDREW CURRAN 08/23/2018

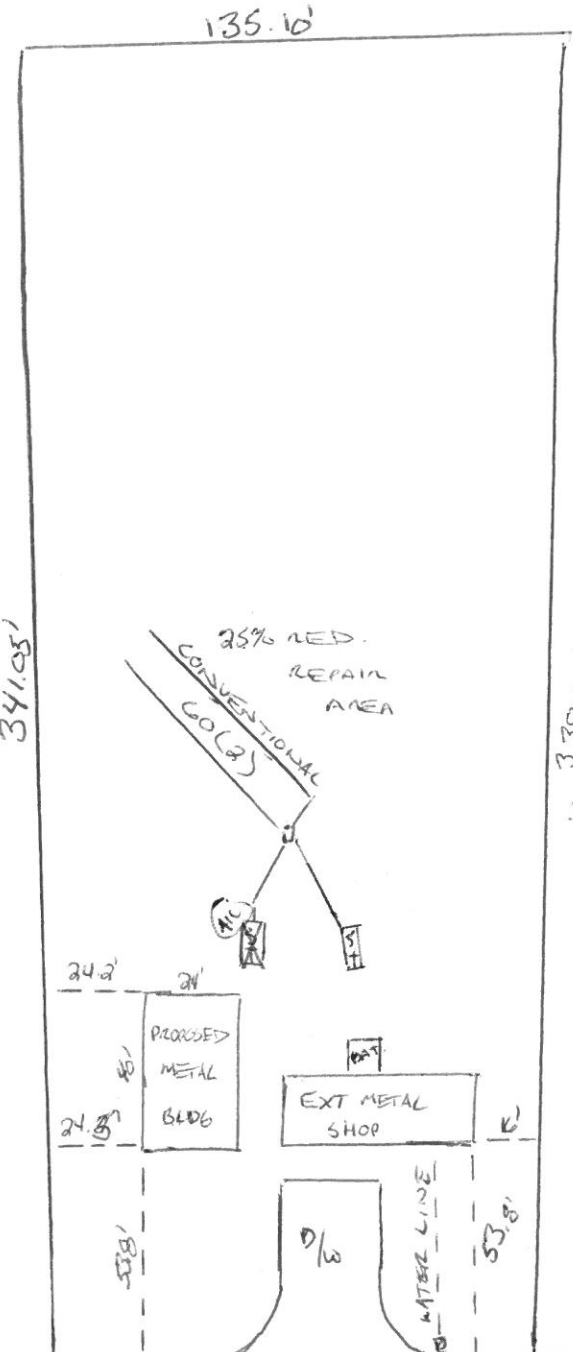

* Conventional OR
25% reduction

* 6IN Approved
Imported Cover
required

* 14IN Trench
At-Grade Sys.
required

* Revision may be
required based on
final location of
bathroom by
Planning Dept requirements
(via Applicant)

REVISION (8/23)
* TANK RELAXATION
FOR BATHROOM
RELAXATION
[MEET ON-SITE MAY
BE REQUIRED]

HOLLIES PINES RD. (SR 1270)