

Owner: Luis Mattias Applicant: (SR 2611)

Owner: Lois Martin (512 261) Applicant: _____
Address: 87 Sunset Bay Pl Date Evaluated: _____
Proposed Facility: Dwmtl Design Flow (.1949): 360 GPD Property Size: _____
Location of Site: _____ Property Recorded: _____
Water Supply: ☒ Public ☐ Individual ☐ Well ☐ Spring ☐ Other
Evaluation Method: ☒ Auger Boring ☐ Pit ☐ Cut
Type of Wastewater: ☒ Sewage ☐ Industrial Process ☐ Mixed

[illegible]

Description	Initial System	Repair System	Other Factors (.1946): Site Classification (.1948):
Available Space (.1945)			S Evaluated By: Others Present:
System Type(s)			
Site I.TAR			

COMMENTS: _____

LANDSCAPE POSITIONS	GROUP	TEXTURES	.1955 LTAR	CONSISTENCE MOIST	WET
R-RIDGE	I	S-SAND	1.2 - 0.8	VFR-VERY FRIABLE	NS-NON-STICKY
S-SHOULDER SLOPE		LS-LOAMY SAND			SS-SLIGHTLY STICKY
L-LINEAR SLOPE	II	SL-SANDY LOAM	0.8 - 0.6	FI-FIRM	S-STICKY
FS-FOOT SLOPE		L-LOAM		VFI-VERY FIRM	VS-VERY STICKY
N-NOSE SLOPE				EFI-EXTREMELY FIRM	NP-NON-PLASTIC
H-HEAD SLOPE	III	SI-SILT	0.6 - 0.3		SP-SLIGHTLY STICKY
CC-CONCLAVE SLOPE		SIL-SILT LOAM			P-PLASTIC
CV-CONVEX SLOPE		CL-CLAY LOAM			VP-VERY PLASTIC
T-TERRACE		SCL-SANDY CLAY LOAM			
FP-FLOOD PLAN	IV	SIC-SILTY CLAY	0.4 - 0.1		
		C-CLAY			
		SC-SANDY CLAY			

STRUCTURE

SG-SINGLE GRAIN

M-MASSIVE

CR-CRUMB

GR-GRANULAR

SBK-SUBANGULAR BLOCKY

ABK-ANGULAR BLOCKY

PL-PLATY

PR-PRISMATIC

MINERALOGY

SLIGHTLY EXPANSIVE

EXPANSIVE

Show profile locations and other site features (dimensions, references or benchmark, and North)

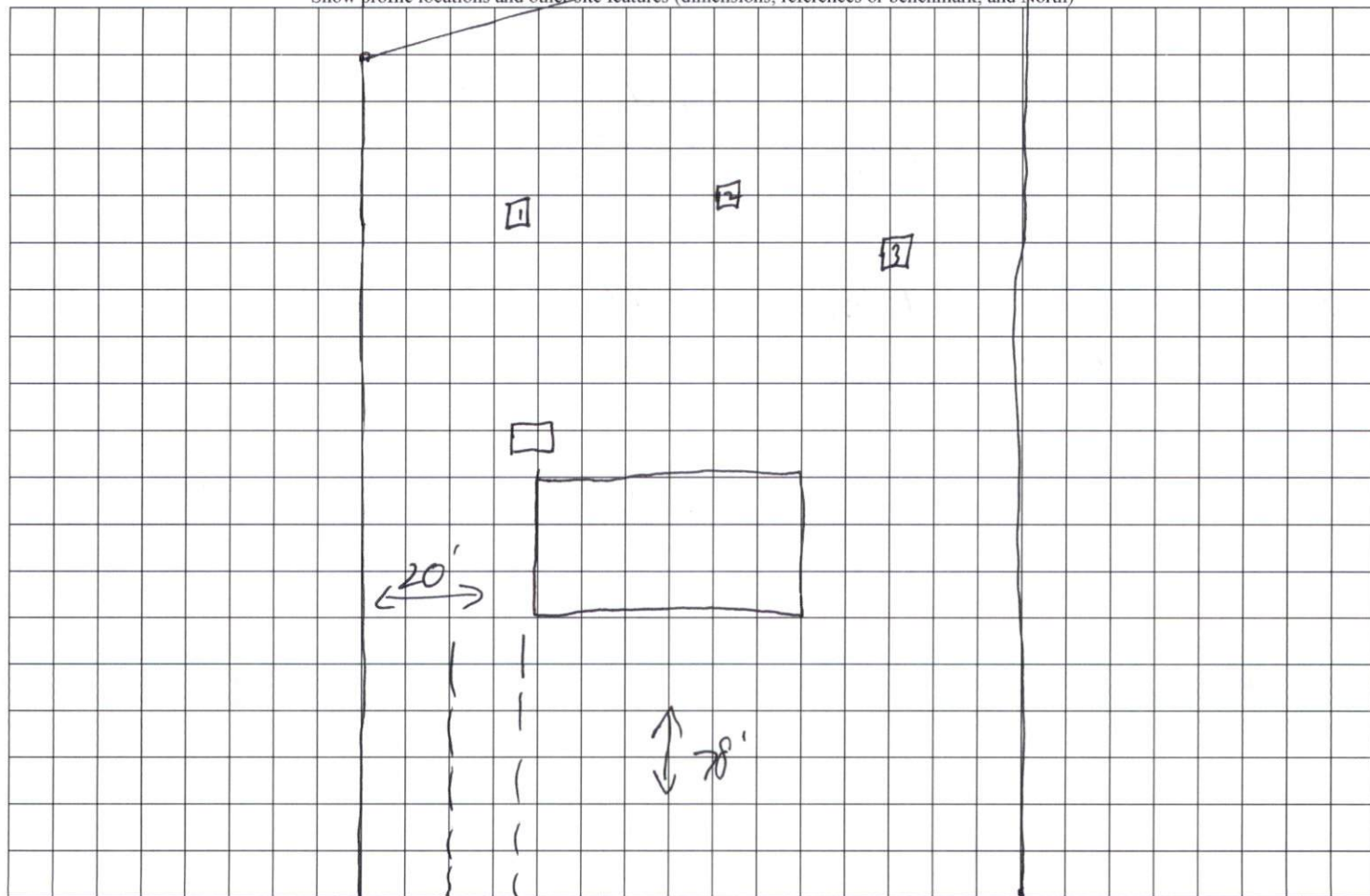

← Sweetbay Pl →