

**Adams Soil Consulting  
1676 Mitchell Road  
Angier, NC 27501  
919-414-6761**

---

June 5, 2024  
Project #1927

Attention: Charles Hill  
JHILL Property Group, LLC

RE: Preliminary soil/site evaluation for Lots #1 & 1A of the minor subdivision for the JHILL Property Group, LLC located adjacent to NC Hwy 27 E (Coats, NC) in Harnett County (PIN#1610-70-2843).

Mr. Hill,

Adams Soil Consulting (ASC) conducted a preliminary soil evaluation on the above referenced parcel to determine the areas of soils which are suitable for subsurface wastewater disposal systems (conventional & LPP). The soil/site evaluation was performed using hand auger borings during moist soil conditions based on the criteria found in the State Subsurface Rules, 15ANCAC 18E. The suitable soil boundary was sketched onto a preliminary plat supplied by your surveyor.

At the time of evaluation, the lots were vacant. The suitable soils shown on the accompanying soil map have potential for a conventional, modified conventional, or alternative type initial and repair area for at least one 2-bedroom home site on lots 1 and 1A. The lots contain greater than 8,000 ft<sup>2</sup> of suitable soils that consist of a sandy clay loam subsoil that can support a daily loading rate of 0.25-0.4 gallons/day/ft<sup>2</sup>. The lots should accommodate a house foot print of at least 30' x 60'. It is recommended that a septic design be performed prior to a financial commitment being made on any of the subject lots to confirm septic system type and location.

All lots will require a detailed soils evaluation by the Harnett County Health Department or permitting authority prior to issuance of any permits related to any future septic system. A septic system design may be required before a permit can be issued on the above referenced lots demonstrating available space for a septic system. Due to the subjective nature of the permitting process and the variability of naturally occurring soils, Adams Soil Consulting cannot guarantee that areas delineated as suitable for on-site wastewater disposal systems will be permitted by the local county agency. The lots may require a septic system utilizing pumps, shallow or ultra-shallow conventional trench placement, low pressure pipe system, pre-treatment, and/or reductions systems for final approval. The accompanying soil map is preliminary in nature, no further assumptions or subdivision should be made without a more detailed evaluation.

\*Preliminary Soils Evaluation - only a portion of the property was evaluated.

\*Soil boundary was sketched onto a preliminary map of the property supplied by the client's surveyor.

\*Not a Survey.

\*Septic system setbacks listed below for new lots.

- 1) 10' from property lines.
- 2) 100' from wells for primary systems.
- 3) 50' from surface waters (streams, ponds, lakes).

\*Any mechanical disturbances such as grading, cutting and filling of the suitable soil areas can render areas unsuitable for future septic systems.

\*See accompanying report for additional information.

\*Due to Soil Variability, Adams soil consulting cannot guarantee that the areas shown as suitable will be permitted by the local Health Department.

\* A more detailed soil evaluation is required prior to final subdivision planning.

Preliminary Soil Evaluation  
JHILL Property Group, LLC  
Minor Subdivision - Lot 1 and 1A  
Harnett County NC  
PIN# 1610-70-2843

June 5, 2024

Legend



Areas contain soils with 24 inches or more of useable material and have potential for conventional, modified conventional, LPP or ultra-shallow conventional septic systems.

UN

Areas Not Evaluated or Unsuitable areas

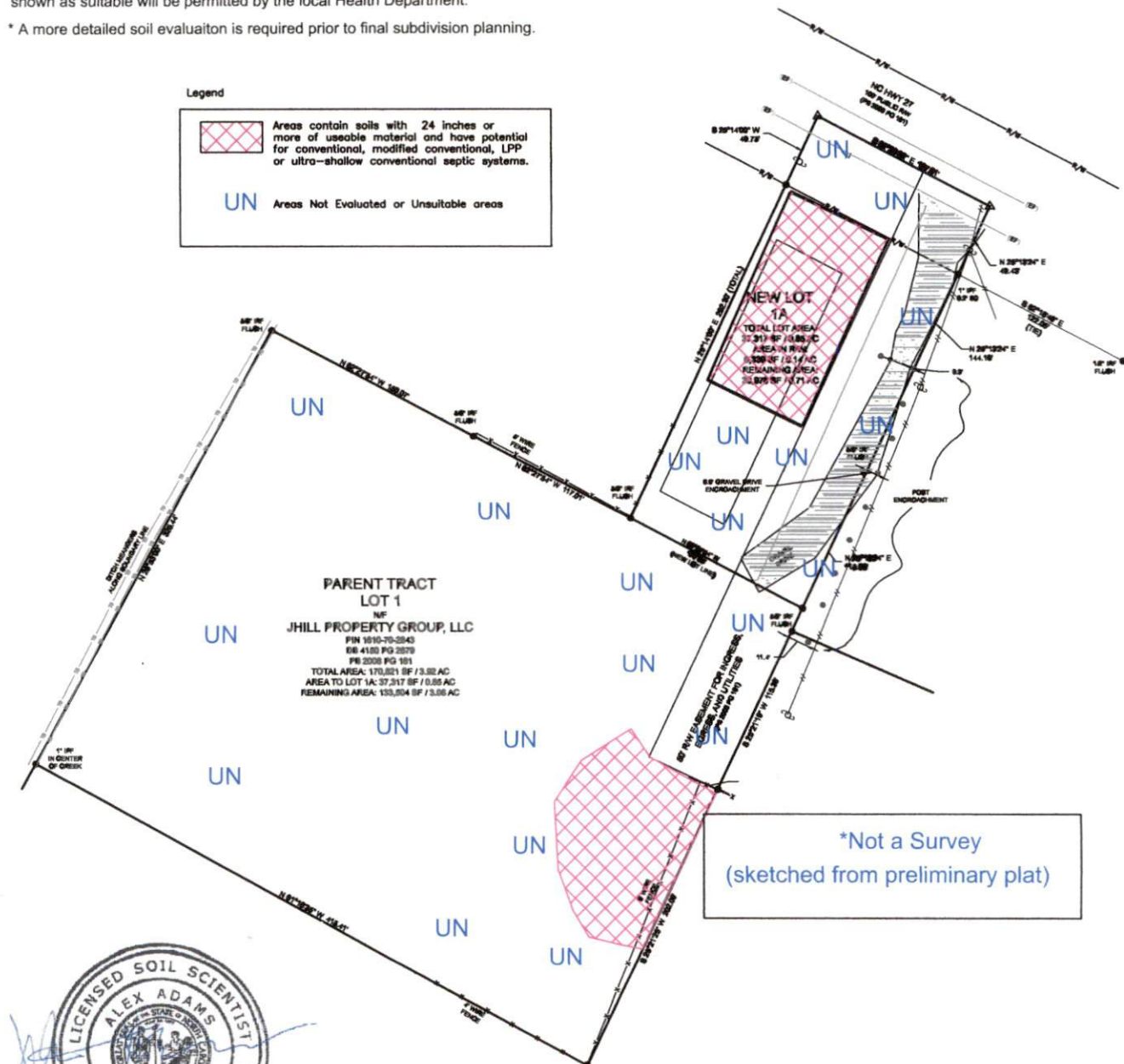

\*Not a Survey  
(sketched from preliminary plat)



GRAPHIC SCALE  
1" = 100'



Adams  
Soil Consulting  
919-414-6761  
Project #1927

If you have any questions regarding the findings on the attached map or in this report, please feel free to contact me anytime. Thank you allowing me to perform this site evaluation for you.

Sincerely,



Alex Adams  
NC Licensed Soil Scientist #1247

