



Town of Erwin  
**Zoning Application & Permit**  
Planning & Inspections Department

Permit #
26-008

Rev Sep2014

Each application should be submitted with an attached plot/site plan with the proposed use/structure showing lot shape, existing and proposed buildings, parking and loading areas, access drives and front, rear, and side yard dimensions.

Name of Applicant	Charlene Maahs	Property Owner	Patricia Lapole
Home Address	8005 Knightdale Bld.	Home Address	109 Holmes St.
City, State, Zip	Knightdale, NC 27545	City, State, Zip	Erwin, NC 28339
Telephone	336-245-1176	Telephone	4436155856
Email	raleighaccounting@tarheelbasement systems.com	Email	ptriplett97@gmail.com
Address of Proposed Property 109 HOLMES St.			
Parcel Identification Number(s) (PIN)		Estimated Project Cost	
What is the applicant requesting to build / what is the proposed use of the subject property? Be specific.		We will encapsulate, replace insulation and seal all vents and perforations in the crawlspace. Two 20 amp GFCI outlets will be added to the crawlspace for the dehumidifier	
Description of any proposed improvements to the building or property		Encapsulation of Crawlspace	
What was the Previous Use of the subject property?		Residential	
Does the Property Access DOT road?		N/A	
Number of dwelling/structures on the property already		Property/Parcel size	
Floodplain SFHA Yes No		Watershed Yes No Wetlands Yes No	
MUST circle one that applies to property		Existing/Proposed Septic System Or Existing/Proposed County/City Sewer	

**Owner/Applicant Must Read and Sign**

The undersigned property owner, or duly authorized agent/representative thereof certifies that this application and the forgoing answers, statements, and other information herewith submitted are in all respects true and correct to the best of their knowledge and belief. The undersigning party understands that any incorrect information submitted may result in the revocation of this application. Upon issuance of this permit, the undersigning party agrees to conform to all applicable town ordinances, zoning regulations, and the laws of the State of North Carolina regulating such work and to the specifications of plans herein submitted. The undersigning party authorizes the Town of Erwin to review this request and conduct a site inspection to ensure compliance to this application as approved.

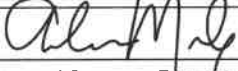
Charlene Maahs		7/15/2025
Print Name	Signature of Owner or Representative	Date

**For Office Use**

Zoning District	R10	Existing Nonconforming Uses or Features	NA
Front Yard Setback	35	Other Permits Required	Conditional Use Building Fire Marshal Other
Side Yard Setback	10/20	Requires Town Zoning Inspection(s)	Foundation Prior to C. of O.
Rear Yard Setback	35	Zoning Permit Status	Approved Denied
Fee Paid: 600.00		Date Paid: NA	Staff Initials: OME

Comments	NO Expansion of 986, Trade Permit from HAMBURG County
----------	---

Signature of Town Representative: 	Date Approved/Denied: 7/16/25
---	-------------------------------



*A Groundworks Company*

## **Scope of Work for:**

**109 Holmes St.**

**Erwin, NC 28339**

\*CrawlSeal System to include the following:

-20 ml Vapor Barrier installed wall to wall with 100% floor coverage. All sections of liner will be overlapped a minimum of 1' and will be seamed together, attached with tape.

--Wrap all existing CMU/Brick Piers 20 ml Vapor Barrier. Contractor will leave a termite inspection gap at the top of each pier. The liner will be fastened to the pier and the top edge of the liner will be sealed with caulking.

-All Vents will be sealed from inside the crawl space with R-10 Rigid 2" Foam Sheathing.

\*AprilAire E100 Dehumidifier install - unit specifications on page 2

\*R-19 Insulation installed in the rim joist cavities.

\*Extreme Block - R-10 Rigid 2" Foam Sheathing - Wall Insulation installed with a 3-4" termite inspection reveal left at the top of the foundation wall. All vents will be sealed from the inside.

\*CrawlDrain Install CrawlDrain in the area shown. Hand dig in order to develop a trench where indicated on the drawing and install 4" corrugated and perforated pipe with engineered mesh silt sock to collect ground water, back filled with #57 drainage stone and connect to sump system to discharge.

\*Electrical - Installation of new dedicated 120vac/20amp electrical circuit/s and electrical outlet/s (WP-GFCI) to supply sump pump and /or dehumidifier in crawl space (basement).

Touchstone Electric

8601 Six Forks Road

Unit 400

Raleigh, NC 27601

(919) 670-4015

[dispatch@touchstoneelectric.com](mailto:dispatch@touchstoneelectric.com)

License # U.37073

back

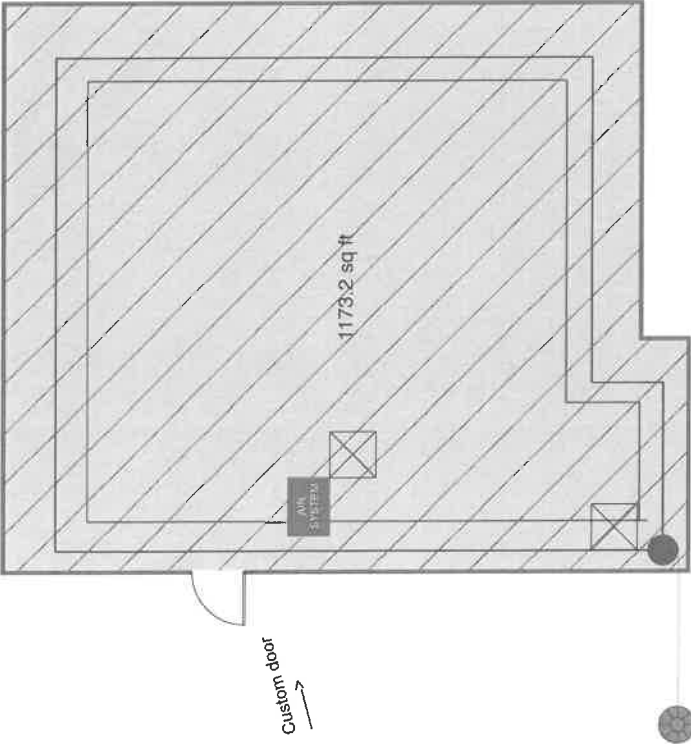

Front

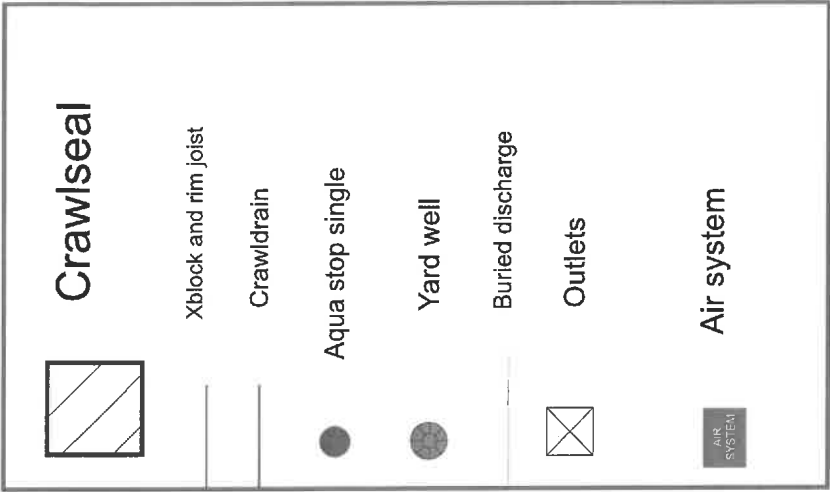

Title: Patricia Triplett	Drawn: Cullen Toomey	Customer: 259949
Site: 109 Holmes st	Date: 7/10/2025	Farheel Basement Systems- 3005 Knightdale Blvd Knightdale 27545