



## **Scope of Work for:**

**366 Robeson St.**

**Spring Lake, NC 28390**

\*CrawlSeal System to include the following:

-20 ml Vapor Barrier installed wall to wall with 100% floor coverage. All sections of liner will be overlapped a minimum of 1' and will be seamed together, attached with tape.

--Wrap all existing CMU/Brick Piers 20 ml Vapor Barrier. Contractor will leave a termite inspection gap at the top of each pier. The liner will be fastened to the pier and the top edge of the liner will be sealed with caulking.

-All Vents will be sealed from inside the crawl space with R-10 Rigid 2" Foam Sheathing.

\*AprilAire E100 Dehumidifier install - unit specifications on page 2

\*Existing R-19 insulation will remain in the floor system.

\*Extreme Block - R-10 Rigid 2" Foam Sheathing - Wall Insulation installed with a 3-4" termite inspection reveal left at the top of the foundation wall. All vents will be sealed from the inside.

**Using Existing Electrical**

# TARHEEL™

## BASEMENT SYSTEMS

A Groundworks Company

SPECIFICATIONS		
<b>Capacity</b>		
	@ 80°F/60% RH	100 ppd
	@ 73°F/60% RH	85 ppd
<b>Energy Factor</b>		
	@ 80°F/60% RH	2.6 L/kW-h
	@ 73°F/60% RH	2.35 L/kW-h
<b>Airflow @ varying E.S.P. (external static pressure - dry coil)</b>		
	0.0" w.c.	280 CFM
	0.2" w.c.	245 CFM
	0.4" w.c.	210 CFM
<b>Voltage, phase, frequency</b>		120VAC, 1 phase, 60 Hz
<b>Current draw<sup>(1)</sup></b>		6.9 Amps
<b>Noise</b>		55 dBA ducted
<b>Dimensions: (cabinet only)<sup>(2)</sup></b>		Width: 14" Height: 15" Length: 26"
<b>Unit Weight</b>		64 lbs.
<b>Shipping Weight</b>		82 lbs.
<b>Inlet air operating conditions during</b>		
<b>-Dehumidification:</b>		50°F-104°F, 40°F dew point min.
<b>-Ventilation:</b>		40°F-140°F, 0%-99% RH (non-condensing)
<small><sup>(1)</sup>Rated capacity, energy factor and current draw measured at 80°F/60% RH inlet air at 0.0 ESP.</small>		
<small><sup>(2)</sup>Height does not include adjustable feet. The width excludes the filter doors and length excludes the duct collars.</small>		

## Key



Encapsulation  
Remove old vapor barrier



Emergency low spot sump



Air System

Barrett Simmons  
366 Robeson St  
Spring Lake, NC 28390  
#256711

Prepared By:  
Ken Houston  
Tar Heel Basement Systems  
(919) 819-2083  
5-31-25

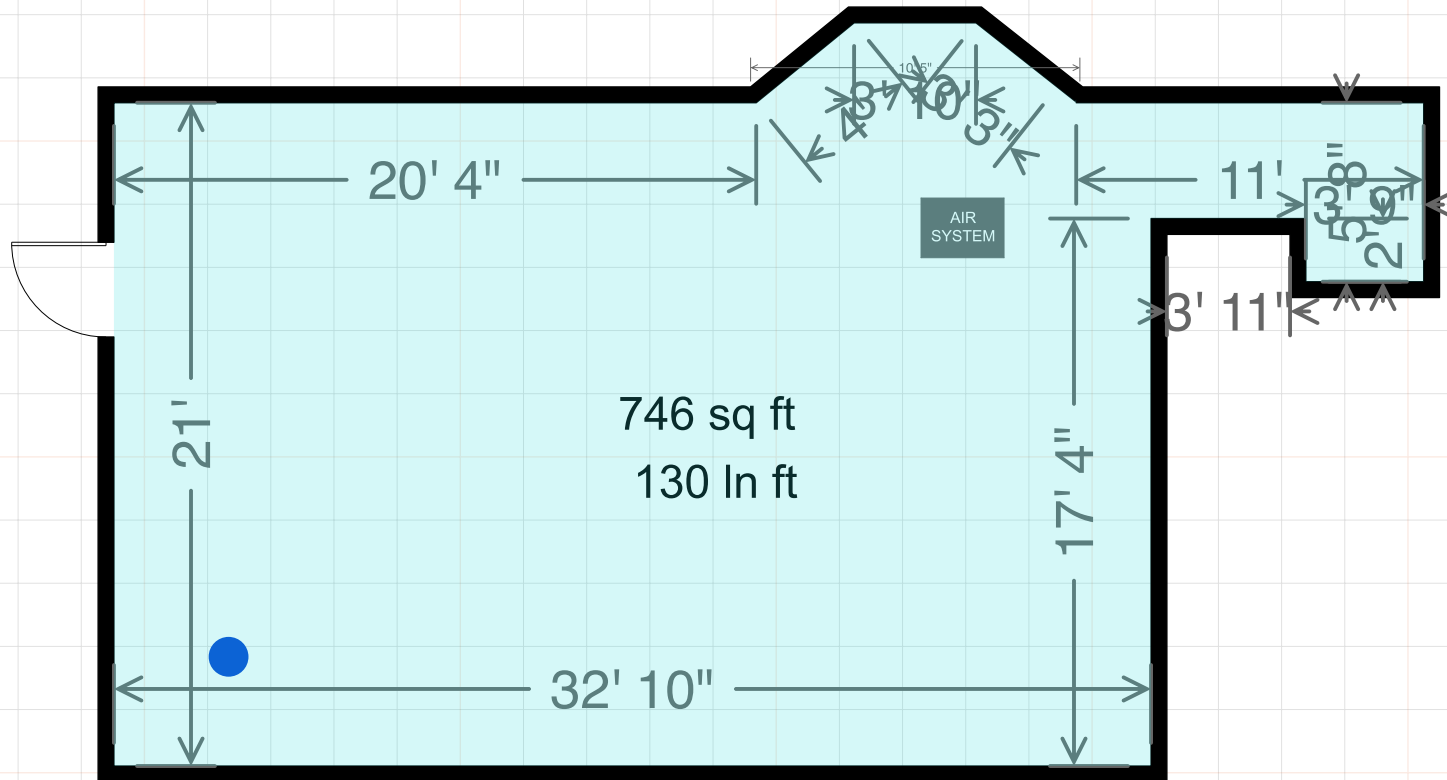

Front