

NC GRID NORTH MAG 1983 (2011)

LINE	BEARING	DISTANCE
L1	N 84°47'49" E	61.83
L2	N 61°26'56" E	46.13

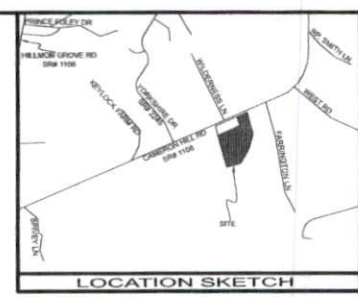

LEGEND OF SYMBOLS AND ABBREVIATIONS

- CP COMPUTED POINT
- EA EXISTING AXLE
- ECM EXISTING CONCRETE MONUMENT
- EIP EXISTING IRON PIPE
- EBR EXISTING IRON ROD
- NBR NEW IRON ROD
- NIP NEW IRON PIPE
- FR FIRE HYDRANT
- GV GAS VALVE
- PP POWER POLE
- LP LIGHT POLE
- SM SANITARY SEWER MANHOLE
- STORM MANHOLE
- TEP TELEPHONE PEDESTAL
- TRF TRANSFORMER
- WM WATER METER
- WV WATER VALVE
- WELL
- AG ABOVE GRADE
- BG BELOW GRADE
- CB CATCH BASIN
- CL CENTER LINE
- CO CLEAN OUT
- CMP CORRUGATED METAL PIPE
- CPP CORRUGATED PLASTIC PIPE
- DI DROP INLET
- EJB ELECTRIC JUNCTION BOX
- EM ELECTRIC METER
- EMN EXISTING MAG NAIL
- EN EXISTING NAIL
- EOP EDGE OF PAVEMENT
- EPK EXISTING PK NAIL
- ERRS EXISTING RAILROAD SPIKE
- FO FIBER OPTIC
- FL FLUSH WITH GRADE
- ICV IRRIGATION CONTROL VALVE
- MBS MINIMUM BUILDING SETBACKS
- NF NOW OR FORMERLY
- NMN NEW MAG NAIL
- RCP REINFORCED CONCRETE PIPE
- ROW RIGHT-OF-WAY
- TBC TOP BACK CURB
- TOC TOE OF CURB
- YI YARD INLET

- SURVEYED PROPERTY BOUNDARY
- COMPUTED / ADJOINER PROPERTY LINE
- RIGHT-OF-WAY
- TRAIL LINE
- SETBACK LINES
- SS SANITARY SEWER LINE
- S STORM LINE
- W WATER LINE
- X FENCE
- E OVERHEAD ELECTRIC LINES
- EASEMENTS

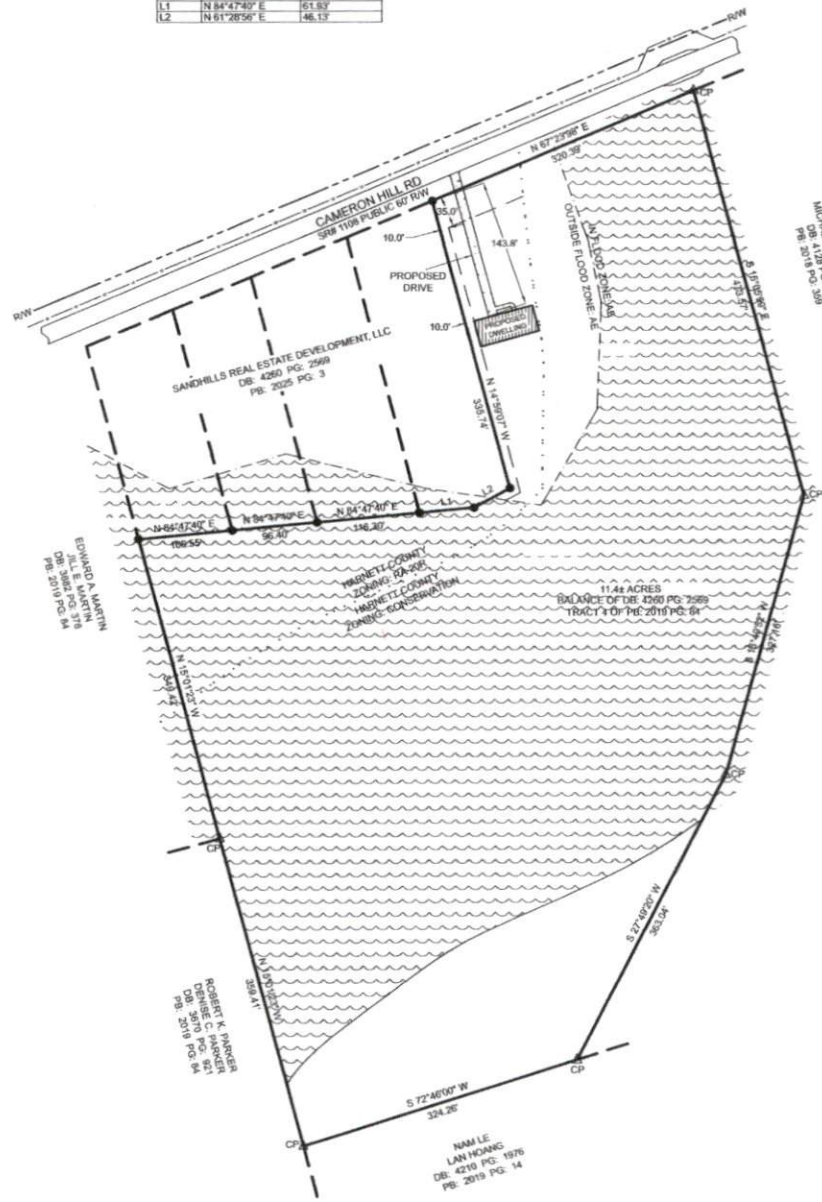

TOTAL PROPERTY BEING SURVEYED IS 11.44 ACRES
DEED BOOK 4260, PAGE 2569
PLAT CABINET 2019, SLIDE 84
PB 2019 PG 339

- NOTES:
- THIS PROJECT IS LOCATED WITHIN A SPECIAL FLOOD HAZARD AREA PER NCRRFS. MAP# 1713556400J EFFECTIVE DATE: OCTOBER 3, 2006
 - ACREAGE DETERMINED BY COORDINATE METHOD
 - ALL LINES SURVEYED BY DZT LAND SURVEYING, PLLC ARE SHOWN BY BOLD LINES. ALL LINES NOT SURVEYED ARE INDICATED BY DASHED LINES.
 - TAX PARCEL PIN: 55564-64-4384
 - ZONING: RA-20R, CONSERVATION
 - PUBLIC WATER SUPPLY WATERSHED: STREAM: LITTLE RIVER (INTAKE NO.2) TYPE: WS-BIP
 - NO ATTEMPT WAS MADE BY THIS SURVEY TO LOCATE ALL UNDERGROUND UTILITIES NOR ANY OTHER EASEMENTS OR CONVEYANCES THAT WOULD BE REVEALED BY A TITLE SEARCH
 - VERIFY MINIMUM BUILDING SETBACKS BEFORE CONSTRUCTION.
 - LOCATION OF UNDERGROUND UTILITIES, IF SHOWN, ARE BASED ON VISIBLE EVIDENCE AND DRAWINGS PROVIDED TO THE SURVEYOR. LOCATION OF UNDERGROUND UTILITIES AND STRUCTURES MAY VARY FROM SHOWN LOCATIONS. ADDITIONAL UTILITIES MAY EXIST. LOCAL UTILITY COMPANIES SHOULD BE CONSULTED FOR FURTHER INFORMATION ON UTILITIES AFFECTING THE PROPERTY.
 - MONUMENTATION FROM PB: 2019 PG: 84 NOT ACTUALLY SET.
 - APPROXIMATE LOCATION OF 6" WATER MAIN FROM HARNETT COUNTY GIS. SURVEYOR DOES NOT CERTIFY TO ITS LOCATION OR EXISTENCE.

I, DAVID R. EISSICK, CERTIFY THAT THIS MAP WAS DRAWN UNDER MY SUPERVISION FROM AN ACTUAL SURVEY MADE UNDER MY SUPERVISION (DEED DESCRIPTION RECORDED IN (SEE REFERENCE TABLE); THAT THE BOUNDARIES NOT SURVEYED ARE INDICATED AS DRAWN FROM INFORMATION IN (SEE REFERENCE TABLE); AND THAT THIS MAP MEETS THE REQUIREMENTS OF THE STANDARDS OF PRACTICE FOR LAND SURVEYING IN NORTH CAROLINA (21 NCAC 56.1600).

THIS 17TH DAY OF APRIL, A.D., 2025.

David R. Eissick

PROFESSIONAL LAND SURVEYOR, L-5423



SignFlow e-signature (S) Declaration
04/17/2025 14:06:10 UTC

PLOT PLAN FOR:
ERIC AND ANIKA DAVIS
APRIL 17TH, 2025
JOHNSONVILLE TOWNSHIP
HARNETT COUNTY, NORTH CAROLINA

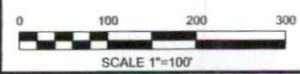

REFERENCE TABLE:	PROPERTY ADDRESS:
DEED BOOK 4260, PAGE 2569	CAMERON HILL RD
PLAT CABINET 2019, SLIDE 84	CAMERON, NC 28326
HARNETT COUNTY REGISTRY	OWNER'S ADDRESS:
	1565 N MAY ST
	SOUTHERN PINES, NC 28387



DZT
LAND SURVEYING, PLLC NC FIRM #3366

SUITE 5 7900 NC HWY 15501 WEST END, NC 27376