



TOWN OF COATS

ZONING PERMIT APPLICATION

NOTE: Attach a site plan that includes property lines (front, side, and rear), location of proposed structures (including driveways, decks, etc.), and existing structures. This plan should be drawn to scale. Also, in order to receive a Privilege License from the Town of Coats to open a business, you must have a valid Zoning Permit, along with all applicable inspections from Harnett County.

Permit No.: 3-11-25-2 Date: 3/11/25 Fee: 50

Parcel ID*: 07160001 0018 Area Zoned As: _____

APPLICANT:

Name (Print) Donovan Coulter
 Address 264 williams Rd
 City, State Coats, NC
 Zip Code 27521
 Phone # 919-980-1434

PROPERTY OWNER:

Name Donovan Coulter
 Address 264 williams Rd
 City, State Coats, NC
 Zip Code 27521
 Phone # 919-980-1434

Location of Property: IN-TOWN ☒ ETJ ☐ ETJ (contiguous) ☐

Present Use of Property: Personal Residential

PROPOSED USE OF PROPERTY:

[] Single Family Dwelling: # Rooms: _____ # Bedrooms: _____ Square Feet: _____
 [] Multi Family Dwelling: # of Units: _____ #Bedrooms (per unit): _____ Square Feet (per unit) _____
 [] Mobile Home (single lot): Single wide: _____ Double Wide: _____
 [] Mobile Home Park: Section 16, Zoning Ordinance must apply
 [] Business: Total # of employees per day _____ Type of business _____
 [X] Others (specify): Construct a metal shed on a concrete slab. Enclosed building 30'x30' with 10'x30' lean-to
 [] Existing structure: _____ Renovate: _____ Addition: _____ Demolish: _____

WATER AND SEWER SUPPLY:

Water: [] Private [] Public [] Proposed [] Existing
 Sewer: [] Private [] Public [] Proposed [] Existing

Applicant: I certify that all of the information presented in this application is true, complete, and accurate to the best of my knowledge. False information is grounds for rejection of the application.

Signature: Donovan Coulter Date: 2/24/2025

ZONING ADMINISTRATOR USE ONLY

Notes: _____

Approved: ☒ Denied: ☐

Zoning Administrator: Elizabeth Krige Date: 3-11-2025

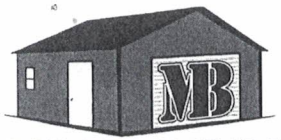

MILLENNIUM
— BUILDINGS —

Customer Order - Feb 18, 2025

Millennium Buildings

866-216-8499

Info@millenniumbuildings.com

Ship To

Name Danavan Coulter Order # 1739808726377066
Billing Address _____
City _____ State _____ Zip Code _____
Install Address _____
City _____ State NC Zip Code 27521
Email _____ Phone # _____ Mobile # _____

Building Info	Size	Color	Anchoring & Site Preparation
Style: Triple Wide	40' X 30' X 12'9" Width Length Leg Height	Roof Black <input checked="" type="checkbox"/>	Installation Surface: Concrete
Roof Overhang: 6"		Trim: Black <input checked="" type="checkbox"/>	Installation Surface (Provided by Customer)
Roof Style: Vertical Style		Gable End Wall White <input type="checkbox"/>	Power Available (Within 100' of Installation Site) <input type="checkbox"/>
Gauge: 12-Gauge Framing		Side Wall White <input type="checkbox"/>	Site Ready (Concrete/Asphalt Already Cured - Ground Level) <input type="checkbox"/>
Leg Style: Standard			Jobsite Level (At most 3"-4") <input type="checkbox"/>
Brace: Standard Brace			Engineer Certified: 150/35 Cert

Design Link & Notes

Design Link: <https://millenniumbuildings.com/resources/3dbuilder/?lng=en-US#0669144d629b1b1b3917e9511685b791>

Building Images

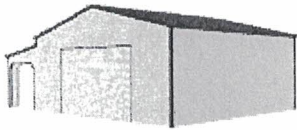

Perspective View

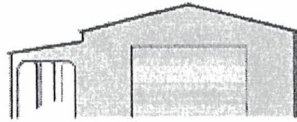

Front

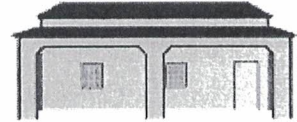

Left Side

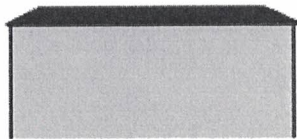



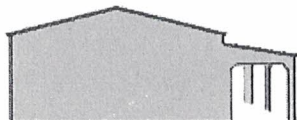



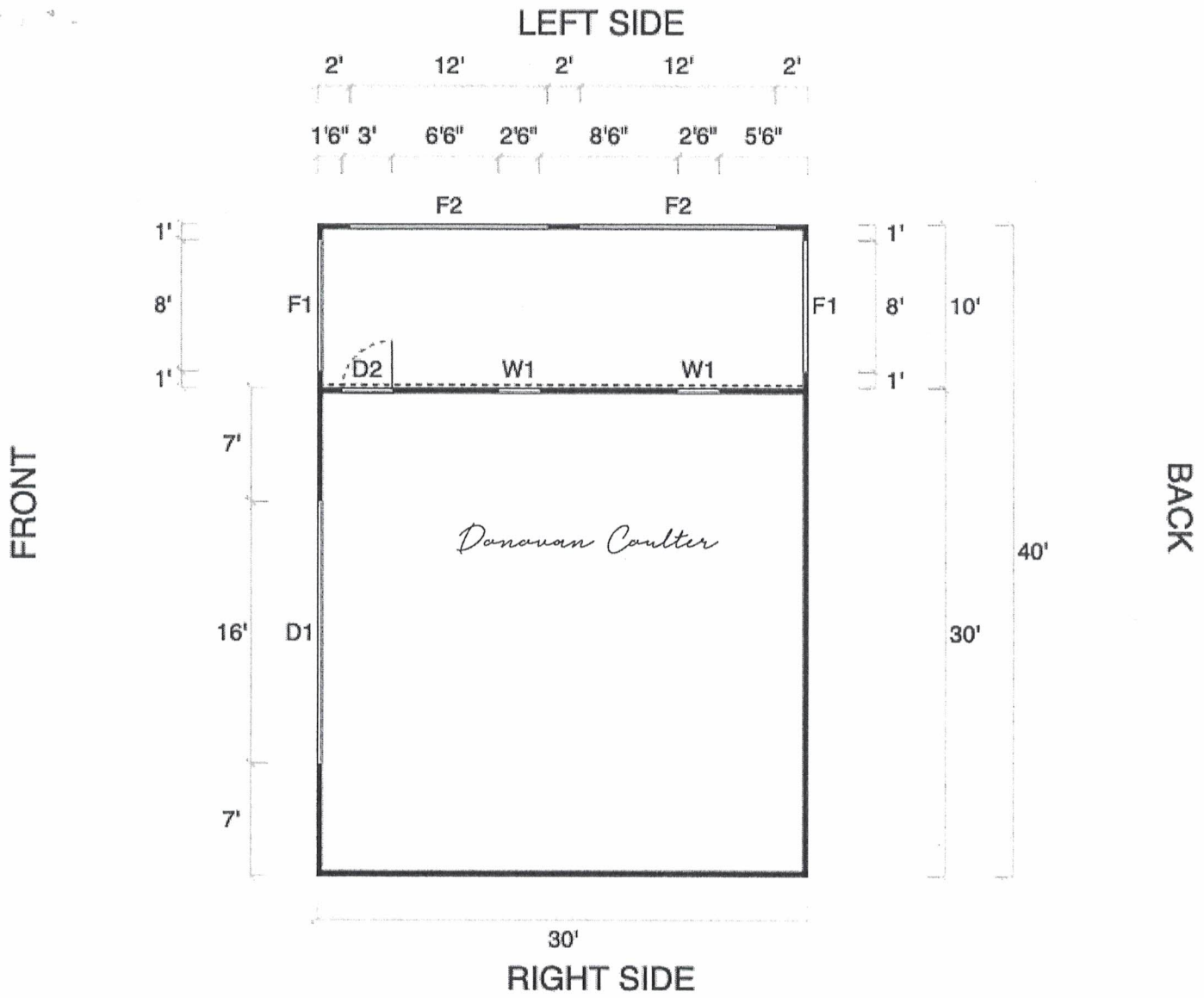

Right Side



Back

#1739808726377066



SYMBOL LEGEND					
	D1	16'x10' Certified Garage Door*		D2	Walk-In Door (36x80)
	W1	30W x 36H Windows		F1	Frameout 8'x8' Garage Door
	F2	Frameout - Custom Size			Closed Wall
		Open Wall			