



Millennium Buildings
866-216-8499
Info@millenniumbuildings.com

Customer Order - **Feb 18, 2025**

Ship To

Name <u>Danovan Coulter</u>	Order # <u>1739808726377066</u>
Billing Address _____	
City _____	State _____ Zip Code _____
Install Address _____	
City _____	State <u>NC</u> Zip Code <u>27521</u>
Email _____	Phone # _____ Mobile # _____

Building Info	Size	Color	Anchoring & Site Preparation
Style: Triple Wide	$\frac{40'}{\text{Width}} \times \frac{30'}{\text{Length}} \times \frac{12'9'}{\text{Leg Height}}$	Roof Black <input checked="" type="checkbox"/>	Installation Surface: Concrete
Roof Overhang: 6"		Trim: Black <input checked="" type="checkbox"/>	Installation Surface (Provided by Customer)
Roof Style: Vertical Style		Gable End Wall White <input type="checkbox"/>	Power Available (Within 100' of Installation Site) <input type="checkbox"/>
Gauge: 12-Gauge Framing		Side Wall White <input type="checkbox"/>	Site Ready (Concrete/Asphalt Already Cured - Ground Level) <input type="checkbox"/>
Leg Style: Standard			Jobsite Level (At most 3"-4") <input type="checkbox"/>
Brace: Standard Brace			Engineer Certified: 150/35 Cert

Design Link & Notes

Design Link: <https://millenniumbuildings.com/resources/3dbuilder/?lng=en-US#0669144d629b1b1b3917e9511685b791>

Building Images

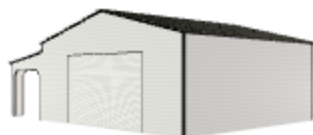

Perspective View



Front



Left Side



Right Side



Back

#1739808726377066

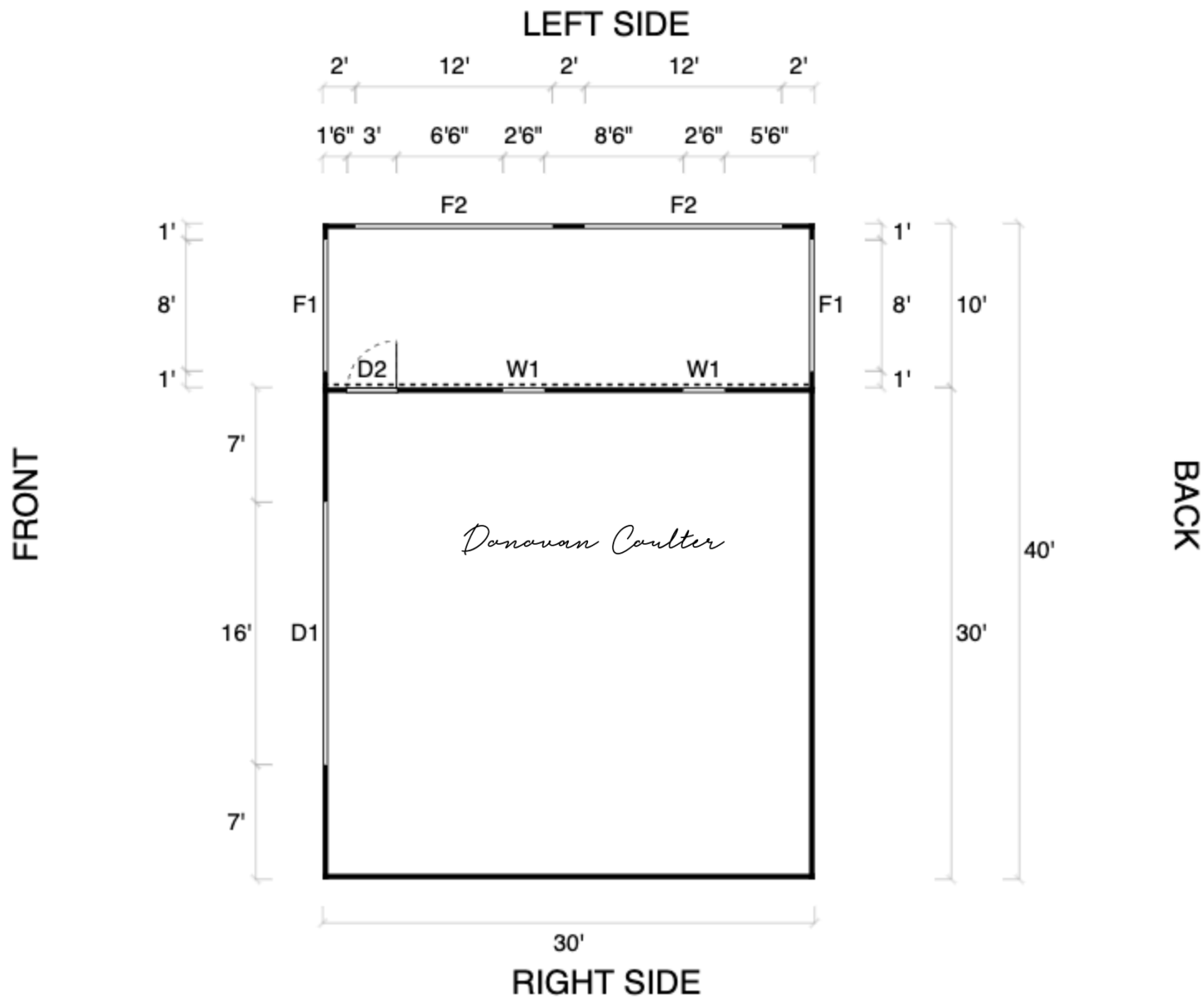

SYMBOL LEGEND

D1	16'x10' Certified Garage Door*	D2	Walk-In Door (36x80)
W1	30W x 36H Windows	F1	Frameout 8'x8' Garage Door
F2	Frameout - Custom Size	—	Closed Wall
----	Open Wall		