

Owner: Ashley Twiss Applicant:
Address: 5215 Cool Spring
Proposed Facility: DWMT

Date Evaluated: _____
Design Flow (.1949): 600 GPD Property Size: _____

Property Recorded:

☒ Public ☐ Individual ☐ Well ☐ Spring ☐ Other☒ Pit ☐ Cut☐ Industrial Process ☐ Mixed

Description	Initial System	Repair System	Other Factors (.1946): Site Classification (.1948): Evaluated By: <i>SM d-REH</i> Others Present:
Available Space (.1945)	<input checked="" type="checkbox"/>	<input checked="" type="checkbox"/>	
System Type(s)	<input checked="" type="checkbox"/>	<input checked="" type="checkbox"/>	
Site I.T.A.R.	<input checked="" type="checkbox"/>	<input checked="" type="checkbox"/>	

COMMENTS: _____

LANDSCAPE POSITIONS	GROUP	TEXTURES	.1955 LTAR	CONSISTENCE MOIST	WET
R-RIDGE	I	S-SAND	1.2 - 0.8	VFR-VERY FRIABLE	NS-NON-STICKY
S-SHOULDER SLOPE		LS-LOAMY SAND		FR-FRIABLE	SS-SLIGHTLY STICKY
L-LINEAR SLOPE				FI-FIRM	S-STICKY
FS-FOOT SLOPE	II	SL-SANDY LOAM	0.8 - 0.6	VFI-VERY FIRM	VS-VERY STICKY
N-NOSE SLOPE		L-LOAM		EFI-EXTREMELY FIRM	NP-NON-PLASTIC
H-HEAD SLOPE					SP-SLIGHTLY STICKY
CC-CONCLAVE SLOPE	III	SI-SILT	0.6 - 0.3		P-PLASTIC
CV-CONVEX SLOPE		SIL-SILT LOAM			VP-VERY PLASTIC
T-TERRACE		CL-CLAY LOAM			
FP-FLOOD PLAN		SCL-SANDY CLAY LOAM			
	IV	SIC-SILTY CLAY	0.4 - 0.1		
		C-CLAY			
		SC-SANDY CLAY			

STRUCTURE

SG-SINGLE GRAIN
M-MASSIVE
CR-CRUMB
GR-GRANULAR
SBK-SUBANGULAR BLOCKY
ABK-ANGULAR BLOCKY
PL-PLATY
PR-PRISMATIC

MINERALOGY

SLIGHTLY EXPANSIVE
EXPANSIVE

Show profile locations and other site features (dimensions, references or benchmark, and North)

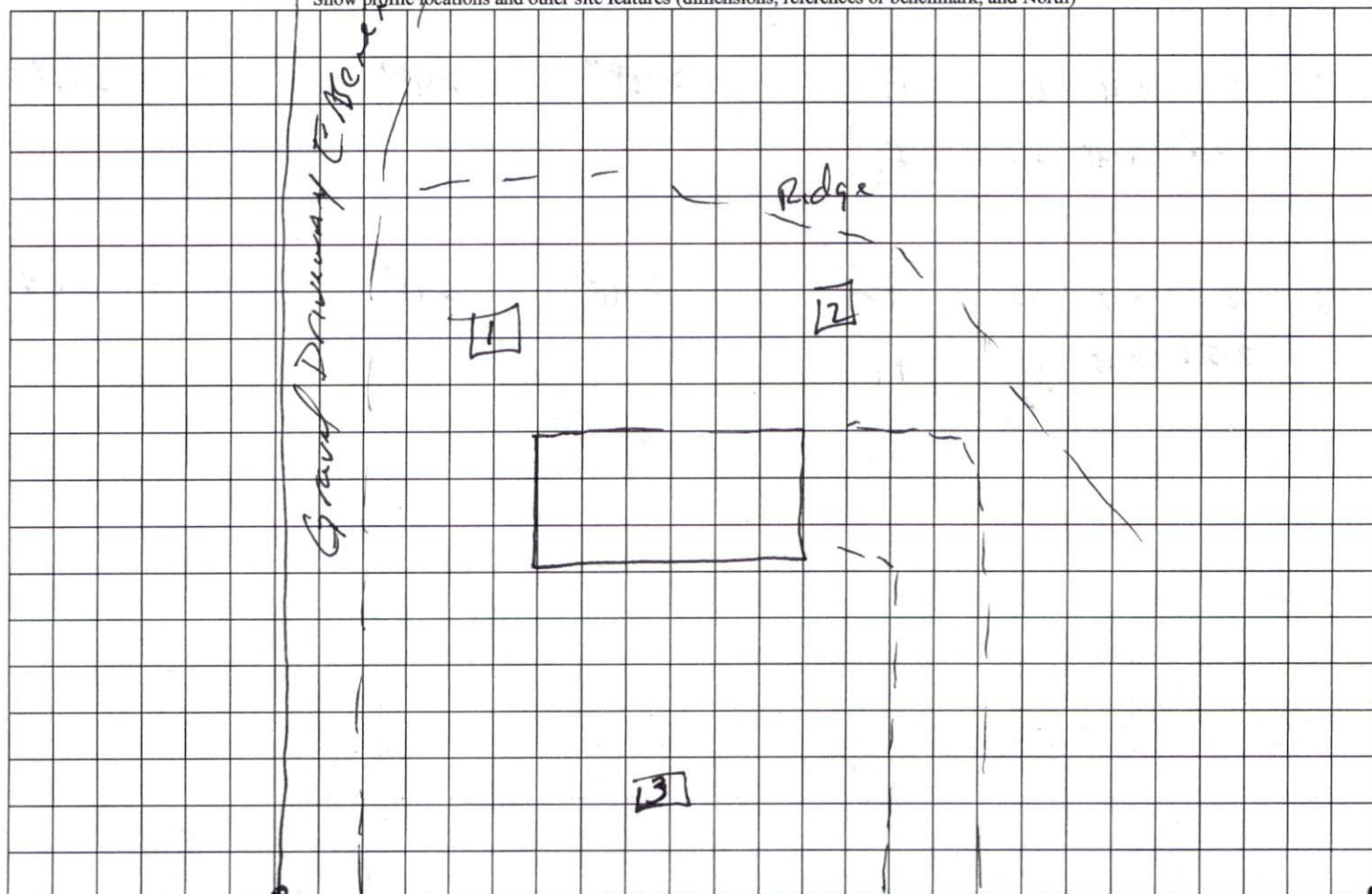

Cool Spring Rd