



Scope of Work for:
25 Remington Hill Dr
Bunnlevel, NC 28323

*CrawlSeal System to include the following:

-20 ml Vapor Barrier installed wall to wall with 100% floor coverage. All sections of liner will be overlapped a minimum of 1' and will be seamed together, attached with Christmas Tree fasteners, and caulked.

-Install WallSeal on basement walls to help prevent water vapor and moisture intrusion as well as direct wall leakage to the waterproofing system. (12 ml Vapor Barrier on Walls)

-Wrap all existing CMU/Brick Piers 20 ml Vapor Barrier. Contractor will leave a termite inspection gap at the top of each pier. The liner will be fastened to the pier and the top edge of the liner will be sealed with caulking.

-All Vents will be sealed from inside the crawl space with R-10 Rigid 2" Foam Sheathing.

**AprilAire E100 Dehumidifier install - unit specifications on page 2

*R-19 Insulation installed in the rim joist cavities.

*Extreme Block - R-10 Rigid 2" Foam Sheathing - Wall Insulation installed with a 3-4" termite inspection reveal left at the top of the foundation wall. All vents will be sealed from the inside.

*Electrical - Installation of new dedicated 120vac/20amp electrical circuit/s and electrical outlet/s (WP-GFCI) to supply sump pump and /or dehumidifier in crawl space (basement).

Touchstone Electric

8601 Six Forks Road

Unit 400

Raleigh, NC 27601

(919) 670-4015

dispatch@touchstoneelectric.com

License # U.37073

TARHEEL™

BASEMENT SYSTEMS

A Groundworks Company

SPECIFICATIONS	
Capacity	
	@ 80°F/60% RH 100 ppd
	@ 73°F/60% RH 85 ppd
Energy Factor	
	@ 80°F/60% RH 2.6 L/kW-h
	@ 73°F/60% RH 2.35 L/kW-h
Airflow @ varying E.S.P. (external static pressure - dry coil)	
	0.0" w.c. 280 CFM
	0.2" w.c. 245 CFM
	0.4" w.c. 210 CFM
Voltage, phase, frequency	120VAC, 1 phase, 60 Hz
Current draw⁽¹⁾	6.9 Amps
Noise	55 dBA ducted
Dimensions: (cabinet only) ⁽²⁾	Width: 14" Height: 15" Length: 26"
Unit Weight	64 lbs.
Shipping Weight	82 lbs.
Inlet air operating conditions during	
-Dehumidification:	50°F-104°F, 40°F dew point min.
-Ventilation:	40°F-140°F, 0%-99% RH (non-condensing)
⁽¹⁾ Rated capacity, energy factor and current draw measured at 80°F/60% RH inlet air at 0.0 ESP.	
⁽²⁾ Height does not include adjustable feet. The width excludes the filter doors and length excludes the duct collars.	

front

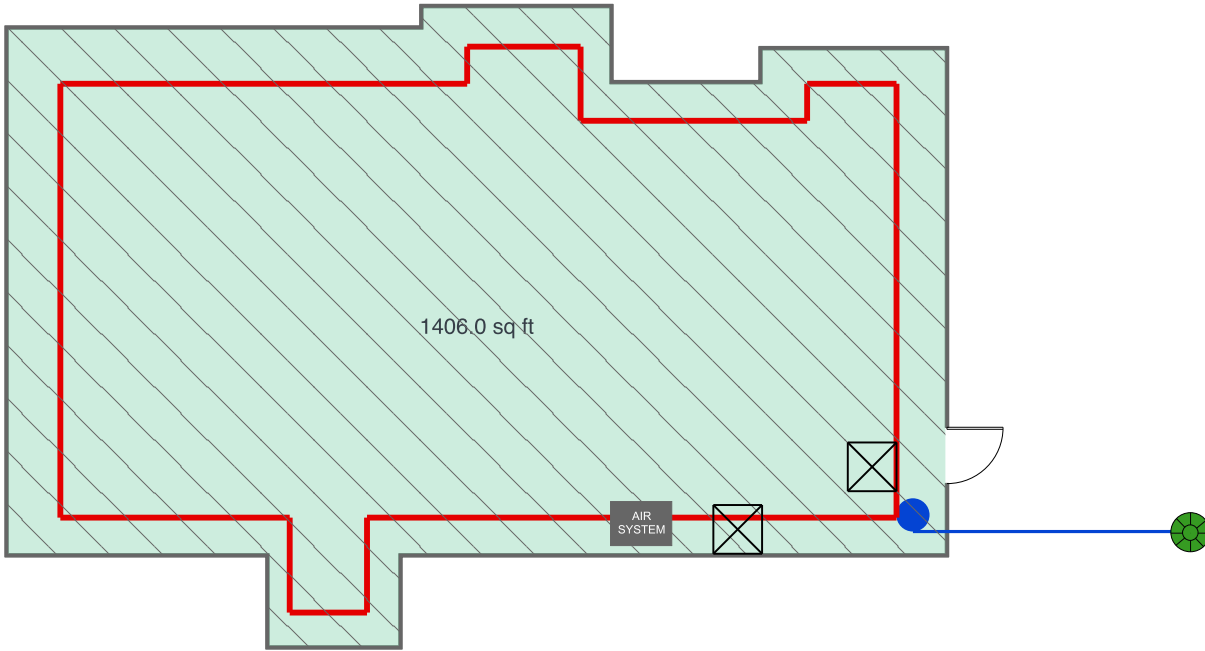

Back

Title: Joseph wendl	Drawn: Cullen Toomey	Customer: 244042
site: 25 Remington Hill Dr	Date: 11/21/24	Tarheel Basement Systems- 3333 Air Park Rd Fuquay- Varina