

**VICINITY MAP**  
Not To Scale

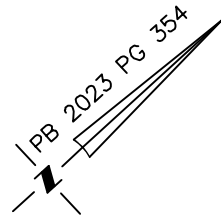
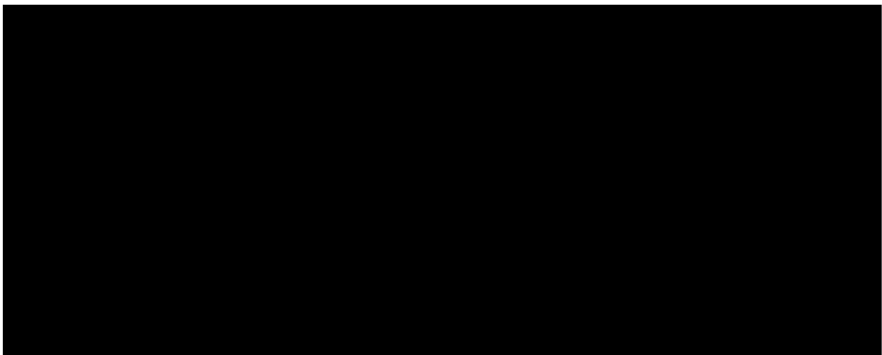

SEWER LAT.  
○  
■  
WATER METER

SETBACKS: (PB 2023 PG 350)

- FRONT - 20'  
REAR - 20'  
SIDE - 4'  
CORNER YARD - 12'

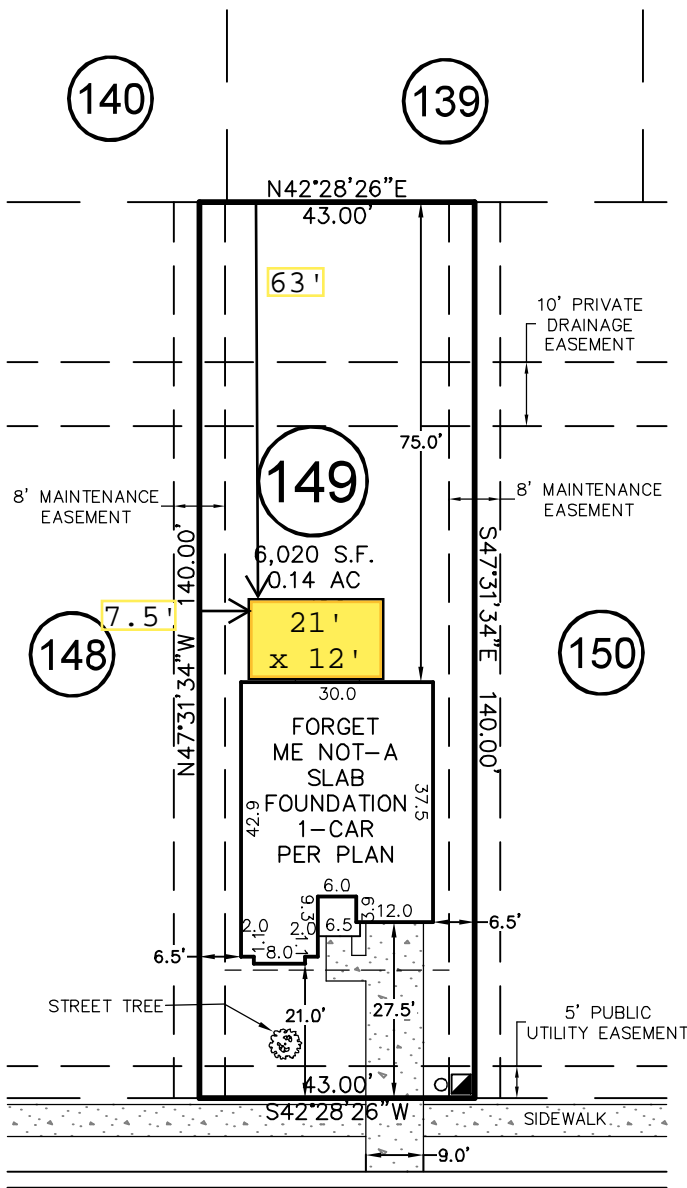

**ASHBROOK COVE**  
50' PUBLIC R/W  
& UTILITY

THIS PROPERTY MAY BE SUBJECT TO ANY AND ALL APPLICABLE DEED RESTRICTIONS, EASEMENTS, RIGHT-OF-WAY, UTILITIES AND RESTRICTIVE COVENANTS WHICH MAY BE OF RECORD OR IMPLIED

THIS DRAWING DOES NOT REFLECT AS-BUILT INFORMATION

**PRELIMINARY PLAT**  
NOT FOR RECORDATION, CONVEYANCES, OR SALES.

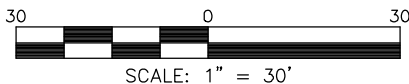

**HOUSE LOCATION PLOT PLAN**

FOR  
#66 ASHBROOK COVE  
LOT 149, SERENITY SUBDIVISION, PHASE 1D, 1E & 2G  
(LOTS LESS THAN 9,000 SF) LOTS 144-167, & 248-272  
Hector's Creek Township, Harnett County, North Carolina

PROPERTY OF: GARMAN HOMES  
MAP BOOK 2023 PAGE 350-356 DEED REFERENCE \_\_\_\_\_

DRAWN: JLS | SURVEYED: N/A | CHECKED: DMR | DATE: MARCH 27, 2024