

SOIL/SITE EVALUATION
 for ON-SITE WASTEWATER SYSTEM

Owner: Zachary Cochran
 Applicant: Zachary Cochran

Address: 9792 NC 2105

Proposed Facility: SWMH

Location of Site:

Water Supply:

Evaluation Method: Auger Boring

Type of Wastewater:

Date Evaluated: 480 GPD

Design Flow (.1949):

Property Recorded:

- Public Individual Well Spring Other
 Pit Cut
 Industrial Process Mixed
 Sewage

Property Size:

P R O F I L E #	.1940 Landscape Position/ Slope %	Horizon Depth (In.)	SOIL MORPHOLOGY .1941		OTHER PROFILE FACTORS				Profile Class & LTAR
			.1941 Structure/ Texture	.1941 Consistence Mineralogy	.1942 Soil Wetness/ Color	.1943 Soil Depth (IN.)	.1956 Sapro Class	.1944 Restr Horiz	
1	L	0-10	LS	Fr	10YR 8/1	>40"	-	-	U
	2-5%	10-40	SC	Fi	< 11"				
2,4	L	0-14	LS	Fr	10YR 6/1	>48"	-	-	S.3
	2-5%	14-48	SCR	Fi	≥ 30"	(Pump)			
3,5,6 7,8,9	L	0-10	LS	Fr	10YR 6/1	>40"	-	-	U
	2-5%	10-40	SC	Fi	< 10"				
10,11 12,13	L	0-26	LS	Fr	10YR 6/1	>48"	-	-	S.4
	2-5%	26-48	SCR	Fi	≥ 36"				

Description	Initial System	Repair System
Available Space (.1945)	<input checked="" type="checkbox"/>	<input checked="" type="checkbox"/>
System Type(s)	<input checked="" type="checkbox"/>	<input checked="" type="checkbox"/>
Site LTAR	.4	.4

Other Factors (.1946):
 Site Classification (.1948):
 Evaluated By: S M REHS
 Others Present:

COMMENTS: _____

LANDSCAPE POSITIONS	GROUP	TEXTURES	.1955 LTAR	CONSISTENCE MOIST	WET
R-RIDGE	I	S-SAND	1.2 - 0.8	VFR-VERY FRIABLE	NS-NON-STICKY
S-SHOULDER SLOPE		LS-LOAMY SAND		FR-FRIABLE	SS-SLIGHTLY STICKY
L-LINEAR SLOPE	II	SL-SANDY LOAM	0.8 - 0.6	FI-FIRM	S-STICKY
FS-FOOT SLOPE		L-LOAM		VFI-VERY FIRM	VS-VERY STICKY
N-NOSE SLOPE	III	SI-SILT	0.6 - 0.3	EFI-EXTREMELY FIRM	NP-NON-PLASTIC
H-HEAD SLOPE		SIL-SILT LOAM		SP-SLIGHTLY STICKY	
CC-CONCLAVE SLOPE		CL-CLAY LOAM		P-PLASTIC	
CV-CONVEX SLOPE		SCL-SANDY CLAY LOAM		VP-VERY PLASTIC	
T-TERRACE	IV	SIC-SILTY CLAY	0.4 - 0.1		
FP-FLOOD PLAN		C-CLAY			
		SC-SANDY CLAY			

STRUCTURE
 SG-SINGLE GRAIN
 M-MASSIVE
 CR-CRUMB
 GR-GRANULAR
 SBK-SUBANGULAR BLOCKY
 ABK-ANGULAR BLOCKY
 PL-PLATY
 PR-PRISMATIC

MINERALOGY
 SLIGHTLY EXPANSIVE
 EXPANSIVE

Show profile locations and other site features (dimensions, references or benchmark, and North)

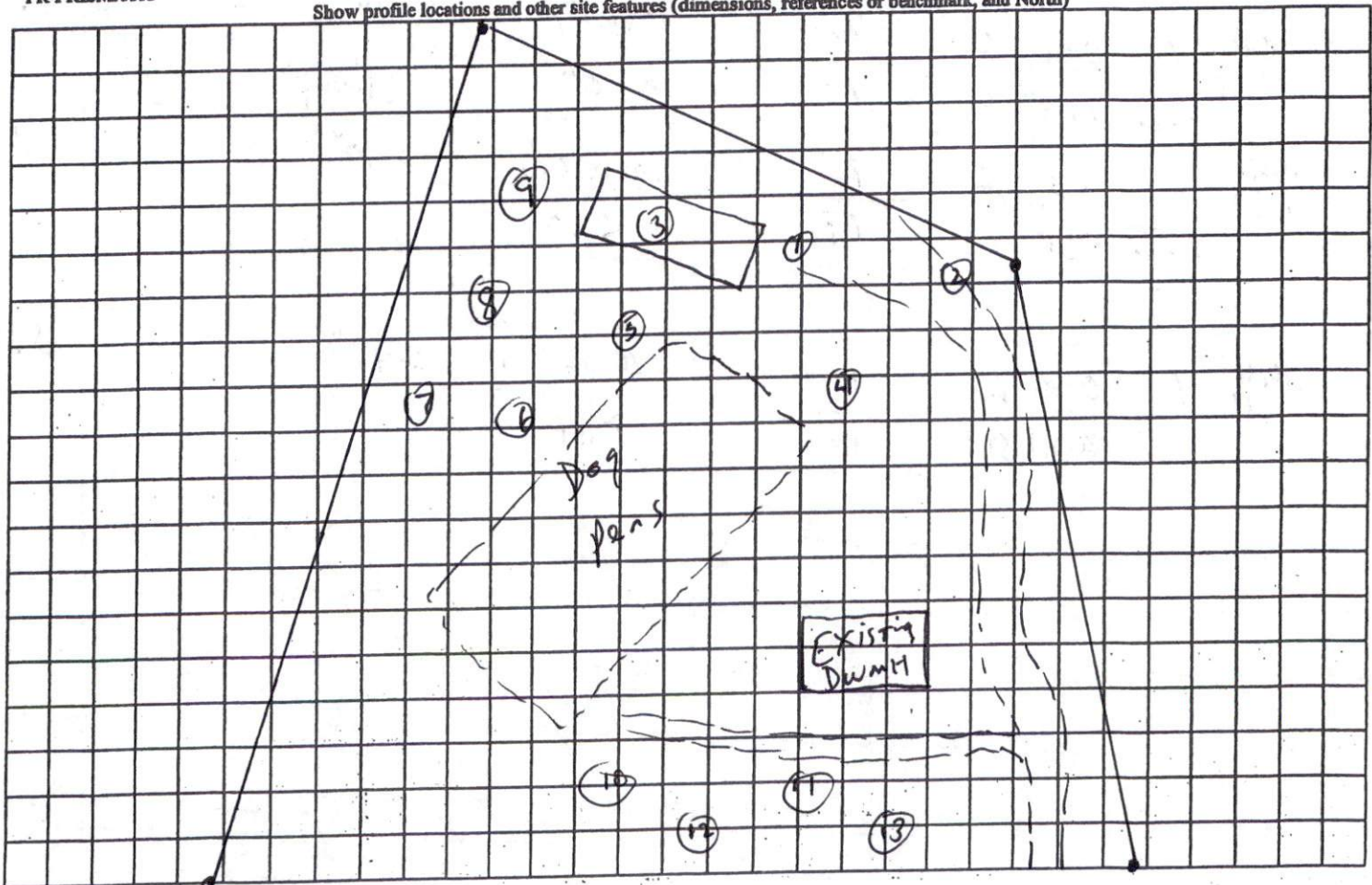

← Spring Lake ← NC 2105 → Callington →