



COMMENTS: \_\_\_\_\_

<u>LANDSCAPE POSITIONS</u>	<u>GROUP</u>	<u>TEXTURES</u>	<u>1955 LTAR</u>	<u>CONSISTENCE MOIST</u>	<u>WET</u>
R-RIDGE	I	S-SAND	1.2 - 0.8	VFR-VERY FRIABLE FR-FRIABLE FI-FIRM VFI-VERY FIRM EFI-EXTREMELY FIRM	NS-NON-STICKY
S-SHOULDER SLOPE		LS-LOAMY SAND			SS-SLIGHTY STICKY
L-LINEAR SLOPE	II	SL-SANDY LOAM	0.8 - 0.6		S-STICKY
FS-FOOT SLOPE		L-LOAM			VS-VERY STICKY
N-NOSE SLOPE	III	SI-SILT	0.6 - 0.3		NP-NON-PLASTIC
H-HEAD SLOPE		SIL-SILT LOAM			SP-SLIGHTLY STICKY
CC-CONCLAVE SLOPE		CL-CLAY LOAM			P-PLASTIC
CV-CONVEX SLOPE		SCL-SANDY CLAY LOAM			VP-VERY PLASTIC
T-TERRACE	IV	SIC-SILTY CLAY	0.4 - 0.1		
FP-FLOOD PLAN		C-CLAY			
		SC-SANDY CLAY			

STRUCTURE

SG-SINGLE GRAIN  
M-MASSIVE  
CR-CRUMB  
GR-GRANULAR  
SBK-SUBANGULAR BLOCKY  
ABK-ANGULAR BLOCKY  
PL-PLATY  
PR-PRISMATIC

MINERALOGY

SLIGHTLY EXPANSIVE

EXPANSIVE

Show profile locations and other site features (dimensions, references or benchmark, and North)

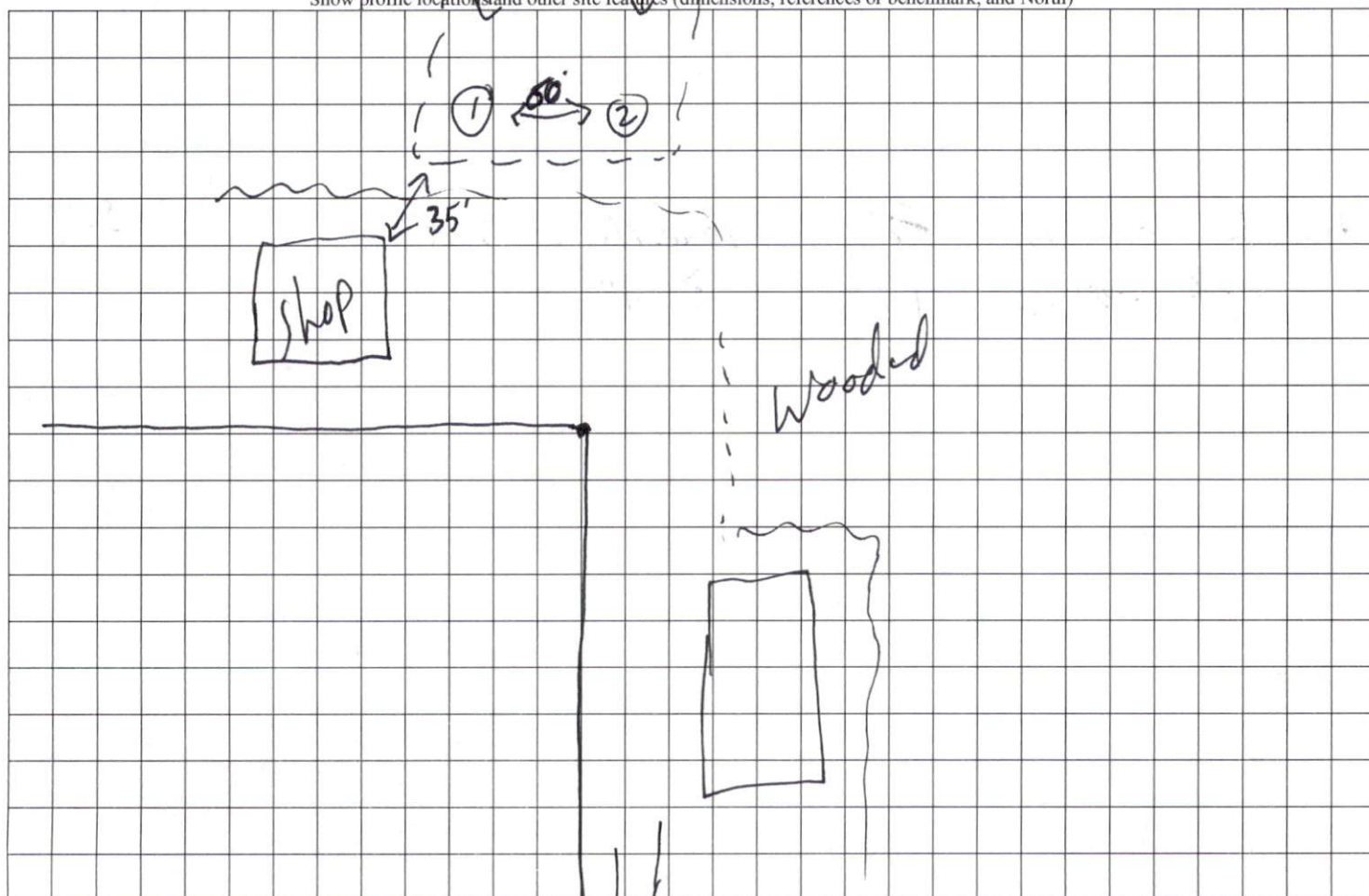

← walkway →