

Chalmers

1

Footing and foundation design

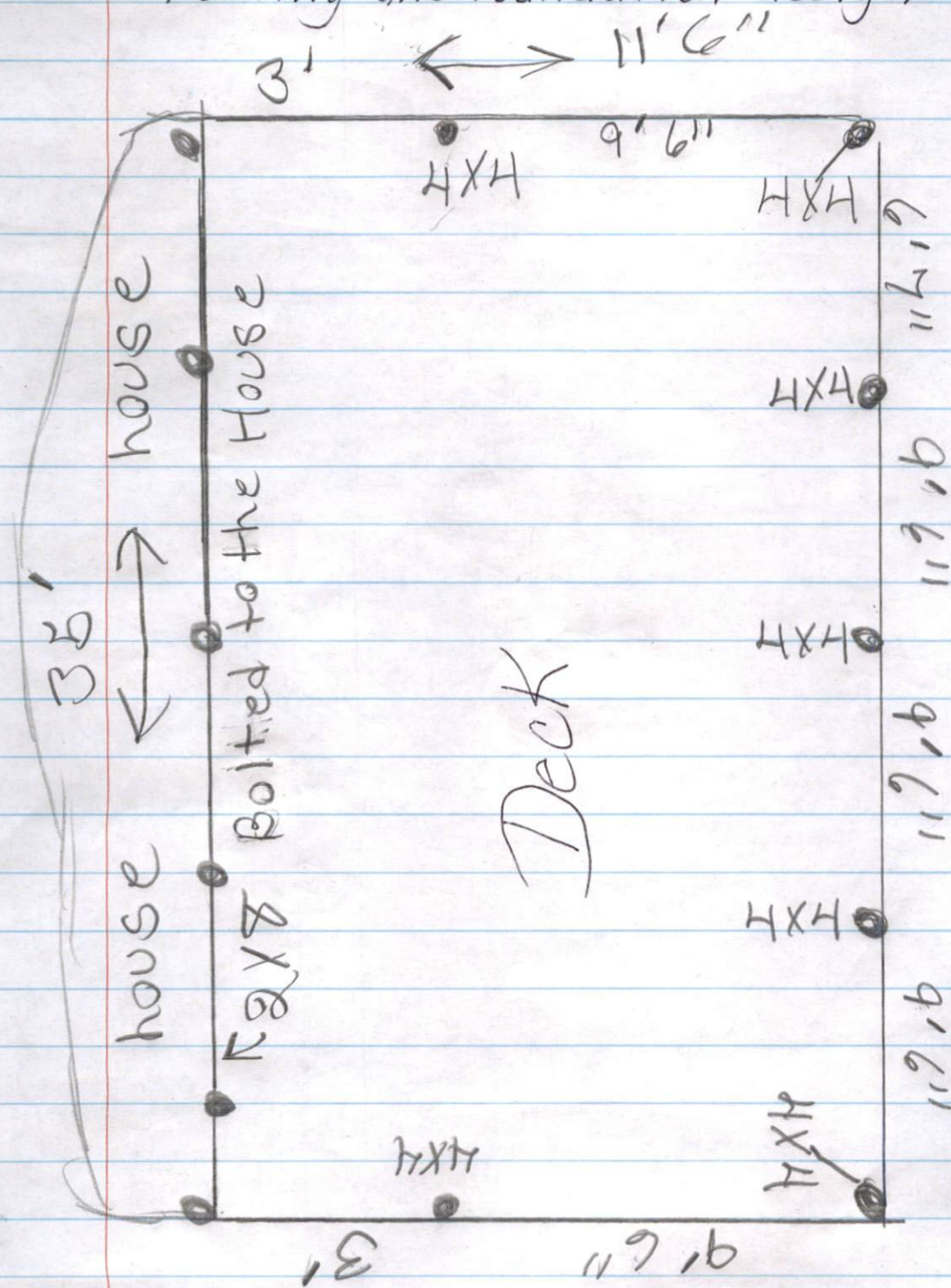

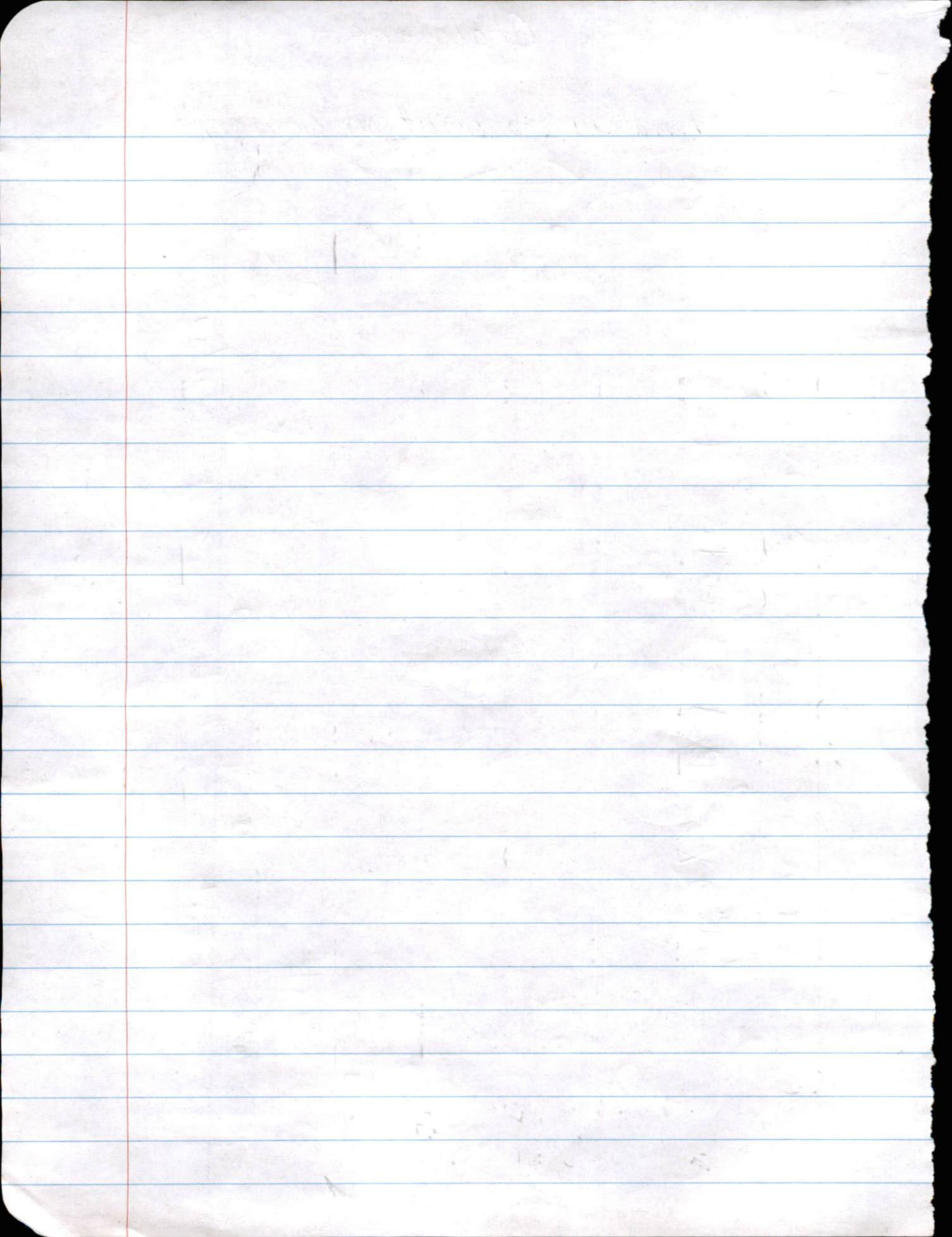

Dimensions on Plan, and Plan drawn to scale
Chalmers

2+3

← 11' 6" →

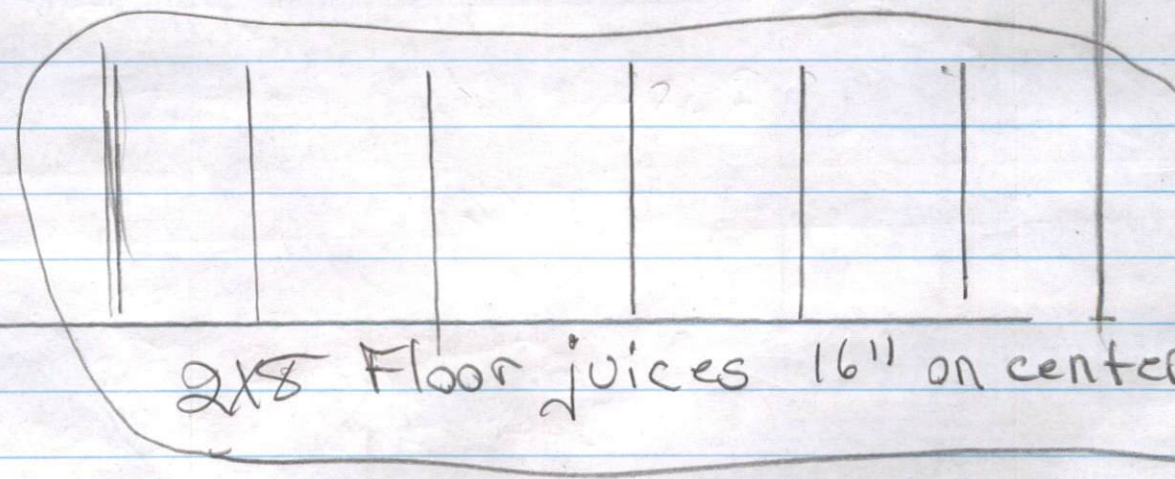
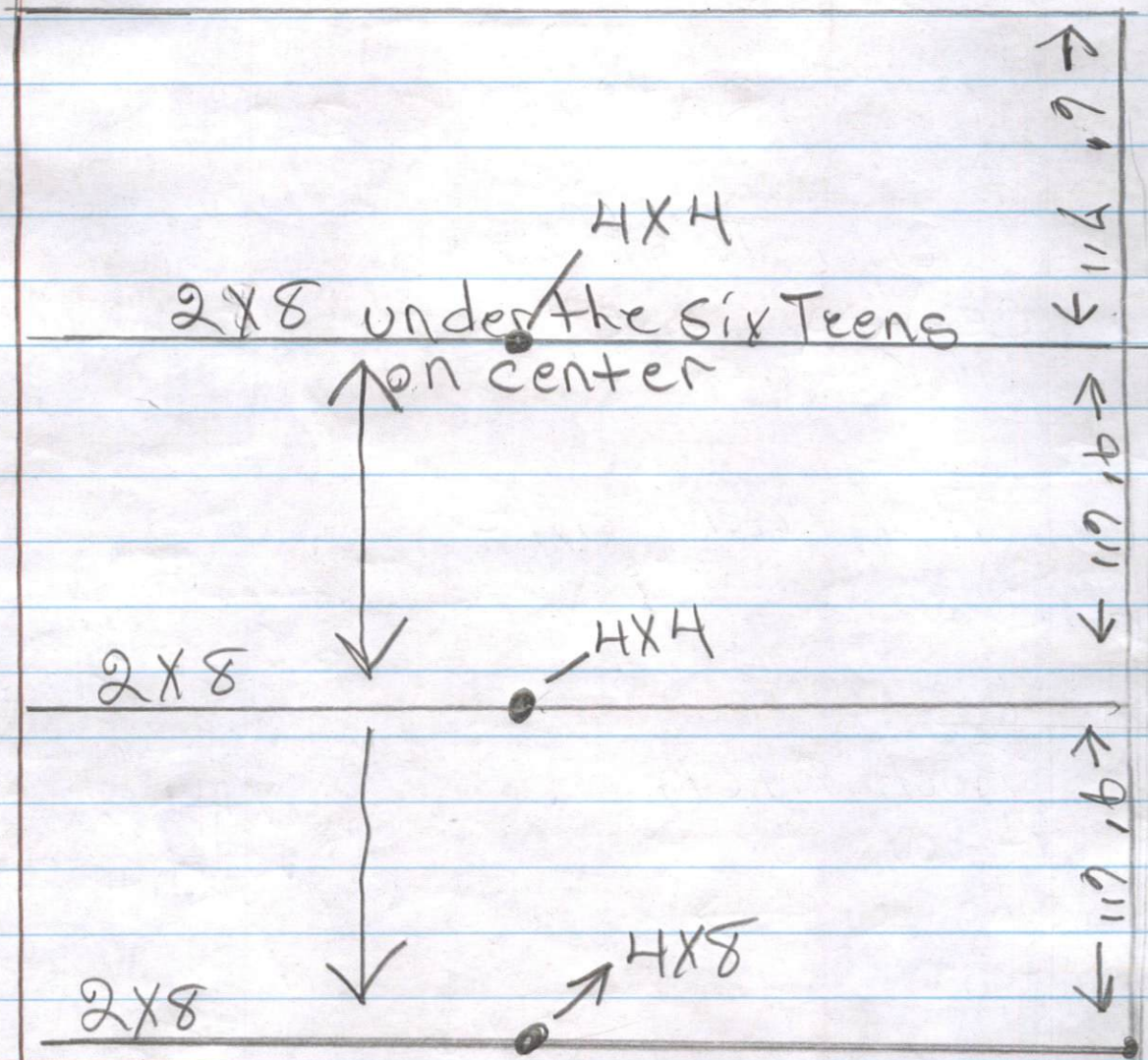

4

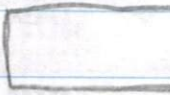
Rafter size
2x6 

RAFTER size

5 Ceiling Joist size
ceiling joist size is 2x6

Roof covering Type

6 Black Tin

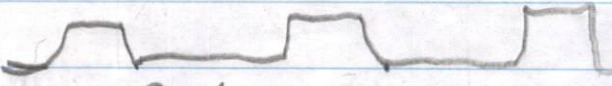
25 gauge 

Roof Pitch

7 it could Be A
10 or 12
Pitch →

1x4 16" center

2x6 2x6 2x6

RAFTER 2' on center

2x6

1, 2, 3, 4

2 is 2x8x2
BEAM the
RAFTER

3

Are on
For
Support

4

2x8 Floor Joists
on center

16" 16" 16" 16" 16" 16" 16" 16"

house

36' →

→ 11' 6" →

Dimensions on plan and plan drawn
to scale

2+3

I Love you.

