

**Harnett County Central Permitting**  
420 McKinney Pkwy Lillington, NC 27546  
PO Box 65 Lillington, NC 27546

Telephone Number: 910-893-7525 ext. 1 Fax 910-893-2793 www.harnett.org/permits

Application for Manufactured Home Set-Up Permit  
(Please fill out each part completely)

**Part I – Owner Information:**

Home Owner Information (To be completed by owner of the manufactured home)

Name: Tommy Ray & Jennifer Lynn<sup>ROUSE</sup> Address: 1245 Cool Springs RoadCity: Lillington, State: NC Zip: 27546 Daytime Phone: (919) 356-7099

Landowner Information (To be completed by landowner, if different than above)

Name: Tommy & Jennifer Rouse Address: 1245 Cool Springs RoadCity: Lillington, State: NC Zip: 27546 Daytime Phone: (919) 356-7099**Part II – Contractor Information** (To be completed by Contractors or Homeowner, if applicable.)

Name, address, &amp; phone must match information on license)

A. **Set-Up Contractor** Company Name: Outlaw Mobile Homes Inc.Phone: (919) 658-6636 Address: 300 Tadlock RoadCity: Mt. Olive, State: NC Zip: 28365 Email: outlawmh@att.netSetup Signature: [Signature] State Lic# 4019B. **Electrical Contractor** Company Name: Nick Outlaw Electric CompanyPhone: (919) 222-0125 Address: 105 Sun Walk DriveCity: LaGrange, State: NC Zip: 28551 Email: nickoutlawelectrical@live.comElectrician's Signature: [Signature] State Lic# 26796-UC. **Mechanical Contractor** Company Name: Mullis Heating & Air LLCPhone: (910) 408-8304 Address: 214 Snowden CourtCity: Richlands, State: NC Zip: 28574 Email: mullisvac@gmail.comHVAC Signature: [Signature] State Lic# 36071D. **Plumbing Contractor** Company Name: M.P.H. Driveways & Septic Tanks, IncPhone: (919) 252-0316 Address: 3510 Summerlins Crossroad RoadCity: Mt. Olive, State: NC Zip: 28365 Email: maxph26@gmail.comPlumber's Signature: [Signature] State Lic# 24198**Part III – Manufactured Home Information**Model Year: 2025 Size: 16 x 76**Complete & follow zoning criteria sheet**

Park Name: \_\_\_\_\_ Lot Number: \_\_\_\_\_

I hereby certify that I have the authority to apply for this permit, that the application is correct including the contractor information and signatures, and that the construction or installation will conform to the applicable manufactured home set-up requirements, and the Harnett County Zoning Ordinance. I understand that if any item is incorrect or false information has been provided that this permit could be revoked.

[Signature]  
Signature of Home Owner or Agent

December 17, 2024  
Date

\*Effective July 1, 2004, a County Tax Department Moving Permit must be provided before a Set Up Permit will be issued. It is purchased from the tax office of the county that the home is moved from. If the home is from a dealer, we need proof of year on the Form 500 and if available, the serial number.  
List of inspections and Egress requirements available upon request. Progress Energy customers must provide Premise Number.

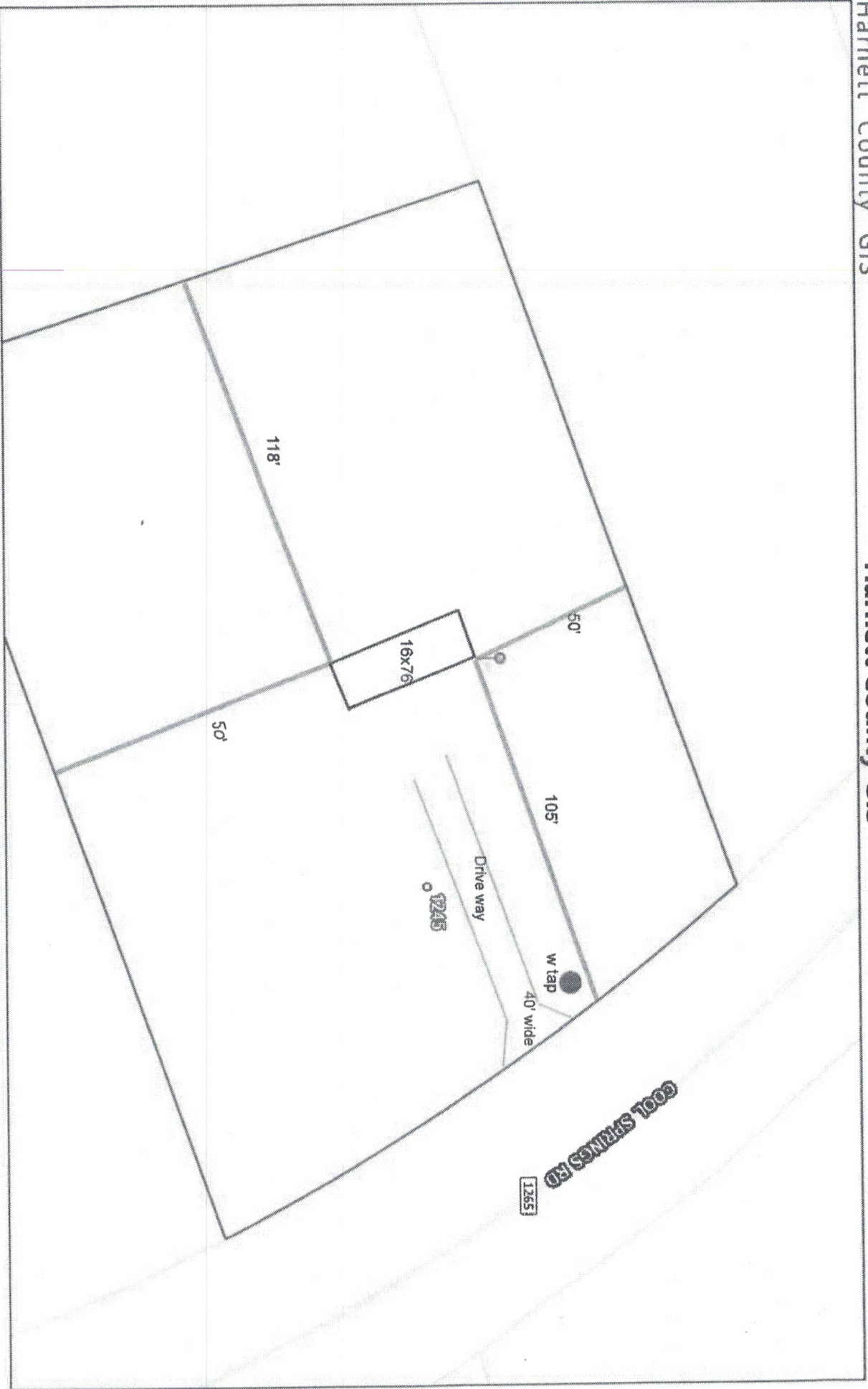

Harnett.org/GIS

October 7, 2024

- County Boundary
- Address Numbers
- Road Centerlines
- Parcels

