



Scope of Work for:
2773 US 401
Lillington, NC 27546

The following will be performed as a crawlspace encapsulation project:

****CrawlSeal System to include the following:**

-20 ml Vapor Barrier installed wall to wall with 100% floor coverage. All sections of liner will be overlapped a minimum of 1' and will be seamed together, attached with Christmas Tree fasteners, and caulked.

-Install WallSeal on basement walls to help prevent water vapor and moisture intrusion as well as direct wall leakage to the waterproofing system. (12 ml Vapor Barrier on Walls)

-Wrap all existing CMU/Brick Piers 20 ml Vapor Barrier. Contractor will leave a termite inspection gap at the top of each pier. The liner will be fastened to the pier and the top edge of the liner will be sealed with caulking.

-All Vents will be sealed from inside the crawl space with R-10 Rigid 2" Foam Sheathing.

*R-19 Insulation installed in the rim joist cavities.

*Extreme Block - R-10 Rigid 2" Foam Sheathing - Wall Insulation installed with a 3-4" termite inspection reveal left at the top of the foundation wall. All vents will be sealed from the inside

*Drainage Matting Install Drainage matting under the CrawlSeal Liner.

*AprilAire E100 Dehumidifier install - unit specifications on page 2

*Electrical - Installation of new dedicated 120vac/20amp electrical circuit/s and electrical outlet/s (WP-GFCI) to supply sump pump and /or dehumidifier in crawl space (basement).

Davis Dunlap Electrical LLC.

210 Timberland Dr

Angier, NC 27501

(919) 669-0768

david@dunlapelectric.com

License #27056-L

TARHEEL™

BASEMENT SYSTEMS

A Groundworks Company

SPECIFICATIONS	
Capacity	
@ 80°F/60% RH	100 ppd
@ 73°F/60% RH	85 ppd
Energy Factor	
@ 80°F/60% RH	2.6 L/kW-h
@ 73°F/60% RH	2.35 L/kW-h
Airflow @ varying E.S.P. (external static pressure - dry coil)	
0.0" w.c.	280 CFM
0.2" w.c.	245 CFM
0.4" w.c.	210 CFM
Voltage, phase, frequency	120VAC, 1 phase, 60 Hz
Current draw^①	6.9 Amps
Noise	55 dBA ducted
Dimensions: (cabinet only)^②	Width: 14" Height: 15" Length: 26"
Unit Weight	64 lbs.
Shipping Weight	82 lbs.
Inlet air operating conditions during	
-Dehumidification:	50°F-104°F, 40°F dew point min.
-Ventilation:	40°F-140°F, 0%-99% RH (non-condensing)
<small>①Rated capacity, energy factor and current draw measured at 80°F/60% RH inlet air at 0.0 ESP.</small>	
<small>②Height does not include adjustable feet. The width excludes the filter doors and length excludes the duct collars.</small>	

*Two (2) Crawlspace Single w/ Backup Install 1/3 HP Sump pump system with liner, cast iron pump, pump stand, water alarm system and battery back-up pumping system with charging/control box with alarm, and 120 amp sealed maintenance free battery.

*CrawlDrain Install CrawlDrain in the area shown. Hand dig in order to develop a trench where indicated on the drawing and install 4" corrugated and perforated pipe with engineered mesh silt sock to collect ground water, back filled with #57 drainage stone and connect to sump system to discharge.

RHOS: 58.68
 RHIS: 68.21
 WMC: 18.5+

CDL: 2'0 3/4 x 1'8 1/8
 Crawl Height: 1'6 to 2'3

Ins. Cond: none

Joist Size: na
 Girder Size/Type: na

Pier/FDN Settlement: na

Joist/Girder Sag: na

NOTES:

Contractor to remove existing liner and debris from crawl space.

Contractor to install crawl drain per drawings and install box drain in rear section of home at low point. Contractor to install single with backup discharging to drainage ditch on side of home.

Contractor to seal all vents and penetrations. Contractor to install rim joist insulation and xbloc on walls.

Contractor to install CrawlSeal.

Contractor to install Air System and electrical outlets for sump pump and air system.

Contractor to install new custom door.

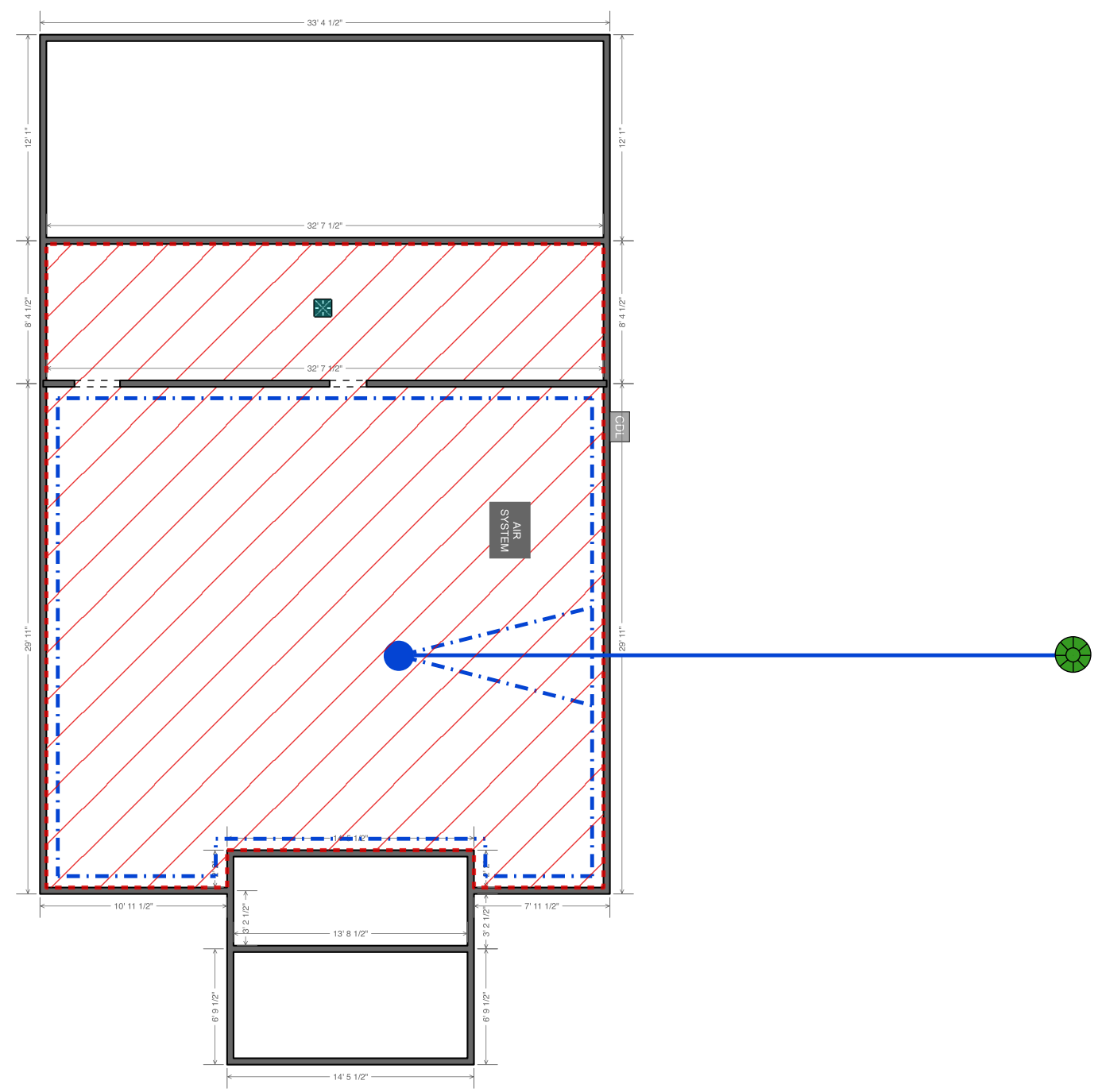

PRODUCT KEY

- PolyRenewal
- 2-Part (Stabilize)
- Crack Repair
- Control Joint Seal
- Previously Injected

PRODUCT KEY

- Sump Pump
- Crawl Drain
- Yard Well
- Box Drain
- ExtremeBloc
- CrawlSeal
- Air System
- Electrical Outlet
- Floor Joist
- Floor Joist Sister
- Main Beam
- Steel I-Beam
- Intellijack
- Shim
- Helical Pier

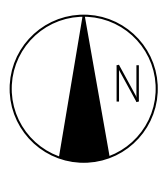

REV	DESCRIPTION	BY	DATE

AMENDMENTS

TARHEEL™
BASEMENT SYSTEMS

2115 ENTERPRISE DRIVE NE
 LELAND, NC 28451

910.622.6125

CLIENT
ANDREW JACKL

SITE
**2773 US 401
 LILLINGTON, NC 27546**

TITLE
JACKL RESIDENCE

DATE 10/04/2024	DRAWN BY STEELE WELCH
---------------------------	---------------------------------

CUSTOMER NO. 000000	SHEET NO. A01
DRAWING NO. 1	