

STRUCTURAL NOTES:

1. STRUCTURE IS DESIGNED FOR A MAXIMUM DESIGN FLOOR LOAD OF 40 POUNDS PER SQUARE FOOT (PSF) LIVE LOAD AND 10 POUNDS PER SQUARE FOOT (PSF) DEAD LOAD
2. ANCHOR STRAP MATERIAL SHALL BE 1 1/4" WIDE AND 0.035 INCHES THICK AND SHALL CONSIST OF TYPE 1, FINISH B, GRADE 1 STEEL CONFORMING TO ASTM D 3953-97.
3. THIS DESIGN MEETS INTERNATIONAL CODE COUNCIL REQUIREMENTS FOR 130 MPH WIND SPEED (MAXIMUM) AND SEISMIC ZONE D.

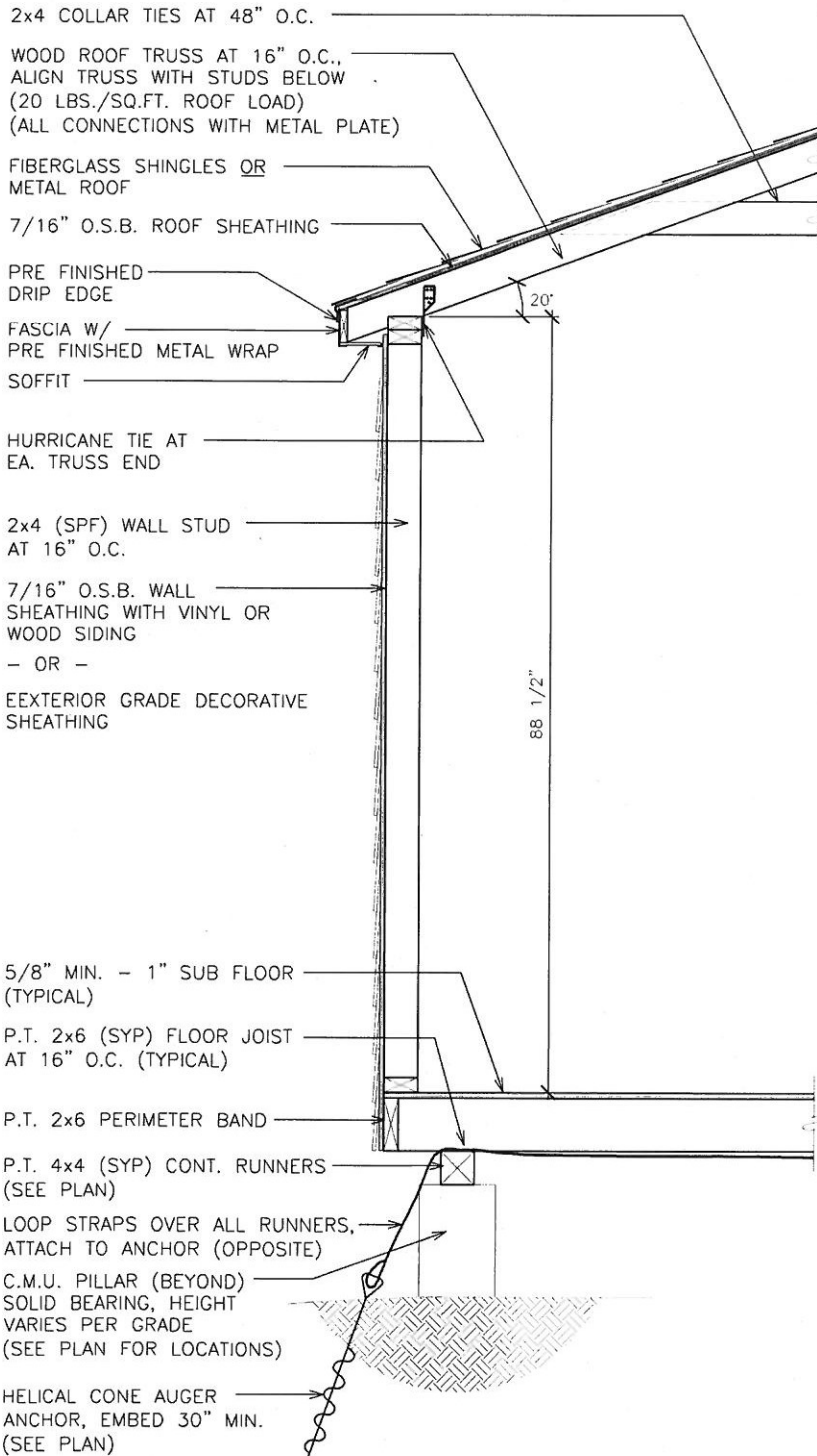

BUILDING SERIES: DELUXE SHED	SIZE: SEE PLAN
SHEET NAME: TYPICAL WALL	SCALE: 5/8" = 1'-0"
WELLS ENGINEERING, PLLC 3401 LONDONDERRY DRIVE GREENSBORO, NC 27410 PHONE: 336.545.0149	DRAWN BY: DOUG GAITHER
	DATE DRAWN: 11.17.14



14' Wide • Vinyl Deluxe

**if building has porch see Wall Sections\B_4.1

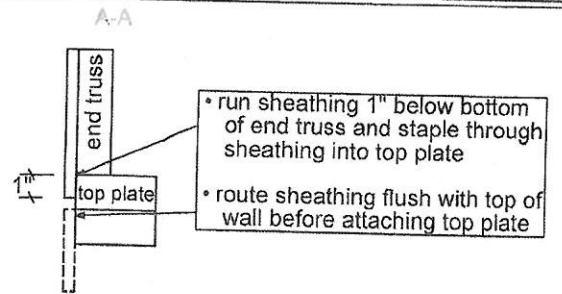
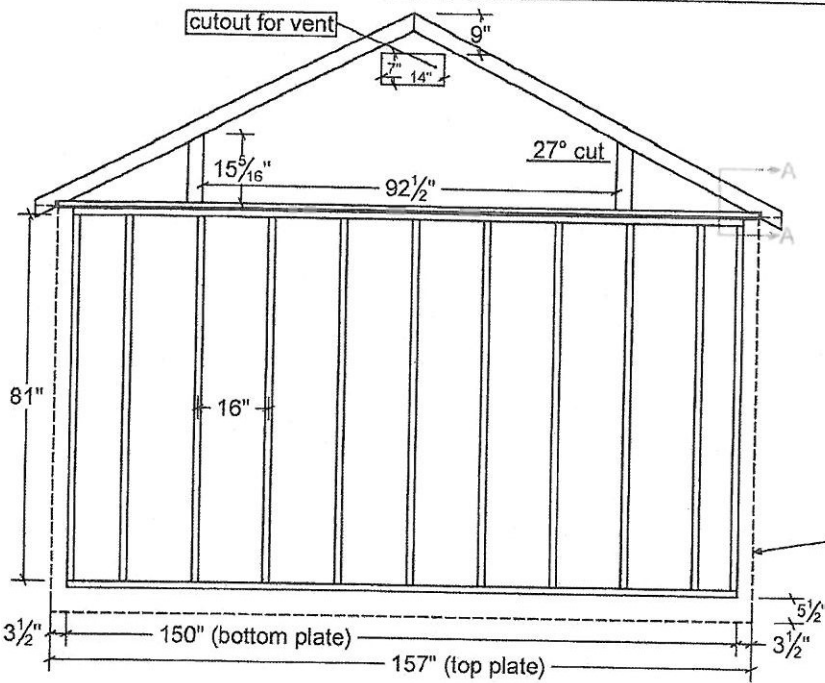

• wall sheathing to extend 3 1/2" past wall
• staple through sheathing into side wall

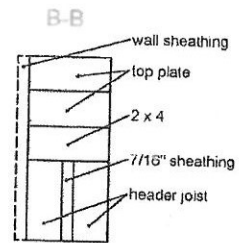
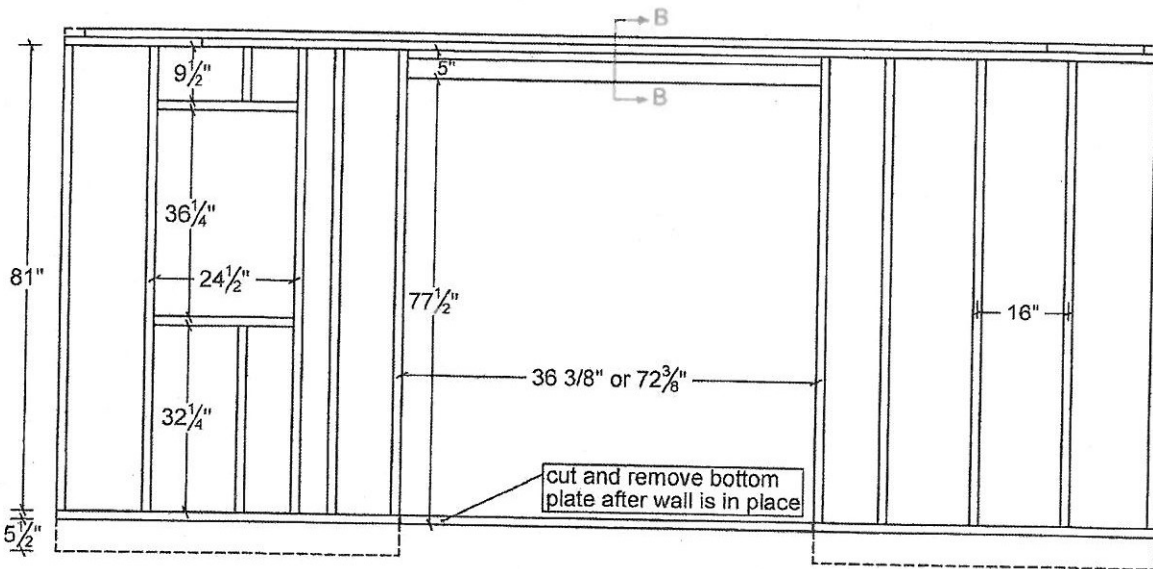

centering a window between door and corner

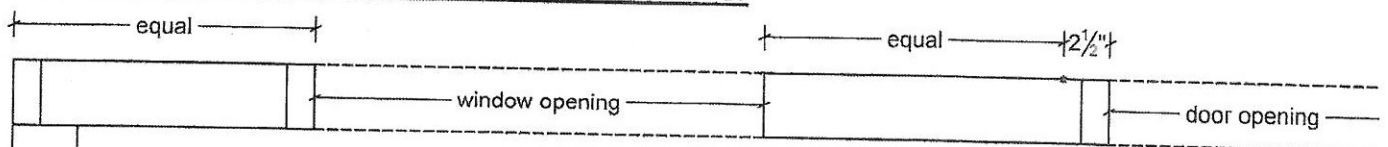

to center a window between a door and a corner:
• mark 2 1/2" outside of door opening
• center window between this mark and corner
*this will center window between 2 1/4" vinyl corner and vinyl door trim

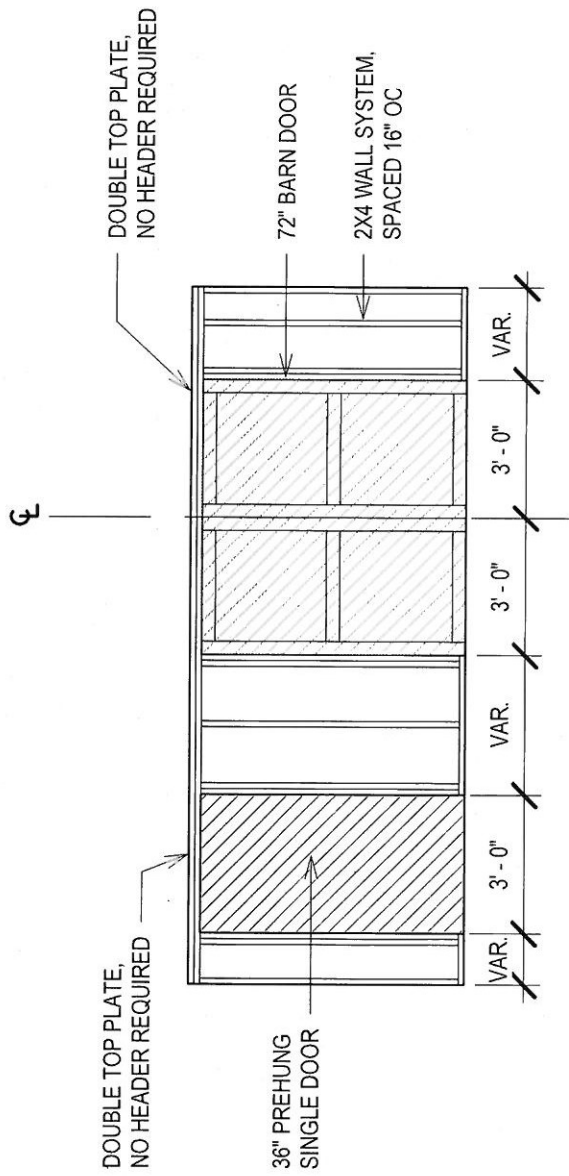

1 TYPICAL DOOR DETAIL
1/4" = 1'-0"