

Harnett County Environmental Health

EXISTING SYSTEM APPROVAL

Issued by: Local Health Department AOWE Certified Inspector

Existing System Approval

Site modification (e.g., storage shed) or footprint addition with no DDF or wastewater strength increase

Reconnection when the proposed facility is in the same footprint as existing/previous facility

Construction Authorization/Notice of Intent to Construct

[issued for reconnection when the proposed facility is not in the same footprint as existing/previous facility pursuant to Session Law 2023-77, Section 5.(c)]

[certified inspectors are not authorized to approve reconnections outside of footprint pursuant to Session Law 2023-77, Section 5.(c)]

Applicant: Brandon Letuli

Mailing Address: 1203 Adcock Rd

City: Lillington

State: NC Zip: 27546

Phone #: 910-987-5928

Email: _____

Owner: Mary Womack

Mailing Address: 1122 Cool Spring Rd

City: Lillington

State: NC Zip: 27546

Phone #: _____

Email: _____

PIN/Lot Identifier: 0610-31-9367

Property Location/Address: 1480 Griffin Rd (SR 1237)

Facility Type: House/Modular Mobile/Manufactured Home Business Other: _____

Operation Permit/ATO #: BRES2409-0043 Design Daily Flow: 360 GPD

Number of Bedrooms: 3 Max # Occupants: 6 Other: _____

Wastewater Strength: Domestic High Strength Industrial Process Wastewater

Water Supply: Private well Public well Shared well Municipal Supply Spring Other: _____

Proposed Property Improvement: _____

All of the following must be checked for approval:

***For Reconnections:**

- Site complies with its Operation Permit or the wastewater system was in use prior to July 1, 1977
- No current or past uncorrected malfunction of the system as described in 15A NCAC 18E .1303(a)(2)
- DDF and wastewater strength for the proposed facility do not exceed that of the existing system
- Facility meets the setbacks in Section .0600 of 15A NCAC 18E
- Existing system is being operated and maintained in accordance with Section .1300 of 15A NCAC 18E and permit conditions.

***For Site Modifications or Footprint Expansions:**

- Proposed structure meets the setbacks in Section .0600 of 15A NCAC 18E

Approval Conditions: _____

Inspector's Printed Name: Mark Osborne REHS Inspector Certification #: 2613

Inspector's Signature:  Date: 11-8-24

See attached site sketch

**EXISTING SYSTEM APPROVAL
SITE SKETCH**

Operation Permit/ATO #: BRES2409-0043

PIN/Lot Identifier: 0610-31-9367

Owner: Mary Womack

Property Location/Address: 1480 Griffin Rd (SR 1237)

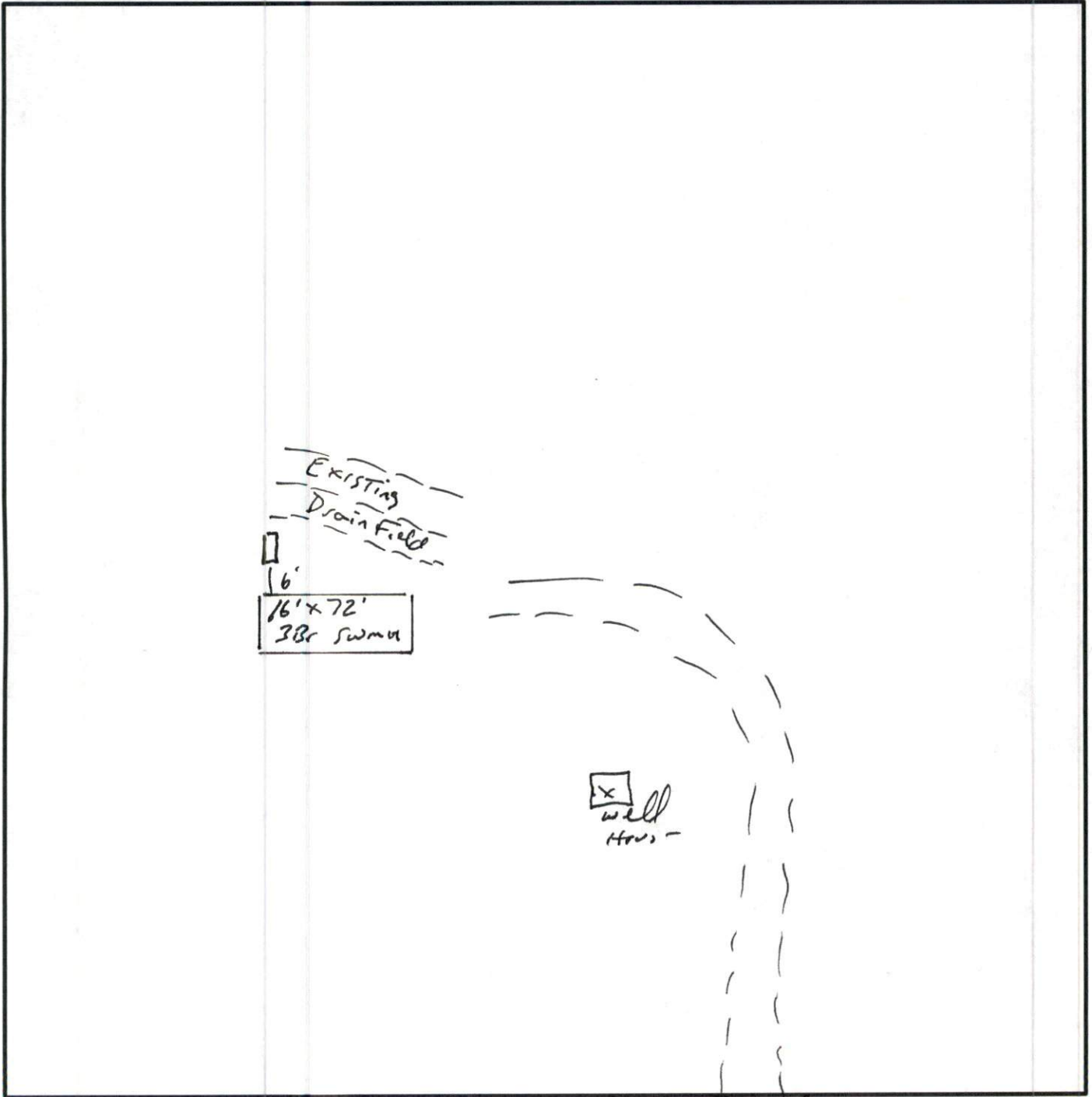

*Include the existing and proposed structures and applicable setbacks. ← Griffin Rd →