



**Scope of Work for:
205 Cypress Wood Lane
Cameron, NC 28326**

The following will be performed as a crawlspace encapsulation project:

*CrawlSeal System to include the following:

-20 ml Vapor Barrier installed wall to wall with 100% floor coverage. All sections of liner will be overlapped a minimum of 1' and will be seamed together, attached with Christmas Tree fasteners, and caulked.

-Install WallSeal on basement walls to help prevent water vapor and moisture intrusion as well as direct wall leakage to the waterproofing system. (12 ml Vapor Barrier on Walls)

-Wrap all existing CMU/Brick Piers 20 ml Vapor Barrier. Contractor will leave a termite inspection gap at the top of each pier. The liner will be fastened to the pier and the top edge of the liner will be sealed with caulking.

*All Vents will be sealed from inside the crawl space with R-10 Rigid 2" Foam Sheathing.

*Existing R-19 insulation will remain in the floor system.

*Drainage Matting Install Drainage matting under the CrawlSeal Liner.

*AprilAire E100 Dehumidifier install - unit specifications on page 2

*Electrical - Installation of new dedicated 120vac/20amp electrical circuit/s and electrical outlet/s (WP-GFCI) to supply sump pump and /or dehumidifier in crawl space (basement).

Davis Dunlap Electrical LLC

210 Timberland Dr

Angier NC 27501

919-669-0768

davisdunlapelectric@yahoo.com

License #27056-L

TARHEEL™

BASEMENT SYSTEMS

A Groundworks Company

SPECIFICATIONS	
Capacity	
@ 80°F/60% RH	100 ppd
@ 73°F/60% RH	85 ppd
Energy Factor	
@ 80°F/60% RH	2.6 L/kW-h
@ 73°F/60% RH	2.35 L/kW-h
Airflow @ varying E.S.P. (external static pressure - dry coil)	
0.0" w.c.	280 CFM
0.2" w.c.	245 CFM
0.4" w.c.	210 CFM
Voltage, phase, frequency	120VAC, 1 phase, 60 Hz
Current draw⁽¹⁾	6.9 Amps
Noise	55 dBA ducted
Dimensions: (cabinet only)⁽²⁾	Width: 14" Height: 15" Length: 26"
Unit Weight	64 lbs.
Shipping Weight	82 lbs.
Inlet air operating conditions during	
-Dehumidification:	50°F-104°F, 40°F dew point min.
-Ventilation:	40°F-140°F, 0%-99% RH (non-condensing)
<small>⁽¹⁾Rated capacity, energy factor and current draw measured at 80°F/60% RH inlet air at 0.0 ESP.</small>	
<small>⁽²⁾Height does not include adjustable feet. The width excludes the filter doors and length excludes the duct collars.</small>	









*Two (2) Crawlspace Triple w/ Backup Install 1/3 HP Sump pump system with liner, cast iron pump, pump stand, water alarm system and battery back-up pumping system with charging/control box with alarm, and 120 amp sealed maintenance free battery.

*CrawlDrain Install CrawlDrain in the area shown. Hand dig in order to develop a trench where indicated on the drawing and install 4" corrugated and perforated pipe with engineered mesh silt sock to collect ground water, back filled with #57 drainage stone and connect to sump system to discharge.

Tar Heel Basement Systems
 Certified Foundation and Waterproofing Inspector
 Jordan Williams
 910.919.1748
 jordan.williams@tarheelbasementsystems.com

Signature: *J. Williams*

James Kennedy
 C#234446
 205 Cypress Wood Ln. Cameron NC 28326

-  Discharge Line
-  Crawl Drain
-  AquaStop Sump Pump
-  AquaStop Air System
-  Electric Outlet
-  Crawl Seal
-  X-block
-  Biocide spray w/ insulation pull

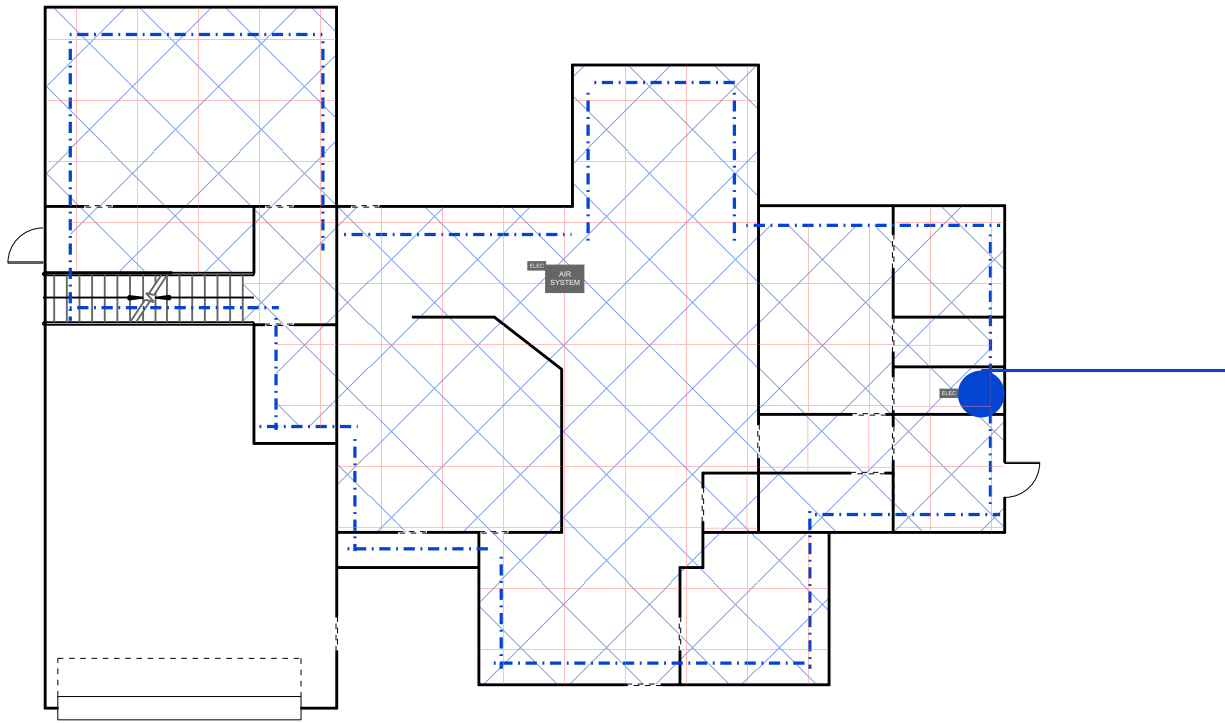

FRONT