

Harnett County Environmental Health

File/Permit Number: BRES2408-0006

IMPROVEMENT PERMIT

County: Harnett
PIN/Lot Identifier: 9576-30-0255
Owner: SRP Cameron LLC Applicant: SRP Cameron LLC
Property Location: 423 Ted Brown Rd (SR 1155)
Subdivision (if applicable) Country MHP Lot #: 423 Block: _____ Section: _____
New ☒ Expansion ☐ System Relocation ☐ Change of Use ☐
Facility Type: 32'x56' DWMH
Number of bedrooms: 3 Number of Occupants: 6 Other: _____
Design Wastewater Strength: ☒ Domestic ☐ High Strength ☐ Industrial Process Wastewater
Proposed Design Daily Flow: 360 GPD Proposed LTAR (Initial): .6 Proposed LTAR (Repair): .6
Proposed Wastewater System Type*: 25% reduction (Initial) Pump Required: ☐ Yes ☒ No ☐ May be required
Proposed Wastewater System Type*: 25% reduction (Repair) Pump Required: ☐ Yes ☒ No ☐ May be required
*Please include system classification for proposed wastewater system types in accordance with Rule .1301 Table XXXII
Effluent Standard: ☒ DSE ☐ HSE ☐ NSF/ANSI 40 ☐ TS-I ☐ TS-II ☐ RCW
Saprolite System (Initial): ☐ Yes ☒ No Saprolite System (Repair): ☐ Yes ☒ No
Fill System (Initial): ☐ Yes ☒ No If yes, specify: ☐ New ☐ Existing (when adding more than 6 inches of fill to system area provide a fill plan)
Fill System (Repair): ☐ Yes ☒ No If yes, specify: ☐ New ☐ Existing (when adding more than 6 inches of fill to system area provide a fill plan)
Usable Depth to LC (Initial)*: 38 Usable Depth to LC (Repair)*: 38 * Limiting Condition
Max. Trench Depth (Initial)*: 24 Max. Trench Depth (Repair)*: 24 * Measured on the downhill side of the trench
Artificial Drainage Required: ☐ Yes ☒ No If yes, please specify details: _____
Type of Water Supply: ☐ Private well ☐ Public well ☐ Shared well ☒ Municipal Supply ☐ Spring ☐ Other: _____
Drainfield location meets requirements of Rule .0508: Yes ☒ No ☐ Drainfield location meets requirements of Rule .0601: Yes ☒ No ☐
Permit valid for: ☒ Five years [site plan submitted pursuant to GS 130A-334(13a)] ☐ No expiration [plat submitted pursuant to GS 130A-334(7a)]

Permit conditions:

NO GUTTER OR FOUNDATION DRAINS SHALL EMPTY ONTO DRAIN FIELD

Authorized Agent's Printed Name: Mark Osborne REHS Expiration Date: 2-12-30
Authorized Agent's Signature: [Signature] Date: 2-12-25

See attached site sketch

The issuance of this permit in no way guarantees the issuance of other permits. The permit holder is responsible for checking with appropriate governing bodies in meeting their requirements. This permit is subject to revocation if the site plan, plat, or the intended use changes. The Improvement Permit shall not be affected by a change in ownership of the site. This permit is subject to compliance with the provisions of 15A NCAC 18E and to the conditions of this permit.

Harnett County Environmental Health

File/Permit Number: BRES2408-0006

CONSTRUCTION AUTHORIZATION

County: Harnett PIN/Lot Identifier: 9576-30-0255
Owner: SRP Cameron LLC Applicant: SRP Cameron LLC
Property Location: 423 Ted Brown Rd (SR 1155)
Facility Type: 32'x56' DWMH
Number of bedrooms: 3 Number of Occupants: 6 Other: _____
☒ New ☐ Expansion ☐ Repair ☐ System Relocation ☐ Change of Use
Basement? ☐ Yes ☒ No Basement Fixtures? ☐ Yes ☒ No
Crawl Space? ☒ Yes ☐ No Slab Foundation? ☐ Yes ☒ No
Type of Wastewater System* 25% reduction (Initial) 25% reduction (Repair)

*Please include system classification for proposed wastewater system types in accordance with Rule .1301 Table XXXII

Design Daily Flow: 360 GPD Wastewater Strength: ☒ Domestic ☐ High Strength ☐ Industrial Process Wastewater

Rule .0403(e) Engineering Design Utilizing Low-flow Fixtures and Low-flow Technologies (S.L. 2013-413 and 2014-120)? ☐ Yes ☒ No
(if yes, please provide engineering documentation)

Effluent Standard: ☒ DSE ☐ HSE ☐ NSF/ANSI 40 ☐ TS-I ☐ TS-II ☐ RCW

Type of Water Supply: ☐ Private well ☐ Public well ☐ Shared well ☒ Municipal Supply ☐ Spring ☐ Other: _____

Installation Requirements/Conditions

Septic Tank Size: 1000 gallons Total Trench/Bed Length: 150 feet Trench/Bed Spacing: 9 feet on center
Trench/Bed Width: 36 inches LTAR: .6 gpd/ft² Usable Depth to LC (Initial)*: 38 ^{*Limiting condition}
Soil Cover: 6 inches Slope Corrected Maximum Trench/Bed Depth*: 24 inches ^{* Measured on the downhill side of the trench}

Pump Tank Size (if applicable): _____ gallons Requires more than one pump? ☐ Yes ☐ No

Pump Requirements: _____ ft. TDH vs. _____ GPM Grease Trap Size (if applicable): _____ gallons

Distribution Method: ☒ Serial ☐ D-Box or Parallel ☐ Pressure Manifold(s) ☐ LPP ☐ Other: _____

Artificial Drainage Required: Yes ☐ No ☒ If yes, please specify details: _____

Legal Agreements (If the answer is "Yes" to any type of legal agreements, please attach a copy of the agreement.)

Multi-party Agreement Required [Rule .0204(g)]: ☐ Yes ☐ No

Easement, Right-of-Way, or Encroachment Agreement Required [Rule .0204(d)]: ☐ Yes ☐ No

Declaration of Restrictive Covenants: ☐ Yes ☐ No

Pre-Construction Conference Required: Yes ☐ No ☐

Management Entity Required: ☐ Yes ☐ No Minimum O&M Requirements: _____

Conditions: _____

The requirements of 15A NCAC 18E are incorporated by reference into this permit and shall be met. Systems shall be installed in accordance with the attached site sketch. This Construction Authorization is subject to revocation if the site plan, plat, or the intended use changes. The Construction Authorization shall not be affected by a change in ownership of the site. This Construction Authorization is subject to compliance with the provisions of 15A NCAC 18E, or 15A NCAC 18A .1900, as applicable, and to the conditions of this permit.

Authorized Agent's Printed Name: Mark Osborne REHS

Expiration Date: 2-12-30

Authorized Agent's Signature: [Signature] REHS

Date: 2-12-25

See attached site sketch

Harnett County Environmental Health

SITE SKETCH

PIN 9576-30-0255

Permit Number BRES2408-0006

SRP Cameron LLC

Country MHP 423

Applicant's Name

Subdivision/Section/Lot Number

Mark Osborne REHS

2-12-25

Authorized State Agent

Date

System components represent approximate contours only. The contractor must flag the system prior to beginning the installation to ensure that the proper grade is maintained.

Scale = NTS

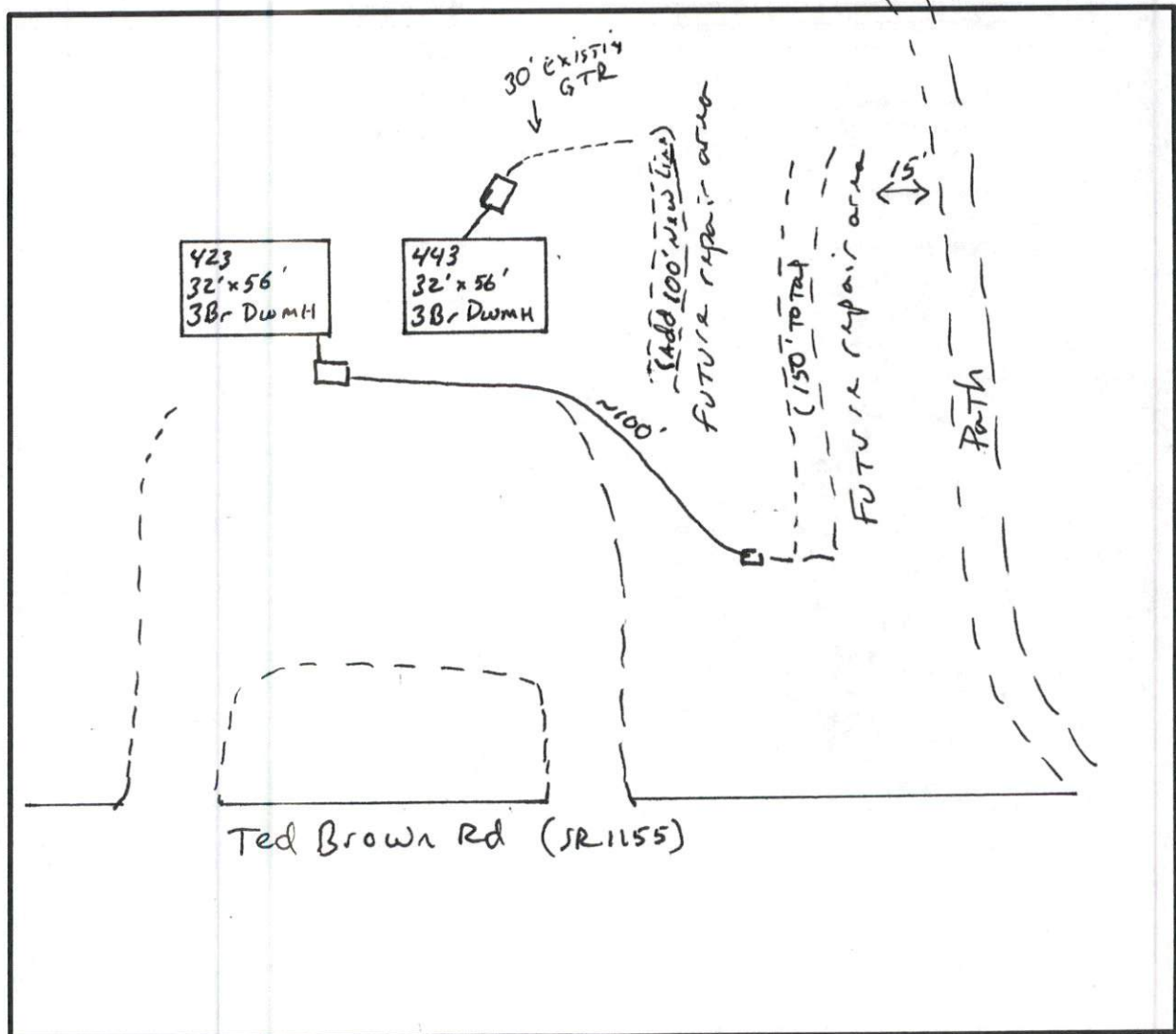

* IF any Part of Supply line From Septic tank
to Drain line is under the driveway, IT MUST be
sleeved to protect From Damage

* IF Questions About Drainfield area, call For
Pre-Install Consult