

Harnett County Environmental Health

EXISTING SYSTEM APPROVAL

Issued by: Local Health Department AOWE Certified Inspector

Existing System Approval

- Site modification (e.g., storage shed) or footprint addition with no DDF or wastewater strength increase
- Reconnection when the proposed facility is in the same footprint as existing/previous facility

Construction Authorization/Notice of Intent to Construct

[issued for reconnection when the proposed facility is not in the same footprint as existing/previous facility pursuant to Session Law 2023-77, Section 5.(c)]
[certified inspectors are not authorized to approve reconnections outside of footprint pursuant to Session Law 2023-77, Section 5.(c)]

Applicant: Parrot Bay Pools

Mailing Address: 194 Federal Rd

City: Benson

State: NC Zip: 27504

Phone #: 919-268-6479

Email: _____

Owner: Drew Hanson

Mailing Address: 220 Brae Dr (SR 1371)

City: Lillington

State: NC Zip: 27546

Phone #: 207-333-8603

Email: _____

PIN/Lot Identifier: 0630-73-6195

Property Location/Address: 220 Brae Dr (SR 1371)

Facility Type: House/Modular Mobile/Manufactured Home Business Other: Pool addition

Operation Permit/ATO #: BRES2407-0068 Design Daily Flow: 360 GPD

Number of Bedrooms: 3 Max # Occupants: 6 Other: _____

Wastewater Strength: Domestic High Strength Industrial Process Wastewater

Water Supply: Private well Public well Shared well Municipal Supply Spring Other: _____

Proposed Property Improvement: _____

All of the following must be checked for approval:

***For Reconnections:**

- Site complies with its Operation Permit or the wastewater system was in use prior to July 1, 1977
- No current or past uncorrected malfunction of the system as described in 15A NCAC 18E .1303(a)(2)
- DDF and wastewater strength for the proposed facility do not exceed that of the existing system
- Facility meets the setbacks in Section .0600 of 15A NCAC 18E
- Existing system is being operated and maintained in accordance with Section .1300 of 15A NCAC 18E and permit conditions.

***For Site Modifications or Footprint Expansions:**

- Proposed structure meets the setbacks in Section .0600 of 15A NCAC 18E

Approval Conditions: _____

Inspector's Printed Name: Mark Osborne REHS Inspector Certification #: 2613

Inspector's Signature: [Signature] Date: 9-13-24

See attached site sketch

**EXISTING SYSTEM APPROVAL
SITE SKETCH**

Operation Permit/ATO #: BRES2407-0068

PIN/Lot Identifier: 0630-73-6195

Owner: BRES2407-0068

Property Location/Address: 220 Brae Dr (SR 1371)

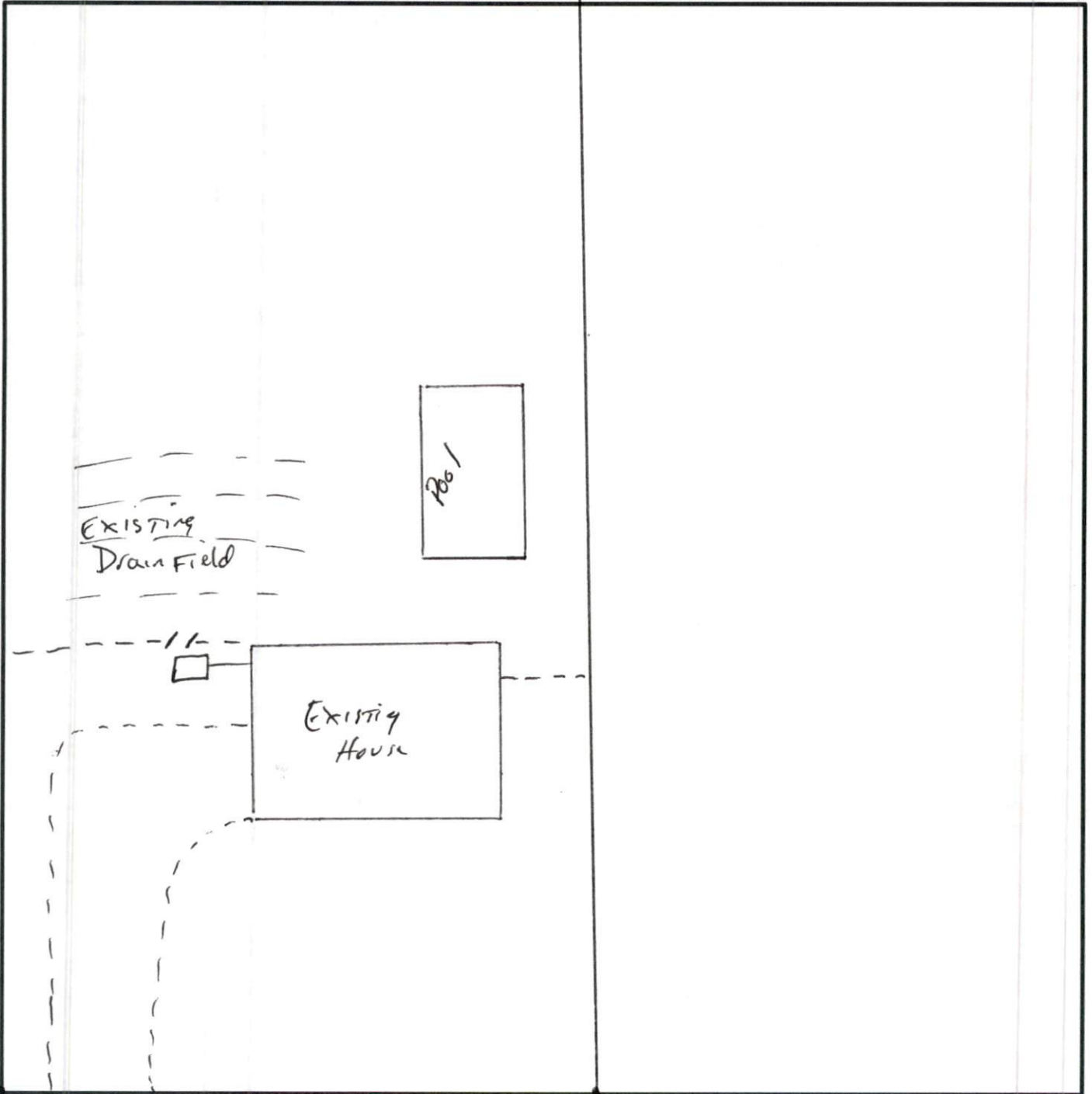

← Brae Dr → *Include the existing and proposed structures and applicable setbacks.*